



**Katrina Martinez**  
Deputy Clerk

# Pima County Clerk of the Board

**Melissa Manriquez**

**Administration Division**  
130 W. Congress St., 1st Floor  
Tucson, AZ 85701  
Phone: (520)724-8449 • Fax: (520)222-0448

**Management of Information & Records Division**  
1640 East Benson Highway  
Tucson, Arizona 85714  
Phone: (520) 351-8454 • Fax: (520) 791-6666

January 5, 2026

Sung Tae Lee  
Seoul Shi  
5118 N. Ocean Avenue  
Tucson, AZ 85704

RE: Arizona Liquor License Job No.: 369760  
d.b.a. Seoul Shi

Dear Mr. Lee:

Enclosed is a copy of the Affidavit of Posting relative to your Liquor License Application for a Series 12, Restaurant, which was received in our office on November 26, 2025. The Hearing before the Pima County Board of Supervisors has been scheduled for Tuesday, January 20, 2026, at 9:00 a.m. or thereafter, at the following location:

Pima County Administration Building  
Board of Supervisors Hearing Room  
130 W. Congress, 1st Floor  
Tucson, AZ 85701

Should you have any questions pertaining to this matter, please contact this office at (520)724-8449.

Sincerely,

A handwritten signature in black ink, appearing to read "Melissa Manriquez", is written over a horizontal line.

Melissa Manriquez  
Clerk of the Board

Enclosure



## POSTING

Job# \_\_\_\_\_

DLLC use only

Arizona Dept. of Liquor Licenses and Control  
800 W. Washington St. 5<sup>th</sup> Floor Phoenix, AZ 85007  
(602) 542-5141

Type or Print with Black Ink

12/01/25  
Date of Posting: \_\_\_\_/\_\_\_\_/\_\_\_\_

12/22/25  
Date of Posting Removal: \_\_\_\_/\_\_\_\_/\_\_\_\_

Applicant's Name: Seoul Shi  
Lee Sung Tae  
Last First Middle

Business Address: 6462 N. Oracle Road Tucson 85704  
Street City Zip

I hereby certify that pursuant to A.R.S. 4-201, I posted notice in a conspicuous place on the premises proposed to be licensed by the above applicant and said notice was posted for at least twenty (20) days.

Ross Mckillop DETECTIVE (520)351-6000  
Print Name of City/County Official Title Phone Number

Signed by: [Signature] Badge8591  
Signature badge 12/22/2025  
Signature badge Date Signed

Return this affidavit with your recommendations or any other related documents.  
If you have any questions please call (602) 542-5141 and ask for the Licensing Division.

DEC 22 2021 11:15 PM CLK OF BD



## Pima County Clerk of the Board

Melissa Manriquez

Katrina Martinez  
Deputy Clerk

Administration Division  
130 W. Congress St., 1st Floor  
Tucson, AZ 85701  
Phone: (520) 724-8449 • Fax: (520) 222-0448

Management of Information & Records Division  
1640 East Benson Highway  
Tucson, Arizona 85714  
Phone: (520) 351-8454 • Fax: (520) 791-6666

---

TO: Development Services, Zoning Division

FROM: Aliza Barraza  
Administrative Specialist III

DATE: November 26, 2025

RE: Zoning Report - Application for Liquor License

---

Attached is the application of:

Sung Tae Lee  
d.b.a. Seoul Shi  
6462 N. Oracle Road  
Tucson, AZ 85704

Arizona Liquor License Job No. 369760  
Series 12, Restaurant  
New License ☒  
Person Transfer  
Location Transfer

---

ZONING REPORT

DATE: 12/11/2025

Will current zoning regulations permit the issuance of the license at this location?

Yes ☒ No ☐

If No, please explain:

---

---

---

---

  
Pima County Zoning Inspector

When complete, please return to cob\_mail@pima.gov

25-34-9561

**State of Arizona**  
**Department of Liquor Licenses and Control**

Created 11/26/2025 @ 08:22:20 AM

**Local Governing Body Report**

**LICENSE**

Number: Type: 012 RESTAURANT  
Name: SEOUL SHI  
State: Pending  
Issue Date: Expiration Date:  
Original Issue Date:  
Location: 6462 N ORACLE ROAD  
TUCSON, AZ 85704  
USA  
Mailing Address: 5118 N OCEAN AVENUE  
TUCSON, AZ 85704  
USA  
Phone: (213)554-7183  
Alt. Phone:  
Email: JOYCEJ3339@GMAIL.COM

**AGENT**

Name: SUNG TAE LEE  
Gender: Male  
Correspondence Address: 5118 N OCEAN AVENUE  
TUCSON, AZ 85704  
USA  
Phone: (213)554-7183  
Alt. Phone:  
Email: JOYCEJ3339@GMAIL.COM

**OWNER**

Name: THE BUUL LLC  
Contact Name: SUNG TAE LEE  
Type: LIMITED LIABILITY COMPANY  
AZ CC File Number: 23884221 State of Incorporation: AZ  
Incorporation Date: 09/17/2025  
Correspondence Address: 5118 N OCEAN AVENUE  
TUCSON, AZ 85704  
USA  
Phone: (213)554-7183  
Alt. Phone:  
Email: JOYCEJ3339@GMAIL.COM

**Officers / Stockholders**

60th Day  
1-25-2026

Name:  
JUNG RYEOL KWON  
SUNG TAE LEE

Title:  
Member  
Member

% Interest:  
50.00  
50.00

### **THE BUUL LLC - Member**

Name: JUNG RYEOL KWON  
Gender: Male  
Correspondence Address: 5118 N OCEAN AVENUE  
TUCSON, AZ 85704  
USA  
Phone: (213)268-8123  
Alt. Phone:  
Email: JUNGKWON.KSRDEVELOPMENT@GMAIL.COM

### **THE BUUL LLC - Member**

Name: SUNG TAE LEE  
Gender: Male  
Correspondence Address: 5118 N OCEAN AVENUE  
TUCSON, AZ 85704  
USA  
Phone: (213)554-7183  
Alt. Phone:  
Email: JOYCEJ3339@GMAIL.COM

## **MANAGERS**

Name: ESTHER EUN-SONG SHIN  
Gender: Female  
Correspondence Address: 5118 N OCEAN AVENUE  
TUCSON, AZ 85704  
USA  
Phone: (714)328-3298  
Alt. Phone:  
Email: ESTHERSTHERE@GMAIL.COM

## **APPLICATION INFORMATION**

Application Number: 369760  
Application Type: New Application  
Created Date: 11/19/2025

## **QUESTIONS & ANSWERS**

**012 Restaurant**

- 1) Are you applying for an Interim Permit (INP)?  
Yes  
What date are you taking ownership? Please upload the Interim Permit Notary page when you reach the upload page.  
11/19/2025
- 2) Are you one of the following? Please indicate below.  
Property Tenant  
Subtenant  
Property Owner  
Property Purchaser  
Property Management Company  
Property Tenant
- 3) Is there a penalty if lease is not fulfilled?  
Yes  
What is the penalty?  
Landlord lockout
- 4) Is the Business located within the incorporated limits of the city or town of which it is located?  
No  
If no, in what City, Town, County or Tribal/Indian Community is this business located?  
Pima County
- 5) What is the total money borrowed for the business not including the lease?  
Please list each amount owed to lenders/individuals.  
None, capital contributions
- 6) Are there walk-up or drive-through windows on the premises?  
No
- 7) Does the establishment have a patio?  
No
- 8) Is your licensed premises now closed due to construction, renovation or redesign or rebuild?  
No
- 9) What type of business will this license be used for?  
Restaurant

## DOCUMENTS

DOCUMENT TYPE	FILE NAME	UPLOADED DATE
MISCELLANEOUS	DBL K-App & Auth Letter.pdf	11/19/2025
QUESTIONNAIRE	Esther Mgr Q Basic & Mgt Certs.pdf	11/19/2025
DIAGRAM/FLOOR PLAN	Floor Plan.pdf	11/19/2025
INTERIM PERMIT NOTARY PAGE	INP.pdf	11/19/2025
QUESTIONNAIRE	Jungryeol Q & Attach.pdf	11/19/2025
MENU	Menu.pdf	11/19/2025
RESTAURANT OPERATION PLAN	Rest Op Plan.pdf	11/19/2025
RECORDS REQUIRED FOR AUDIT	RRFA.pdf	11/19/2025
QUESTIONNAIRE	Sungtea Q Attach ASF Naturalization.pdf	11/19/2025

**State of Arizona**  
**Department of Liquor Licenses and Control**

Created 11/26/2025 @ 08:20:40 AM

**Local Governing Body Report**

**LICENSE**

Number:	INP100035979	Type:	INP INTERIM PERMIT
Name:	SEOUL SHI		
State:	Active		
Issue Date:	11/26/2025	Expiration Date:	03/04/2026
Original Issue Date:	11/26/2025		
Location:	6462 N ORACLE ROAD TUCSON, AZ 85704 USA		
Mailing Address:	5118 N OCEAN AVENUE TUCSON, AZ 85704 USA		
Phone:	(213)554-7183		
Alt. Phone:			
Email:	JOYCEJ3339@GMAIL.COM		

**AGENT**

Name:	SUNG TAE LEE
Gender:	Male
Correspondence Address:	5118 N OCEAN AVENUE TUCSON, AZ 85704 USA
Phone:	(213)554-7183
Alt. Phone:	
Email:	JOYCEJ3339@GMAIL.COM

**OWNER**

Name:	THE BUUL LLC		
Contact Name:	SUNG TAE LEE		
Type:	LIMITED LIABILITY COMPANY		
AZ CC File Number:	23884221	State of Incorporation:	AZ
Incorporation Date:	09/17/2025		
Correspondence Address:	5118 N OCEAN AVENUE TUCSON, AZ 85704 USA		
Phone:	(213)554-7183		
Alt. Phone:			
Email:	JOYCEJ3339@GMAIL.COM		

**Officers / Stockholders**

Name:  
JUNGRYEOL KWON  
SUNG TAE LEE

Title:  
Member  
Member

% Interest:  
50.00  
50.00

**THE BUUL LLC - Member**

Name: JUNGRYEOL KWON  
Gender: Male  
Correspondence Address: 5118 N OCEAN AVENUE  
TUCSON, AZ 85704  
USA  
Phone: (213)268-8123  
Alt. Phone:  
Email: JUNGKWON.KSRDEVELOPMENT@GMAIL.COM

**THE BUUL LLC - Member**

Name: SUNG TAE LEE  
Gender: Male  
Correspondence Address: 5118 N OCEAN AVENUE  
TUCSON, AZ 85704  
USA  
Phone: (213)554-7183  
Alt. Phone:  
Email: JOYCEJ3339@GMAIL.COM

**MANAGERS**

Name: ESTHER EUN-SONG SHIN  
Gender: Female  
Correspondence Address: 5118 N OCEAN AVENUE  
TUCSON, AZ 85704  
USA  
Phone: (714)328-3298  
Alt. Phone:  
Email: ESTHERSTHERE@GMAIL.COM



## APPLICATION INFORMATION

Application Number: 369761  
Application Type: New Application  
Created Date: 11/19/2025

## QUESTIONS & ANSWERS

### INP Interim Permit

- 1) Enter License Number currently at location 12104439
- 2) Is the license currently in use? yes
- 3) Submit the interim permit section of the license series application you are applying for when you reach the upload page. yes

125 11 20 Lique. Dept FM 4 146



Arizona Department of Liquor Licenses and Control  
<https://www.azliquor.gov>  
(602) 542-5141

FOR DLIC USE ONLY

Permit Number:	12104437
Date Approved:	11-26-2025
Expiration:	3-4-2026
LC:	Chaya

## INTERIM PERMIT (INP)

### NOTARY PAGE

\$100.00 INTERIM PERMIT APPLICATION FEE

#### SECTION 5, PAGE 2, of the license application

#### For approval of an interim permit:

- There **must** be a valid license of the same series issued to the current location you are applying for, OR
- A Hotel/Motel license is being replaced with a restaurant license pursuant to A.R.S. §4-203.01(A)

1. Enter license number currently at the location: 12104437

2. Is the license currently in use? ☒ Yes ☐ No If no, how long has it been out of use? N/A

I, (Print Full Name) Dae Sun So (Controlling Person) hereby declare that I am the Individual, Owner, Agent, or Controlling Person on the stated license and location.

Signature: Dae Sun So

State of Arizona

County of Pima

Signed before me on this 28 day of October, 2025

Notary Signature: Denise Rene Gadd

My commission expires on 16 day of May, 2028

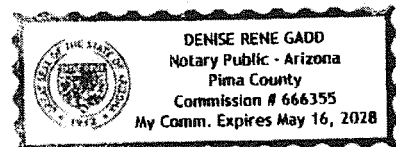

Notary Seal

25 11 20 Lsq. DEPT PM 4 146

Emergency /  
Delivery E.E.

Emergency  
Door & Screen Door

2,910  
Sq. Feet

Storage

Sushi  
Bar

Right  
Area

Finch Area

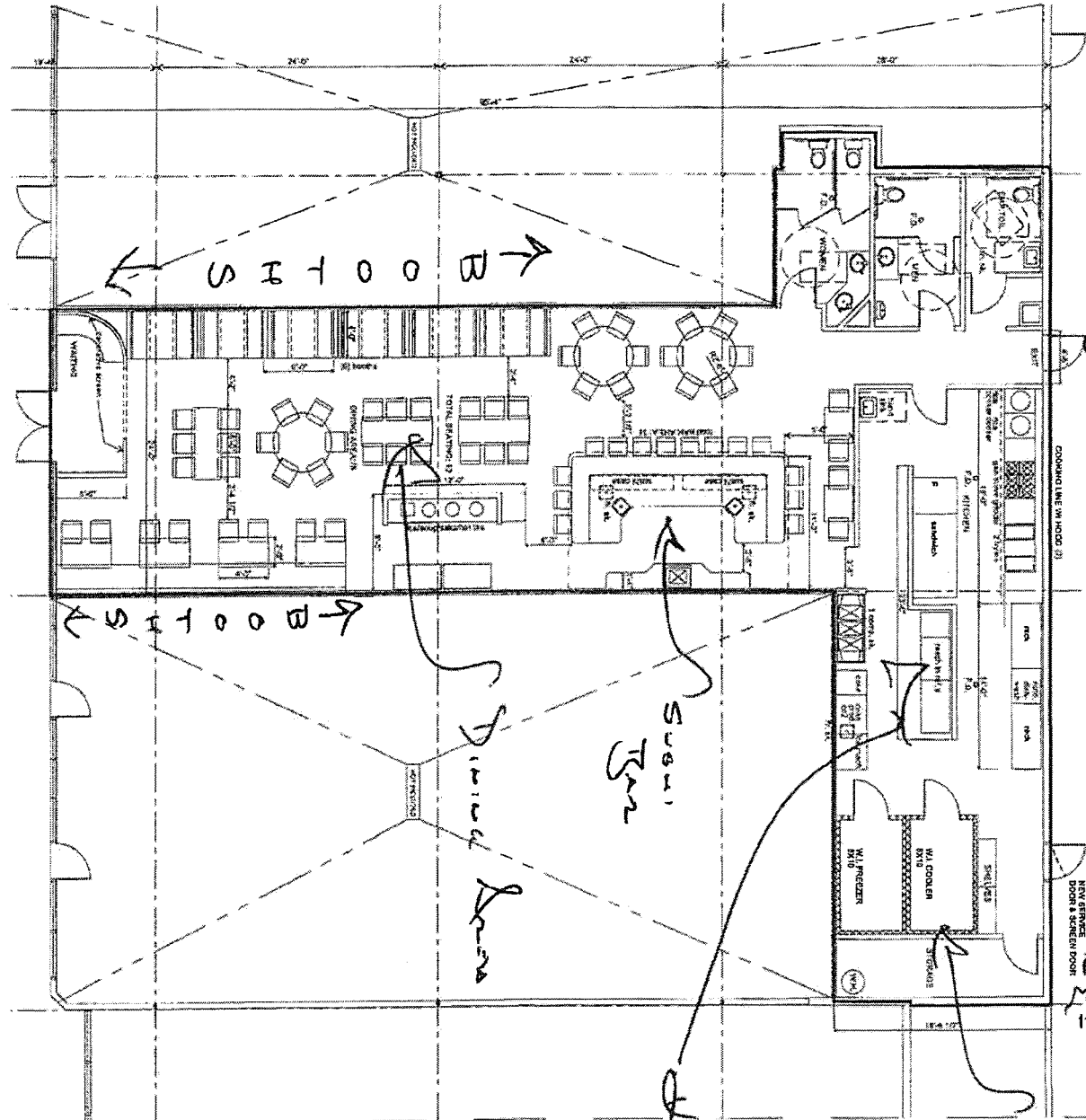

FIRST FLOOR PLAN  
SCALE 1/8" = 1'-0"  
NORTH

DWG. NO. A2.0	DATE 04/16/2014	REVISIONS 1	FLOOR PLAN RESTAURANT TENANT INTERIOR FOR: TAMPA SUSHI OPPING CENTER and DEVELOPMENT, INC.	PAUL REYES AIA TOWNWEST DESIGN AND INTERIORS, INC. 2000 1st Avenue South Tampa, FL 33606 Tel: 813-281-1111 Fax: 813-281-1112	
------------------	--------------------	----------------	--	--	--



DLLC USE ONLY

Job #:	369760
Date Accepted:	11-19-2025
LC:	Chaya
License #:	

## RESTAURANT OPERATION PLAN

RESTAURANT SERIES 12 AND  
HOTEL/MOTEL SERIES 11 ONLY

1. Name of restaurant (Please print): SEoul Shi

2. Must indicate the equipment below by Make, Model, and Capacity:

### LIST ONLY THE FOLLOWING - NO ATTACHMENTS

Grill	1-2 1/2' SS SALAMANDER, 1-2 1/2' SS CHAR BROTHER, 1-2 1/2' SS GRIDDLE, 1-2' SS FLAT TOP
Oven	1-2 1/2' SS WALK IN COMM. OVEN, 1-3' 6 BURNER SS STOVE TOP w/ OVEN
Freezer	1-3 1/2' COMM. CHEST, 1-12' X 6' SS WALK IN, 1-7' SS 2 DOOR UPRIGHT
Refrigerator	1-4' SS 2 DOOR FLOOR UNIT, 1-6' SS REFR. SAND PREP., 1-5' SS REFR. SAND. PREP., 1-12' X 6' SS WALK IN
Sink	1-6' "L" SS PREP w/ SINK, 1-8' SS "L" SS PREP w/ SINK, 2-SS HAND SINK, 1-2 1/2' SS SINK, 1-3' SS SINGLE COMP. SINK
Dish Washing Facilities	1-COMM. DISHWASHER
Food Preparation Counter (Dimensions)	1-5' SS PREP
Other	2-6' REFR. SUSHI CASES, 1-7' SS REFR. SUSHI CASE, 1-5' COMM. MIXER, 1-MEAT SCALE, 2-COMM. MICROWAVE, 1-WOP SINK, 2-TILE COOKERS, 1-2' SS LARGE GAS BURNER, 2-2 BASKET SS FILTERS, 1-3' SS 2 COMP. SINK, 1-13' SS HOOD w/ ANSUL, 1-COMM. ICE MACHINE, 1-5 1/2' SS 3 COMP. SINK

3. Attach a copy of your FULL menu with pricing INCLUDING NON-ALCOHOLIC BEVERAGES

4. What percentage of your public premises is used primarily for restaurant dining?

(Do not include kitchen, bar, hi-top tables, or game area.) 100 %

5. Does your restaurant have a bar area that is distinct and separate from the dining area? ☐ YES ☒ No

(If yes, what percentage of the public floor space does this area cover?) N/A %

6. List the seating capacity for:

a) Restaurant dining area of your premises:  
(DO NOT INCLUDE PATIO SEATING)

[ 105 ]

b) Bar area

[ + 0 ]

TOTAL [ = 105 ]

7. What type of dinnerware is primarily used in your restaurant? ☒ Reusable ☐ Disposable ☐ Both

8. Does your restaurant contain any **games, televisions, or any other entertainment**? ☒ Yes ☐ No  
If yes, specify what types and how many (examples: 4-TV's, 2-Pool Tables, 1-Video Game, etc.)

4 - 55" Flat Screen TV's

9. Do you have live entertainment or dancing? ☐ Yes ☒ No  
If yes, what type and how often (example: DJ-2 x a week, Karaoke-2 x a month, Live Band-1 x a month, etc.)

10. List number of employees for each position:

Position	How many
Cooks	2
Bartenders	0
Hostesses	0
Managers	1
Servers	7
Other (Dishwasher)	1/2
Other (Sushi Cook)	4
Other ( )	

I, (Print Full Name) SUNG TAE LEE, hereby swear under penalty of perjury and in compliance with A.R.S. § 4-210(A)(2) and (3) that I have read and understand the foregoing and verify that the information and statements that I have made herein are true and correct to the best of my knowledge.

Applicant Signature: Sungtae Lee



# Seoul Shi Menu

## Appetizers

Edamame \$3.95

Gyoza \$7.95

Shumai \$6.95

Steamed shrimp dumplings \$9.95

Vegetable Tempura \$6.95

Deep fried vegetables served with tempura sauce \$6.95

Shrimp Tempura \$6.95

Agedashi Tofu \$6.95

Deep fried tofu served with tempura sauce \$6.95

Crab Puff \$7.95

Deep fried wontons stuffed with crab and cream cheese \$7.95

Yakitori \$7.95

Tender chicken skewers glazed in our house teriyaki \$7.95

## Salads

Avocado Salad \$7.95

Crab Salad \$7.95

Crab over sliced cucumbers with ponzu sauce \$7.95

Cucumber Salad \$3.95

Poke Salad \$7.95

Seaweed Salad \$3.95

Spicy Crab Salad \$7.95

Spicy crab over sliced cucumbers \$7.95

Spicy Tuna Salad \$7.95

## Entrees

All entrees are served with steamed rice

Chicken Teriyaki \$16.95

Beef Teriyaki \$16.95

Salmon Teriyaki \$16.95

Vegetable Tempura \$13.95

Deep fried vegetables served with tempura sauce \$13.95

Shrimp Tempura \$16.95

Sesame Chicken \$16.95

Spicy Chicken \$16.95

## Specialties

Chirashi \$24.95

Una Don \$24.95

Hwe Dup Bop \$24.95

Ahi Tuna Tataki \$22.95

Poke Salad \$24.95

## Rolls

Alaskan Roll \$12.95

Atom Bomb Roll \$12.95

Baked California Roll \$7.95

Baked Scallop California Roll \$14.95

Bubba Roll \$8.50

\*25 11 20 Lique. Dept PM 4 46

California Roll \$6.50

Caterpillar Roll \$11.95

Crunch Roll \$8.95

Deep Fried California Roll \$8.95

Dragon Roll \$12.95

Dynamite California Roll \$12.95

Eel Roll \$8.50

Electric Roll \$12.95

Hawaiian Roll \$12.95

## Nigiri

2 pieces per order

Albacore (White Tuna) \$5.50

Crab (Kani) \$5.50

Freshwater Eel (Unagi) \$5.50

Fried Tofu (Inari)\$5.50

Mackerel (Saba) \$5.50

Salmon (Sake)\$5.50

Salmon Roe (Ikura)\$5.50

Shrimp (Ebi)\$5.50

Smelt Roe (Masago)\$5.50

Smoked Salmon\$5.50

Spicy Scallops\$5.50

Squid (Ika)\$5.50



Surf Clam (Hokigai)\$5.50

Sweet Egg (Tamago)\$5.50

Sweet Shrimp (Amaebi)\$5.50

Tuna (Maguro)\$5.50

White Fish (Izumidai)\$5.50

Yellowtail (Hamachi)\$5.50

## Sashimi

Ahi Tuna Tataki \$21.95

Albacore Tataki (9 pc) \$21.95

Salmon (9 pc) \$21.95

Tuna (9 pc) \$21.95

Yellowtail (9 pc) \$21.95

Combo (6 pc) \$21.95

Combo (9 pc) \$21.95

## Non Alcoholic beverages

coke/ diet coke/ zero coke/ sprite/ dr.pepper/ lemonade \$4

## Beer & Sake & Wine

**\$7.00**

**SAPPORO RESERVE**

**\$9.00**

**NOZAWA — SUPER DRY SAKE, 6 OZ.**

**\$15.00**

**NIGORI — UNFILTERED SAKE, 12.7 OZ.**

\$14.00

15.11.2014, Dept. #145  
HAKKAISAN — PREMIUM DRY SAKE, 10.1 OZ.

\$38.00

NOZAWA BAR PREMIUM SAKE, 24.3 OZ.

\$98.00

BRASSFIELD — SAUVIGNON BLANC

G\$12

B\$48

THE CALLING — CHARDONNAY

G.\$14

B.\$56

HANZELL SEBELLA — CHARDONNAY

G\$16

B\$64

DRY AND COMPLEX	300ml	720ml
Karatamba 'Dry Wave'	21	50
Kurosawa 'Black Creek'	29	60
Konteki 'Tears of Dawn'	44	94

DELICATE AND FRUITFUL	300ml	720ml 25 11 20 14:46 Dept PM 4 46
Kikusui Chrysanthemum Mist	29	58
Haketsuru	23	52
Heaven's Sake 'Sake Baby	30	

BOLD AND SOPHISTICATED	300ml	720ml
Wakatake Onikoroshi 'Demon Slayer'		112
Takatenjin 'Soul of the Sense'	45	98
Kubota Hekiju '100 Ostentatious-nesses'		122
Kubota Manju – 10,000 Ostentatious-ness		152

OTHERS	300ml	720ml
Sho Chiku Bai Nigori	18	39
Yuki White Peach Nigori	26	
Zipang Sparkling	22	
Hot Sake	15	
Sake Bomb	8	



25 11 20 Lique. Dept PH 4 47  
Arizona Department of Liquor Licenses and Control  
<https://www.azliquor.gov>  
(602) 542-5141

**RECORDS REQUIRED FOR AUDIT  
RESTAURANT/HOTEL/MOTEL**

DLLC USE ONLY	
Job #:	369760
Date Accepted:	11-19-2025
LC:	Chayn
License #:	

In the event of an audit, you will be asked to provide to the Department any documents necessary to determine Compliance with A.R.S. §4-205.02(G). Such documents requested may include however, are not limited to:

1. Name of restaurant (Please print): SEoul Shi
2. All invoices and receipts for the purchase of food and spirituous liquor for the licensed premises.
3. A list of *all* food and liquor vendors
4. The restaurant menu used during the audit period
5. A price list for alcoholic beverages during the audit period
6. Mark-up figures on food and alcoholic products during the audit period
7. A recent, *accurate* inventory of food and liquor (taken within two weeks of the Audit Interview Appointment)
8. Monthly Inventory Figures - beginning and ending figures for food and liquor
9. Chart of accounts (copy)
10. Financial Statements-Income Statements-Balance Sheets
11. General Ledger
  - A. Sales Journals/Monthly Sales Schedules
    - 1) Daily sales Reports (to include the name of each waitress/waiter, bartender, etc. with sales for that day)
    - 2) Daily Cash Register Tapes - Journal Tapes and Z-tapes
    - 3) Dated Guest Checks
    - 4) Coupons/Specials/Discounts
    - 5) Any other evidence to support income from food and liquor sales
  - B. Cash Receipts/Disbursement Journals
    - 1) Daily Bank Deposit Slips
    - 2) Bank Statements and canceled checks
12. Tax Records
  - A. Transaction Privilege Sales, Use and Severance Tax Return (copies)
  - B. Income Tax Return - city, state and federal (copies)
  - C. Any supporting books, records, schedules or documents used in preparation of tax returns

13. Payroll Records

25 11 20 Liqueur. Dept. FR 4 47

- A. Copies of all reports required by the State and Federal Government
- B. Employee Log (A.R.S. §4-119)
- C. Employee time cards (actual document used to sign in and out each workday)
- D. Payroll records for all employees showing hours worked each week and hourly wages

14. Off-site Catering Records (must be complete and separate from restaurant records)

- A. All documents that support the income derived from the sale of food off the license premises.
- B. All documents which support purchases made for food to be sold off the licensed premises.
- C. All coupons/specials/discounts

The sophistication of record keeping varies from establishment to establishment. Regardless of each licensee's accounting methods, the amount of gross revenue derived from the sale of food and liquor must be substantially documented.

**REVOCATION OF YOUR LIQUOR LICENSE MAY OCCUR IF YOU FAIL TO COMPLY WITH  
A.R.S. §4-210(A)7 AND A.R.S. §4-205.02(G).**

**A.R.S. §4-210(A) 7**

The licensee fails to keep for two years and make available to the department upon reasonable request all invoices, records, bills or other papers and documents relating to the purchase, sale and delivery of spirituous liquors and, in the case of a restaurant or hotel-motel licensee, all invoices, records, bills or other papers and documents relating to the purchase, sale and delivery of food.

**A.R.S. §4-205.02(M)**

For the purpose of this section:

Restaurant: an establishment that derives **at least forty percent (40%)** of its gross revenue from the sale of food

Gross revenue: the revenue derived from all sales of food and spirituous liquor on the licensed premises regardless of whether the sales of spirituous liquor are made under a restaurant license issued pursuant to this section or under any other license that has been issued for the premises pursuant to this article.

**Declaration:**

I, (Print Name) SUNGTAE LEE, declare under penalty of perjury that I am authorized to submit this application. I have read the contents and to the best of my knowledge believe all statements made on this application to be true, correct, and complete.

Signature: Sungtae Lee

**\*MAKE A COPY OF THIS DOCUMENT AND KEEP IT WITH RECORDS REQUIRED BY THE STATE\***