

July 7, 2026

Honorable Chair Jennifer Allen
Members of the Pima County Board of Supervisors
Clerk of the Board of Supervisors

RE: Case Co 12-76-52 Rancho Del Cerro Subdivision, Plat Note modification to allow another driveway at 5532 W Placita Acantilada for a garage

Dear Chair Allen and Members of the Board of Supervisors,

We live in Rancho Del Cerro Subdivision adjacent to the subject property and just received notice of the proposed Special Action, Co 12-76-52, Plat Note Modification of the Rancho del Cerro Subdivision, Lot 430. We oppose the modification to lift the one foot no access easement along Calle del Risco. We would encourage the applicant to work within their existing building footprint and driveway to build their garage. Our reasons include:

1. This subdivision was developed to minimize grading, embrace native plant preservation and honor the hillsides of the Tucson Mountain area. The project site is one block from the Sweetwater Preserve where many in the neighborhood bike and hike. This is a prominent hilltop visible throughout the neighborhood. This new driveway and garage will scar the hillside and be far removed from the house. The hill is covered with saguaros and native vegetation. Plat note 21 specifically states all natural vegetation will remain except that which must be removed for driveways and building pads, meaning only those necessary.
2. There is no hardship proven to necessitate a new driveway. The applicant says that the existing driveway is too steep but the applicant just purchased the home in the last year. The existing home and driveway with large turnaround has existed for almost 40 years. The plat explicitly allows for certain lots to have a circular driveway to mitigate site visibility issues with the road but this lot is not one of them.
3. The six houses mentioned in the staff report that do have access to Calle del Risco are downhill from the street and it serves as their only access. This new driveway will be uphill from the road posing some questions on how this will change drainage and runoff during storms. It will also change the traffic dynamic along Calle Del Risco. Some of those six houses will now look into a garage rather beautiful hillside desert.

We request that you deny the request to modify the plat by removing the one foot access easement for this lot.

JUL 08 26 AM 09:17 PCC CLK OF ED JMM

Property Owner

Address

Date

Keith Angle	4680 N. Calle Hanover	7-7-26
Joseph Ralston	5531 west Placita Acantilada	7-7-26
Jenice Cruzman/Oliver Clark	5641 W. Pasco de las Estrellas Tucson AZ 85745	7/7/26

CLERK'S NOTE:
COPY TO SUPERVISORS
COUNTY ADMINISTRATOR

DATE 7/8/26 EM

CC: DSD; Tom Drzazgowski, Deputy Director;
Rob Donaldson; Matthew Bacal

July 7, 2026

Honorable Chair Jennifer Allen
Members of the Pima County Board of Supervisors
Clerk of the Board of Supervisors

RE: Case Co 12-76-52 Rancho Del Cerro Subdivision, Plat Note modification to allow another driveway at 5532 W Placita Acantilada for a garage

Dear Chair Allen and Members of the Board of Supervisors,

We live in Rancho Del Cerro Subdivision adjacent to the subject property and just received notice of the proposed Special Action, Co 12-76-52, Plat Note Modification of the Rancho del Cerro Subdivision, Lot 430. We oppose the modification to lift the one foot no access easement along Calle del Risco. We would encourage the applicant to work within their existing building footprint and driveway to build their garage. Our reasons include:

1. This subdivision was developed to minimize grading, embrace native plant preservation and honor the hillsides of the Tucson Mountain area. The project site is one block from the Sweetwater Preserve where many in the neighborhood bike and hike. This is a prominent hilltop visible throughout the neighborhood. This new driveway and garage will scar the hillside and be far removed from the house. The hill is covered with saguaros and native vegetation. Plat note 21 specifically states all natural vegetation will remain except that which must be removed for driveways and building pads, meaning only those necessary.
2. There is no hardship proven to necessitate a new driveway. The applicant says that the existing driveway is too steep but the applicant just purchased the home in the last year. The existing home and driveway with large turnaround has existed for almost 40 years. The plat explicitly allows for certain lots to have a circular driveway to mitigate site visibility issues with the road but this lot is not one of them.
3. The six houses mentioned in the staff report that do have access to Calle del Risco are downhill from the street and it serves as their only access. This new driveway will be uphill from the road posing some questions on how this will change drainage and runoff during storms. It will also change the traffic dynamic along Calle Del Risco. Some of those six houses will now look into a garage rather beautiful hillside desert.

We request that you deny the request to modify the plat by removing the one foot access easement for this lot.

Property Owner

Address

Date

John Gilmore	5560 W. Paseo De Las Estrellas,	7/7/2026
Reginald McClendon	4190 N. Calle Del Risco	7/7/2026
Oscar Gomez	4154 N Calle Del Risco	7/7/2026
Gregory L. King	4178 N Calle del Risco	7/7/2026
Chitra Estrella	4136 N Calle del Risco	7/7/2026
Mary Chavez	4100 N Calle del Risco	7/7/2026

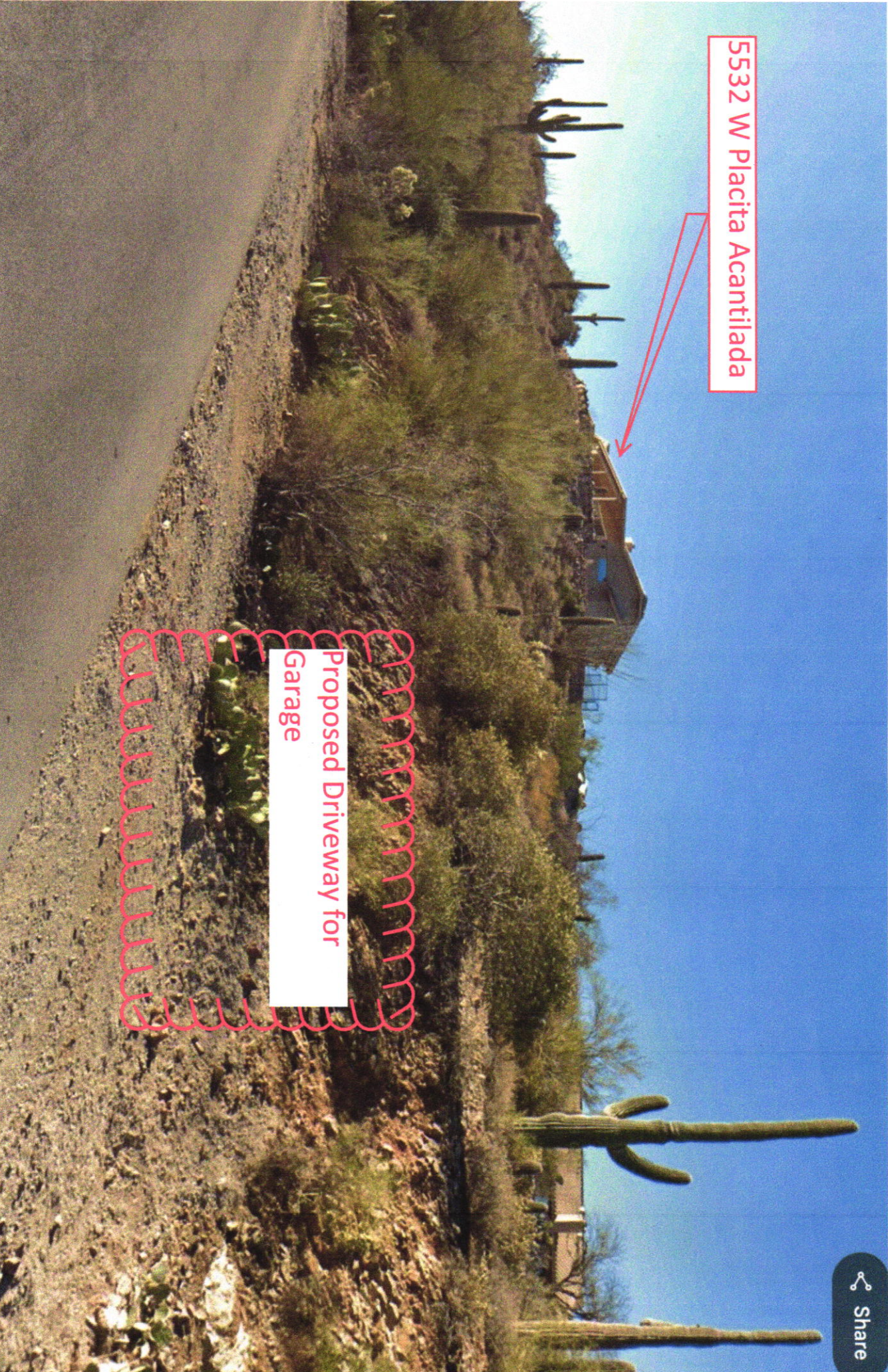

5532 W Placita Acantilada

Proposed Driveway for
Garage

Proposed New Driveway & Garage

