



## BOARD OF SUPERVISORS AGENDA ITEM REPORT

Requested Board Meeting Date: 9/7/2021

*\*= Mandatory, information must be provided*

Click or tap the boxes to enter text. If not applicable, indicate "N/A".

**\*Title:**

Approval of conveyance of dedicated drainageway to Town of Oro Valley

**\*Introduction/Background:**

The plat for the Rancho Catalina (Lots 107-221), a subdivision located in the Town of Oro Valley ("Town") was recorded on August 10, 1972. Per the plat all open space areas were dedicated to Pima County. In order to clear title the previously dedicated open space requires conveyance of the parcels from Pima County to the Town in order for ownership to be accurately reflected with the Pima County Assessor's Office. The subdivision is lying within Section 25, Township 12S, Range 13E, G&S.R.B. & M, Pima County, Arizona, as shown on the attached Location Map. File Sale-0098

**\*Discussion:**

The Town was incorporated in April 1974. All public dedications of open space per the platting process and subsequent annexation Ordinance No. (0)03-09 dated 05/07/03 should have transferred to the Town.

**\*Conclusion:**

This request has been reviewed by appropriate County and Town staff and all agree to conveying the open space parcels from Pima County to the Town.

**\*Recommendation:**

Staff recommends that the Board of Supervisors approve the conveyance to the Town. Upon approval staff will record a Quit Claim Deed.

**\*Fiscal Impact:**

Pima County will no longer be responsible for maintenance of the dedicated open space.

**\*Board of Supervisor District:**

☒ 1 ☐ 2 ☐ 3 ☐ 4 ☐ 5 ☐ All

Department: Real Property Services

Telephone: 724-6379

Contact: Tim Murphy

Telephone: *Click or tap here to enter text.*

Department Director Signature: \_\_\_\_\_

Date: 8/10/2021

Deputy County Administrator Signature: \_\_\_\_\_

Date: 8/18/2021

County Administrator Signature: \_\_\_\_\_

Date: 8/19/21

# Rancho Catalina Lots 107-221

## Legend

-  Parcels
- PCGPR Subdivisions
  -  Drainage Rights
  -  Misc Easement
  -  Other
  -  Property
  -  Road Rights
  -  Unknown
  -  Utility Rights
  -  Unassigned

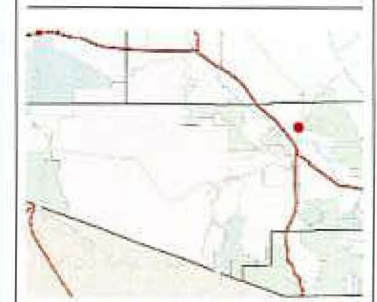
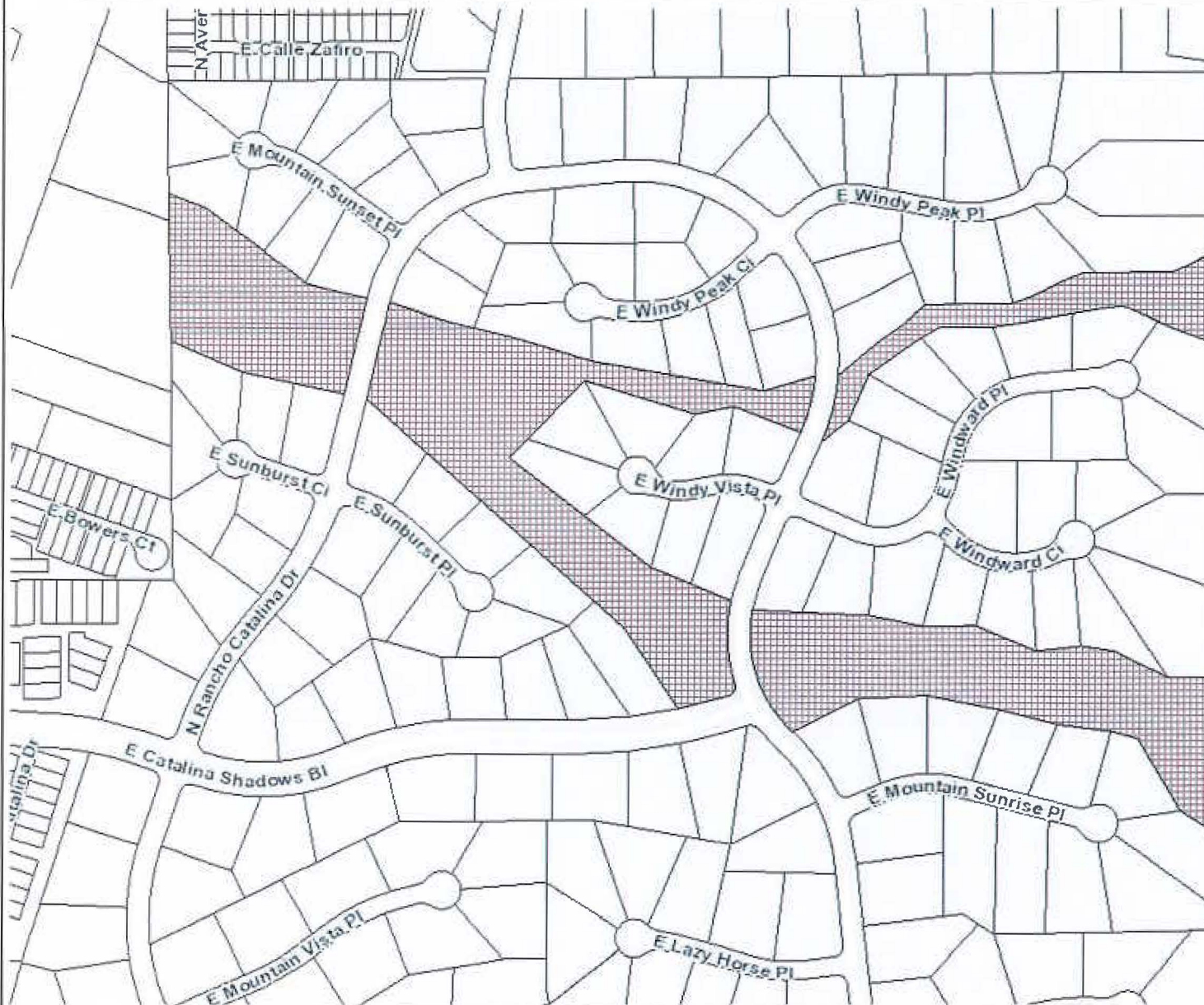

Parcel No.'s 225-17-222A & 222B

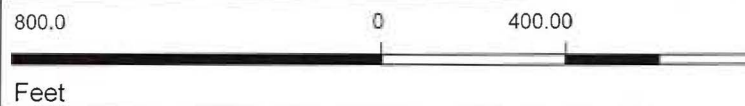

This map is static output from an internet mapping site and no warranty is expressed or implied as to the accuracy, reliability, currency or completeness of the data, and is for reference only

8/9/2021