



BOARD OF SUPERVISORS AGENDA ITEM REPORT

Requested Board Meeting Date: 9/7/2021

**= Mandatory, information must be provided*

Click or tap the boxes to enter text. If not applicable, indicate "N/A".

***Title:**

Consent for Sale of Surplus Property. RPS File: Sale-0091

***Introduction/Background:**

Staff asks the Board of Supervisors to consent to the sale of a portion of tax parcel 304-26-9670 ("the Property"). The Property is vacant land located on the west side of the I-19 Frontage Road, south of Continental Road. The Property to be sold has a size of 12,110 square feet. The Property was originally acquired for the I-19 Frontage Road right of way project.

***Discussion:**

The consent will authorize Real Property to proceed with the sale of the Property by auction to the highest bidder pursuant to A.R.S Section 11-251(9). County departments have been noticed and none have expressed a need for the Property.

***Conclusion:**

The Property will be auctioned pursuant to State Law and sold to the highest bidder.

***Recommendation:**

It is recommended that the Board of Supervisors authorize the sale of the Property.

***Fiscal Impact:**

The County will no longer have liability and maintenance responsibility for the Property and will receive revenue from the sale. The appraised value of the property as of June 18, 2021 is \$145,300.00. A \$1,000.00 administration fee will be added to the appraised amount for a total of opening bid amount of not less than \$146,300.00.

***Board of Supervisor District:**

☐ 1 ☐ 2 ☐ 3 ☒ 4 ☐ 5 ☐ All

Department: Real Property Services

Telephone: 724-6313

Contact: Rita Leon

Telephone: 724-6462

Department Director Signature: _____

Date: 8/5/2021

Deputy County Administrator Signature: _____

Date: 8/18/2021

County Administrator Signature: _____

Date: 8/19/21

LOCATION MAP

SECTION 22
TOWNSHIP 18 SOUTH
RANGE 13 EAST



SECTION 22 G&SRM
PIMA COUNTY, ARIZONA

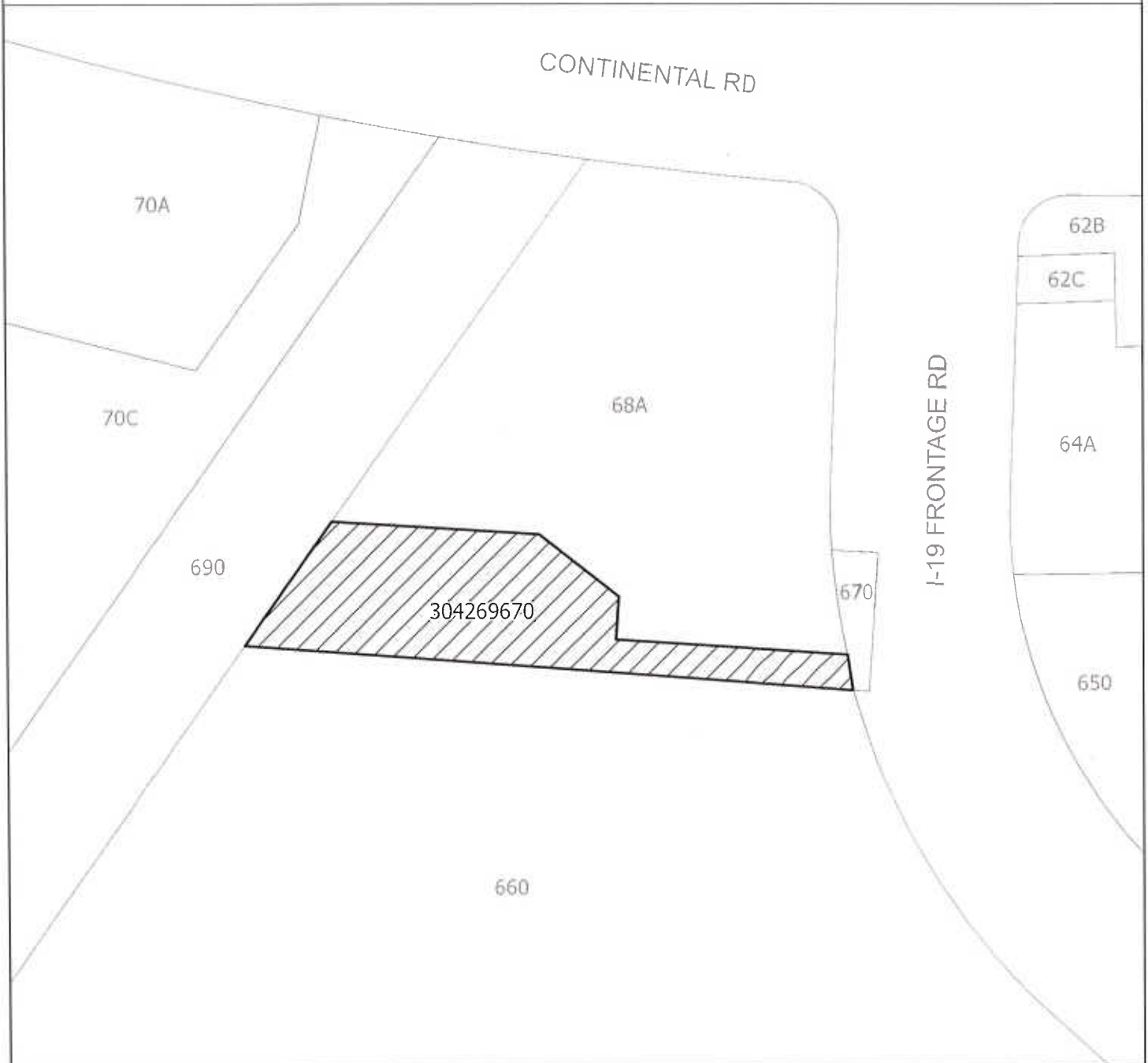

**PIMA COUNTY DEPARTMENT OF TRANSPORTATION
ENGINEERING INFORMATION MANAGEMENT**

21028

DRAWING NOT TO SCALE DRAWN BY: C HORNECK DATE: JUN 2021

LEGEND

 Subject Property:
Part of Parcel 304269670