



Melissa Manriquez
Deputy Clerk

Pima County Clerk of the Board

Julie Castañeda

Administration Division
130 W. Congress, 5th Floor
Tucson, AZ 85701
Phone: (520)724-8449 • Fax: (520) 222-0448

Management of Information & Records Division
1640 East Benson Highway
Tucson, Arizona 85714
Phone: (520) 351-8454 • Fax: (520) 791-6666

Tyler Daru Fenton
Reilly Craft Pizza and Drink
6700 N. Oracle Road, Suite 504
Tucson, AZ 85704

RE: Application for Permanent Extension of Premises/Patio Permit
License No.: 012100010400
Reilly Craft Pizza and Drink

Dear Mr. Fenton:

Notice is hereby given that the Pima County Board of Supervisors will hold a hearing in reference to the above Permanent Extension of Premises/Patio Permit application. Please be advised that the hearing has been scheduled for Tuesday, March 17, 2020, at 9:00 a.m. or thereafter, to be held at the following location:

Pima County Administration Building
Board of Supervisors Hearing Room
130 West Congress, 1st Floor
Tucson, Arizona 85701

If you have any questions pertaining to this hearing, please contact this office at (520)724-8449.

Sincerely,

A handwritten signature in black ink, appearing to read "Julie Castañeda", is written over a horizontal line.

Julie Castañeda
Clerk of the Board



Arizona Department of Liquor Licenses and Control
800 W Washington 5th Floor
Phoenix, AZ 85007-2934
www.azliquor.gov
(602) 542-5141

DLIC USE ONLY

CSR:

Log #:

APPLICATION FOR EXTENSION OF PREMISES/PATIO PERMIT

OBTAIN APPROVAL FROM LOCAL GOVERNING BOARD BEFORE SUBMITTING TO THE DEPARTMENT OF LIQUOR

Notice: Allow 30-45 days to process permanent change of premises

☒ Permanent change of area of service. A non-refundable \$50. Fee will apply. Specific purpose for change:

Restaurant is expanding into additional space.

☐ Temporary change (No Fee) for date(s) of: ___/___/___ through ___/___/___ list specific purpose for change:

1. Licensee's Name: FENTON TYLER DARU License#: 012100010400
Last First Middle
2. Mailing address: 6700 N ORACLE ROAD, SUITE 504 TUCSON AZ 85704
Street City State Zip Code
3. Business Name: REILLY CRAFT PIZZA & DRINK
4. Business Address: 7262 N ORACLE ROAD TUCSON AZ 85704
Street City State Zip Code
5. Email Address: TYLER@REILLYPIZZA.COM
6. Business Phone Number: PENDING Contact Phone Number: 520-797-6700
7. Is extension of premises/patio complete?
☐ N/A ☐ Yes ☒ No If no, what is your estimated completion date? 05 / 01 / 2020
8. Do you understand Arizona Liquor Laws and Regulations?
☒ Yes ☐ No
9. Does this extension bring your premises within 300 feet of a church or school?
☐ Yes ☒ No
10. Have you received approved Liquor Law Training?
☒ Yes ☐ No
11. What security precautions will be taken to prevent liquor violations in the extended area? We have a thorough list of
liquor protocols in our employee manual. We will observe the same high standards of care in the extended area as we do in all areas.

12. **IMPORTANT:** Attach the revised floor plan, clearly depicting your licensed premises along with the new extended area outlined in black marker or ink, if the extended area is not outlined and marked "extension" we cannot accept the application.

012100010400 KCFB

- ☐ Barrier Exemption: an exception to the requirement of barriers surrounding a patio/outdoor serving area may be requested. Barrier exemptions are granted based on public safety, pedestrian traffic, and other factors unique to a licensed premises. List specific reasons for exemption:

☐ Approval ☐ Disapproval by DLLC: _____ Date: ____/____/____

Notary

I, (Signature) [Signature], hereby declare that I am a **CONTROLLING PERSON/ AGENT** filing this notification. I have read this document and the contents and all statements are true, correct and complete.

State of Arizona }
County of Pima }

On this 19th Day of February, 2020 before me personally appeared Tyler Danu Fenton
Day Month Year (Print Name of Document Signer)

Whose identity was proven to me on the basis of satisfactory evidence to be the person who he or she claims to be and acknowledged that he or she signed the above/attached document.

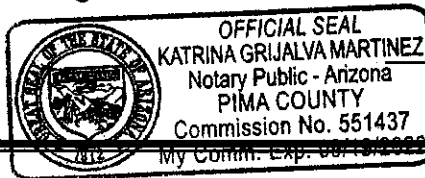

[Signature]
Signature of NOTARY PUBLIC

GOVERNING BOARD

After completion, and **BEFORE submitting to the Department of Liquor**, please take this application to your local Board of Supervisors, City Council or Designate for their recommendation. This recommendation is not binding on the Department of Liquor.

☐ Approval ☐ Disapproval

Authorized Signature Title Agency Date

DLLC USE ONLY

Investigation Recommendation: ☐ Approval ☐ Disapproval by: _____ Date: ____/____/____

Director Signature required for Disapprovals: _____ Date: ____/____/____

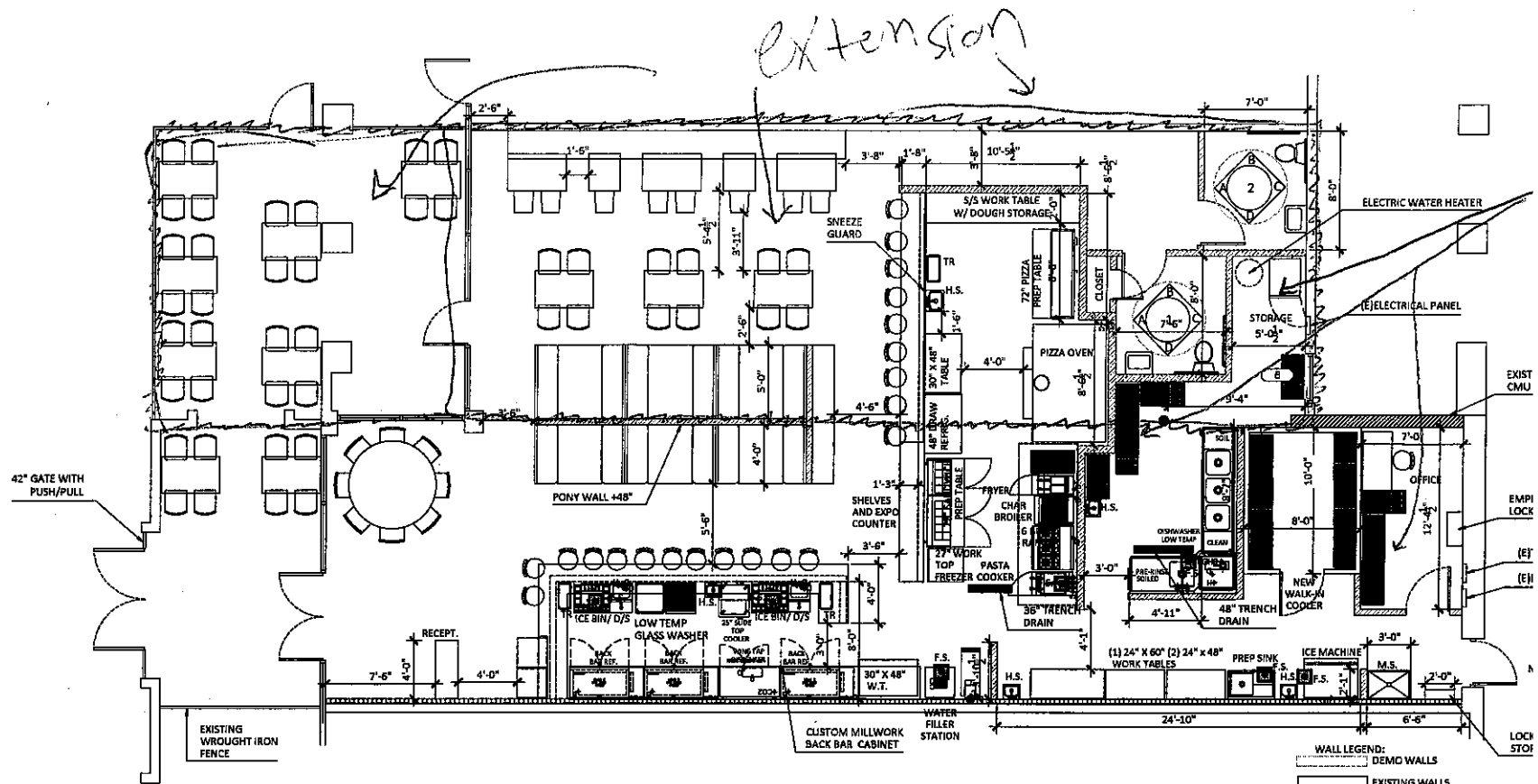

ROOM FINISH SCHEDULE													
ROOM NAME	FLOOR	WALL	CEILING	DOORS	BASE	W	S	E	W	CEILING	WALLS	DOORS	REMARKS
SEATING AREA													
KITCHEN													
STORAGE AREA													
BATHROOM													

FRP= FIBERGLASS REINFORCED PANEL TO 8'-0" HEIGHT
SPECIFIC FINISHES FOR QUALITY AND COLOR SHOULD BE
SELECTED BY OWNER AND COORDINATED WITH GENERAL
CONTRACTOR

PLAN NOTES:
ALL EXITS TO BE OPERABLE FROM THE INSIDE
WITHOUT THE USE OF A KEY OR SPECIAL KNOWLEDGE.
MANUALLY OPERATED EDGE OR SURFACE MOUNTED
FLUSH BOLTS AND SURFACE BOLTS ARE PROHIBITED.
EXISTING MAIN EXITS IDENTIFIED ON PLAN TO OUTSIDE
TO HAVE A SIGN READING "THIS DOOR MUST REMAIN
UNLOCKED AT ALL TIMES BUILDING IS OCCUPIED".
[WITH 1" HIGH LETTERS]. PROVIDE EXIT SIGNS AT
DOORS. THIS SPACE IS HANDICAPPED ACCESSIBLE.

ANSI A117.1/03-404.2.6 DOOR HARDWARE
HANDLES, PULLS LATCHES, LOCKS AND OTHER OPERABLE PARTS ON ACCESSIBLE
DOORS SHALL HAVE A SHAPE THAT IS EASY TO GRASP WITH ONE HAND AND DOES
NOT REQUIRE TIGHT GRASPING, PINCHING, OR TWISTING OF THE WRIST TO
OPERATE.
OPERABLE PARTS OF SUCH HARDWARE SHALL BE 34 INCHES MIN. AND 48 INCHES
MAX. ABOVE THE FLOOR.

IBC 1108.2.9.1 DINING SURFACES FIXED OR
BUILT-IN SEATING OR TABLES WHERE FIXED OR
BUILT-IN SEATING OR TABLES ARE PROVIDED IN
DINING AREA AT 5%, SHALL BE ACCESSIBLE
AND BE DISTRIBUTED THROUGHOUT THE
FACILITY

18 SEATS 5% ACCESSIBLE 1
ACCESSIBLE SEATS REQUIRED

ADA CLEAR FLOOR SPACE =

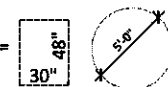

FLOOR PLAN

SCALE 1/4" = 1'-0"



J. J. [illegible]



Pima County Clerk of the Board
Julie Castañeda

Melissa Manriquez
Deputy Clerk

Administration Division
130 W. Congress, 5th Floor
Tucson, AZ 85701
Phone: (520) 724-8449 • Fax: (520) 222-0448

Management of Information & Records Division
1640 East Benson Highway
Tucson, Arizona 85714
Phone: (520) 351-8454 • Fax: (520) 791-6666

TO: Development Services, Zoning Division

FROM: Melissa Whitney
Administrative Support Specialist

DATE: February 21, 2020

RE: Zoning Report - Permanent Extension of Premises/Patio Permit

Attached find the application of:

Tyler Daru Fenton
d.b.a. Reilly Craft Pizza and Drink
7262 N. Oracle Road
Tucson, AZ 85704

Arizona Liquor License No. 012100010400

ZONING REPORT

DATE: 3/3/2020

Will current zoning regulations permit the issuance of the license at this location?

Yes ☒ No ☐

If No, please explain:

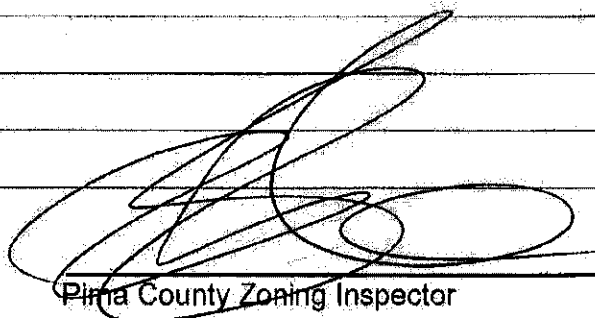

Pima County Zoning Inspector

When complete, please return to cob_mail@pima.gov

MAR 03 2020 10:05 PM CLK/CFD