

# Pima County Clerk of the Board

Julie Castañeda

Melissa Manriquez  
Deputy Clerk

Administration Division  
130 W. Congress, 5<sup>th</sup> Floor  
Tucson, AZ 85701  
Phone: (520)724-8449 • Fax: (520)222-0448

Management of Information & Records Division  
1640 East Benson Highway  
Tucson, Arizona 85714  
Phone: (520) 351-8454 • Fax: (520) 791-6666

May 2, 2019

Gregory Lee Wexler  
Whiskey Roads  
6088 W. Pavillions Drive, Ste No. 2  
Tucson, AZ 85743

RE: Arizona Liquor License Job No.: 59991  
d.b.a. Whiskey Roads

Dear Mr. Wexler:

Enclosed is a copy of the Affidavit of Posting relative to your Liquor License Application for a Series 12, Restaurant, which was received in our office on April 5, 2019. The Hearing before the Pima County Board of Supervisors has been scheduled for Tuesday, May 21, 2019, at 9:00 a.m. or thereafter, at the following location:

Pima County Administration Building  
Board of Supervisors Hearing Room  
130 W. Congress, 1st Floor  
Tucson, AZ 85701

Should you have any questions pertaining to this matter, please contact this office at (520)724-8449.

Sincerely,

A handwritten signature in black ink, appearing to read "Julie Castañeda", is written over a horizontal line.

Julie Castañeda  
Clerk of the Board

Enclosure



Arizona Department of Liquor Licenses and Control  
 800 W Washington 5th Floor  
 Phoenix, AZ 85007-2934  
 www.azliquor.gov  
 (602) 542-5141

# AFFIDAVIT OF POSTING

Date of Posting: 4-10-2019

Date of Posting Removal: 4-30-19  
 4-30

Applicant's Name: Whiskey Roads  
Wexler Gregory Lee  
 Last First Middle

Business Address: 2265 W. Ina Road Tucson 85741  
 Street City Zip

License #: 59991

I hereby certify that pursuant to A.R.S. 4-201, I posted notice in a conspicuous place on the premises proposed to be licensed by the above applicant and said notice was posted for at least twenty (20) days.

BRIAN J. RUTLEDGE PCSD Process Server 520-301-1212  
 Print Name of City/County Official Title Phone Number

B. J. Rutledge 5-1-2019 BR  
 Signature Date Signed

Return this affidavit with your recommendations (i.e., Minutes of Meeting, Verbatim, etc.) or any other related documents.  
 If you have any questions please call (602) 542-5141 and ask for the Licensing Division.

MAY 02 19AM 11 28 PCD KDF RD



# Pima County Clerk of the Board

Julie Castañeda

Melissa Manriquez  
Deputy Clerk

Administration Division  
130 W. Congress, 5<sup>th</sup> Floor  
Tucson, AZ 85701  
Phone: (520) 724-8449 • Fax: (520) 222-0448

Management of Information & Records Division  
1640 East Benson Highway  
Tucson, Arizona 85714  
Phone: (520) 351-8454 • Fax: (520) 791-6666

TO: Development Services, Zoning Division  
FROM: Alina Bárcenas  
Administrative Support Specialist Senior  
DATE: 4/5/2019  
RE: Zoning Report - Application for Liquor License

Attached is the application of:

Gregory Lee Wexler  
d.b.a. Whiskey Roads  
2265 W. Ina Road  
Tucson, AZ 85741

Arizona Liquor License Job No. 59990  
Series 7, Beer and Wine Bar  
New License  
Person Transfer ☒  
Location Transfer ☒

## ZONING REPORT

DATE: 4/10/19

Will current zoning regulations permit the issuance of the license at this location?

Yes ☒

No ☐

If No, please explain:

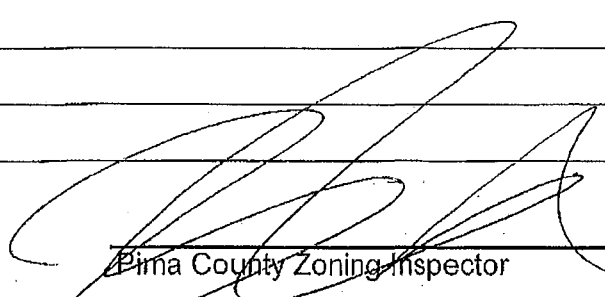
  
Pima County Zoning Inspector

When complete, please return to [cob\\_mail@pima.gov](mailto:cob_mail@pima.gov)

APR 10 19 09 55 POC CLK OF PD

● 19-08-9355

State of Arizona  
Department of Liquor Licenses and Control

Created 04/04/2019 @ 04:38:19 PM

Local Governing Body Report

**LICENSE**

Number:	07100504	Type:	007 BEER AND WINE BAR
Name:	WHISKEY ROADS		
State:	Pending		
Issue Date:		Expiration Date:	09/30/2019
Original Issue Date:	07/11/1983		
Location:	2265 W INA ROAD TUCSON, AZ 85741 USA		
Mailing Address:	6088 W PAVILLIONS DRIVE STE 2 TUCSON, AZ 85743 USA		
Phone:	(520)333-8522		
Alt. Phone:			
Email:	JOSHUA.ARVIZO@ICLOUD.COM		

Currently, this license has pending applications.

**AGENT**

Name:	GREGORY LEE WEXLER
Gender:	Male
Correspondence Address:	6088 W PAVILLIONS DRIVE STE 2 TUCSON, AZ 85743 USA
Phone:	(520)333-8522
Alt. Phone:	
Email:	JOSHUA.ARVIZO@ICLOUD.COM

**OWNER**

APR 05 15PM 01 05 PC CLK OF BD

ARCS

Name: WHISKEY ROAD LLC  
Contact Name: GREGORY LEE WEXLER  
Type: LIMITED LIABILITY COMPANY  
AZ CC File Number: 1947924 State of Incorporation: AZ  
Incorporation Date: 06/06/2019  
Correspondence Address: 6088 W PAVILLIONS DRIVE  
STE 2  
TUCSON, AZ 85743  
USA  
Phone: (520)333-8522  
Alt. Phone:  
Email: JOSHUA.ARVIZO@ICLOUD.COM

**Officers / Stockholders**

Name:	Title:	% Interest:
GREGORY LEE WEXLER	ManagingMember	100.00

**WHISKEY ROAD LLC - ManagingMember**

Name: GREGORY LEE WEXLER  
Gender: Male  
Correspondence Address: 6088 W PAVILLIONS DRIVE  
STE 2  
TUCSON, AZ 85743  
USA  
Phone: (520)333-8522  
Alt. Phone:  
Email: JOSHUA.ARVIZU@ICLOUD.COM

**APPLICATION INFORMATION**

Application Number: 59990  
Application Type: Location / Owner Transfer  
Created Date: 04/04/2019

**QUESTIONS & ANSWERS**

**007 Beer and Wine Bar**

- 1) If you intend to operate business while your application is pending you will need an interim permit pursuant to A.R.S.§4-203.01. Would you like to apply for an Interim Permit?  
No
- 4) Have you submitted a questionnaire? Each person listed must submit a questionnaire and mail in a fingerprint card along with a \$22. processing fee per card.  
Yes
- 5) Is the Business located within the incorporated limits of the city or town of which it is located?  
No
- 6) Does the Business location address have a street address for a City or Town but is actually in the boundaries of another City, Town or Tribal Reservation?  
Yes  
If Yes, what City, Town or Tribal Reservation is this Business located in?  
PIMA COUNTY

- 15) Please provide name, address, and Distance of nearest school.  
DONALDSON ELEMENTARY 2427 W INA RD TUCSON, AZ 85742 1100FT
- 16) Please provide name, address, and distance of nearest church.  
CASAS ADOBE BAPTIST CHURCH 10801 W LA CHOLLA BLVD TUCSON, AZ 85741  
1250 FT
- 17) Are you a tenant? (A person who holds the lease of a property; a lessee)  
Yes  
A Document of type SUPPLEMENTAL INFO is required.
- 18) Is there a penalty if lease is not fulfilled?  
Yes  
What is the penalty?  
\$15,000.00
- 19) Are you a sub-tenant? (A person who holds a lease which was given to another person (tenant) for all or part of a property)  
No
- 20) Are you the owner  
No
- 21) Are you a purchaser?  
No
- 22) Are you a management company?  
No
- 23) What is the total money borrowed for the business not including the lease?  
Please list lenders/people owed money for the business.  
ZERO
- 24) Is there a drive through window on the premises?  
No
- 25) Have you provided a diagram of your premises?  
Yes
- 26) If there is a patio please indicate contiguous or non-contiguous within 30 feet.  
CONTIGUOUS
- 27) Is your licensed premises now closed due to construction, renovation or redesign or rebuild?  
Yes  
If yes, what is your estimated completion date?  
07/01/19

MAIN ENTRY NO CHANGES EXISTING EXIT SIGNS

8505 Sq Ft

EXISTING EXIT WITH EMERGENCY LIGHTS  
AND PANIC HARDWARE

EXISTING EXIT WITH EMERGENCY LIGHTS  
AND PANIC HARDWARE

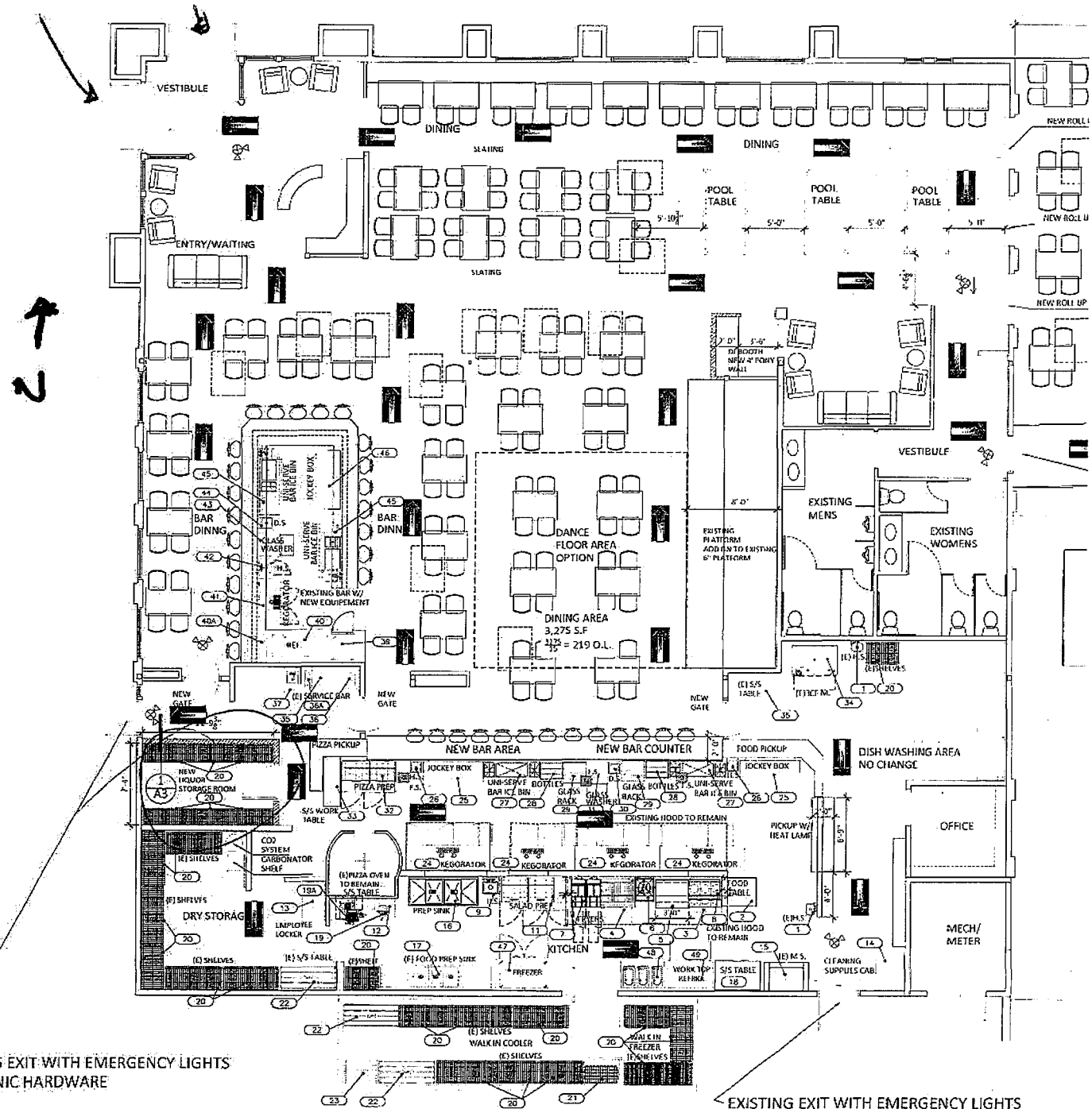

19 APR 4 11 PM 4 52