



Pima County Clerk of the Board

Julie Castañeda

Melissa Manriquez
Deputy Clerk

Administration Division
130 W. Congress, 5th Floor
Tucson, AZ 85701
Phone: (520)724-8449 • Fax: (520)222-0448

Management of Information & Records Division
1640 East Benson Highway
Tucson, Arizona 85714
Phone: (520) 351-8454 • Fax: (520) 791-6666

April 10, 2019

Janice Glenn Welker
Food Mart
2001 N. Ajo Gila Bend Highway
Tucson, AZ 85321

RE: Arizona Liquor License Job No.: 55867
d.b.a. Food Mart

Dear Ms. Welker:

Enclosed is a copy of the Affidavit of Posting relative to your Liquor License Application for a Series 09, Liquor Store, which was received in our office on March 13, 2019. The Hearing before the Pima County Board of Supervisors has been scheduled for Tuesday, May 7, 2019, at 9:00 a.m. or thereafter, at the following location:

Pima County Administration Building
Board of Supervisors Hearing Room
130 W. Congress, 1st Floor
Tucson, AZ 85701

Should you have any questions pertaining to this matter, please contact this office at (520)724-8449.

Sincerely,

A handwritten signature in black ink, appearing to read "Castañeda", is written over a horizontal line.

Julie Castañeda
Clerk of the Board

Enclosure



Arizona Department of Liquor Licenses and Control
800 W Washington 5th Floor
Phoenix, AZ 85007-2934
www.azliquor.gov
(602) 542-5141

AFFIDAVIT OF POSTING

Date of Posting: 3/19/19

Date of Posting Removal: 04/08/19

Applicant's Name: Food Mart
Welker Janice Glenn
Last First Middle

Business Address: 2001 N. Ajo Gila Bend Highway Ajo 85321
Street City Zip

License #: 55867

I hereby certify that pursuant to A.R.S. 4-201, I posted notice in a conspicuous place on the premises proposed to be licensed by the above applicant and said notice was posted for at least twenty (20) days.

Michael Yeagon #6701 Deputy 520-471-7878
Print Name of City/County Official Title Phone Number

[Signature] #6701 04/08/19
Signature Date Signed

Return this affidavit with your recommendations (i.e., Minutes of Meeting, Verbatim, etc.) or any other related documents.
If you have any questions please call (602) 542-5141 and ask for the Licensing Division.

AR 1019M1104PCAKDEFD



Pima County Clerk of the Board

Julie Castañeda

Melissa Manríquez
Deputy Clerk

Administration Division
130 W. Congress, 5th Floor
Tucson, AZ 85701
Phone: (520) 724-8449 • Fax: (520) 222-0448

Management of Information & Records Division
1640 East Benson Highway
Tucson, Arizona 85714
Phone: (520) 351-8454 • Fax: (520) 791-6666

TO: Development Services, Zoning Division
FROM: Melissa Whitney
Administrative Support Specialist Senior
DATE: 3/14/2019
RE: Zoning Report - Application for Liquor License

Attached is the application of:

Janice Glenn Welker
d.b.a. Food Mart
2001 N. Ajo Gila Bend Highway
Ajo, AZ 85321

Arizona Liquor License Job No. 55867
Series 09, Liquor Store
New License
Person Transfer ☒
Location Transfer ☒

ZONING REPORT

DATE: 3/14/19

Will current zoning regulations permit the issuance of the license at this location?

Yes ☒ No ☐

If No, please explain:

Pima County Zoning Inspector

When complete, please return to cob_mail@pima.gov

MAR 14 19 10 50 PCC CLK OF PCD
JW

State of Arizona
Department of Liquor Licenses and Control

Created 03/13/2019 @ 12:56:44 PM

Local Governing Body Report

LICENSE

Number: 09103600 Type: 009 LIQUOR STORE
Name: FOOD MART
State: Pending
Issue Date: Expiration Date: 10/31/2019
Original Issue Date: 11/13/2015
Location: 2001 N AJO GILA BEND HIGHWAY
AJO, AZ 85321
USA
Mailing Address: 2001 N AJO GILA BEND HIGHWAY
AJO, AZ 85321
USA
Phone: (520)387-5591
Alt. Phone: (520)387-5583
Email: AJOBROWSER@AOL.COM

Currently, this license has pending applications.

AGENT

Name: JANICE GLENN WELKER
Gender: Female
Correspondence Address: 2001 N AJO GILA BEND HIGHWAY
AJO, AZ 85321
USA
Phone: (520)387-5591
Alt. Phone: (520)387-5583
Email: AJOBROWSER@AOL.COM

OWNER

Name: A-MART LLC
Contact Name: JANICE GLENN WELKER
Type: LIMITED LIABILITY COMPANY
AZ CC File Number: L0802565-0 State of Incorporation: AZ
Incorporation Date:
Correspondence Address: 2001 N AJO GILA BEND HIGHWAY
AJO, AZ 85321
USA
Phone: (520)387-5583
Alt. Phone:
Email: AJOBROWSER@AOL.COM

Officers / Stockholders

Name: Title: % Interest:

LJ AND JG WELKER 1995 TRUST - TRUSTEE

Name: JANICE GLENN WELKER
Gender: Female
Correspondence Address: PO BOX 38
AJO, AZ 85321
USA
Phone: (520)387-5583
Alt. Phone:
Email: AJOBROWSER@AOL.COM

LJ AND JG WELKER 1995 TRUST - TRUSTEE

Name: LAMAR JAMES WELKER
Gender: Male
Correspondence Address: PO BOX 38
AJO, AZ 85321
USA
Phone: (520)387-5583
Alt. Phone:
Email: AJOCOPST@AOL.COM

A-MART LLC - MEMBER

Name: LJ AND JG WELKER 1995 TRUST
Contact Name: JANICE GLENN WELKER
Type: TRUST
AZ CC File Number: State of Incorporation:
Incorporation Date:
Correspondence Address: PO BOX 38
AJO, AZ 85321
USA
Phone: (520)387-5583
Alt. Phone:
Email: AJOCOPST@AOL.COM

MANAGERS

Name: BRUCE WILLARD OWENS
Gender: Male
Correspondence Address: PO BOX 38
AJO, AZ 85321
USA
Phone: (520)387-5583
Alt. Phone: (520)387-5591
Email: BWOAJAINS@AOL.COM

APPLICATION INFORMATION

Application Number: 55867

QUESTIONS & ANSWERS

009 Liquor Store

- 1) If you intend to operate business while your application is pending you will need an interim permit pursuant to A.R.S.§4-203.01. Would you like to apply for an Interim Permit?
No
- 4) Have you submitted a questionnaire? Each person listed must submit a questionnaire and mail in a fingerprint card along with a \$22. processing fee per card.
Yes
- 5) Is the Business located within the incorporated limits of the city or town of which it is located?
No
- 6) Does the Business location address have a street address for a City or Town but is actually in the boundaries of another City, Town or Tribal Reservation?
Yes
If Yes, what City, Town or Tribal Reservation is this Business located in?
PIMA COUNTY
- 15) Please provide name, address, and Distance of nearest school.
AJO HIGH SCHOOL
111 N WELL RD AJO AZ 85321
6 MILES
- 16) Please provide name, address, and distance of nearest church.
FULL GOSPEL FELLOWSHIP
1900 N 2ND AVE AJO AZ 85321
775FT
- 17) Are you a tenant? (A person who holds the lease of a property; a lessee)
No
A Document of type SUPPLEMENTAL INFO is required.
- 18) Is there a penalty if lease is not fulfilled?
No
- 19) Are you a sub-tenant? (A person who holds a lease which was given to another person (tenant) for all or part of a property)
No
- 20) Are you the owner?
Yes
- 21) Are you a purchaser?
No
- 22) Are you a management company?
No
- 23) What is the total money borrowed for the business not including the lease?
Please list lenders/people owed money for the business.
0
- 24) Is there a drive through window on the premises?
No
- 25) Have you provided a diagram of your premises?
Yes
- 26) If there is a patio please indicate contiguous or non-contiguous within 30 feet
NONE
- 27) Is your licensed premises now closed due to construction, renovation or redesign or rebuild?
No

Ownership Flow Chart

A-Mart L.L.C. dba Food Mart - Application for License No. 09103600
Arizona Corporation Commission Entity ID # L08025650
L. J. and J. G. Welker 1995 Trust - owner

↓

↓

L. J. and J. G. Welker 1995 Trust

↓

↓

Lamar J. Welker - Co Trustee	Janice G. Welker - Co Trustee
------------------------------	-------------------------------

↓

↓

Lamar J. Welker Beneficiary 50%	Janice G. Welker Beneficiary 50%
------------------------------------	-------------------------------------

19 MAR 13 14 PM 12:59

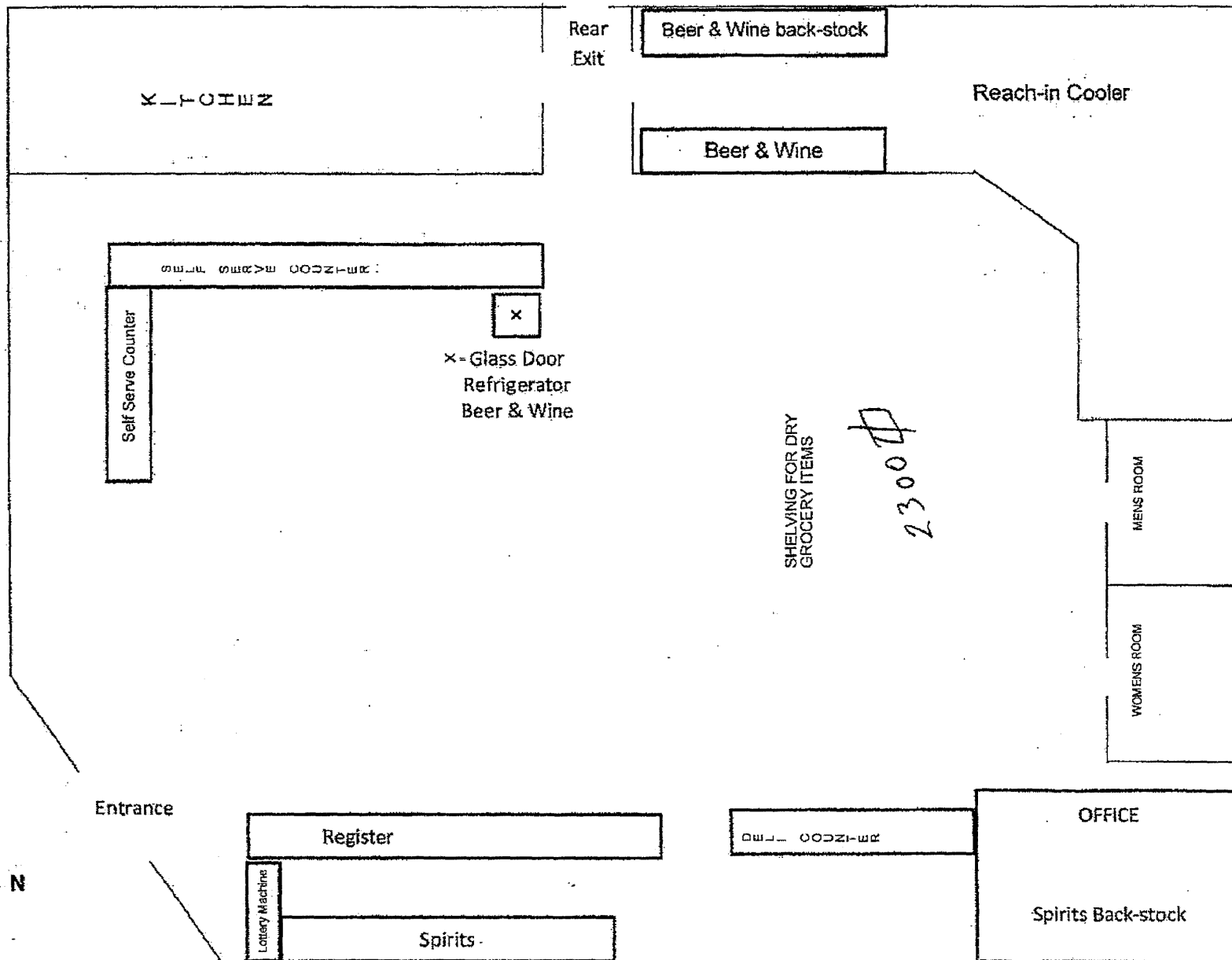

19 MAR 13 1:47 PM 1259