



BOARD OF SUPERVISORS AGENDA ITEM REPORT

Requested Board Meeting Date: May 2, 2017

Title: Resolution Authorizing Pima County to Condemn for La Cholla Boulevard: Overton Road to Tangerine Road
Project Code: 4LCBOT File: Pr-0035

Introduction/Background:

Pima County needs to acquire right of way and real property rights for the La Cholla Boulevard: Overton Road to Tangerine Road improvements (the "Project").

Discussion:

In the event the real property interests for the Project cannot be acquired through timely negotiations, Pima County may have to exercise its powers of eminent domain to acquire the necessary interests to construction the Project.

Conclusion:

The Pima County Attorney will be authorized to institute condemnation proceedings to acquire real property interests for the Project.

Recommendation:

Staff recommends that the Pima County Board of Supervisors approve the Resolution authorizing the Pima County Attorney to condemn real property interests, when necessary, for the Project.

Fiscal Impact:

N/A

Board of Supervisor District:

☒ 1 ☐ 2 ☐ 3 ☐ 4 ☐ 5 ☐ All

Department: Public Works Real Property Services Telephone: 724-6713

Department Director Signature/Date: [Signature] 4-5-17

Deputy County Administrator Signature/Date: [Signature] 4/21/17

County Administrator Signature/Date: C. Delaney 4/21/17

RESOLUTION NO. 2017- _____

**RESOLUTION OF THE PIMA COUNTY BOARD OF SUPERVISORS
AUTHORIZING THE PIMA COUNTY ATTORNEY TO CONDEMN
REAL PROPERTY INTERESTS WHERE NECESSARY FOR LA
CHOLLA BOULEVARD: OVERTON ROAD TO TANGERINE ROAD
IN SECTIONS 3, 4, 9, 10, 15, 16, 21, & 22 OF TOWNSHIP 12 SOUTH,
RANGE 13 EAST, G&SRM, PIMA COUNTY, ARIZONA**

The Board of Supervisors of Pima County, Arizona finds:

1. Pima County plans to make road improvements to 3.3 miles of La Cholla Boulevard; Overton Road to Tangerine Road (the "Project") located in Sections 3, 4, 9, 10, 15, 16, 21, & 22 of Township 12 South, Range 13 East, G&SRM, for the use and benefit of the public; and
2. The Board of Supervisors of Pima County finds it is necessary to exercise its powers of eminent domain, pursuant to A.R.S. § 12-1111, to acquire interests in the real property depicted in attached **Exhibit A** in order to construct the Project;

NOW, THEREFORE, BE IT RESOLVED that the Pima County Attorney be and is hereby authorized and directed to institute condemnation proceedings to acquire real property interests for the above described Project, from the real property shown on the attached **Exhibit A**.

Passed and adopted, this _____ day of _____, 2017.

Chair, Pima County Board of Supervisors

ATTEST:

Clerk of the Board of Supervisors

APPROVED AS TO FORM:

Deputy County Attorney

Board of Supervisors Approval:		S <u>3, 4, 9, 10, 15, 16, 21, & 22</u> /T <u>12S</u> /R <u>13E</u>	
Agent: gf	File #:PR-0035	Project Code #: 4LCBOT	P <input type="checkbox"/> De <input type="checkbox"/> Do <input type="checkbox"/> E <input type="checkbox"/>

EXHIBIT "A"

SECTIONS 3,4,9,10,15,16,21,22
TOWNSHIP 12 S, RANGE 13E

SUBJECT AREA

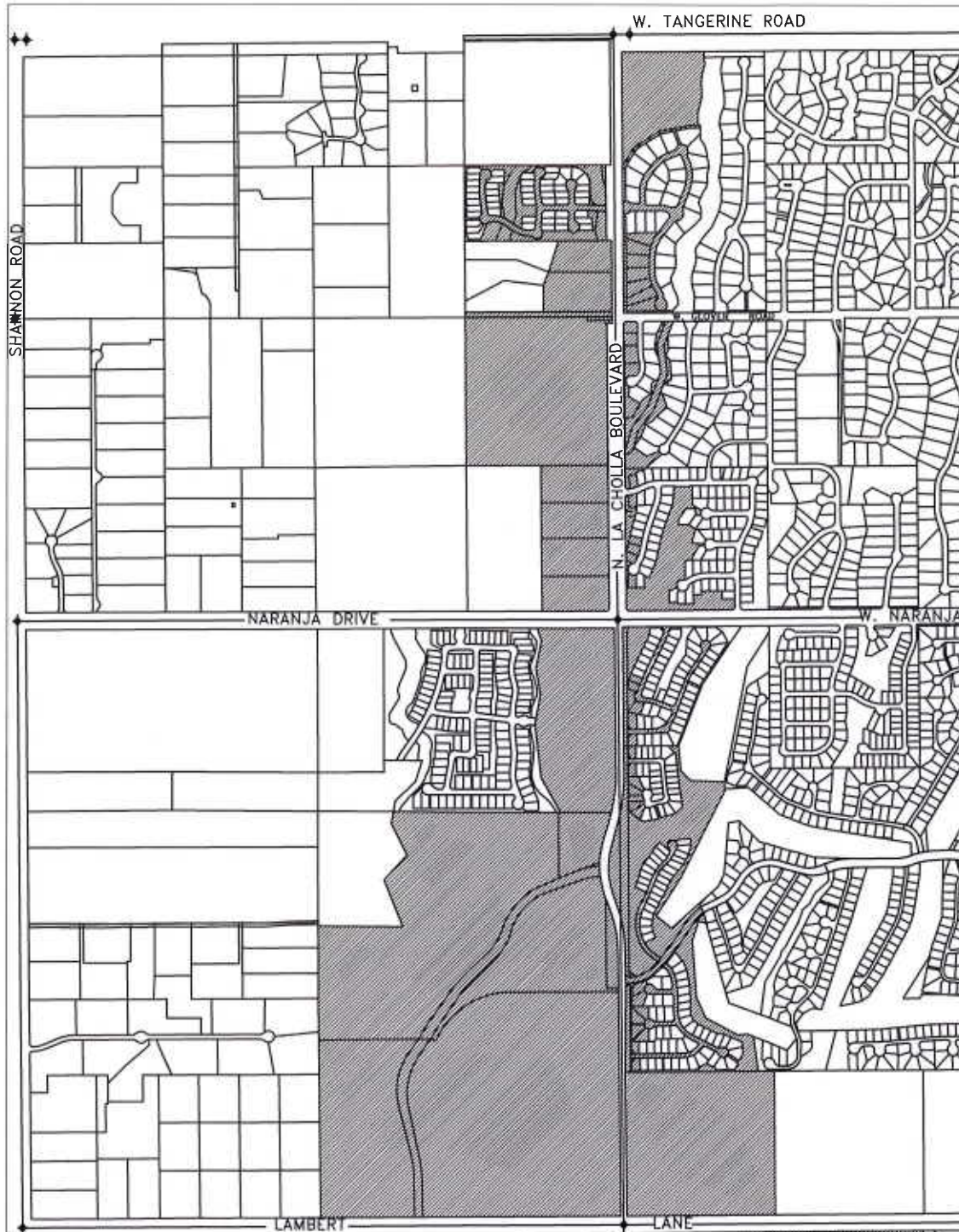
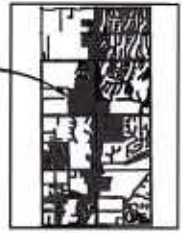

224-09-0850	224-11-061J
224-09-1780	224-11-061H
224-09-1680	224-11-061G
224-09-1690	224-11-060A
224-09-1700	224-09-0840
224-09-1710	224-09-0810
224-49-2020	224-11-038C
224-49-2010	224-11-038B
224-24-7530	224-11-037B
224-24-7520	224-08-4510
224-24-7510	224-11-2100
224-24-7500	224-11-2110
224-24-7490	224-08-4500
224-24-7620	225-06-018B
224-24-7310	225-06-017B
224-08-4520	224-08-4420
224-11-037F	224-08-4410
224-11-037G	224-24-765B
224-24-8180	
224-24-8190	
224-24-8080	
224-24-8110	
224-24-8090	
224-24-8100	
224-09-0380	
224-09-0200	
224-09-0190	
224-09-0180	
224-09-0170	
224-09-0160	
224-24-8240	
224-20-002B	
224-24-765A	
224-49-2470	
224-09-179A	
224-08-4520	
224-08-4470	
224-08-4460	
224-08-4450	
224-08-4440	
224-08-4430	
224-49-1940	
224-49-1930	
224-49-1920	
224-24-7950	
224-24-7960	
224-23-001A	
224-24-0120	
224-24-8220	
224-24-8230	
22424-8250	
224-20-001C	
224-20-001D	
224-24-7630	
224-24-7640	
224-49-2450	
224-49-2460	

SEE NEXT SHEET

 PARCELS TO BE ACQUIRED



2017003

PIMA COUNTY DEPARTMENT OF TRANSPORTATION
ENGINEERING INFORMATION MANAGEMENT

DRAWING NOT TO SCALE

DRAWN BY: BSMITH

DATE: JAN 2017

EXHIBIT "A"

SECTIONS 3,4,9,10,15,16,21,22
TOWNSHIP 12 S, RANGE 13E

SUBJECT AREA

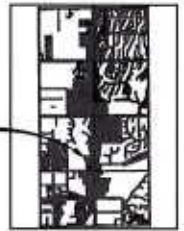

SEE PREVIOUS SHEET

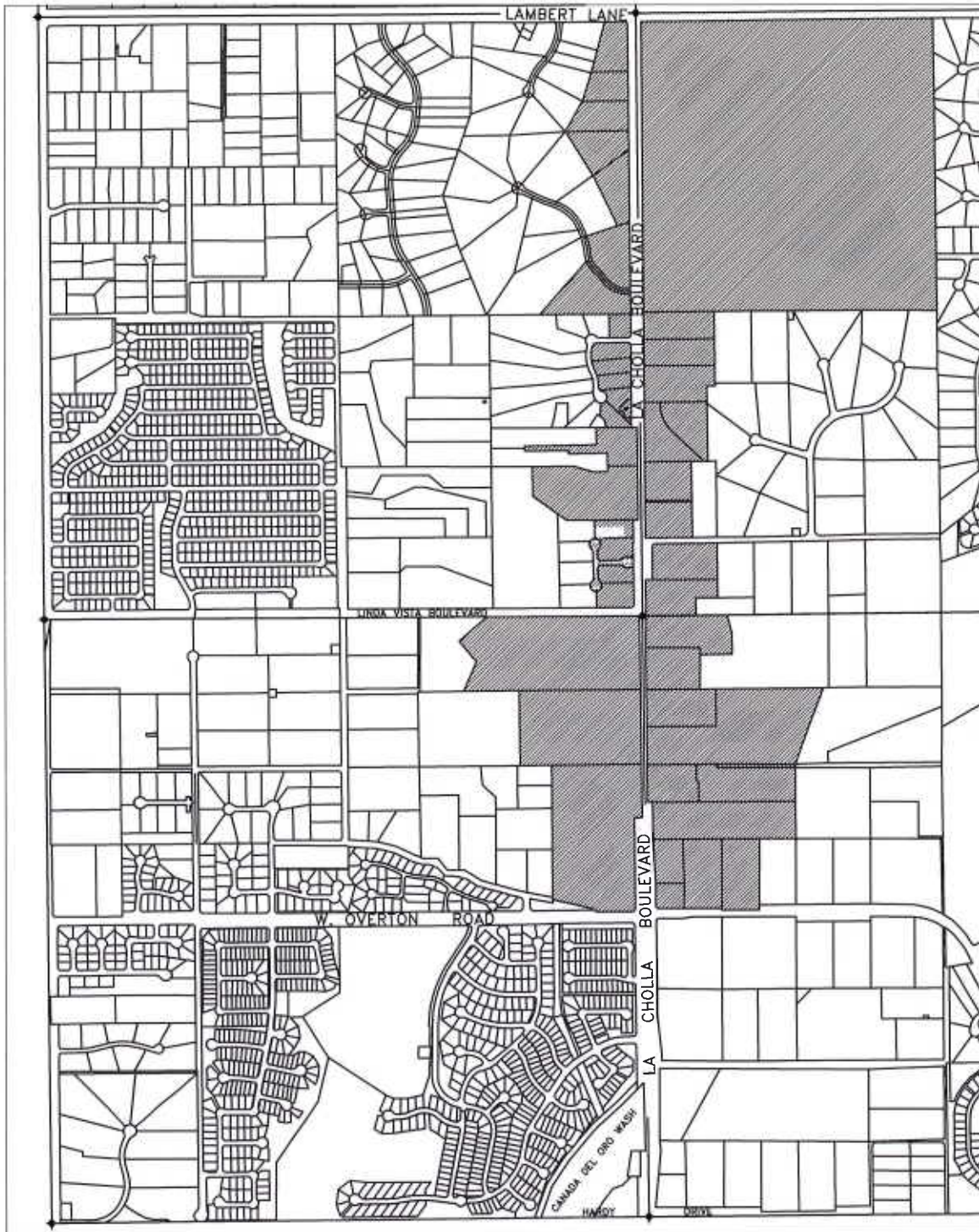

225-06-014A
225-06-016B
225-06-016A
225-06-0150
225-04-003N
225-06-0080
225-04-002B
225-06-0070
225-06-0060
225-04-001A
225-06-005D
224-39-016A
224-39-014A
224-41-0300
224-41-0310
224-41-0330
224-41-0240
224-41-0250
224-39-0110
224-39-0250
224-41-008B
224-41-005D
224-39-0100
224-39-0130
224-39-0060
224-41-0130
224-41-0230
224-41-0120
224-39-0050
224-41-0110
224-41-0100
224-41-0090
224-39-0040
224-39-0030
224-41-0220
224-39-0020
224-43-082A
224-43-071A
224-43-0700
224-43-0690
224-43-0680
224-43-0670
224-43-0660
224-23-001A
225-06-019A
225-06-0200

PARCELS TO BE ACQUIRED



2017003

PIMA COUNTY DEPARTMENT OF TRANSPORTATION
ENGINEERING INFORMATION MANAGEMENT

DRAWING NOT TO SCALE

DRAWN BY: BSMITH

DATE: JAN 2017

2 OF 2