



BOARD OF SUPERVISORS AGENDA ITEM REPORT **CONTRACTS / AWARDS / GRANTS**

Requested Board Meeting Date: January 3, 2017

or Procurement Director Award ☐

Contractor/Vendor Name (DBA): Arizona Game and Fish Department (AGFD)

Project Title/Description:

Resolution to Support County Application for Shooting Range Development Grant from AGFD for Clay Target Center

Purpose:

The County is applying for grant from AGFD to fund 50% of the construction cost to build shade ramada attachment to front of small office building at the County's Clay Target Center. As part of the application process AGFD requires formal resolution from the BOS in support of the grant application and associated construction project.

Procurement Method:

N/A

Program Goals/Predicted Outcomes:

Awarding of grant by AGFD to fund 50% of the construction cost for the shade ramada extension, and subsequent completion of the construction project. After completion, grant final report will be compiled and filed with AGFD.

Public Benefit:

A shaded gathering area will be constructed at the County's Clay Target Center to provide for customer and staff welfare and safety. Will make the facility more customer friendly during the hot summer months and during bad weather. Will also allow for covered outside meeting place for small groups using the facility.

Metrics Available to Measure Performance:

Budget Expenditure, Project Completion Schedule, Quarterly Reports to AGFD, and Final Report to AGFD.

Retroactive:

No

DEC 21 16W0437PCCLKOF-BD
pk

Original Information

Document Type: GTAP Department Code: _____ Contract Number (i.e., 15-123): 17*55
Effective Date: 07/2017 Termination Date: 06/2018 Prior Contract Number (Synergen/CMS): _____
☐ Expense Amount: \$ _____ ☒ Revenue Amount: \$ \$17,200.00
Funding Source(s): Grant would come Arizona Game and Fish Department Range Development Grant funds.
County funds for project will be from NRPR Department FY18 operating budget.

Cost to Pima County General Fund: _____

Contract is fully or partially funded with Federal Funds? ☐ Yes ☐ No ☒ Not Applicable to Grant Awards

Were insurance or indemnity clauses modified? ☐ Yes ☐ No ☒ Not Applicable to Grant Awards

Vendor is using a Social Security Number? ☐ Yes ☐ No ☒ Not Applicable to Grant Awards

If Yes, attach the required form per Administrative Procedure 22-73.

Amendment Information

Document Type: _____ Department Code: _____ Contract Number (i.e., 15-123): _____
Amendment No.: _____ AMS Version No.: _____
Effective Date: _____ New Termination Date: _____
☐ Expense ☐ Revenue ☐ Increase ☐ Decrease Amount This Amendment: \$ _____
Funding Source(s): _____

Cost to Pima County General Fund: _____

Contact: Leonard Ordway, Shooting Sports Program Manager

Department: NRPR Telephone: (520)724-5752

Department Director Signature/Date: *Ray Padilla* 12/15/16

Deputy County Administrator Signature/Date: *Steve H. [unclear]* 12/16/16

County Administrator Signature/Date: *C. [unclear]* 12/16/16
(Required for Board Agenda/Addendum Items)

RESOLUTION 2017 - ____

RESOLUTION OF THE PIMA COUNTY BOARD OF SUPERVISORS IN SUPPORT OF A GRANT APPLICATION TO THE ARIZONA GAME AND FISH DEPARTMENT FOR THE CONSTRUCTION OF A SHADE RAMADA AT THE SOUTHEAST REGIONAL PARK CLAY TARGET CENTER

The Board of Supervisors of Pima County, Arizona finds:

1. The Arizona Game and Fish Commission under A.R.S. § 17-231(B)(4) has authorized the establishment of a Shooting Range Development Policy providing financial assistance for the development of shooting ranges for public purposes.
2. The Arizona Game and Fish Department has responsibility for the administration of the policy and has established guidelines and procedures governing applications for funding assistance under the policy.
3. The Arizona Game and Fish Department's application procedures require the applicant's governing body to approve by resolution the submission of applications for shooting range assistance.
4. The Pima County Board of Supervisors, in accordance with A.R.S. §11-251, supports the application of Pima County to the Arizona Game and Fish Department for a Shooting Range Development Grant for construction of a shade ramada at the Southeast Regional Park Clay Target Center.

NOW, THEREFORE, BE IT RESOLVED that the Pima County Board of Supervisors:

1. Approves the filing of an application to the Arizona Game and Fish Department for a Shooting Range Development Grant for construction of a shade ramada at the Southeast Regional Park Clay Target Center.
2. Certifies that the project application is consistent and compatible with all adopted plans and programs for safe shooting range development.
3. Agrees that Pima County will comply with all procedures, guidelines and requirements of the Arizona Game and Fish Department as a part of the application process.
4. Acknowledges that the project scope and funding amount are subject to final approval by the Arizona Game and Fish Commission.

Leonard Ordway, Shooting Sports Program Manager for the Pima County Department of Natural Resources, Parks and Recreation, is hereby authorized and directed to act on behalf of Pima County with regard to this grant application by conducting negotiations with the Arizona Game and Fish Department and by executing and submitting documents, including but not limited to applications, agreements,

amendments, and other documents which may be necessary for the completion of the shooting range development project.

Passed, adopted and approved, this 3rd day of January, 2017.

Sharon Bronson, Chair, Pima County Board of Supervisors

ATTEST:

Clerk of the Board

APPROVED AS TO FORM



Tobin Rosen, Deputy County Attorney

12/23/16

Fill out and print this page and place it on the cover of your application.

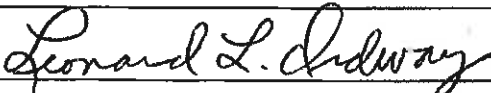
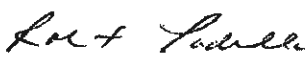
Arizona Game and Fish Commission Shooting Range Development Grants		<i>Department use only</i> Application # Date received Grant year	
Application cover page <i>Please type or print</i>			
Organization name	Pima County - Natural Resources, Parks & Recreation Department		
Project title	SE Regional Park Clay Target Center Shade Ramada		
Total project cost	\$ 37,845.00	Maximum grant award is 50% of total actual project cost.	
Total Grant Amount Requesting	\$ 17,200.00		
Brief description of the project	County will use Contractor to construct Ramada to fully cover existing concrete pad in front of Clay Target Center office, thus providing shaded sitting area and meeting location for customers.		
Project start date	07/1/17 (Upon Grant Award)	Project end date	01/31/18 (Upon Final Report to AGFD)
Contact person for this application	Leonard Ordway, Shooting Sports Program Manager		
Mailing address	Pima County - NRPR, 3500 W. River Rd., Tucson, AZ 85741		
Telephone	(520) 724-5752	Fax number	None
Email address	leonard.ordway@pima.gov		
Shooting Range information			
Name of range	Pima County SE Regional Park Clay Target Center		
Name of range manager	Butch Jensen	Phone Number	(520) 724-5750
Email address of Manager or contact	butch.jensen@pima.gov		
Mailing address of range or general range location	Mailing Address: Same as above for Pima County-NRPR River Rd. Office Range Location: 11295 S. Harrison Rd., Tucson, AZ 85749		
Legal description	SW	11	16 South
	Quarter	Section	Township
			15 East
			Range
I certify that the information contained in this grant application is accurate. If awarded a grant, our organization will abide by the requirements of the Arizona Game and Fish Department. I acknowledge that failure to meet the requirements of the grant program will result in the forfeiture of grant funds.			
Signature of person who prepared the application			Date 12/14/16
Printed name of individual above	Leonard Ordway, Shooting Sports Program Manager		
Signature of the president of the applicant organization			Date 12/15/16
Printed name of individual above	Chris Cawein, Department Director		

Application checklist

A completed application checklist must accompany your grant application. Copy or remove this page, then initial each item you have attached to your application. Incomplete applications are ineligible for funding.

- ☒ Application cover page
- ☒ Checklist
- ☒ Project description
- ☒ Project plans
- ☒ Reasonable public access and fees
- ☒ Range master plan
- ☒ Location map
- ☒ Public benefit information
- ☒ Budget worksheet
- ☐ Yes, project would still be completed if only partial funding was granted
- ☒ Insurance certificate
- ☐ Board resolution in support of the application
- ☒ Arizona GAO-W-9 form
- ☒ Control and tenure statement
- ☒ State Historical Preservation Office (SHPO) Certificate
- ☐ Two complete sets of the application and support documents

2017 AGFD Range Development Grant Application

Applicant: Pima County – Natural Resources, Parks and Recreation Department

Project: SE Regional Park Clay Target Center Shade Ramada

Project Description

Our project plan is to construct an approximate 30' x 30' ramada canopy to fully cover an existing concrete slab in front of the County's Clay Target Center small office building. The ramada will replace a very small covering in front of the office that currently only provides weather coverage for the cashier's window area. The existing concrete slab in front of the office provides adequate room for tables and seating by customers, but generally receives minimal extended seating use because there is no shade over it, and it does not afford the means for seated guests to remove themselves from the weather elements.

The new ramada will afford shooters as well as spectators a place to sit and relax between rounds or when waiting for or watching shooters. Because of the facility's use by youth group (BSA, 4H and SCTP) shooters, we often have non-shooting parents having no place to sit on property out of the sun. The new covered area will also allow small groups to have a place to gather and meet prior to shooting, after shooting, or in association with facility events. In general customer welfare and shooter safety will increase as they will have a covered shaded area and gathering spot to remove themselves from extended sun and/or bad weather exposure, and a nice place to sit down and rest between clay target rounds. A rested and relaxed shooter generally shoots better and is safer. This is especially important for the older shooters who frequent our shooting facility.

The County's Clay Target Center makes up part of the County's SE Regional Shooting complex, and is situated in the Vail-Corona de Tucson area adjoining the County Fairgrounds southeast of Tucson city proper. Visitors to the facility come from across the Tucson area with a majority coming from the southeastern Tucson basin. Population in and around the Tucson area is roughly three-quarters of a million people. During the winter months the facility sees its peak use; plus, it serves as a complimentary local practice facility for the Tucson Trap and Skeet Club Range located to the southwest of Tucson. Currently the Clay Target Center is receiving about 3,000 visitors per year, and is only open to public shooting for half days on weekends. Having an enhanced covered area for guests to sit and rest at will allow the County the opportunity to consider extended public shooting hours, especially during the cooler part of the year.

Clay target shooters of all experience levels as well their non-shooting guests will benefit from the project. Monthly our facility is used by BSA, 4H and SCTP Youth Trap and Skeet

Shooters who come from Pima, Cochise and Santa Cruz Counties, along with their coaches and parents. BSA holds their annual shotgun merit badge qualification at the facility, and 4H holds their annual Southeastern Arizona Trap and Skeet Shoot at the facility. Tucson area Senior Olympics Trap and Skeet Competition Events are conducted during January at the Clay Target Center. During the late summer and fall of the year we see an influx of hunters who come to renew and hone their shotgun shooting skills in preparation for migratory and upland bird seasons. Most recently our facility has begun to offer league shooting during the spring and late fall for both trap and skeet shooting, so with the new ramada covering we will have a place to conduct league meetings. And finally, small groups associated with local churches and companies have begun to use our facility for fun shoots and small charity events; again the new ramada will afford these small groups a meeting location.

Schedule of Deliverables:

July 2017 –	Awarding and acceptance of Grant from AGFD
July–September 2017 –	Contractor completing final plans and engineering to obtain Permit(s); final plans submitted to AGFD for approval
October 2017 –	Quarterly report to AGFD
October–November –	Project construction by contractor and painting by County staff and volunteers
December 2017 –	Project completion and inspection by AGFD
January 2018 –	Final project report to AGFD

Funding:

If the grant is approved for 50% of the construction costs, the County plans to pay for the final project planning / engineering / permitting, and the remaining 50% of the construction costs using our Natural Resources, Park and Recreation Department FY2018 budgeted operation and maintenance funds. Any subsequent enhancement to the ramada that is deemed necessary will be covered by our Shooting Sports Program budgeted operation and maintenance funds. The project as presented in attached proposal and draft concept plans will meet the necessary customer welfare needs, and enhance current weekend and by agreement operations at the Clay Target Center. Plus, the design allows for future enhancement or adjustment of the ramada to address operation expansion in the future.

Without the grant for 50% of the construction costs of the ramada, it is unlikely that this project will be completed in the foreseeable County budget future.

Information and Outreach for the Completed Project:

The County plans to place a sign with logos (AGFD and Pima County – NRPR) on or near the new ramada covering acknowledging and thanking the AGFD for the project. An article with photos and logos will be completed after the project is complete and disseminated externally to the public, as well as internally to County employees, using the County's electronic newsletter processes. And finally, as part of any public gathering and presentation that is done in association with the ramada, staff will verbally thank and acknowledge AGFD for the project, and express the value to the shooting public of the AGFD Range Development Grant process.

Community Support:

The need for an enlarged and enhanced covered resting and meeting area in association with the small office at our Clay Target Center is one of the most common comments that we get from both external and internal customers. So in general all customers using the facility now and in the future would support this project. Attached you will find formal letters from local 4H, BSA and SCTP leadership expressing the need and support for this project and the grant awarding by AGFD.

Project Plan

Please refer to attached project proposal and draft concept plans from an outside contractor that the County could use for the project. Upon grant award the County will pay for and have the selected contractor complete final and formal engineered plans, and acquire building permit for the project. All will be submitted to AGFD for final approval and construction authorization.

Reasonable Public Access and Fees

Hours and Days of Operation for the Clay Target Center are as follows:

7:00 a.m. – 11:00 a.m.; May 1 – October 31

9:00 a.m. – 1:00 p.m.; November 1 – April 30

Saturday and Sunday; Closed on all Pima County holidays

At the Clay Target Center there is no membership fee, but rather a per round of trap or skeet target range fees as follows:

Daily Range Fees:

General Public - Day Pass: \$8 per 25-target round

General Public Discount Multi-Use Pass: \$140 per 20 25-target rounds (7 per 25-target round)

College Level SCTP: \$6 per 25-target round

Organize Youth - SCTP, 4H and BSA: \$3 per 25-target round

For groups and special events outside of normal public shooting times, a special use agreement is setup for the group and they generally shoot at the reduced Discount Multi-Use Pass of \$140 per 20 25-target rounds (or \$7 per 25-target round).

Master Plan

The Clay Target Center is situated in proximity and association with the County's Shooting and Archery Ranges to the west, with all three together making up the Pima County SE Regional Shooting Complex situated on 3/4 Section of County owned land. The complex is situated in association with the County Fairgrounds and Motorsports Park to the southeast of Tucson. Please refer to attached master plan over view picture.

The Clay Target Center is new in design, constructed per NRA standards, and opened in 2013. The range is staffed and supervised by NRA trained County Rangemasters. It has six fields - three are for trap shooting, and the other three fields are combination fields for shooting either trap or skeet. Trap machines are from Pat Trap and skeet machines are from Mattarelli, with the system being controlled via Duematic hardware and software. Trap machines can either be activated manually or via Canterbury voice release system; the skeet machines are activated manually. Additionally, there are a parking lot, small office/cashier building with front cashier window area shade, small field shade ramadas with bench seating, uncovered concrete picnic tables, restroom facility, target storage container and a patterning board area.

The Rifle/Pistol Range is situated across Harrison Road to the west of the Clay Target Center. The Shooting Range is relatively new, built to NRA standards and opened in 2004. The main public portion of the Shooting Range offers 18 covered shooting positions from 5 to 50 yards for small bore and handgun, and 12 covered shooting positions for rifle/big bore at 100 and 200 yards. Additionally, there is a separate Education Range that provides 30 covered shooting positions from 5 to 50 yards primarily for small bore and handgun. Target

frames are provided. The range is open to the public on Thursday through Sunday, and by reservation; it is staffed and supervised by NRA trained County Rangemasters. Additionally, there are a parking lot, education center with administrative offices (230-person occupancy), small office/cashier building, rangemaster office, shop area, equipment storage bay, 5 mini-mobile type storage containers and restroom facility.

The Archery Range is also situated across Harrison Road to the west of the Clay Target Center and north of the Rifle/Pistol Range. The Archery Range is new in design and construction and opened in 2013. The range offers 30 distance marked shooting positions from 10 yards to 100 yards, and with Pacific Bow Butt stacked targets as a backstop for each shooting lane. Targets are provided on the bow butts. The entire range is surrounded by earthen berms. The range is open to the public on Thursday through Sunday, and by reservation; it is staffed and supervised by NRA trained County Rangemasters. Additionally, there are a parking lot, small shade ramadas with bench seating and restroom facility. For beginner archery training the education center noted above for the shooting range is setup with 10 indoor 20 yard shooting positions with Hips Archery Targets and safety curtain.

Location Map

Please refer to attached Pima County map depicting the project location in the County, and the attached aerial view of the Clay Target Center depicting the location of the project at the facility. As noted above the Clay Target Center is one part of the County's SE Regional Park Shooting Complex, and the shooting range complex is one component of the County's SE Regional Park and Fairgrounds Complex. The shooting range complex is either surrounded by County owned land or expansive open desert State Land. No proximal development is underway or planned in the foreseeable future for the open desert State Land situated to the west and north of the County owned land on which the shooting complex sits.

Public Benefit Information

The entire SE Regional Park Shooting Complex was created, developed and is currently operated to provide an array of safe and responsible public shooting experiences in association with excellent customer service by County Staff. Program focus is on public shooting and to provide an atmosphere and experience to encourage young and new shooters, while at the same time providing for experienced shooters. The facility is staffed by NRA credentialed rangemasters supported by a diverse cadre of about 60 active volunteers.

In 2015 the Pima County shooting complex had approximately 22,000 visitors - 18,000 for the Shooting Range, 3,000 for the Clay Target Center and 1,000 for the Archery Range. Events included weekly open public shooting, monthly Hunter Education classes/field days in association with Arizona Game & Fish Department personnel and volunteers, monthly 4H practice and annual shoot involving all three ranges, regular BSA merit badge training and qualifications involving all three ranges, regular Clay Target Center use by Scholastic Clay Target Program athletes (youth and college level) for practice and training, Trap and Skeet League, Annual Senior Olympic Shotgun/Pistol/Rifle competitions, and charity fundraising events by local businesses. Beginning in September 2016 the BSA and University of AZ Scholastic Action Pistol Program groups began using our Shooting Range facility. And finally, we have an annual Volunteer Celebration at the County Shooting Complex in February wherein we host all of our volunteers and their families allowing them to use the ranges free of charge in return for the about 6,000 hours of time per year that the volunteers donate to the County Shooting Sports Program.

Our Education Building and Range supports training and qualification for Arizona Game and Fish Department officers, local law enforcement officers, local security organizations, a local Arizona Ranger group, local chapter of The Well-Armed Women, and contract firearms training vendors. And finally as a well-respected member of our local community a couple of businesses (and ACE Hardware and a local gun shop) provide discounts to shooters who purchase shooting accessories and ammunition from them to use at our range facilities.

Every year since our facility has opened and subsequently expanded, customer use has grown. We are respected for providing a safe, responsible and affordable facility to shoot at. And every improvement that we have made (including the planned ramada) has been focused to benefit and improve customer experience and welfare at our shooting complex.

Budget Worksheet

See attached completed form.

Partial Funding

This project will NOT be completed in the foreseeable County budget future if less than 50% of the construction cost is granted. Box on checklist is NOT marked accordingly.

Insurance Certificate

See attached Pima County Certificate of Self-Insurance specific to this project and issued with AZ Game & Fish Department noted as the Certificate Holder.

Board Resolution in Support of the Application

See attached notarized and signed formal resolution passed by the Pima County Board of Supervisors at their January 3, 2017, public meeting in support of the grant application and project.

Arizona GAO-W9 Form

See attached.

Control and Tenure Statement

See attached copy of the legal document depicting 1981 real property acquisition by Pima County Board of Supervisors from the State of Arizona of the land that the Clay Target Center was developed on.

State Historical Preservation Office (SHPO) Certificate

Attached are the completed AGFD SHPO Consultation form, copy of Archaeological Survey completed for the Clay Target Center development area, and associated SHPO Determination of Eligibility Letter for the Clay Target Center development. Survey work and SHPO consultation concludes that no historic properties would be affected by construction and subsequent development of the Clay Target Center.

Pertinent to undeveloped County and State owned property near the shooting complex, there is archeological site sensitive information contained in both the attached Archeological Survey Report (Attachment 10.C.) and the SHPO Letter (Attachment 10.D.). This information is protected pursuant to State Law and should not be subject to subsequent public records dissemination relative to this grant application process. The County should be consulted relative to the security of this archeological site information should any potential for public records dissemination associated with it arise.

List of Attachments:

1. Community Support
 - A) BSA Leadership Letter
 - B) 4H Leadership Letter
 - C) SCTP Leadership Letter
2. Project Plan – Contractor Proposal and Draft Concept Structural Drawings
3. Master Plan – Shooting Complex Aerial Overview Picture
4. Location Maps
 - A) Project Location in Pima County
 - B) Aerial View of Project Location at the Clay Target Center (same for SHPO below)
5. Budget Worksheet
6. Insurance Documentation
7. Pima County Board of Supervisors Resolution of Support
8. Pima County W9 Form
9. Property Ownership Documentation
10. SHPO Consultation Information
 - A) AGFD SHPO Consultation form
 - B) Aerial View of Project Location at the Clay Target Center (same as location map above)
 - C) Copy of Archaeological Survey for the Clay Target Center Development
 - D) SHPO Determination of Eligibility Letter (No Historic Properties Affected) for the Clay Target Center Development

Attachment 1. Community Support

A) BSA Leadership Letter

B) 4H Leadership Letter

C) SCTP Leadership Letter



BOY SCOUTS OF AMERICA
CATALINA COUNCIL

Attachment I.A.

December 9, 2016

To: Arizona Game and Fish Department
Re: Letter of Support for Pima County, AZ to fund a portion of the cost of a shade ramada extension

Dear Sirs,

The purpose of this letter is to provide support to Pima County of Arizona's grant application to fund 50% of the construction cost of a shade ramada extension to the front of the Clay Target Center office building. The ramada will cover the entire concreted area in front of the office building providing shelter from the sun and weather, as well as provide a covered meeting area for groups like Scouting to use the Clay Target Center.

The Catalina Council, Boy Scouts of America headquartered in Tucson, AZ and serving all of Southern Arizona has a wonderful relationship with Pima County and the Southeast Regional Park Shooting Range. We have a cooperative agreement allowing Scouts to participate in shooting activities year-round at Southeast Regional Park Shooting Range. We have organized many Scouting activities at the Range teaching Scouts how to safely shoot a number of different types of guns.

The Catalina Council, Boy Scouts of America supports Pima County's grant application to fund 50% of the construction cost of this shade ramada extension. This new ramada would greatly enhance their facilities and our programs at the range.

The Catalina Council, Boy Scouts of America highly values its partnership with Pima County and the Southeast Regional Park Shooting Range. Thank you for the opportunity to provide support to their grant application.

Sincerely,

Ken Tucker
Scout Executive

5049 E. Broadway Blvd.
Suite 200
Tucson, AZ 85711-3636
Office 520.750.0385
Toll Free 800.765.2543
Fax 520.750.0815
www.catalinacouncil.org

Prepared. For Life.™





John Whiteside
4450 East Cooper Street
Tucson, Arizona 85711
(520) 321-1916 * Email: arizona4hshootingsports@yahoo.com

December 10, 2016

Arizona Game and Fish Department
5000 W. Carefree Highway
Phoenix, AZ 85086-5000

Dear Sir/Madam,

Please accept my recommendation that the Department award a Range Development Grant to Pima County's Southeast Clay Target Facility to fund 50% of the construction of a shade ramada. The ramada will extend the shaded area to all of the concrete slab in front of the office area, increasing the area for shooters to get out of the sun and weather. The cover will also provide an area for groups such as 4-H to hold meetings and instructional sessions out of the sun, such as the recent 4-H instructor training held at the clay target facility. Any youth shooting program entails engaging the parents as well as the youth. Providing a comfortable place for parents to watch their children will help keep parents supporting the program. The ramada will help in recruiting youth for Arizona's 4-H Shooting Sports program as well as to keep current members enthusiastic about shooting sports.

The Clay Target Facility hosts monthly practices, county matches, and state matches for 4-H. The support that Pima County has given 4-H and other youth groups shows that youth programs are a top priority. The staff run an outstanding program; there is no better place for youth to experience shooting sports. I can think of no better investment than one to attract more youth shooters to the Pima County Southeast Clay Target Facility.

I enthusiastically encourage the Department to support the construction of the ramada. This will provide valuable help to 4-H and the Pima County Clay Target Facility to provide the best possible shooting sports experience for youth. Please do not hesitate to contact me if there are any questions or if further information is desired.

Sincerely,

John Whiteside, State Coordinator
Arizona 4-H Shooting Sports Education

December 13, 2016

Arizona Game and Fish Dept.
5000 W. Carefree Hwy.
Phoenix, AZ 85086

To whom it may concern,

My name is David Huelsman, and I am the Head Coach of the Tucson Shooting Stars. We are a youth shotgun program, and a member of the Scholastic Clay Target Program, (SCTP) and the Scholastic Shooting Sports Foundation (SSSF). Our team consists of approximately 50 youth, ages 9 through 18, and 15 volunteer coaches.

I am writing to you in support of the Pima County Southeast Clay Target Center, and their application for a range development grant from the Arizona Game and Fish Department to assist in funding a project to build a shade Ramada extension to the existing Clay Target Center office building at their facility. This facility, run by the Pima County Natural Resources, Parks and Recreation Department, is one of only a few clay target ranges available for youth groups in our area. Our team, as well as several others from Southern Arizona, already utilize this facility for team practices, instruction, coaching and volunteer training. The addition of the shade Ramada will allow groups such as ours to have meetings, as well as training and instruction classes at the range with more adequate protection from the elements. As you know, heat and sun exposure are a major concern in the desert, and this project will make a major improvement in providing that protection. This will help us attract more youth to the sport of clay target shooting, while enhancing the experience for the existing athletes, and the public.

In closing, let me say that I can think of no better action for AZGFD than to provide funding support for this project. It is truly a positive and worthwhile investment in the future of our sport, and our community.

Thank you for your consideration. Please feel free to contact me if you have any questions.

Sincerely,



David Huelsman, Head Coach
Tucson Shooting Stars
5760 N. Vista Valverde
Tucson, AZ 85718
520-299-6630

Attachment 2. Project Plan – Contractor Proposal and Draft Concept Structural Drawings



December 14, 2016

COMMERCIAL
HISTORIC
PARK DEVELOPMENT
DESIGN BUILD

Pima County PMO
Attn: Art Gibbs
201 N. Stone Avenue, 2nd Floor
Tucson, AZ 85701

Re: Budget Estimate – Steel Ramada Structure At Southeast Regional Park

Dear Mr. Gibbs,

We will provide labor, material and equipment to perform the following:

1. Prepare Drawings and Engineering to obtain permitting for a 30' wide x 30' long Steel Coverworx Shelter per the attached cut sheet. Our proposal includes an \$800.00 allowance for permit fees
2. Supply and install one (1) 30x30 Coverworx Shelter. No painting required.

Design & Permit Cost:	\$3,445.00
<u>Total Construction Cost:</u>	<u>\$34,400.00</u>
Total Price:	\$37,845.00

Exclusions:

- Unforeseen/Concealed Conditions
- Overtime/Off Hours Work
- Construction Water
- Testing/Special Inspections
- Prevailing Wages
- Rain Gutters & Downspouts
- Any work not specifically mentioned above

Thank you for the opportunity to provide you with this Proposal!

Best Regards,

A handwritten signature in blue ink, appearing to read "Mario R. Durazo Jr.", with a horizontal line underneath.

Mario R. Durazo Jr.
President
Durazo Construction Corporation

PO Box 629
Tucson, AZ 85702
Phone: 520.623.1077
Fax: 520.798.3428
durazoconstruction.com

ROC27404 ROC25963

Model: Steelworx Gable Shelter, 30' x 30'
Model # GA-3030-SW

Manufacturing Mission: To provide all prefabricated components and installation instructions for a 30' wide (measured from eave to eave) by 30' long free standing bolt together, tubular steel constructed shelter kit.

Design Criteria: Structure is typically designed for a 25 lb live load and a 90 mph wind load capacity, but can be designed based on specific site requirements upon request. All structural members are ASTM A-500 U.S. grade B steel. Welded connection plates shall be ASTM A-36 hot rolled steel. All welding performed to latest AWS standards by ASTM Certified welders and provided in accordance to same.

Tubular Steel Columns and Beams: Standard column dimension shall be 5" x 5" x 3/16" tubular steel welded to 5/8" base plate (footing design provided separately). Main support beams are 7" x 5" x 3/16" and purlins are 5" x 4" x 3/16". All framing connections are done using A325 grade bolts within concealed access openings from above and will later be concealed by the roofing. All roof framing shall be flush against the roof decking to eliminate the possibility of bird nesting. Steel sizes are preliminary and may change upon final engineering based on actual site conditions and load requirements (site specific engineering shall be an additional cost).

Roofing: 24 Ga. pre-cut steel panels with Kynar 500 finish in a variety of colors with white underside. Standard roof slope is a 4/12 pitch with a eave height of 8'-0". Also available with 6/12 or 8/12 pitch roof. Attached to structural framing with engineered strength self tapping screws.

Frame Finish: All steel framework will receive a corrosion protective TGIC Polyester powder coat, electro-statically applied and cured at 400°F. A large selection of standard colors are available.

Foundation: All columns need to be anchored to concrete footings. Columns can be surface mounted with anchor bolts at or below finish slab elevation or they can be embedded directly into the footing. Optional base plate covers are available at an additional cost.

Hardware: All structural hardware and roofing fasteners shall be provided.

Warranty: 10 years against manufacturer defects.

Not Included: Concrete work of any kind, unloading of product and installation.

Additional Options:

- Flexibility of Design
Such as: Height and Pitch
- Additional Engineering
- Variety of Colors
- Decorative Railings, Lattice, Braces, Trim, etc.
- Cupolas and Rooftop Accs.
- Site Furnishings and Accs.
- Column Style Variations
- Lexan Wind Screens
- Tongue & Groove Roof Decking
- Asphalt Shingles, Standing Seam, Cedar Shake or Clay Tile Roofing
- Composite Finished Ceiling
- Solar Panels & Solar Lighting

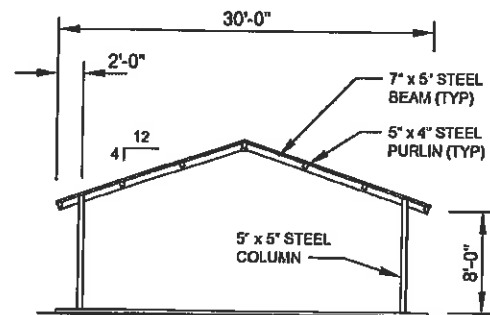

FRONT ELEVATION
SCALE: NTS

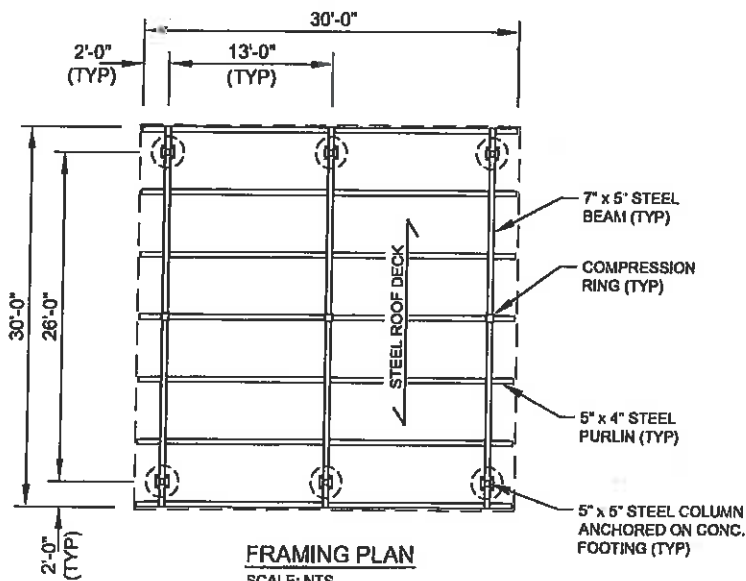

FRAMING PLAN
SCALE: NTS

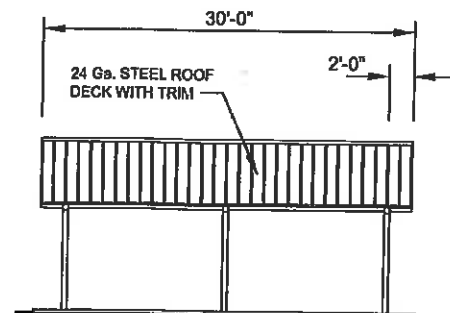

SIDE ELEVATION
SCALE: NTS



11800 East 9 Mile Road
Warren, MI 48089
Office: (586) 486-1088
Fax: (586) 754-9130
Toll Free: (800) 657-6118
Email: info@coverworx.net
www.CoverWorx.net

Steelworx Gable Shelter - 30' x 30'

Model: GA-3030-SW

DESIGN SPECIFICATIONS

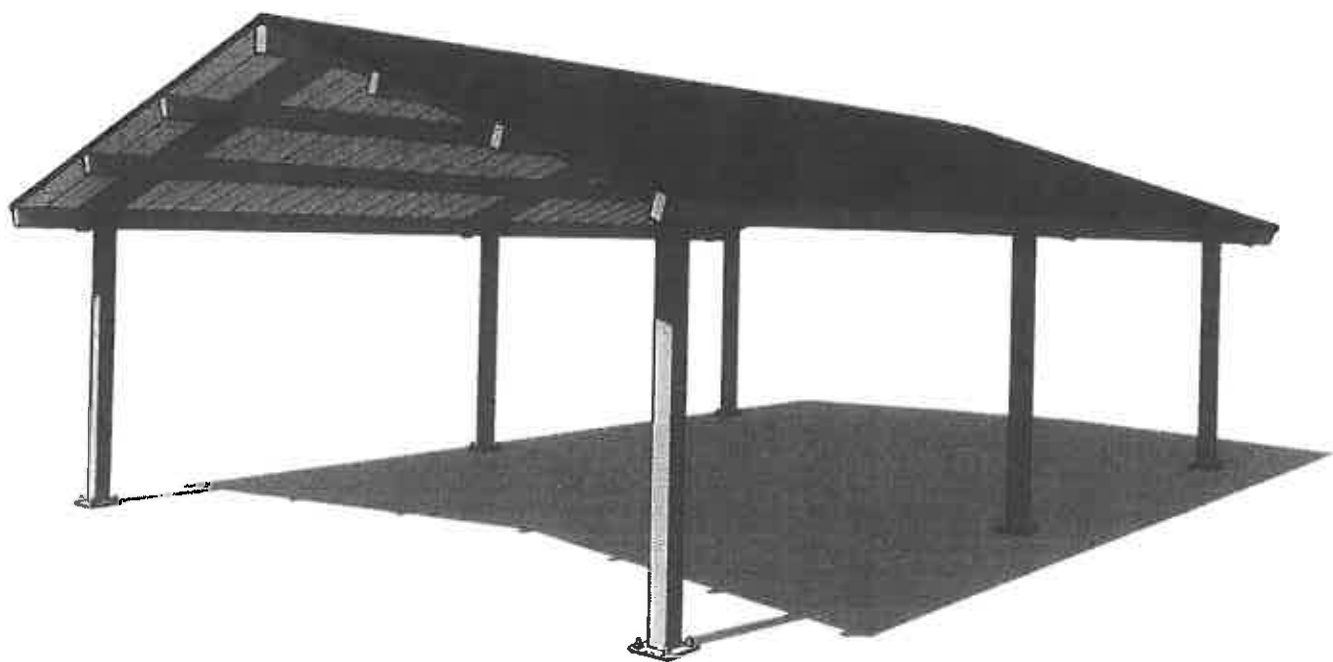

Attachment 3. Master Plan – Shooting Complex Aerial Overview Picture

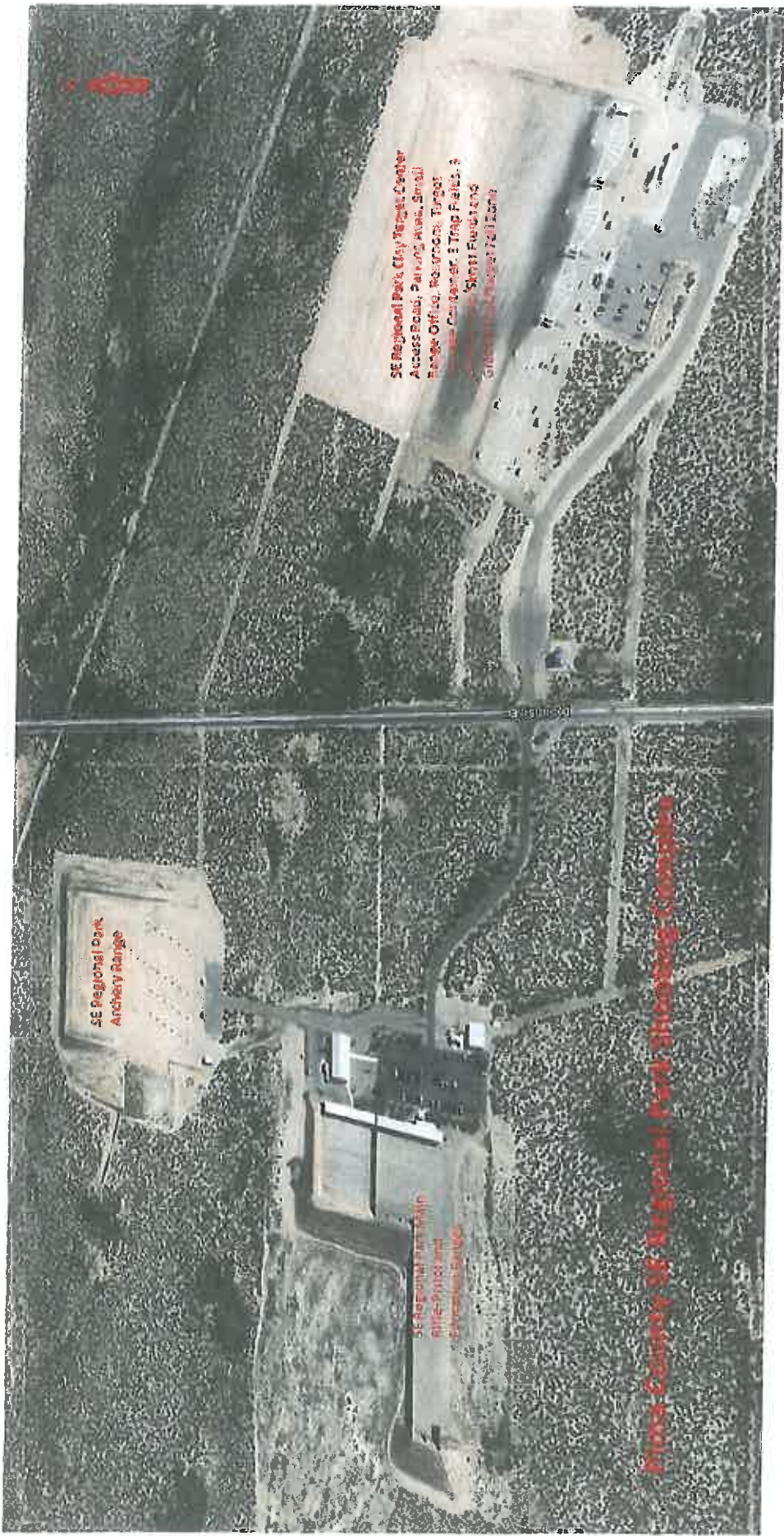

Attachment 4. Location Maps

A) Project Location in Pima County

B) Aerial View of Project Location at the Clay Target Center (same for SHPO below)

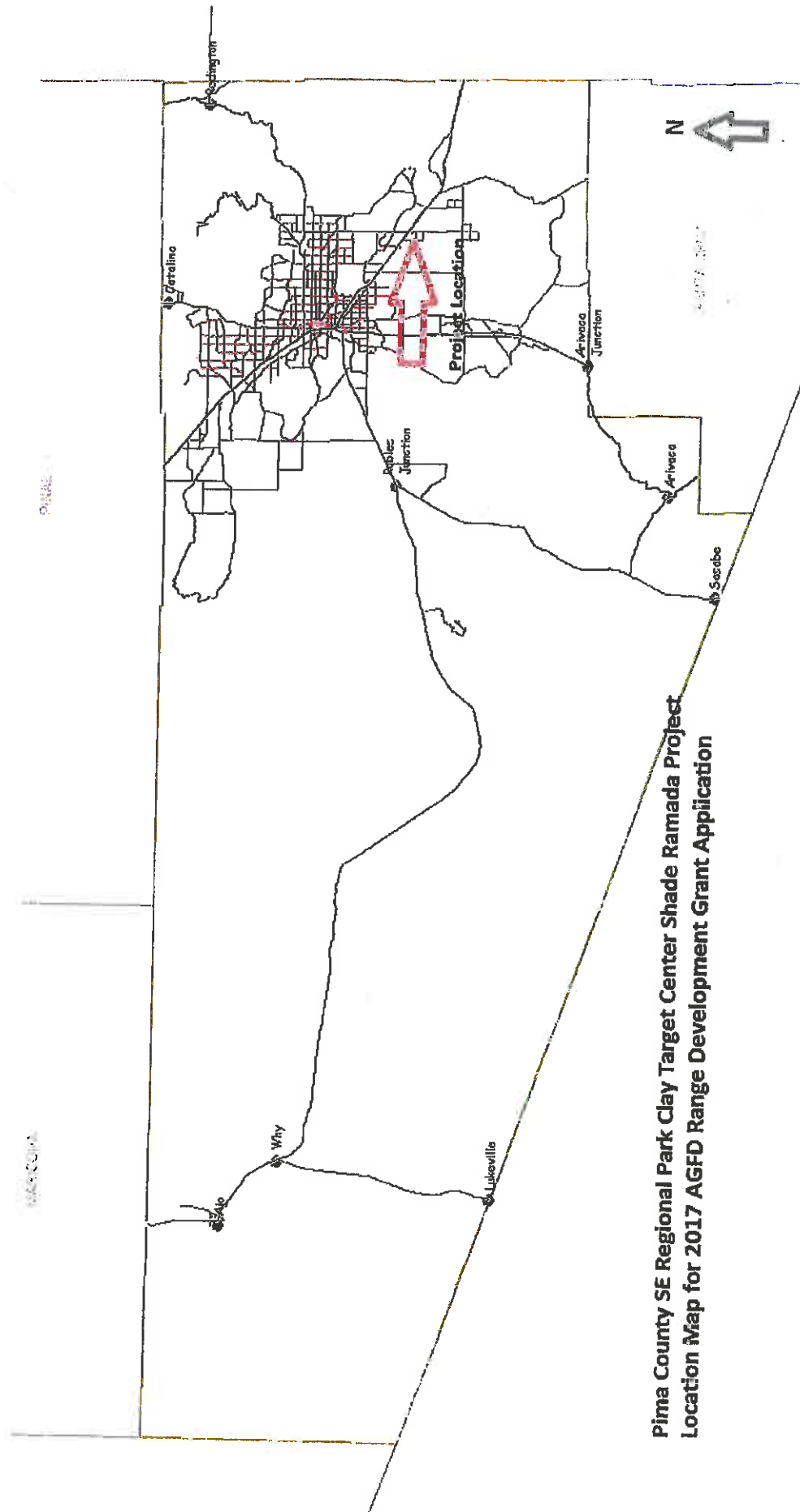

**Pima County SE Regional Park Clay Target Center Shade Ramada Project
Location Map for 2017 AGFD Range Development Grant Application**



Attachment 4.B.

Attachment 5. Budget Worksheet

Budget Worksheet

Use this worksheet to develop a cost estimate. Additional categories may be used if needed.

Project Title:	SE Regional Park Clay Target Center Shade Ramada		
Organization:	Pima County - Natural Resources Parks & Recreation Department		
	Estimated costs <i>This column should contain estimates of all project costs.</i>	Organization dollars (Cash Dollars Dedicated to the Project)	Value of donated services and supplies
	<i>Organization dollars and donated services and supplies must equal 50% of the total project cost.</i>		
Planning/development	\$ 3,445.00	\$ 3,445.00	\$
Equipment	\$	\$	\$
Construction	\$ 34,400.00	\$ 17,200.00	\$
Labor	\$	\$	\$
Supplies	\$	\$	\$
Other	\$	\$	\$
Total project cost	\$ 37,845.00		
Total organizational dollars and donations (Must Equal or Exceed 50% of Total Project Cost)	\$ 20,645.00 =	\$ 20,645.00 +	\$
Grant Request (Not to Exceed 50% of the Total Project Costs)	\$ 17,200.00		
Please tell us if any other organizations are providing funding for this project. No other organization or entity is providing funding for this project.			

Attachment 6. Insurance Documentation



**PIMA COUNTY
DEPARTMENT OF FINANCE AND RISK MANAGEMENT**

Keith Dommer, Director

CERTIFICATE OF SELF-INSURANCE

THIS IS TO CERTIFY THAT PIMA COUNTY, IN ACCORDANCE WITH A.R.S. §11-981
AND PIMA COUNTY CODE §3.04, IS SELF-INSURED.

TO THE EXTENT PERMITTED BY LAW, PIMA COUNTY, AS A SELF-INSURER, IS
PROVIDING EVIDENCE OF GENERAL LIABILITY COVERAGE FOR THE COUNTY
OF ONE MILLION DOLLARS (\$1,000,000) FOR LIABILITIES THAT HAVE BEEN
PROPERLY DETERMINED TO ARISE FROM THIS ACTIVITY.

DATE OF ISSUE:
December 14, 2016

CERTIFICATE HOLDER:
Arizona Game and Fish Department AZ-(DAAS)
Mike Raum, Shooting Sports Branch Chief
5000 W. Carefree Hwy.
Phoenix, AZ 85086

Program:
Proof of self-insurance for SE Regional Park Clay
Target Center Grant Application GTAP Contract
Number is 17*55

Certificate Expires: June 30, 2018
(Unless Master Agreement sooner canceled or terminated)

***Certificate good with respect to Pima
County only.***

Lauren G. Eib, Risk Manager
Pima County Finance & Risk Management Department

Attachment 7. Pima County Board of Supervisors Resolution of Support

RESOLUTION 2017 - ____

**RESOLUTION OF THE PIMA COUNTY BOARD OF SUPERVISORS IN SUPPORT OF
A GRANT APPLICATION TO THE ARIZONA GAME AND FISH DEPARTMENT FOR
THE CONSTRUCTION OF A SHADE RAMADA AT THE SOUTHEAST REGIONAL
PARK CLAY TARGET CENTER**

The Board of Supervisors of Pima County, Arizona finds:

1. The Arizona Game and Fish Commission under A.R.S. § 17-231(B)(4) has authorized the establishment of a Shooting Range Development Policy providing financial assistance for the development of shooting ranges for public purposes.
2. The Arizona Game and Fish Department has responsibility for the administration of the policy and has established guidelines and procedures governing applications for funding assistance under the policy.
3. The Arizona Game and Fish Department's application procedures require the applicant's governing body to approve by resolution the submission of applications for shooting range assistance.
4. The Pima County Board of Supervisors, in accordance with A.R.S. §11-251, supports the application of Pima County to the Arizona Game and Fish Department for a Shooting Range Development Grant for construction of a shade ramada at the Southeast Regional Park Clay Target Center.

NOW, THEREFORE, BE IT RESOLVED that the Pima County Board of Supervisors:

1. Approves the filing of an application to the Arizona Game and Fish Department for a Shooting Range Development Grant for construction of a shade ramada at the Southeast Regional Park Clay Target Center.
2. Certifies that the project application is consistent and compatible with all adopted plans and programs for safe shooting range development.
3. Agrees that Pima County will comply with all procedures, guidelines and requirements of the Arizona Game and Fish Department as a part of the application process.
4. Acknowledges that the project scope and funding amount are subject to final approval by the Arizona Game and Fish Commission.

Leonard Ordway, Shooting Sports Program Manager for the Pima County Department of Natural Resources, Parks and Recreation, is hereby authorized and directed to act on behalf of Pima County with regard to this grant application by conducting negotiations with the Arizona Game and Fish Department and by executing and submitting documents, including but not limited to applications, agreements,

amendments, and other documents which may be necessary for the completion of the shooting range development project.

Passed, adopted and approved, this 3rd day of January, 2017.

Sharon Bronson, Chair, Pima County Board of Supervisors

ATTEST:

Clerk of the Board

APPROVED AS TO FORM



Tobin Rosen, Deputy County Attorney

12/23/16

Attachment 8. Pima County W9 Form

**Request for Taxpayer
Identification Number and Certification**

Attachment 8

Give Form to the
requester. Do not
send to the IRS.

Print or type
See Specific Instructions on page 2.

1 Name (as shown on your income tax return). Name is required on this line; do not leave this line blank.

PIMA COUNTY GOVERNMENT

2 Business name/disregarded entity name, if different from above

3 Check appropriate box for federal tax classification; check only one of the following seven boxes:

☐ Individual/sole proprietor or single-member LLC ☐ C Corporation ☐ S Corporation ☐ Partnership ☐ Trust/estate

☐ Limited liability company. Enter the tax classification (C=C corporation, S=S corporation, P=partnership) ▶

Note. For a single-member LLC that is disregarded, do not check LLC; check the appropriate box in the line above for the tax classification of the single-member owner.

☒ Other (see instructions) ▶

GOVERNMENT AGENCY

5 Address (number, street, and apt. or suite no.)

130 WEST CONGRESS, 7TH FLOOR

6 City, state, and ZIP code

TUCSON, ARIZONA 85701

7 List account number(s) here (optional)

4 Exemptions (codes apply only to certain entities, not individuals; see instructions on page 3):
Exempt payee code (if any) _____

Exemption from FATCA reporting
code (if any) _____

(Applies to accounts maintained outside the U.S.)

Requester's name and address (optional)

Part I Taxpayer Identification Number (TIN)

Enter your TIN in the appropriate box. The TIN provided must match the name given on line 1 to avoid backup withholding. For individuals, this is generally your social security number (SSN). However, for a resident alien, sole proprietor, or disregarded entity, see the Part I instructions on page 3. For other entities, it is your employer identification number (EIN). If you do not have a number, see *How to get a TIN* on page 3.

Note. If the account is in more than one name, see the instructions for line 1 and the chart on page 4 for guidelines on whose number to enter.

Social security number

____ - ____ - ____

or

Employer identification number

8 6 - 6 0 0 0 5 4 3

Part II Certification

Under penalties of perjury, I certify that:

1. The number shown on this form is my correct taxpayer identification number (or I am waiting for a number to be issued to me); and
2. I am not subject to backup withholding because: (a) I am exempt from backup withholding, or (b) I have not been notified by the Internal Revenue Service (IRS) that I am subject to backup withholding as a result of a failure to report all interest or dividends, or (c) the IRS has notified me that I am no longer subject to backup withholding; and
3. I am a U.S. citizen or other U.S. person (defined below); and
4. The FATCA code(s) entered on this form (if any) indicating that I am exempt from FATCA reporting is correct.

Certification Instructions. You must cross out item 2 above if you have been notified by the IRS that you are currently subject to backup withholding because you have failed to report all interest and dividends on your tax return. For real estate transactions, item 2 does not apply. For mortgage interest paid, acquisition or abandonment of secured property, cancellation of debt, contributions to an individual retirement arrangement (IRA), and generally, payments other than interest and dividends, you are not required to sign the certification, but you must provide your correct TIN. See the instructions on page 3.

Sign
Here

Signature of
U.S. person ▶

Maryhomed

Date ▶

9-7-16

General Instructions

Section references are to the Internal Revenue Code unless otherwise noted.

Future developments. Information about developments affecting Form W-9 (such as legislation enacted after we release it) is at www.irs.gov/ky9.

Purpose of Form

An individual or entity (Form W-9 requester) who is required to file an information return with the IRS must obtain your correct taxpayer identification number (TIN) which may be your social security number (SSN), individual taxpayer identification number (ITIN), adoption taxpayer identification number (ATIN), or employer identification number (EIN), to report on an information return the amount paid to you, or other amount reportable on an information return. Examples of information returns include, but are not limited to, the following:

- Form 1099-INT (interest earned or paid)
- Form 1099-DIV (dividends, including those from stocks or mutual funds)
- Form 1099-MISC (various types of income, prizes, awards, or gross proceeds)
- Form 1099-B (stock or mutual fund sales and certain other transactions by brokers)
- Form 1099-S (proceeds from real estate transactions)
- Form 1099-K (merchant card and third party network transactions)

• Form 1098 (home mortgage interest), 1098-E (student loan interest), 1098-T (tuition)

• Form 1099-C (canceled debt)

• Form 1099-A (acquisition or abandonment of secured property)

Use Form W-9 only if you are a U.S. person (including a resident alien), to provide your correct TIN.

If you do not return Form W-9 to the requester with a TIN, you might be subject to backup withholding. See *What is backup withholding?* on page 2.

By signing the filled-out form, you:

1. Certify that the TIN you are giving is correct (or you are waiting for a number to be issued).
2. Certify that you are not subject to backup withholding, or
3. Claim exemption from backup withholding if you are a U.S. exempt payee. If applicable, you are also certifying that as a U.S. person, your allocable share of any partnership income from a U.S. trade or business is not subject to the withholding tax on foreign partners' share of effectively connected income, and
4. Certify that FATCA code(s) entered on this form (if any) indicating that you are exempt from the FATCA reporting, is correct. See *What is FATCA reporting?* on page 2 for further information.

Attachment 9. Property Ownership Documentation

ACQUISITION COVER SHEET

REAL PROPERTY/ACQUISITION COVER SHEET

DOCKET 06561 ☐ RE-RECORDED DEED

PAGE 01012

SEQ. # 14 11 02

LEASE # 14 12 2-16,23

REC. DATE 06/29/1981 14 12 24

RP AGENT 16 15 10-11,15

FILE # 16 15 22,23

GRANTOR: STATE OF ARIZONA

GRANTEE: ☐ Public

☒ Pima County

☐ Pima County Dot-PCD

☐ Pima County Flood Control District

MANAGING DEPT:

☐ CA ☐ FC ☐ LIB ☐ PCA ☐ SD ☐ SUS ☐ WW

☐ CD ☐ EM ☐ OEM ☐ PR ☐ SS ☐ TR

DOCUMENT CATEGORIES

☐ RIGHT-OF-WAY ☒ PROPERTY ☐ STATE LEASE ☐ FEDERAL/BEM

☐ ROAD ☐ ROAD ☐ ROAD ☐ ROAD

☐ DRAINAGE ☐ DRAINAGE ☐ DRAINAGE ☐ DRAINAGE

☐ PARK ☐ PARK ☐ PARK

☐ OPEN SPACE ☐ PUBLIC ACCESS (by deed)

☐ FINAL ORDER OF CONDEMNATION ☐ BASIN

☐ EASEMENT

COMMENTS:

THIS DOCUMENT DESCRIBES POLYGONS LOCATED IN MULTIPLE SECTIONS. READ DOCUMENT TO IDENTIFY OTHER SECTIONS.

FOR DOT/EM MAPPING & RECORDS USE ONLY

Township	Range	Section	Plotted By:	WM	Date: 05/14/2002
14	11	02	Checked By:	BCS	Date: 01/22/2015
14	12	2-16,23	Polygon ID:	BB1411021E	BB1412241E
14	12	24		BB1412023E	BB16150101E
16	15	10-11,15		BB1412161E	BB1615111E
16	15	22,23		BB1412239E	BB1615221E BB1615231E

LONGITUDE/LATITUDE COORDINATES:

(X) -111.1297 (Y) 32.2197

STATE OF ARIZONA

PATENT NO. 6826 to
LAND EXCHANGED WITH
MINERAL RESERVATION TO
THE STATE OF ARIZONA (II)

For F, G, N and S Lands
(School, Institutional or
University)

TO ALL UNTO WHOM THESE PRESENTS SHALL COME, GREETING:

WHEREAS, in accordance with the provisions of Arizona Revised Statutes Section 41-511.19, the Patentee has conveyed to the State of Arizona certain real property and in consideration thereof the State of Arizona through its State Land Department and the Land Department Selection Board has agreed to exchange therefor the real property hereinafter described,

NOW, KNOW YE, That the State of Arizona in consideration of the premises, and in conformity with law hereby does grant and convey unto

PIMA COUNTY BOARD OF SUPERVISORS

the following described real property situated in the County of Pima, State of Arizona, to-wit:

✓ IN TOWNSHIP 14 SOUTH, RANGE 11 EAST, G&SRB&M, PIMA COUNTY, ARIZONA.

SECTION 2: LOTS 1 AND 2; THE SOUTH HALF OF THE NORTHEAST QUARTER (S2NE4); AND THE SOUTHEAST QUARTER (SE4); CONTAINING 319.64 ACRES, MORE OR LESS.

IN TOWNSHIP 14 SOUTH, RANGE 12 EAST, G&SRB&M, PIMA COUNTY, ARIZONA.

SECTION 2: LOTS 1; 2; 3; AND 4; THE NORTH HALF OF THE SOUTH HALF OF THE NORTHWEST QUARTER (N2S2NW4); AND THE NORTH HALF OF THE SOUTHWEST QUARTER OF THE NORTHEAST QUARTER (N2SW4NE4); CONTAINING 257.72 ACRES, MORE OR LESS.

SECTION 16: THE EAST HALF (E2); CONTAINING 320.00 ACRES, MORE OR LESS.

SECTION 23: THE NORTH HALF OF THE NORTHWEST QUARTER (N2NN4) AND THE SOUTHWEST QUARTER OF THE NORTHWEST QUARTER (SW4NW4); THE WEST HALF OF THE SOUTHEAST QUARTER OF THE NORTHWEST QUARTER (W2SE4NW4) AND THE NORTHEAST QUARTER OF THE SOUTHEAST QUARTER OF THE NORTHWEST QUARTER (NE4SE4NW4); CONTAINING 150.00 ACRES, MORE OR LESS.

SECTION 24: THE NORTH HALF OF THE SOUTHWEST QUARTER (N2SW4); AND THE WEST HALF OF THE SOUTHEAST QUARTER (W2SE4); CONTAINING 160.00 ACRES, MORE OR LESS.

IN TOWNSHIP 16 SOUTH, RANGE 15 EAST, G&SRB&M, PIMA COUNTY, ARIZONA.

SECTION 10: THE SOUTHEAST QUARTER (SE4); CONTAINING 160.00 ACRES, MORE OR LESS.

SECTION 11: THE SOUTH HALF (S2), EXCEPT THAT PART LYING EASTERLY OF THE EAST LINE OF HOUGHTON ROAD AS ESTABLISHED UNDER PROCEEDINGS NO. 1233 AND OF RECORD AT THE PIMA COUNTY RECORDER'S OFFICE IN BOOK 9 OF ROAD MAPS AT PAGE 92 THEREOF; CONTAINING 311.5 ACRES, MORE OR LESS.

SECTION 15: ALL; CONTAINING 640.00 ACRES, MORE OR LESS.

SECTION 22: ALL; CONTAINING 640.00 ACRES, MORE OR LESS.

SECTION 23: ALL, EXCEPT THE SOUTHEAST QUARTER OF THE SOUTHEAST QUARTER (SE4SE4) THEREOF; CONTAINING 600.00 ACRES, MORE OR LESS.

containing 3,558.86 acres, more or less, subject to existing reservations, easements, or rights-of-way heretofore legally obtained and now in full force and effect, and subject to the following specific mineral reservation, viz:

PURSUANT TO THE PROVISIONS OF ARIZONA REVISED STATUTES 37-231, OF THE FOLLOWING SUBSTANCES NOT HERETOFORE RETAINED AND RESERVED BY A PREDECESSOR IN TITLE TO THE STATE OF ARIZONA ALL OIL, GAS, OTHER HYDROCARBON SUBSTANCES, HELIUM OR OTHER SUBSTANCES OF

PLOTTED BY	DATE	CHECKED BY	DATE
J. B.	7-27-81	BT	7-29-81

Section 2, 14/11

6561 PAGE 1012

3

A GASEOUS NATURE, COAL, METALS, MINERALS, FOSSILS, FERTILIZER OF EVERY NAME AND DESCRIPTION, TOGETHER WITH ALL URANIUM, THORIUM, OR ANY OTHER MATERIAL WHICH IS OR MAY BE DETERMINED BY THE LAWS OF THE UNITED STATES, OR OF THIS STATE, OR DECISIONS OF COURT, TO BE PECULIARLY ESSENTIAL TO THE PRODUCTION OF FISSIONABLE MATERIALS, WHETHER OR NOT OF COMMERCIAL VALUE, AND THE EXCLUSIVE RIGHT THERETO, ON, IN, OR UNDER THE ABOVE DESCRIBED LANDS, SHALL BE AND REMAIN AND ARE HEREBY RESERVED IN AND RETAINED BY THE STATE OF ARIZONA, TOGETHER WITH THE RIGHT OF THE STATE OF ARIZONA, ITS LESSEES OR PERMITTEES TO ENTER UPON THOSE LANDS FOR THE PURPOSE OF EXPLORATION, DEVELOPMENT AND REMOVAL OF THE ABOVE DESCRIBED SUBSTANCES AS PROVIDED BY THE RULES AND REGULATIONS OF THE STATE LAND DEPARTMENT AND THE LAWS OF ARIZONA;

TO HAVE AND TO HOLD said real property together with all the rights, privileges, immunities and appurtenances of whatsoever nature thereunto belonging unto said Patentee, its successors and assigns forever.

In Testimony Whereof, We, the undersigned who on the date hereof comprised the Arizona State Land Department Selection Board, have caused these letters to be made patent and the Great Seal of the State of Arizona to be hereunto attached.

Given under our hand at the City of Phoenix, Arizona, this 30th day of April, 1981.

GOVERNOR OF THE STATE OF ARIZONA
and ex-officio member of the Selection Board

ATTORNEY GENERAL OF THE STATE OF ARIZONA
and ex-officio member of the Selection Board

STATE LAND COMMISSIONER OF THE STATE OF ARIZONA as ex-officio member of the Selection Board and for the State Land Department

Attest:

SECRETARY OF STATE OF THE STATE OF ARIZONA



APPROVED BY THE PIMA COUNTY BOARD OF SUPERVISORS
JUNE 16, 1981



Sam Lena, Chairman

STATE OF ARIZONA
COUNTY OF PIMA
Witness my hand and Official Seal.

Indexed	Paged	Blotted

FORM 4-13

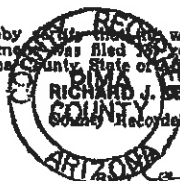
I hereby certify that this instrument was filed for record in Pima County, State of Arizona
RICHARD J. DENNEY
County Recorder



No. 68064
Book 6561 Page 1012-1013
Date: JUN 20 81 2 25 PM
Request of: Property Management

Deputy
6561-1012

Fee: 2.00

Attachment 10. SHPO Consultation Information

A) AGFD SHPO Consultation form

B) Aerial View of Project Location at the Clay Target Center (same as location map above)

AGFD SHPO Consultation

This consultation is required by regulations implementing the State Preservation Act (A.R.S. § 41-861 through 42-864), effective July 24, 1982. It is understood that recipients of state funds are required to comply with this law throughout the project period. The State Historic Preservation Act mandates that all State agencies consider the potential of activities or projects to impact significant cultural resources. Each State agency is required to consult with the State Historic Preservation Officer with regard to those activities or projects that may impact cultural resources.

PROJECT TITLE SE Regional Park Clay Target Center Shade Ramada

APPLICANT Pima County - Natural Resources, Parks & Recreation Department

Please answer the following questions which provide information on the potential of the project to impact cultural resources:

Does the proposed project have the potential to disturb the surface and/or subsurface of the ground?

 X YES NO

Are there any known prehistoric and/or historic archaeological sites within the project area that have the potential to be disturbed by the proposed activity?

 YES X NO

Are there any buildings or structures (including mines, bridges, dams, canals, etc.) which are 50 years or older within the project area that have the potential to be disturbed by the proposed activity?

 YES X NO

If you have answered "NO" to all of the above questions, please sign on the line below certifying that the activity or project is in compliance (and will remain in compliance throughout the project period) with the State Historic Preservation Act.

Leonard L. Ordway 12/14/16
Authorized Signature/Date

Leonard Ordway
Printed Name

(520) 724-5752
Phone Number

If you have answered "YES" to any of the above questions you must complete the "SHPO Information Form" and follow the directions on the back of this certification. Forward copies of all information requested to the Arizona Game and Fish Department. All original copies should be submitted with the application to the Arizona Game and Fish Department. **DO NOT FORWARD THIS FORM TO SHPO!**

SHPO Information Sheet

If you answered yes to question #1 on the SHPO Consultation page, please attach a brief description of the proposed project and specifically identify any surface or subsurface impacts that are expected.

The project is to construct a shade structure on the front side of the existing range office over top of existing concrete pad. The ground disturbance will consist of digging six (6) footers to support structure columns. Footers will be placed and dug either alongside or through existing concrete pad.

Identify the total project area acreage involved: 0.017 acres

Please comment on the condition of the current ground surface within the entire project boundary area (i.e., is the ground in a natural undisturbed condition, or has it been bladed, paved, graded, etc.). Attach extra sheets if more space is needed.

Project area involves existing graded area that is already covered with either concrete or decomposed granite. The area is regularly used and traversed by County staff and facility customers.

Has the project area been previously surveyed for cultural resources by a qualified Archaeologist?

 X yes no

If yes, applicant must submit a copy of the Archaeologist's report.

Identify the Landowner (Note: if a Federal Agency is involved, they must consult with SHPO pursuant to the National Historic Preservation Act).

The project area and Clay Target Center are owned and operated by Pima County.

Project location: T16S, R15E, Section 11, SW 1/4

(Township, Range, Section and quarter/quarters)

Please provide a map identifying the location of the range and proposed project areas. Topo quad maps and Google Earth images are both acceptable.

