

Pima County Clerk of the Board

Robin Brigode

Julie Castañeda
Deputy Clerk

Administration Division
130 W. Congress, 5th Floor
Tucson, AZ 85701
Phone: (520)724-8449 • Fax: (520)222-0448

Document and Micrographics Mgt. Division
1640 East Benson Highway
Tucson, Arizona 85714
Phone: (520) 351-8454 • Fax: (520) 791-6666

June 21, 2016

Fadhl Nagi Obeid Aldhali
Pima Liquors
2858 W. Drexel Road
Tucson, AZ 85746

RE: Arizona Liquor License No.: 09100101
d.b.a. Pima Liquors

Dear Mr. Aldhali:

Enclosed is a copy of the Affidavit of Posting relative to your Liquor License Application for a Series 9, Liquor Store, which was received in our office on May 20, 2016. The Hearing before the Pima County Board of Supervisors has been scheduled for Tuesday, July 5, 2016, at 9:00 a.m. or thereafter, at the following location:

Pima County Administration Building
Board of Supervisors Hearing Room
130 W. Congress, 1st Floor
Tucson, AZ 85701

For your information, enclosed is a copy of the Sheriff's Report. Any questions pertaining to the enclosed report should be directed to the Pima County Sheriff's Department at (520) 351-6999. If you have any questions pertaining to the above referenced hearing, please contact this office at (520) 724-8449.

Sincerely,

A handwritten signature in cursive script that reads "Robin Brigode".

Robin Brigode
Clerk of the Board

Enclosure

c: Pima County Sheriff Investigative Support Unit



Arizona Department of Liquor Licenses and Control
800 W Washington 5th Floor
Phoenix, AZ 85007-2934
www.azliquor.gov
(602) 542-5141

JUN 20 16 02 06 PC CLK/FHD
ACB

AFFIDAVIT OF POSTING

Date of Posting: 5/26/16 Date of Posting Removal: 6/20/16

Applicant's Name: Pima Liquors
Aldhali Fadhil Nagi Obeid
Last First Middle

Business Address: 2880 W. Drexel Road Tucson 85706
Street City Zip

License #: 09100101

I hereby certify that pursuant to A.R.S. 4-201, I posted notice in a conspicuous place on the premises proposed to be licensed by the above applicant and said notice was posted for at least twenty (20) days.

FRANK R. HECHT 1775 - PCSO PROCESS SERVER 520 310 4034
Print Name of City/County Official Title Phone Number

[Signature] 6/20/16
Signature Date Signed

Return this affidavit with your recommendations (i.e., Minutes of Meeting, Verbatim, etc.) or any other related documents.
If you have any questions please call (602) 542-5141 and ask for the Licensing Division.



Pima County Clerk of the Board

Robin Brigode

Julie Castañeda
Deputy Clerk

Administration Division
130 W. Congress, 5th Floor
Tucson, AZ 85701
Phone: (520) 724-8449 • Fax: (520) 222-0448

Document and Micrographics Mgt. Division
1640 East Benson Highway
Tucson, Arizona 85714
Phone: (520) 351-8454 • Fax: (520) 791-6668

TO: Development Services, Zoning Division
FROM: Alina Bárcenas *ABC*
Administrative Support Specialist
DATE: May 23, 2016
RE: Zoning Report - Application for Liquor License

Attached is the application of:

Fadhl Nagi Obeid Aldhali
d.b.a. Pima Liquors
2880 W. Drexel Road
Tucson, AZ 85706

Arizona Liquor License No. 09100101
Series 9, Liquor Store
New License _____
Person Transfer _____
Location Transfer X

ZONING REPORT

DATE: 5/31/16

Will current zoning regulations permit the issuance of the license at this location?

Yes ☒ No ☐

If No, please explain:

Pima County Zoning Inspector

When complete, please return to cob_mail@pima.gov

MAY 31 16 10 13 P C CLK OF B



15 MAY 18 147. Lic. #1152

Arizona Department of Liquor Licenses and Control
800 W Washington 5th Floor
Phoenix, AZ 85007-2934
www.azliquor.gov
(602) 542-5141

16-10-9253

Application for Liquor License
Type or Print with Black Ink

APPLICATION FEE AND INTERIM PERMIT FEES (IF APPLICABLE) ARE NOT REFUNDABLE
A service fee of \$25 will be charged for all dishonored checks (A.R.S. § 44-6852)

SECTION 1 This application is for a:

- ☐ Interim Permit (Complete Section 5)
☐ New License (Complete Sections 2, 3, 4, 13, 14, 15, 16)
☐ Person Transfer (Complete Section 2, 3, 4, 12, 13, 14, 16)
☒ Location Transfer (Bars and Liquor Stores Only)
(Complete Section 2, 3, 4, 11, 13, 14, 16)
☐ Probate/ Will Assignment/ Divorce Decree
(Complete Sections 2, 3, 4, 9, 13, 14, 16)
(Fee not required)
☐ Government (Complete Sections 2, 3, 4, 10, 13, 16)
☐ Seasonal

SECTION 2 Type of Ownership:

- ☐ J.T.W.R.O.S. (Complete Section 6)
☐ Individual (Complete Section 6)
☐ Partnership (Complete Section 6)
☒ Corporation (Complete Section 7)
☐ Limited Liability Co (Complete Section 7)
☐ Club (Complete Section 8)
☐ Government (Complete Section 10)
☐ Trust (Complete Section 6)
☐ Tribe (Complete Section 6)
☐ Other (Explain) _____

SECTION 3 Type of license

1. Type of License: 9 - LIQUOR STORE LICENSE # 09100101

SECTION 4 Applicants

1. Individual Owner/Agent's Name: ALDHALI FADHL NAGI OBEID
Last First Middle
2. Owner Name: Pima Liquors, Inc.
(Ownership name for type of ownership checked on section 2)
3. Business Name: Pima Liquors
(Exactly as it appears on the exterior of premises)
4. Business Location Address: 2880 W. Drexel Rd. Tucson AZ 85746
(Do not use PO Box) Street City State Zip Code County
5. Mailing Address: 2858 W. Drexel Rd. Tucson AZ 85746
(All correspondence will be mailed to this address) Street City State Zip Code
6. Business Phone: (520) 578-6418 Daytime Contact Phone: (520) 406-0777
7. Email Address: MOSAB@COX.NET
8. Is the Business located within the incorporated limits of the above city or town? ☐ Yes ☒ No
9. Does the Business location address have a street address for a City or Town but is actually in the boundaries of another City, Town or Tribal Reservation? ☒ Yes ☐ No
If yes, what City, Town or Tribal Reservation is this Business located in: Pima County
10. Total Price paid for Series 6 Bar, Series 7 Beer & Wine Bar or Series 9 Liquor Store (license only) \$ N/A

Fees: <u>\$1000.00</u>	Department Use Only		<u>\$22.00</u>	<u>\$122.00</u>
Application	Interim Permit	Site Inspection	Finger Prints	Total of All Fees
Is Arizona Statement of Citizenship & Alien Status for State Benefits complete? <input checked="" type="checkbox"/> Yes <input type="checkbox"/> No				
Accepted by: <u>[Signature]</u>		Date: <u>5/18/16</u>	License # <u>09100101</u>	

16-10-9253

SECTION 5 Interim Permit

16 MAY 18 14. Lic. #1152

- If you intend to operate business when your application is pending you will need an interim permit pursuant to ARS § 4-203.01
- There **MUST** be a valid license of the same type you are applying for currently issued to the location or for the replacement of a Hotel/Motel license with a Restaurant license pursuant to A.R.S. § 4-203.01.

1. Enter license number currently at the location: _____

2. Is the license currently in use? ☐ Yes ☐ No If no, how long has it been out of use? _____**Attach a copy of the license currently issued at this location to this application.**I, _____ declare that I am the CURRENT OWNER, AGENT, OR CONTROLLING PERSON on
(Print Full Name) the stated license and location.X _____
(Signature of CURRENT Individual Owner/Agent)State of _____ County of _____
The foregoing instrument was acknowledged before me thisMy commission expires on: _____
Date_____ of _____
Day Month Year_____
Signature of NOTARY PUBLIC**SECTION 6 Individual, Partnership, J.T.W.R.O.S, Trust, Tribe Ownerships**

EACH PERSON LISTED MUST SUBMIT A COMPLETED QUESTIONNAIRE, AN "APPLICANT" TYPE FINGERPRINT CARD AND \$22 PROCESSING FEE FOR EACH CARD.

Individual

Last	First	Middle	%Owned	Mailing Address	City	State	Zip Code

Is any person other than above, going to share in profit/losses of the business? ☐ Yes ☐ No

If Yes, give name, current address, and telephone number of person(s). Use additional sheets if necessary.

Last	First	Middle	Mailing Address	City	State	Zip Code	Phone #

Partnership

Name of Partnership: _____

General-Limited	Last	First	Middle	%Owned	Mailing Address	City	State	Zip Code
<input type="checkbox"/> <input type="checkbox"/>								
<input type="checkbox"/> <input type="checkbox"/>								
<input type="checkbox"/> <input type="checkbox"/>								
<input type="checkbox"/> <input type="checkbox"/>								

J.T.W.R.O.S (Joint Tenant with Rights of Survivorship)

Name of J.T.W.R.O.S: _____

Last	First	Middle	Mailing Address	City	State	Zip Code

SECTION 6 - continued

16 MAY 18 04:14 AM 1152

TRUST

Name of Trust: _____

Last	First	Middle	Mailing Address	City	State	Zip Code

TRIBE

Name of Tribal Ownership: _____

Last	First	Middle	Mailing Address	City	State	Zip Code

SECTION 7 Corporations/ Limited Liability Co

EACH PERSON LISTED MUST SUBMIT A COMPLETED QUESTIONNAIRE, AN "APPLICANT" TYPE FINGERPRINT CARD AND \$22 PROCESSING FEE FOR EACH CARD.

- ☒ Corporation Complete Questions 1, 2, 3, 4, 5, 6, and 7
☐ L.L.C. Complete Questions 1, 2, 3, 4, 5, 6, and 7

1. Name of Corporation/ L.L.C.: Pima Liquors, Inc.
 2. Date Incorporated/Organized: 01/03/2007 State where Incorporated/Organized: ARIZONA
 3. AZ Corporation or AZ L.L.C File No: 13348998 Date authorized to do Business in AZ: 01/08/2007
 4. Is Corp/L.L.C. Non Profit? ☐ Yes ☒ No
 5. List Directors, Officers, Members in Corporation/L.L.C:

Last	First	Middle	Title	Mailing Address	City	State	Zip Code
ALDHALI	FADHL	NAGI OBEID	Pres./ Director	2858 W. Drexel Rd.	TULSON	AZ	85746

(Attach additional sheet if necessary)

6. List all Stockholders / percentage owners who own 10% or more:

Last	First	Middle	% Owned	Mailing Address	City	State	Zip Code
ALDHALI	FADHL	NAGI OBEID	100%	2858 W. Drexel Rd.	TULSON	AZ	85746

(Attach additional sheet if necessary)

7. If the corporation/ L.L.C are owned by another entity, attach an Organizational **FLOWCHART** showing the structure of the ownership. Attach additional sheets as needed in order to disclose the Officers, Directors, Members, Managers, Partners, Stockholders and percentage owners of those entities.

SECTION 8 Club Applicants

EACH PERSON LISTED MUST SUBMIT A COMPLETED QUESTIONNAIRE, AN "APPLICANT" TYPE FINGERPRINT CARD AND \$22 PROCESSING FEE FOR EACH CARD

1. Name of Club: _____
2. Is Club non-profit? ☐ Yes ☐ No
3. List all controlling members (minimum of four (4) requested)

Last	First	Middle	Mailing Address	City	State	Zip Code

(Attach additional sheet if necessary)

SECTION 9 Probate, Will Assignment or Divorce Decree of an existing Liquor License

1. Current Licensee's Name: _____
(Exactly as it appear on the license) Last First Middle
2. Assignee's Name: _____
Last First Middle
3. License Type: _____ License Number: _____

ATTACH TO THIS APPLICATION A CERTIFIED COPY OF THE WILL, PROBATE DISTRIBUTION INSTRUMENT, OR DIVORCE DECREE THAT SPECIFICALLY DISTRIBUTES THE LIQUOR LICENSE TO THE ASSIGNEE.

SECTION 10 Government (for cities, towns, or counties only)

1. Government Entity: _____
2. Person/Designee: _____
First Last Middle Day time Contact Phone #

A SEPARATE LICENSE MUST BE OBTAINED FOR EACH PREMISE FROM WHICH SPIRITUOUS LIQUOR IS SERVED.

SECTION 11 Location to Location Transfer: Series 6 Bar, Series 7 Beer & Wine Series 9 Liquor Stores only)

1. Current Business: Name: Pima Liquors
Address: 2858 W. Draper St. Tucson, AZ 85746
(Exactly as it appears on license)
2. New Business: Name: Pima Liquors
Address: 2880 W. Draper St. Tucson, AZ 85746
1. License Type: 9-Liquor Store License Number: 09100101

STATE OF ARIZONA
DEPARTMENT OF LIQUOR LICENSES
AND CONTROL
ALCOHOLIC BEVERAGE LICENSE
License 09100101

Issue Date: 7/11/2001

Expiration Date: 10/31/2016

Issued To:

FADHL NAGI OBEID ALDHALI, Agent
PIMA LIQUORS INC, Owner

Location:

PIMA LIQUORS
2858 W DREXEL RD
TUCSON, AZ 85746

Mailing Address:

FADHL NAGI OBEID ALDHALI
PIMA LIQUORS INC
PIMA LIQUORS
2858 W DREXAL RD
TUCSON, AZ 85746

EXP 10/31/2016

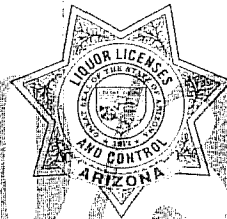

POST THIS LICENSE IN A CONSPICUOUS PLACE

SECTION 12 Person to Person Transfer

16 MAY 18 04:14 PM 1152

Questions to be completed by Current Licensee (Bar and Liquor Stores Only- Series, 06, 07, and 09)

1. Individual Owner / Agent Name: _____ Entity: _____
Last First Middle (Individual, Agent, Etc.)

2. Ownership Name: _____
(Exactly as it appears on license)

3. Business Name: _____
(Exactly as it appears on license)

4. Business Location Address: _____
Street City State Zip

5. License Type: _____ License Number: _____

6. Current Mailing Address: _____
Street City State Zip

7. Have all creditors, lien holders, interest holders, etc. been notified? ☐ Yes ☐ No

8. Does the applicant intend to operate the business while this application is pending? ☐ Yes ☐ No

If yes, complete Section 5 (**Interim Permit**) of this application; attach fee, and current license to this application.

9. I, (Print Full Name) _____ hereby authorize the department to process this Application to transfer the privilege of the license to the applicant provided that all terms and conditions of sale are met. Based on the fulfillment of these conditions, I certify that the applicant now owns or will own the property rights of the license by the date of issue.

I, (Print Full Name) _____, declare that I am the **CURRENT OWNER, MEMBER, PARTNER STOCKHOLDER or LICENSEE** of the stated license. I have read the above Section 12 and confirm that all statements are true, correct, and complete.

NOTARY

X _____
(Signature of CURRENT Individual Owner/Agent)

State of _____ County of _____
The foregoing instrument was acknowledged before me this

My commission expires on: _____
Date

_____ of _____
Day Month Year

Signature of NOTARY PUBLIC

SECTION 13 Proximity to Church or School

16 MAY 18 10:47 AM 1152

Questions to be completed by all in-state applicants.

A.R.S. § 4-207. (A) and (B) state that no retailer's license shall be issued for any premises which are at the time the license application is received by the director, within three hundred (300) horizontal feet of a church, within three hundred (300) horizontal feet of a public or private school building with kindergarten programs or grades one (1) through (12) or within three hundred (300) horizontal feet of a fenced recreational area adjacent to such school building.

The above paragraph DOES NOT apply to:

- a) Restaurant license (§ 4-205.02) Series 12
- b) Hotel/motel license (§ 4-205.01) Series 11
- c) Microbrewery Series 3
- d) Craft Distillery Series 18

- e) Government license (§ 4-205.03) Series 5
- f) Fenced playing area of a golf course (§ 4-207(B)(5))
- g) Wholesaler Series 4
- h) Farm Winery Series 13

1. Distance to nearest School: 2,112 FEET Name of School: PISCATAWAY MIDDLE SCHOOL
(If less than one (1) mile note footage) Address: 5455 S. CARDINAL AVE.
TULSON, AZ 85746

2. Distance to nearest Church: 2,1640 FEET Name of Church: DREXEL HERBERT TRUST
(If less than one (1) mile note footage) Address: 2880 W. DREXEL RD.
TULSON, AZ 85746

SECTION 14 Business Financials

1. I am the: ☒ Lessee ☐ Sub-lessee ☐ Owner ☐ Purchaser ☐ Management Company

2. If the premise is leased give lessors: Name: FADHL NAGI OBEID ALDHALI
Address: 2880 W. DREXEL RD. TULSON, AZ 85746
Street City State Zip

3. Monthly Rent/ Lease Rate: \$ 2,000.00

4. What is the remaining length of the lease? Yrs. 5 Months 0

5. What is the penalty if the lease is not fulfilled? \$ 0 or Other: LONG TERM DEPOSIT \$3,000
(Give details-attach additional sheet if necessary)

6. Total money borrowed for the Business not including lease? \$ 0 (CAPITAL CONTRIBUTIONS)
Please List Lenders/People you owe money to for business.

Last	First	Middle	Amount Owed	Mailing Address	City	State	Zip
N	A		N/A	N/A			

(Attach additional sheet if necessary)

7. What type of business will this license be used for (be specific)?

C-STORE

8. Has a license or a transfer license for the premises on this application been denied by the state with in the past (1) year? ☐ Yes ☒ No If yes, attach explanation.

9. Does any spirituous liquor manufacture, wholesaler, or employee have an interest in your business? ☐ Yes ☒ No

10. Is the premises currently license with a liquor license? ☐ Yes ☒ No

If yes, give license number and licensee's name:

License #: N/A Individual Owner /Agent Name: N/A
(Exactly as it appears on license)

SECTION 15 Restaurant or hotel/motel license applicants

16 MAY 18 11:41 AM 1152

1. Is there an existing Restaurant or Hotel/Motel Liquor License at the proposed location? ☐ Yes ☐ No
2. If the answer to Question 1 is YES, you may qualify for an Interim Permit to operate while your application is pending; consult A.R.S. § 4-203.01; and complete SECTION 5 of this application.
3. All Restaurant and Hotel/Motel applicants must complete a Restaurant Operation Plan form provided by the Department of Liquor Licenses and Control.
4. As stated in A.R.S. § 4-205.02. (H)(2), a Restaurant is an establishment which derives at least forty (40) percent of its gross revenue from the sale of food. Gross revenue is the revenue derived from sales of food and spirituous liquor on the licensed premises. By applying for this ☐ Restaurant ☐ Hotel/Motel, I certify that I understand that I must maintain a minimum of forty (40) percent food sales based on these definitions and have included the Restaurant Hotel/Motel Records Required for Audit form with this application.

(Applicant's Signature)

5. I understand it is my responsibility to contact the Department of Liquor Licenses and Control to schedule an inspection when all tables and chairs are on site, kitchen equipment, and, if applicable, patio barriers are in place on the licensed premises. With the exception of the patio barriers, these items are not required to be properly installed for this inspection. Failure to schedule an inspection will delay issuance of the license. If you are not ready for your inspection 90 days after filing your application, please request an extension in writing; specify why the extension is necessary; and the new inspection date you are requesting.

(Applicant's Initials)

SECTION 16 Diagram of Premises

Check ALL boxes that apply to your business:

- ☒ Entrances/Exits ☒ Liquor storage areas **Patio:** ☐ Contiguous
☐ Walk-up windows ☒ Drive-through windows ☐ Non Contiguous

1. Is your licensed premises currently closed due to construction, renovation or redesign? ☒ Yes ☐ No
If yes, what is your estimated completion date? 09/15/2016

Month/Day/Year

2. Restaurants and Hotel/Motel applicants are required to draw a detailed floor plan of the kitchen and dining areas including the locations of all kitchen equipment and dining furniture. Place for diagram is on section 16 number 6.
3. The diagram (a detailed floor plan) you provide is required to disclose only the area(s) where spirituous liquor is to be sold, served, consumed, dispensed, possessed or stored on the premises unless it is a restaurant (see # 3 above).
4. Provide the square footage or outside dimensions of the licensed premises. Please do not include non-licensed premises such as parking lots, living quarters, etc.
5. As stated in A.R.S. § 4-207.01 (B), I understand it is my responsibility to notify the Department of Liquor Licenses and Control when there are changes to the boundaries, entrances, exits, added or deleted doors, windows, service windows or increase or decrease to the square footage after submitting this initial diagram.

F. A
(Applicant's Initials)

SECTION 16 Diagram of Premises – continued

*16 MAY 18 Lic. Lic. AM1153

6. On the diagram please show only the areas where spirituous liquor is to be sold, served, consumed, dispensed, possessed or stored. It must show all entrances, exits, interior walls, bars, hi-top tables, dining tables, dining chairs, dance floor, stage, game room, and the kitchen. DO NOT include parking lots, living quarters, etc. When completing diagram, North is up ↑.

If a legible copy of a rendering or drawing of your diagram of the premises is attached to this application, please write the words "DIAGRAM ATTACHED" in the box provided for the diagram on the application.

DIAGRAM OF PREMISES

SEE
Lined
Diagram

SECTION 16 CONT. "PUMA LIQUORS"

16 MAY 18 11:41 AM 1153

LIQUOR
 STORAGE

LIQUOR
 STORAGE

WORKING USE

REVENUE
 EQUIPMENT

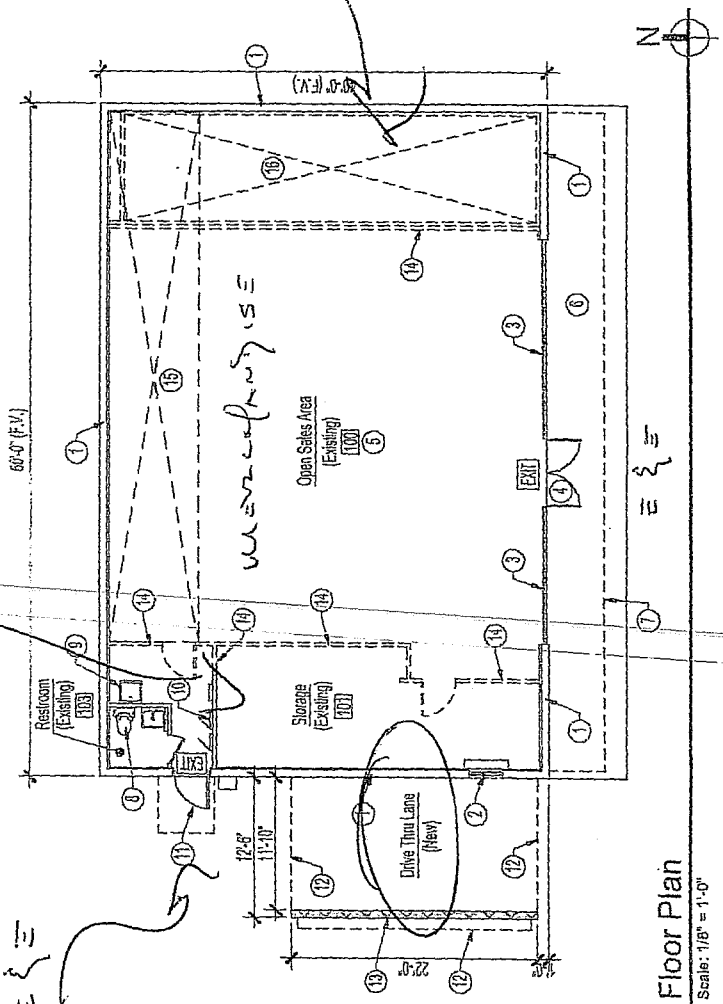

NOTARY

I, (Print Full Name) FADHL NAGI OBEID ALDHALI, hereby declare that I am the Owner/Agent filing this application as stated in Section 4 # 1. I have read this application and verify all statements to be true, correct and complete.

X [Signature]
(Signature of CURRENT Individual Owner/Agent)

State of Arizona County of Pima
The foregoing instrument was acknowledged before me this

My commission expires on: June 5, 2017
Date

3rd of May, 2014
Day Month Year

[Signature]
Signature of NOTARY PUBLIC

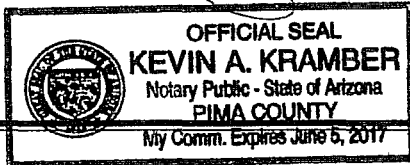

A.R.S. § 41-1030. Invalidity of rules not made according to this chapter; prohibited agency action; prohibited acts by state employees; enforcement; notice

B. An agency shall not base a licensing decision in whole or in part on a licensing requirement or condition that is not specifically authorized by statute, rule or state tribal gaming compact. A general grant of authority in statute does not constitute a basis for imposing a licensing requirement or condition unless a rule is made pursuant to that general grant of authority that specifically authorizes the requirement or condition.

D. THIS SECTION MAY BE ENFORCED IN A PRIVATE CIVIL ACTION AND RELIEF MAY BE AWARDED AGAINST THE STATE. THE COURT MAY AWARD REASONABLE ATTORNEY FEES, DAMAGES AND ALL FEES ASSOCIATED WITH THE LICENSE APPLICATION TO A PARTY THAT PREVAILS IN AN ACTION AGAINST THE STATE FOR A VIOLATION OF THIS SECTION.

E. A STATE EMPLOYEE MAY NOT INTENTIONALLY OR KNOWINGLY VIOLATE THIS SECTION. A VIOLATION OF THIS SECTION IS CAUSE FOR DISCIPLINARY ACTION OR DISMISSAL PURSUANT TO THE AGENCY'S ADOPTED PERSONNEL POLICY.

F. THIS SECTION DOES NOT ABROGATE THE IMMUNITY PROVIDED BY SECTION 12-820.01 OR 12-820.02.