

**BOARD OF SUPERVISORS AGENDA ITEM SUMMARY**

Requested Board Meeting Date: March 3, 2015  
TRANSPORTATION AGENDA

---

ITEM SUMMARY, JUSTIFICATION and/or SPECIAL CONSIDERATIONS:

**Seeking permission to advertise on March 6, and March 13, 2015.**

Establishment of a public road, this road being:

Irving Avenue and Tennessee Place  
Road Establishment No. 3020  
Ramon Valadez - District 2

Hearing Date: March 17, 2015

The purpose of Road Proceeding No. 3020 is to establish Irving Avenue, Alvernon Manor, Bk:14, Pg: 100 and Tennessee Place, Contractors Industrial Park, Bk: 20, Pg: 23.

**Seeking Permission to Advertise**

CONTRACT NUMBER (If applicable)

---

STAFF RECOMMENDATION(S): The Transportation Department recommends that the Board of Supervisors approve permission to advertise.

---

CLERK OF THE BOARD USE ONLY BOS:MTG. \_\_\_\_\_

ITEM NO. \_\_\_\_\_

PIMA COUNTY COST: \$ \_\_\_\_\_ and/or REVENUE TO PIMA COUNTY \$ \_\_\_\_\_

FUNDING SOURCE(S): \_\_\_\_\_  
(i.e. General Fund, State Grant Fund, Federal Fund, Stadium District Fund, etc.)

ADVERTISED PUBLIC HEARING: YES NO X

BOARD OF SUPERVISORS DISTRICT: 1 2 X 3 4 5 All

IMPACT:

IF APPROVED:

Will proceed to advertise on: March 6 and March 13, 2015.

IF DENIED:

Will not advertise and will not pursue the establishment of Irving Avenue and Tennessee Place and there will not be a clear delineation of road right-of-way for these two roads.

---

DEPARTMENT NAME: Transportation

DEPARTMENT DIRECTOR: Priscilla Cornelio, P.E. 

PROJECT MANAGER: David Cummings, P.E. - Operations Division Manager

CONTACT PERSON: \* Claire Logue - Office 724-6332

\*return item to processing contact

**PETITION FOR PUBLIC HIGHWAY**

**ROAD PROCEEDING NO. 3020**

Honorable Board of Supervisors  
Pima County, Arizona

Honorable members of the Board of Supervisors:

The Pima County Engineer respectfully petitions that, pursuant to A.R.S. § 28-6701(B), the Board of Supervisors establish and declare as a County Highway the roads being more fully described in the attached Exhibit A.

Dated this 10th day of February, 2015

A handwritten signature in black ink, appearing to read 'Priscilla S. Cornelio', is written over a horizontal line.

Priscilla S. Cornelio P.E., Pima County Engineer

## NOTICE OF PUBLIC HEARING

### PIMA COUNTY BOARD OF SUPERVISORS

Notice is hereby given that the Pima County Board of Supervisors will hold a public hearing for the proposed Establishment of Irving Avenue and Tennessee Place. These county roads are situated within a portion of Section 34, Township 14 South, Range 14 East, Gila and Salt River Meridian, Pima County, Arizona. MORE PARTICULARLY DESCRIBED AS FOLLOWS:

#### SEE EXHIBIT "A"

The public hearing for the Establishment of this road will be held on **Tuesday, March 17, 2015 at 9:00 A.M.**, or thereafter, located at the Pima County Administration Building, Board of Supervisors Hearing Room, 130 West Congress, 1<sup>st</sup> Floor, Tucson, Arizona.

A copy of the proposed Establishment for the aforementioned road can be obtained at the Pima County Department of Transportation, EIM/Mapping and Records, 201 North Stone Avenue, 5<sup>th</sup> Floor or by calling (520) 724-6332.

Dated this 10<sup>th</sup> day of FEBRUARY, 2015



Priscilla S. Cornelio, P.E., Director  
Pima County Department of Transportation

06 February 2015

**EXHIBIT "A"**  
**LEGAL DESCRIPTION**  
**ESTABLISHMENT PROCEEDINGS NUMBER 3020**  
**IRVING AVENUE AND TENNESSEE PLACE**

All that portion of Alvernon Manor, re-subdivided Lots 6-7, Block C, a subdivision plat recorded in Book 14 of Maps and Plats at Page 100, and Contractors Industrial Park, Lots 1 thru 18, a subdivision plat recorded in Book 20 of Maps and Plats at Page 23, recorded in the office of the Pima County Recorder, Arizona, being located in the Southeast Quarter of Section 34, Township 14 South, Range 14 East, Gila & Salt River Meridian, Pima County, Arizona, more particularly described as follows:

All that portion of the dedicated rights of ways as shown on said subdivision plat of Alvernon Manor, including all of the 30 foot alley west of Lots 1 through 9, all of the 30 foot alley east of Lots 10 through 18, the 10 feet north of and adjacent to Lots 1 and 18 and all of Irving Avenue lying north of that parcel as described in Docket 9551 at Page 3090;

Together with,

All that portion of the dedicated rights of ways as shown on said subdivision plat of Contractors Industrial Park, Lots 1 thru 18 including all the 30 foot alley west of Lots 10 through 18, the 10 feet north of and adjacent to Lots 1, 2, 17 and 18 and all of Tennessee Place, excepting therefrom that portion of Tennessee Place west of and adjacent to Lot 1 as described in Docket 12350 at Page 229.



Expires 31 March 2018



# DEPICTION OF "EXHIBIT A"

SECTION 34  
TOWNSHIP 14 SOUTH  
RANGE 14 EAST

IRVING AVE,  
TENNESSEE PLACE  
& ALLEYS

SUBJECT  
AREA

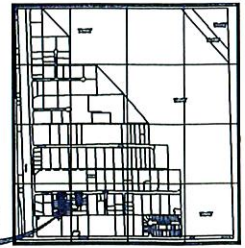

SECTION 34  
G&SRM  
PIMA COUNTY, ARIZONA

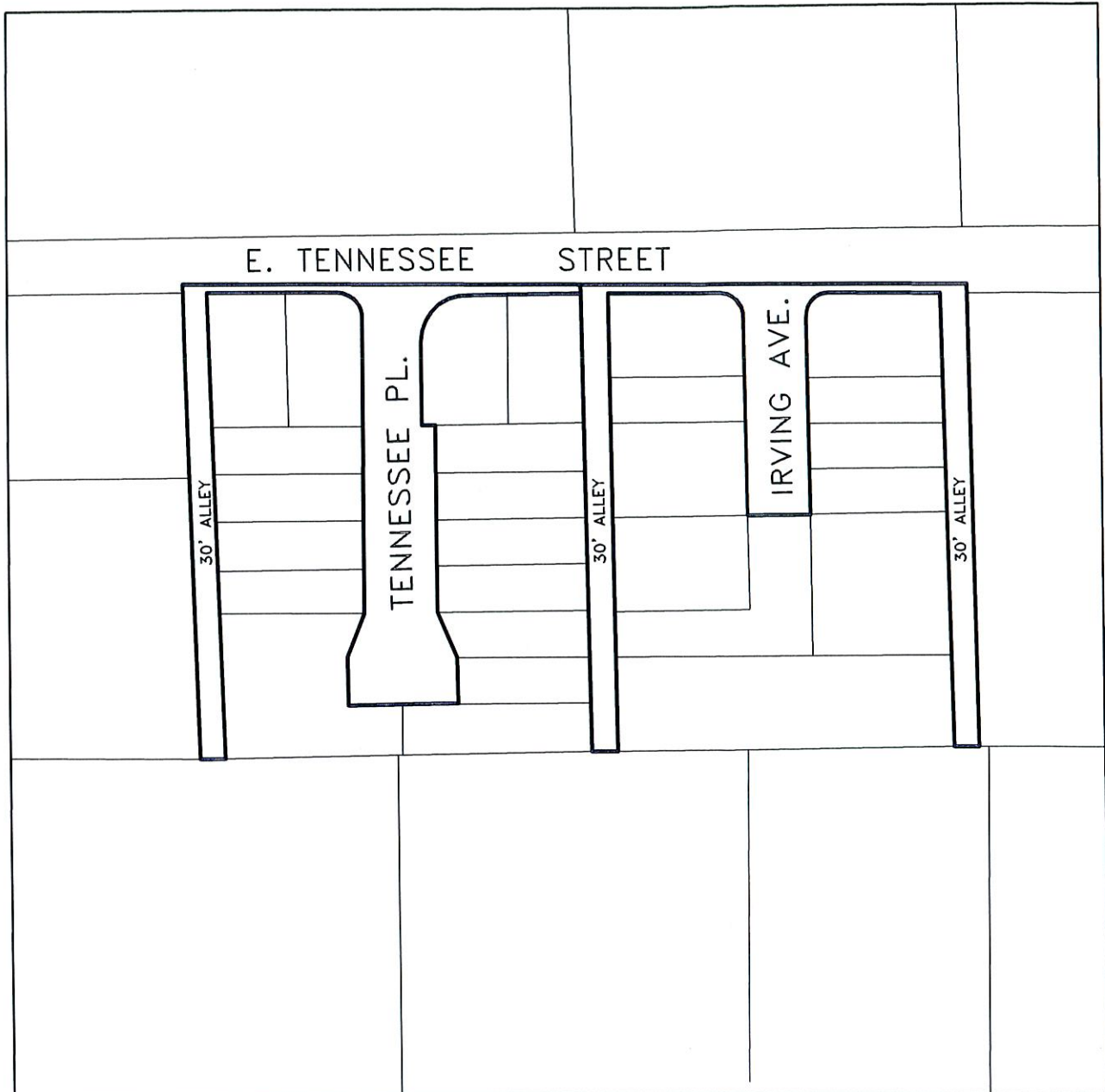

ROAD ESTABLISHMENT - PROC N. 3020



3020

PIMA COUNTY DEPARTMENT OF TRANSPORTATION  
ENGINEERING INFORMATION MANAGEMENT

DRAWING NOT TO SCALE

DRAWN BY: SRBUTLER

DATE: FEB 2015