



## BOARD OF SUPERVISORS AGENDA ITEM REPORT

Requested Board Meeting Date: 6/21/2022

*\*= Mandatory, information must be provided*

Click or tap the boxes to enter text. If not applicable, indicate "N/A".

**\*Title:**

Electric Easement to Tucson Electric Power Company ("TEP")

**\*Introduction/Background:**

On behalf of a private property owner, TEP has requested an electric easement across Pima County property located along the alignment of the Julian Wash, lying within Section 11, Township 15, Range 14, G&SRM, Pima County, Arizona, as shown on attached Location Map.

File # E-0285

**\*Discussion:**

TEP requests the easement for the connection of existing facilities for a nearby residential subdivision of Valencia Crossing.

**\*Conclusion:**

This request has been reviewed by appropriate County staff and they agree to granting the easment.

**\*Recommendation:**

Staff recommends that the Pima County Board of Supervisors approve the easement by unanimous consent to avoid auctioning the easement pursuant to ARS '11-251(9). Upon approval, staff will record the necessary conveyance document.

**\*Fiscal Impact:**

Pima County received \$800 in revenue, which is the appraised value of the easement.

**\*Board of Supervisor District:**

☐ 1 ☒ 2 ☐ 3 ☐ 4 ☐ 5 ☐ All

Department: Real Property Services

Telephone: 724-6313

Contact: Tim Murphy

Telephone: 724-6379

Department Director Signature: \_\_\_\_\_

Date: 5/31/2022

Deputy County Administrator Signature: \_\_\_\_\_

Date: 6/2/2022

County Administrator Signature: \_\_\_\_\_

Date: 6/2/2022

# LOCATION MAP

SECTION 11  
TOWNSHIP 15 SOUTH  
RANGE 14 EAST

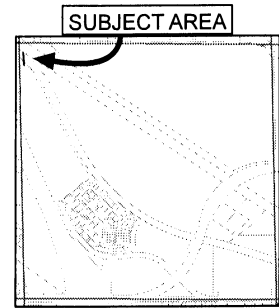

SECTION 11G&SRM  
PIMA COUNTY, ARIZONA

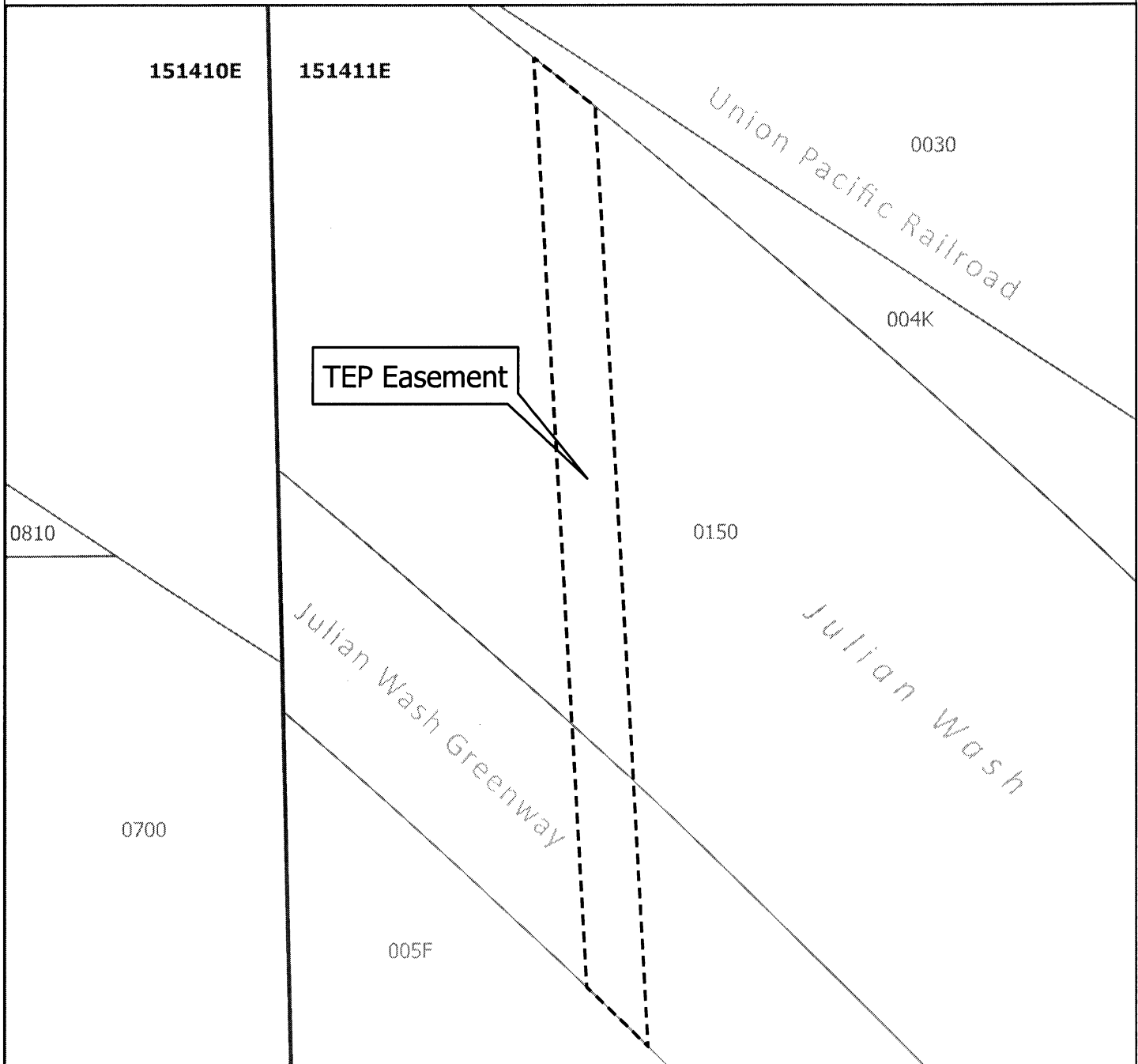

22033

PIMA COUNTY DEPARTMENT OF TRANSPORTATION  
ENGINEERING INFORMATION MANAGEMENT

DRAWING NOT TO SCALE DRAWN BY: O CONSTANTINO DATE: APR 2022

## LEGEND

 Easement, E-0285