

BOARD OF SUPERVISORS AGENDA ITEM SUMMARY

Requested Board Meeting Date: July 2, 2013
TRANSPORTATION AGENDA

ITEM SUMMARY, JUSTIFICATION and/or SPECIAL CONSIDERATIONS:

Seeking permission to advertise on July 12, and July 19, 2013.

Establishment of public roads, these road being:

Panorama Drive and Orange Grove Road
Road Establishment No. 3016
Sharon Bronson - District 3

Hearing Date: August 6, 2013

The purpose of Road Proceeding No. 3016 is to establish a segment of road right-of-way along Panorama Drive to Silverbell Road and the section connecting Orange Grove Road to Panorama Drive. This establishment would reflect the improvements completed under Pima County roadway project number 40GSBI.

Seeking Permission to Advertise

CONTRACT NUMBER (If applicable)

STAFF RECOMMENDATION(S): The Transportation Department recommends that the Board of Supervisors approve permission to advertise.

CLERK OF THE BOARD USE ONLY BOS MTG. _____
ITEM NO. _____

PIMA COUNTY COST: \$ Minimal and/or REVENUE TO PIMA COUNTY \$ _____

FUNDING SOURCE(S): _____
(i.e. General Fund, State Grant Fund, Federal Fund, Stadium District Fund, etc.)

ADVERTISED PUBLIC HEARING: YES NO X

BOARD OF SUPERVISORS DISTRICT: 1 2 3 X 4 5 All

IMPACT:

IF APPROVED:

Will proceed to advertise on: July 12 and July 19, 2013.

IF DENIED:

Will not advertise and will not pursue establishment of roads and there will not be a clear delineation of road right-of-way where Panorama Drive connects to Silverbell Road and the section connecting Orange Grove Road to Panorama Drive.

DEPARTMENT NAME: Transportation

CONTACT PERSON: Claire Logue, TELEPHONE NO.: 724-6332 ext 6737

DEPARTMENT DIRECTOR:  DATE: 6/12/13



PIMA COUNTY
DEPARTMENT OF TRANSPORTATION
201 NORTH STONE AVENUE, FOURTH FLOOR
TUCSON, ARIZONA 85701-1207

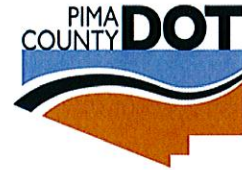

PRISCILLA S. CORNELIO, P. E.
DIRECTOR

(520) 724-6410
FAX (520) 724-6439

PETITION FOR PUBLIC HIGHWAY

PROCEEDING NO. 3016

Honorable Board of Supervisors
Pima County, Arizona

Honorable members of the Board of Supervisors:

The undersigned, being residents and taxpayers of Pima County, respectfully petition that the road as described herein be established and declared a county highway.

The establishment of said road(s) to be Varies in width.

The roads to be known as Panorama Drive and Orange Grove Road or Road No. 3016.

Dated at Tucson, Arizona, this 4th day of June, 2013

	<u>PRINT NAME</u>	<u>SIGNATURE</u>	<u>ADDRESS</u>	<u>ZIP CODE</u>
1.	SANDRA BUTLER	<i>[Signature]</i>	7195 S Monks Tale Dr	85756
2.	LINDA SAGARNAGA	<i>[Signature]</i>	4601 S. CAMINO DE OESTE	85746
3.	GAIL TEBOCKHOSE	<i>[Signature]</i>	8420 E. Brookside Lane	85710
4.	LYNN JARZOMBEK	<i>[Signature]</i>	2880 W. Coyote Desert Dr.	85755
5.	Charisa R. Lewis	<i>[Signature]</i>	4760 N. Hancock Circle	85749
6.	Jonathan Crowe	<i>[Signature]</i>	939 N. 9th Ave, Tucson	85705
7.	MATT ZOLL	<i>[Signature]</i>	1010 E. Palomar Dr. Tucson	85711
8.	Jim Harms	<i>[Signature]</i>	9855 N. ALBATROSS DR TUCSON	85742
9.	Michael Hicks	<i>[Signature]</i>	2530 S. Keen Dr. Tucson	85748
10.	Victoria A Sympson	<i>[Signature]</i>	1549 E. SENECA ST TUCSON	85705

NOTICE OF PUBLIC HEARING

PIMA COUNTY BOARD OF SUPERVISORS

Notice is hereby given that the Pima County Board of Supervisors will hold a public hearing for the proposed Establishment of Panorama Drive and Orange Grove Road these county roads are situated within portions of Section 1 and Section 12 in T13S, R12E, Gila and Salt River Meridian, Pima County, Arizona. MORE PARTICULARLY DESCRIBED AS FOLLOWS:

SEE EXHIBIT "A"

The public hearing for the Establishment of these roads will be held on **Tuesday, August 6, 2013 at 9:00 A.M.**, or thereafter, located at the Pima County Administration Building, Board of Supervisors Hearing Room, 130 West Congress, 1st Floor, Tucson, Arizona.

A copy of the proposed Establishment for the aforementioned road can be obtained at the Pima County Department of Transportation, EIM/Mapping and Records; 201 North Stone Avenue, 5th Floor or by calling (520) 724-6332.

Dated this 12th day of June, 2013



Priscilla S. Cornelio, P.E., Director
Pima County Department of Transportation

Published: Daily Territorial
July 12th and July 19th, 2013



Pima County
Survey

01 May 2013

EXHIBIT "A"
LEGAL DESCRIPTION
ESTABLISHMENT PROCEEDINGS NUMBER 3016
PANORAMA DRIVE AND ORANGE GROVE ROAD

All that portion of Rancho Panorama Estates, a subdivision plat recorded in Book 10 of Maps and Plats at Page 48, recorded in the office of the County Recorder, Pima County, Arizona, being located in the Northeast Quarter of Section 12, Township 13 South, Range 12 East, Gila & Salt River Meridian, Pima County, Arizona, and all that portion of that parcel as described in Docket 13362 at Page 1971, recorded in the office of the County Recorder, Pima County, Arizona, being located in the Southeast Quarter of Section 1, Township 13 South, Range 12 East, Gila & Salt River Meridian, Pima County, Arizona, more particularly described as follows:

PANORAMA DRIVE

The North 30.00 feet of the East 240.00 feet of the West 871.22 feet of said Rancho Panorama Estates subdivision, excluding any portion lying in the existing Panorama Drive as shown in Road Establishment Proceeding #2849.

ORANGE GROVE ROAD

COMMENCING at the South one quarter corner of said Section 1, a found ½ inch rebar with tag stamped "PCDOT 24" to which a witness corner to the Southeast corner of said Section 1, a found 2 inch ACP stamped "Collins Pena, RLS21765, W.C. 350 feet" bears North 89°48'55" East a distance of 2,272.22 feet, said line being the Basis of Bearing as established from the Arizona Coordinate System, 1983 (HARN92), Central Zone 0202;

THENCE along the south line of said Section 1, North 89°48'55" East a distance of 628.88 feet to the **POINT OF BEGINNING**;

THENCE North 00°50'40" West a distance of 107.18 feet to the beginning of a tangent curve concave to the east having a radius of 325.00 feet and a central angle of 13°02'16";

THENCE along the arc of said curve to the right a distance of 73.95 feet to a point of reverse curve of a curve concave to the west having a radius of 40.00 feet and a central angle of 77°51'28";

THENCE along the arc of said curve to the left a distance of 54.36 feet to a point of cusp on the south right of line of Silverbell Road;

THENCE along said south right of way line South $65^{\circ}39'53''$ East a distance of 70.45 feet to the beginning of a tangent curve concave to the south having a radius of 1,572.02 feet and a central angle of $02^{\circ}25'21''$;

THENCE continuing along said south right of way line and curve to the right a distance of 66.47 feet to a point of cusp of a curve concave to the southeast having a radius of 40.00 feet and a central angle of $111^{\circ}50'40''$ and to which a radial line bears North $26^{\circ}45'28''$ East;

THENCE along the arc of said curve to the left a distance of 78.08 feet to point of compound curve of a curve concave to the east having a radius of 275.00 feet and a central angle of $05^{\circ}45'29''$;

THENCE along the arc of said curve to the left a distance of 27.64 feet to a point of tangency;

THENCE South $00^{\circ}50'40''$ East a distance of 107.75 feet to a point on the south line of said Section 1;

THENCE along said south line South $89^{\circ}48'55''$ West a distance of 50.00 feet to the **POINT OF BEGINNING**.

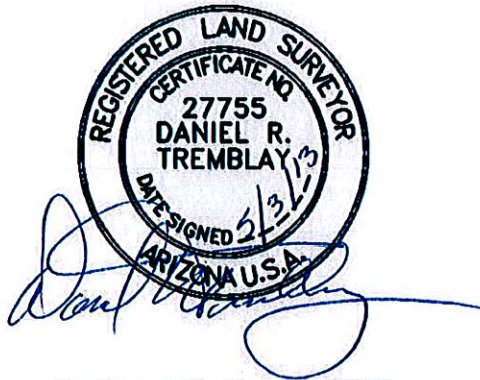

Expires 31 March 2015

PANORAMA DRIVE AND ORANGE GROVE ROAD ESTABLISHMENT #3016

SECTION 01
TOWNSHIP 13 SOUTH
RANGE 12 EAST

SECTION 12
TOWNSHIP 13 SOUTH
RANGE 12 EAST

PROJECT LOCATION

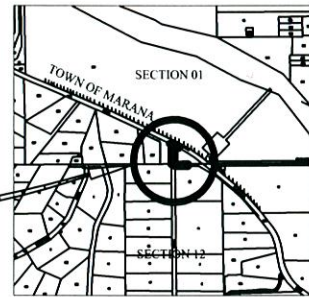

SECTION 01 & 12 G&SRM
PIMA COUNTY, ARIZONA

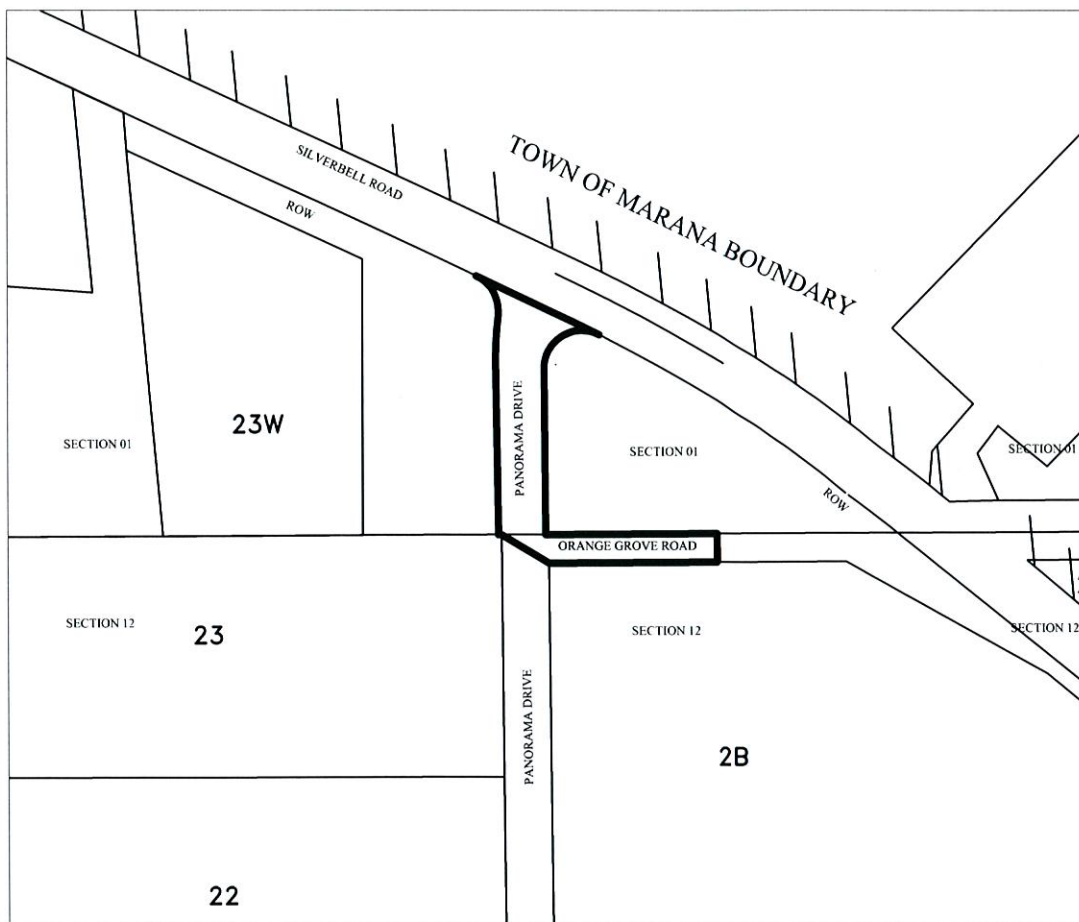

ESTABLISHMENT #3016



3016

PIMA COUNTY DEPARTMENT OF TRANSPORTATION
ENGINEERING INFORMATION MANAGEMENT

DRAWING NOT TO SCALE

DRAWN BY: R. CANCINO

DATE: MARCH 2013