



BOARD OF SUPERVISORS AGENDA ITEM REPORT

Requested Board Meeting Date: August 7, 2018

Title: Easement to Southwest Gas Corporation ("SWG")
File # E-0094

Introduction/Background:

SWG has requested an extension of an existing easement across Pima County Flood Control District owned property lying within Section 18, Township 14, Range 14 G&SRM, Pima County, Arizona, as shown on the attached Location Map.

Discussion:

SWG has determined they need the extended easement for new pipeline to be installed within the Arroyo Chico basin.

Conclusion:

This request has been reviewed by appropriate County staff and they recommend granting the easement.

Recommendation:

Staff recommends that the Pima County Flood Control District Board of Directors approve the Easement pursuant to ARS 48-3603(K). Upon approval, staff will record the necessary conveyance document.

Fiscal Impact:

Pima County Flood Control District received \$1300.00 which includes \$100.00 in revenue and \$1200.00 in reimbursement for the appraisal fee.

Board of Supervisor District:

1 2 3 4 5 All

Department: Real Property Services Telephone: 724-6311

Contact: Tim Murphy Telephone: 724-6379

Department Director Signature/Date:  6/15/2018

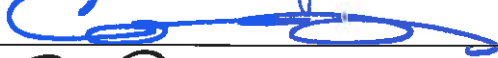
Deputy County Administrator Signature/Date:  6/18/18

County Administrator Signature/Date:  6/19/18



BLOCK 57 UNIVERSITY HEIGHTS
BOOK 3 MAPS & PLATS PAGE 102

13TH STREET
MONUMENT LINE

1" = 50' (ABANDONED PER SEQUENCE
NO. 20131960679)

FOUND 2" DIAM.
BRASS CAP WITH
PUNCH MARK
ONLY

P.O.T.

P.O.B.

EXISTING 15.00'
WIDE P.U.E. PER
SEQUENCE NO.
20110100414

APN 124-12-274B
SEQUENCE NO. 20131960679

BLOCK 64 UNIVERSITY HEIGHTS
BOOK 3 MAPS & PLATS PAGE 102

N 00°55'06" W 286.00' (BASIS OF BEARINGS)
SANTA RITA AVENUE
(ABANDONED PER SEQUENCE
NO. 20131960679)

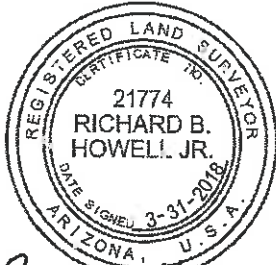

Richard B. Howell Jr.
EXPIRES 3/31/2021

MANLOVE STREET MONUMENT LINE

S 89°05'27" W 480.26'

LINE TABLE

NO.	BEARING	DISTANCE
L1	N 00°55'06" W	20.00'
L2	S 89°05'27" W	40.00'
L3	S 89°05'27" W	18.69'
L4	N 64°35'18" E	23.80'

FOUND 2" DIAMETER BRASS
CAP WITH PUNCH MARK AND
STAMPED "RLS 15343"

P.O.C.

FOUND 2" DIAMETER BRASS
CAP WITH PUNCH MARK AND
STAMPED "RLS 15343"

PROPERTY OWNER: PIMA COUNTY, ARIZONA

DATE: MARCH 31, 2018

SOUTHWEST GAS CORPORATION
SOUTHERN ARIZONA DIVISION
3401 EAST GAS ROAD
TUCSON, ARIZONA 85714

EXHIBIT "B"
WR #3392049 LRS #5934
GRANT OF EASEMENT IN A PORTION OF THE NW 1/4 OF SECTION
18, TOWNSHIP 14 SOUTH, RANGE 14 EAST, GILA AND SALT RIVER
MERIDIAN, PIMA COUNTY, ARIZONA