



BOARD OF SUPERVISORS AGENDA ITEM REPORT

Requested Board Meeting Date: April 4, 2017

Title: Approval of Sewer Easement to 1310 E. Ina Road, LLC (File E-0054)

Introduction/Background:

The applicant owns the adjacent property and has requested a sewer easement across Pima County owned property located at 1330 E. Ina Road, lying within Section 6, Township 13S, Range 14E G&SRM, Pima County, Arizona, as shown on attached Location Map.

Discussion:

This grant of easement request is the result of the adjacent property owner being unable to construct a septic system on his property due to soil conditions. In order to access the County sewer system, an easement is required across Pima County property.

Conclusion:

This request has been reviewed by appropriate County staff and they agree to granting the easement.

Recommendation:

Staff recommends that the Board of Supervisors approve the Sewer Easement by unanimous consent to avoid auctioning the easement. Upon approval, staff will record a Sewer Easement.

Fiscal Impact:

Pima County received \$1800 in revenue and \$800 for the cost of the appraisal.

Board of Supervisor District:

1 2 3 4 5 All

Department: Public Works Real Property Services

Telephone: 724-6379

Department Director Signature/Date:

[Handwritten Signature] 3/28/17

Deputy County Administrator Signature/Date:

[Handwritten Signature] 3/29/17

County Administrator Signature/Date:

[Handwritten Signature] 3/29/17

TOWNSHIP 13
RANGE 14
SECTION 06

LOCATION MAP

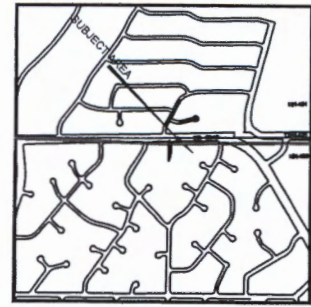

SEC 06 G&SRM
PIMA COUNTY, ARIZONA

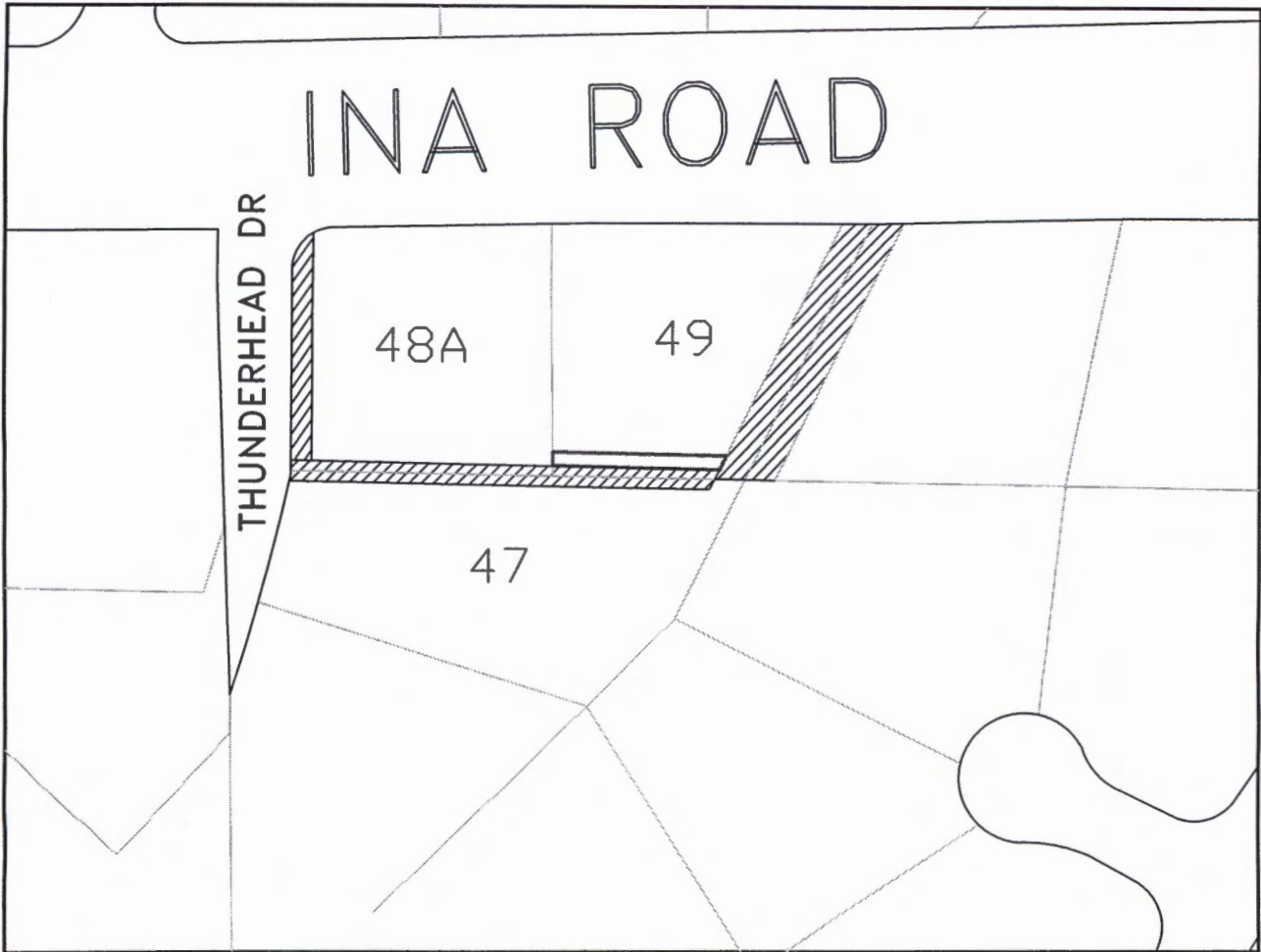

EXISTING UTILITY EASEMENTS

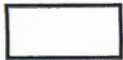

PROPOSED 10' PRIVATE SEWER EASEMENT



17018

PIMA COUNTY DEPARTMENT OF TRANSPORTATION
ENGINEERING INFORMATION MANAGEMENT

DRAWING NOT TO SCALE

DRAWN BY: S. BUTLER

DATE: FEB 2017