

Pima County Clerk of the Board

Julie Castañeda

Melissa Manriquez
Deputy Clerk

Administration Division
130 W. Congress, 5th Floor
Tucson, AZ 85701
Phone: (520)724-8449 • Fax: (520)222-0448

Management of Information & Records Division
1640 East Benson Highway
Tucson, Arizona 85714
Phone: (520) 351-8454 • Fax: (520) 791-6666

June 19, 2019

Roger Joel Pelton
Old Pueblo Cellars
1895 W. Ashbrook Drive
Tucson, AZ 85704

RE: Arizona Liquor License Job No.: 62747
d.b.a. Old Pueblo Cellars

Dear Mr. Pelton:

Enclosed is a copy of the Affidavit of Posting relative to your Liquor License Application for a Series 1, In-State Producer, which was received in our office on May 23, 2019. The Hearing before the Pima County Board of Supervisors has been scheduled for Tuesday, July 2, 2019, at 9:00 a.m. or thereafter, at the following location:

Pima County Administration Building
Board of Supervisors Hearing Room
130 W. Congress, 1st Floor
Tucson, AZ 85701

For your information, enclosed is a copy of the Zoning Inspector's Report. Any questions pertaining to the enclosed Report should be directed to Tom Drzazgowski at 724-9522. If you have any questions pertaining to the above referenced hearing, please contact this office at 724-8449.

Sincerely,

A handwritten signature in black ink, appearing to read "Julie Castañeda".

Julie Castañeda
Clerk of the Board

Enclosure

c: Tom Drzazgowski, Development Services Zoning Inspector



Arizona Department of Liquor Licenses and Control
800 W Washington 5th Floor
Phoenix, AZ 85007-2934
www.azliquor.gov
(602) 542-5141

AFFIDAVIT OF POSTING

Date of Posting: 5-28-19 Date of Posting Removal: 6-17-19

Applicant's Name: Old Pueblo Cellars
Pelton Roger Joel
Last First Middle

Business Address: 10088 N. Saint Patrick Road Tucson 85742
Street City Zip

License #: 62747

I hereby certify that pursuant to A.R.S. 4-201, I posted notice in a conspicuous place on the premises proposed to be licensed by the above applicant and said notice was posted for at least twenty (20) days.

Brian J. Rutledge Process Server PSD 520-301-1212
Print Name of City/County Official Title Phone Number

[Signature] 6-18-2019
Signature Date Signed

JUN 19 10 08 2019

Return this affidavit with your recommendations (i.e., Minutes of Meeting, Verbatim, etc.) or any other related documents. If you have any questions please call (602) 542-5141 and ask for the Licensing Division.



Pima County Clerk of the Board

Julie Castañeda

Melissa Manriquez
Deputy Clerk

Administration Division
130 W. Congress, 5th Floor
Tucson, AZ 85701
Phone: (520) 724-8449 • Fax: (520)222-0448

Management of Information & Records Division
1640 East Benson Highway
Tucson, Arizona 85714
Phone: (520) 351-8454 • Fax: (520) 791-6666

TO: Development Services, Zoning Division
FROM: Katrina Martinez
Administrative Specialist
DATE: May 23, 2019
RE: Zoning Report - Application for Liquor License

Attached is the application of:

Roger Joel Pelton
d.b.a. Old Pueblo Cellars
10088 N. Saint Patrick Road
Tucson, AZ 85742

Arizona Liquor License Job No. 62747
Series 1, In-State Producer
New License
Person Transfer
Location Transfer

ZONING REPORT

DATE: 6/17/19

Will current zoning regulations permit the issuance of the license at this location?

Yes

No

If No, please explain:

"Agricultural processing facilities, including wineries,"
Not allowed in SR ZONE. Requires different
zoning to qualify.

Pima County Zoning Inspector

When complete, please return to cob_mail@pima.gov

JUN 18 19 11 33 POC KCFB

Name:
ROGER JOEL PELTON

Title:
Managing Member

% Interest:
100.00

OLD PUEBLO CELLARS LLC - Managing Member

Name: ROGER JOEL PELTON
Gender: Male
Correspondence Address: 1895 WASHBROOK DRIVE
TUCSON, AZ 85704
USA
Phone: (520)551-1011
Alt. Phone: (214)725-1496
Email: ROGER.PELTON@GMAIL.COM

APPLICATION INFORMATION

Application Number: 62747
Application Type: New Application
Created Date: ~~04/12/2019~~ 5/21/19 SC

QUESTIONS & ANSWERS

001 In-state Producer

- 1) If you intend to operate the business while your application is pending you will need an interim permit pursuant to A.R.S.§4-203.01. Would you like to apply for an Interim Permit?
If yes, after completing this application, please go back to your Licensing screen, under New License Application choose "Interim Permit" from the drop-down window.
No
- 2) Have you submitted a questionnaire? Each person listed must submit a questionnaire and mail in a fingerprint card along with a \$22. processing fee per card.
No
A Document of type QUESTIONNAIRE is required.
- 3) Are you a tenant? (A person who holds the lease of a property; a lessee)
Yes
A Document of type LEASE is required.
- 4) Is there a penalty if lease is not fulfilled?
No
- 5) Are you a sub-tenant? (A person who holds a lease which was given to another person (tenant) for all or part of a property)
No
- 6) Are you the owner?
No
- 7) Are you a purchaser?
No
- 8) Are you a management company?
No
- 9) Is the Business located within the incorporated limits of the city or town of which it is located?
No
If no, in what City, Town, County or Tribal/Indian Community is this business located?
Pima County

- 10) What is the total money borrowed for the business not including the lease?
Please list lenders/people owed money for the business.
0
- 11) Have you provided a diagram of your premises?
No
A Document of type DIAGRAM/FLOOR PLAN is required.
- 12) Is there a drive through window on the premises?
No
- 13) If there is a patio please indicate contiguous or non-contiguous within 30 feet.
There is a patio for tasting of tax-paid (finished) wine. The patio is above ground and is directly above the winery, which is below grade.
- 14) Is your licensed premises now closed due to construction, renovation or redesign or rebuild?
Yes
If yes, what is your estimated completion date?
upon approval

DOCUMENTS

DOCUMENT TYPE	FILE NAME	UPLOADED DATE
ALIEN STATUS	ALIEN_STATUS_SIGNED.pdf	04/18/2019
LEASE	LEASE.pdf	04/18/2019
QUESTIONNAIRE	QUESTIONNAIRE_SIGNED.pdf	04/18/2019
DIAGRAM/FLOOR PLAN	DIAGRAM(WINERY).jpg	04/18/2019
DIAGRAM/FLOOR PLAN	DIAGRAM(TASTING).jpg	04/18/2019
	REVISED_winery.jpg	04/29/2019

19 MAY 21 11:47 AM '19

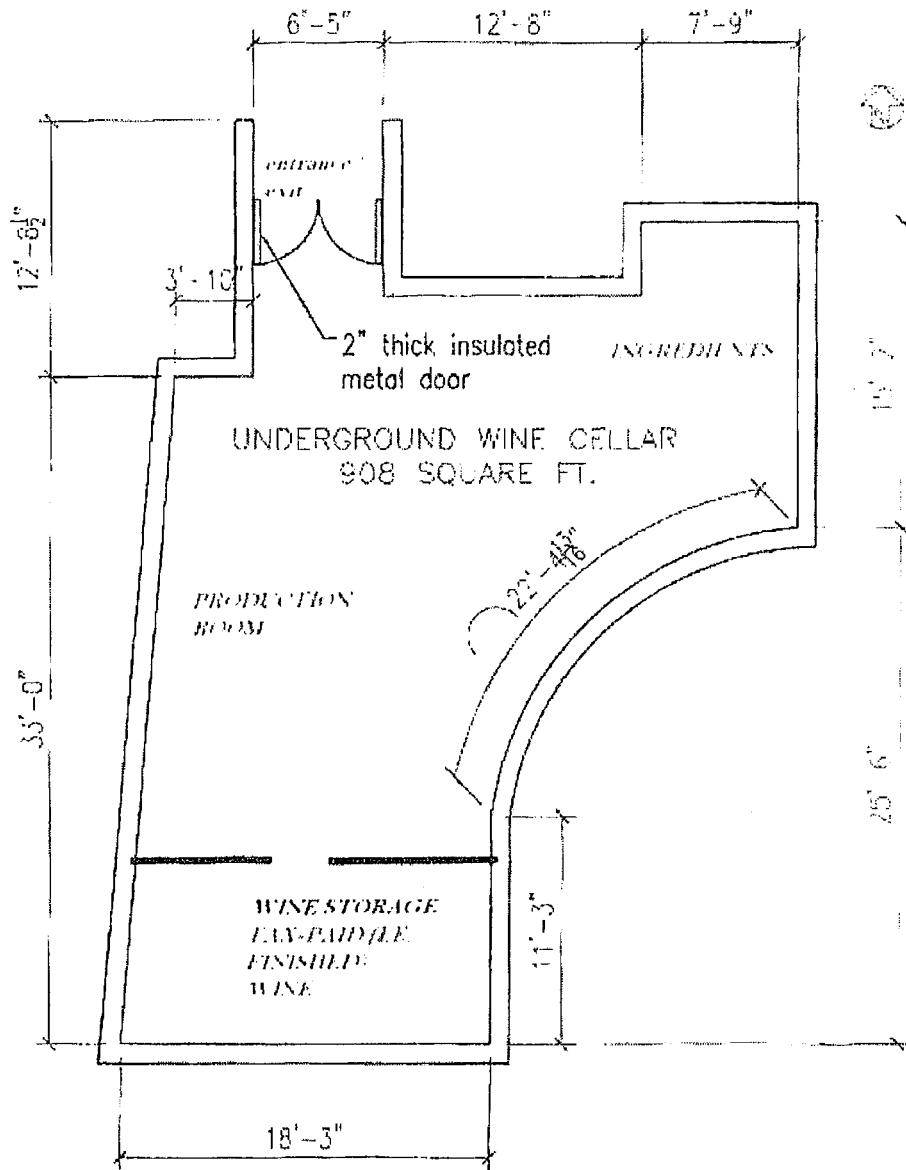

OLD PUEBLO CELLARS
TUCSON AZ