



Pima County Clerk of the Board

Julie Castañeda

Melissa Manriquez
Deputy Clerk

Administration Division
130 W. Congress, 5th Floor
Tucson, AZ 85701
Phone: (520)724-8449 • Fax: (520)222-0448

Document and Micrographics Mgt. Division
1640 East Benson Highway
Tucson, Arizona 85714
Phone: (520) 351-8454 • Fax: (520) 791-6666

May 18, 2017

Rebecca Debenport Safford
Tap & Bottle
4330 N. Via Sinuosa
Tucson, AZ 85745

RE: Arizona Liquor License No.: 07100045
d.b.a. Tap & Bottle

Dear Ms. Safford:

Enclosed is a copy of the Affidavit of Posting relative to your Liquor License Application for a Series 7, Beer & Wine Bar, which was received in our office on April 14, 2017. The Hearing before the Pima County Board of Supervisors has been scheduled for Tuesday, June 6, 2017, at 9:00 a.m. or thereafter, at the following location:

Pima County Administration Building
Board of Supervisors Hearing Room
130 W. Congress, 1st Floor
Tucson, AZ 85701

Should you have any questions pertaining to this matter, please contact this office at (520)724-8449.

Sincerely,

A handwritten signature in cursive script that reads "Castañeda".

Julie Castañeda
Clerk of the Board

Enclosure



Arizona Department of Liquor Licenses and Control
 800 W Washington 5th Floor
 Phoenix, AZ 85007-2934
 www.azliquor.gov
 (602) 542-5141

5/8

MAY 09 17 PM 02:08 PC CLK/CFD

AFFIDAVIT OF POSTING

Date of Posting: 4/17/17 Date of Posting Removal: 5/8/17

Applicant's Name: Tap & Bottle
Safford Rebecca Debenport
Last First Middle

Business Address: 7254 N. Oracle Road Tucson 85704
Street City Zip

License #: 07100045

I hereby certify that pursuant to A.R.S. 4-201, I posted notice in a conspicuous place on the premises proposed to be licensed by the above applicant and said notice was posted for at least twenty (20) days.

R. GRENIER #6175 PCSD 351-6000
Print Name of City/County Official Title Phone Number

[Signature] 5/8/17
Signature Date Signed

Return this affidavit with your recommendations (i.e., Minutes of Meeting, Verbatim, etc.) or any other related documents. If you have any questions please call (602) 542-5141 and ask for the Licensing Division.

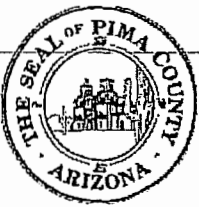

Pima County Clerk of the Board

Julie Castañeda

Administration Division
130 W. Congress, 5th Floor
Tucson, AZ 85701

Phone: (520) 724-8449 • Fax: (520)222-0448

Document and Micrographics Mgt. Division
1640 East Benson Highway
Tucson, Arizona 85714

Phone: (520) 351-8454 • Fax: (520) 791-6666

Melissa Manríquez
Deputy Clerk

TO: Development Services, Zoning Division

FROM: Ricci Romero 
Administrative Support Specialist Senior

DATE: April 14, 2017

RE: Zoning Report - Application for Liquor License

Attached is the application of:

Rebecca Debenport Safford
d.b.a. Tap & Bottle
7254 N. Oracle Road
Tucson, AZ 85704

Arizona Liquor License No. 07100045
Series 7, Beer & Wine Bar

New License

Person Transfer X

Location Transfer X

ZONING REPORT

DATE: 5/17/17

Will current zoning regulations permit the issuance of the license at this location?

Yes No

If No, please explain:

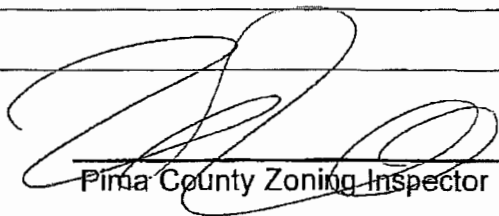

Pima County Zoning Inspector

When complete, please return to cob_mail@pima.gov

MAY 17 17PM 0449 PC CLK OF ED 



17 APR 6 Lir. Dept AM1116

17 MAR 22 Lir. Dept AM1119

Arizona Department of Liquor Licenses and Control
800 W Washington 5th Floor
Phoenix, AZ 85007-2934
www.azliquor.gov
(602) 542-5141

17-10-9286

Application for Liquor License
Type or Print with Black Ink

APPLICATION FEE AND INTERIM PERMIT FEES (IF APPLICABLE) ARE NOT REFUNDABLE
A service fee of \$25 will be charged for all dishonored checks (A.R.S. § 44-6852)

SECTION 1 This application is for a:

- Interim Permit (Complete Section 5)
New License (Complete Sections 2, 3, 4, 13, 14, 15, 16)
Person Transfer (Complete Section 2, 3, 4, 12, 13, 14, 16)
Location Transfer (Bars and Liquor Stores Only)
Probate/ Will Assignment/ Divorce Decree
Government (Complete Sections 2, 3, 4, 10, 13, 16)
Seasonal

SECTION 2 Type of Ownership:

- J.T.W.R.O.S (Complete Section 6)
Individual (Complete Section 6)
Partnership (Complete Section 6)
Corporation (Complete Section 7)
Limited Liability Co (Complete Section 7)
Club (Complete Section 8)
Government (Complete Section 10)
Trust (Complete Section 6)
Tribe (Complete Section 6)
Other (Explain)

SECTION 3 Type of license

1. Type of License: Series 7: Beer & Wine Bar LICENSE# 07100045

SECTION 4 Applicants

1. Individual Owner/Agent's Name: Safford Rebecca Debenport PID# 7340
2. Owner Name: Rebecca Safford Tap & Bottle Company, LLC B1048364
3. Business Name: Tap & Bottle
4. Business Location Address: 7254 N. Oracle Road Tucson AZ 85704 Pima
5. Mailing Address: 4330 N. Via Sinuosa Tucson AZ 85745 Pima
6. Business Phone: 520-743-6451 Daytime Contact Phone: 520-743-6451
7. Email Address: rebecca@thetapandbottle.com

8. Is the Business located within the incorporated limits of the above city or town? Yes No
9. Does the Business location address have a street address for a City or Town but is actually in the boundaries of another City, Town or Tribal Reservation? Yes No
If yes, what City, Town or Tribal Reservation is this Business located in:

10. Total Price paid for Series 6 Bar, Series 7 Beer & Wine Bar or Series 9 Liquor Store (license only) \$ 10,900.00

Fees: Application \$200.00, Department Use Only \$44.00, Total of All Fees \$244.00
Is Arizona Statement of Citizenship & Alien Status for State Benefits complete? Yes
Accepted by: W Date: 4/11/17 License # 07100045

SECTION 5 Interim Permit

- If you intend to operate business when your application is pending you will need an interim permit pursuant to ARS § 4-203.01
- There **MUST** be a valid license of the same type you are applying for currently issued to the location or for the replacement of a Hotel/Motel license with a Restaurant license pursuant to A.R.S § 4-203.01.

N/A

1. Enter license number currently at the location: _____

2. Is the license currently in use? Yes No If no, how long has it been out of use? _____

Attach a copy of the license currently issued at this location to this application.

I, _____ (Print Full Name)	declare that I am the CURRENT OWNER, AGENT, OR CONTROLLING PERSON on the stated license and location.
X _____ (Signature of CURRENT Individual Owner/Agent)	State of _____ County of _____ The foregoing instrument was acknowledged before me this _____
My commission expires on: _____ Date	_____ of _____ Day Month Year
_____ Signature of NOTARY PUBLIC	

SECTION 6 Individual, Partnership, J.T.W.R.O.S, Trust, Tribe Ownerships

EACH PERSON LISTED MUST SUBMIT A COMPLETED QUESTIONNAIRE, AN "APPLICANT" TYPE FINGERPRINT CARD AND \$22 PROCESSING FEE FOR EACH CARD.

Individual

Last	First	Middle	%Owned	Mailing Address	City	State	Zip Code

Is any person other than above, going to share in profit/losses of the business? Yes No

If Yes, give name, current address, and telephone number of person(s). Use additional sheets if necessary.

Last	First	Middle	Mailing Address	City	State	Zip Code	Phone #

Partnership

Name of Partnership: _____

General-Limited	Last	First	Middle	%Owned	Mailing Address	City	State	Zip Code
<input type="checkbox"/> <input type="checkbox"/>								
<input type="checkbox"/> <input type="checkbox"/>								
<input type="checkbox"/> <input type="checkbox"/>								
<input type="checkbox"/> <input type="checkbox"/>								

J.T.W.R.O.S (Joint Tenant with Rights of Survivorship)

Name of J.T.W.R.O.S: _____

Last	First	Middle	Mailing Address	City	State	Zip Code

SECTION 6 - continued

TRUST

Name of Trust: _____

Last	First	Middle	Mailing Address	City	State	Zip Code

TRIBE

Name of Tribal Ownership: _____

Last	First	Middle	Mailing Address	City	State	Zip Code

SECTION 7 Corporations/ Limited Liability Co

EACH PERSON LISTED MUST SUBMIT A COMPLETED QUESTIONNAIRE, AN "APPLICANT" TYPE FINGERPRINT CARD AND \$22 PROCESSING FEE FOR EACH CARD.

Corporation Complete Questions 1, 2, 3, 4, 5, 6, and 7

L.L.C. Complete Questions 1, 2, 3, 4, 5, 6, and 7

Tap & Bottle Company, LLC

1. Name of Corporation/ LLC: _____

2. Date Incorporated/Organized: 4/16/2012 State where Incorporated/Organized: Arizona

3. AZ Corporation or AZLLC File No: L-1754182-1 Date authorized to do Business in AZ: May 2013 5/11/12 RDS

4. Is Corp/LLC. Non Profit? Yes No

5. List Directors, Officers, Members in Corporation/LLC:

Last	First	Middle	Title	Mailing Address	City	State	Zip Code
Safford	Rebecca	Debenport	owner RDS <i>MEMBER</i>	4330 N Via Sinuosa	Tucson	AZ	85745
Safford	Scott	Jason	owner RDS <i>MEMBER</i>	4330 N. Via Sinuosa	Tucson	AZ	85745

(Attach additional sheet if necessary)

6. List all Stockholders/ percentage owners who own 10% or more:

Last	First	Middle	%Owned	Mailing Address	City	State	Zip Code
Safford	Rebecca	Debenport	50%	4330 N Via Sinuosa	Tucson	AZ	85745
Safford	Scott	Jason	50%	4330 N Via Sinuosa	Tucson	AZ	85745

(Attach additional sheet if necessary)

7. If the corporation/ LLC are owned by another entity, attach an Organizational FLOWCHART showing the structure of the ownership. Attach additional sheets as needed in order to disclose the Officers, Directors, Members, Managers, Partners, Stockholders and percentage owners of those entities

SECTION 8 Club Applicants

EACH PERSON LISTED MUST SUBMIT A COMPLETED QUESTIONNAIRE, AN "APPLICANT" TYPE FINGERPRINT CARD AND \$22 PROCESSING FEE FOR EACH CARD

1. Name of Club: _____
2. Is Club non-profit? Yes No
3. List all controlling members (minimum of four (4) requested)

Last	First	Middle	Mailing Address	City	State	Zip Code

(Attach additional sheet if necessary)

SECTION 9 Probate, Will Assignment or Divorce Decree of an existing Liquor License

1. Current Licensee's Name: _____
(Exactly as it appear on the license) Last First Middle
2. Assignee's Name: _____
Last First Middle
3. License Type: _____ License Number: _____

ATTACH TO THIS APPLICATION A CERTIFIED COPY OF THE WILL, PROBATE DISTRIBUTION INSTRUMENT, OR DIVORCE DECREE THAT SPECIFICALLY DISTRIBUTES THE LIQUOR LICENSE TO THE ASSIGNEE.

SECTION 10 Government (for cities, towns, or counties only)

1. Government Entity: _____
2. Person/Designee: _____
First Last Middle Day time Contact Phone #

A SEPARATE LICENSE MUST BE OBTAINED FOR EACH PREMISE FROM WHICH SPIRITUOUS LIQUOR IS SERVED.

SECTION 11 Location to Location Transfer: Series 6 Bar, Series 7 Beer & Wine Series 9 Liquor Stores only)

1. Current Business: Name: The Good Oak Bar
Address: 316 E. Congress St. Tucson, AZ 85701
(Exactly as it appears on license)

2. New Business: Name: Tap & Bottle
Address: 7254 N. Oracle Road Tucson, AZ 85704

1. License Type: Series 7 License Number: 07100045

SECTION 12 Person to Person Transfer

Questions to be completed by Current Licensee (Bar and Liquor Stores Only- Series, 06, 07, and 09)

1. Individual Owner / Agent Name: Thomas Danny Roy Agent
Last First Middle Entity: (Individual, Agent, Etc.)

2. Ownership Name: Good Oak Tucson LLC
(Exactly as it appears on license)

3. Business Name: Good Oak Bar
(Exactly as it appears on license)

4. Business Location Address: 316 E Congress St. Tucson AZ 85701
Street City State Zip

5. License Type: Series 7 License Number: 07100045

6. Current Mailing Address: 316 E. Congress St. Tucson AZ 85701
Street City State Zip

7. Have all creditors, lien holders, interest holders, etc. been notified? Yes No

8. Does the applicant intend to operate the business while this application is pending? Yes No

If yes, complete Section 5 (Interim Permit) of this application; attach fee, and current license to this application.

9. I, (Print Full Name) (See Bill of Sale) hereby authorize the department to process this Application to transfer the privilege of the license to the applicant provided that all terms and conditions of sale are met. Based on the fulfillment of these conditions, I certify that the applicant now owns or will own the property rights of the license by the date of issue.

I, (Print Full Name) (See Bill of Sale), declare that I am the **CURRENT OWNER, MEMBER, PARTNER STOCKHOLDER or LICENSEE** of the stated license. I have read the above Section 12 and confirm that all statements are true, correct, and complete.

NOTARY

X _____ State of _____ County of _____
(Signature of CURRENT Individual Owner/Agent) The foregoing instrument was acknowledged before me this

My commission expires on: _____ of _____
Date Day Month Year

Signature of NOTARY PUBLIC

SECTION 13 Proximity to Church or School

Questions to be completed by all in-state applicants.

A.R.S. § 4-207. (A) and (B) state that no retailer's license shall be issued for any premises which are at the time the license application is received by the director, within three hundred (300) horizontal feet of a church, within three hundred (300) horizontal feet of a public or private school building with kindergarten programs or grades one (1) through (12) or within three hundred (300) horizontal feet of a fenced recreational area adjacent to such school building.
The above paragraph DOES NOT apply to:

- a) Restaurant license (§ 4-205.02) Series 12
- b) Hotel/motel license (§ 4-205.01) Series 11
- c) Microbrewery Series 3
- d) Craft Distillery Series 18
- e) Government license (§ 4-205.03) Series 5
- f) Fenced playing area of a golf course (§ 4-207(B)(5))
- g) Wholesaler Series 4
- h) Farm Winery Series 13

1. Distance to nearest School: 0.3 miles or 1584 ft. Name of School: Edge High School Northwest *(PDS)*
(If less than one (1) mile note footage) Address: 231 W Giaconda Way # 113, Tucson *AZ 85704*

2. Distance to nearest Church: 0.8 miles or 4224 ft. Name of Church: St. Odilia Catholic Community *(PDS) AZ 85704*
(If less than one (1) mile note footage) Address: 7570 N Paseo Del Norte, Oro Valley *AZ 85704*

SECTION 14 Business Financials

1. I am the: Lessee Sub-lessee Owner Purchaser Management Company

2. If the premise is leased give lessors: Name: Romano Real Estate Corporation
 Address: 3900 E. Via Palomita Tucson AZ 85718
Street City State Zip

3. Monthly Rent/ Lease Rate: \$ 6700.00

4. What is the remaining length of the lease? Yrs 5 Months _____

5. What is the penalty if the lease is not fulfilled? \$ _____ or Other: \$150,000 personal guaranty
(Give details-attach additional sheet if necessary)

6. Total money borrowed for the Business not including lease? \$ 0
 Please List Lenders/People you owe money to for business.

Last	First	Middle	Amount Owed	Mailing Address	City	State	Zip

(Attach additional sheet if necessary)

7. What type of business will this license be used for (be specific)?
Beer & Wine Bar

8. Has a license or a transfer license for the premises on this application been denied by the state with in the past (1) year? Yes No If yes, attach explanation.

9. Does any spirituous liquor manufacture, wholesaler, or employee have an interest in your business? Yes No

10. Is the premises currently license with a liquor license? Yes No

If yes give license number and licensee's name:
 License #: _____ Individual Owner / Agent Name: _____
(Exactly as it appears on license)

SECTION 15 Restaurant or hotel/motel license applicants

1. Is there an existing Restaurant or Hotel/Motel Liquor License at the proposed location? Yes No
2. If the answer to Question 1 is YES, you may qualify for an Interim Permit to operate while your application is pending; consult A.R.S. § 4-203.01; and complete SECTION 5 of this application.
3. All Restaurant and Hotel/Motel applicants must complete a Restaurant Operation Plan form provided by the Department of Liquor Licenses and Control.
4. As stated in A.R.S. § 4-205.02. (H)(2), a Restaurant is an establishment which derives at least forty (40) percent of its gross revenue from the sale of food. Gross revenue is the revenue derived from sales of food and spirituous liquor on the licensed premises. By applying for this Restaurant Hotel/Motel, I certify that I understand that I must maintain a minimum of forty (40) percent food sales based on these definitions and have included the Restaurant Hotel/Motel Records Required for Audit form with this application.

(Applicant's Signature)

5. I understand it is my responsibility to contact the Department of Liquor Licenses and Control to schedule an inspection when all tables and chairs are on site, kitchen equipment, and, if applicable, patio barriers are in place on the licensed premises. With the exception of the patio barriers, these items are not required to be properly installed for this inspection. Failure to schedule an inspection will delay issuance of the license. If you are not ready for your inspection 90 days after filing your application, please request an extension in writing; specify why the extension is necessary; and the new inspection date you are requesting.

(Applicant's Initials)

SECTION 16 Diagram of Premises

Check ALL boxes that apply to your business:

- Entrances/Exits Liquor storage areas **Patio:** Contiguous
 Walk-up windows Drive-through windows Non Contiguous

1. Is your licensed premises currently closed due to construction, renovation or redesign? Yes No
If yes, what is your estimated completion date? May 2017

Month/Day/Year

2. **Restaurants and Hotel/Motel** applicants are required to draw a detailed floor plan of the kitchen and dining areas including the locations of all kitchen equipment and dining furniture. Place for diagram is on section 16 number 6.
3. The diagram (a detailed floor plan) you provide is required to disclose only the area(s) where spirituous liquor is to be sold, served, consumed, dispensed, possessed or stored on the premises unless it is a restaurant (see # 3 above).
4. Provide the square footage or outside dimensions of the licensed premises. Please do not include non-licensed premises such as parking lots, living quarters, etc.
5. As stated in A.R.S. § 4-207.01 (B), I understand it is my responsibility to notify the Department of Liquor Licenses and Control when there are changes to the boundaries, entrances, exits, added or deleted doors, windows, service windows or increase or decrease to the square footage after submitting this initial diagram.

RDS

(Applicant's Initials)

SECTION 16 Diagram of Premises – continued

6. On the diagram please show only the areas where spirituous liquor is to be sold, served, consumed, dispensed, possessed or stored. It must show all entrances, exits, interior walls, bars, hi-top tables, dining tables, dining chairs, dance floor, stage, game room, and the kitchen. DO NOT include parking lots, living quarters, etc. When completing diagram, North is up ↑.

If a legible copy of a rendering or drawing of your diagram of the premises is attached to this application, please write the words "DIAGRAM ATTACHED" in the box provided for the diagram on the application.

DIAGRAM OF PREMISES

DIAGRAM
ATTACHED

RETAIL BEER/WINE
PRIVILEGE ZONE

SEATING
BEER/WINE CONSUMED

EXIT
WITH
PANIC
HARDWARE

GATE
WITH
PANIC
HARDWARE

OFFICE

SPECIAL
RETAIL
AREA

STORAGE
BEER
WINE
STORAGE

WALK-IN
MERCHANTS

BEER/WINE SATOPAZONE

OUTDOOR
GAME
AREA

BEER & WINE DISPENSED

BEER/WINE
CONSUMED

OUTDOOR
SEATING

OUTDOOR
BEER/WINE CONSUMED

PDS
TOTAL
SQUARE
FOOTAGE =
3200 SQ. FEET.

← NORTH

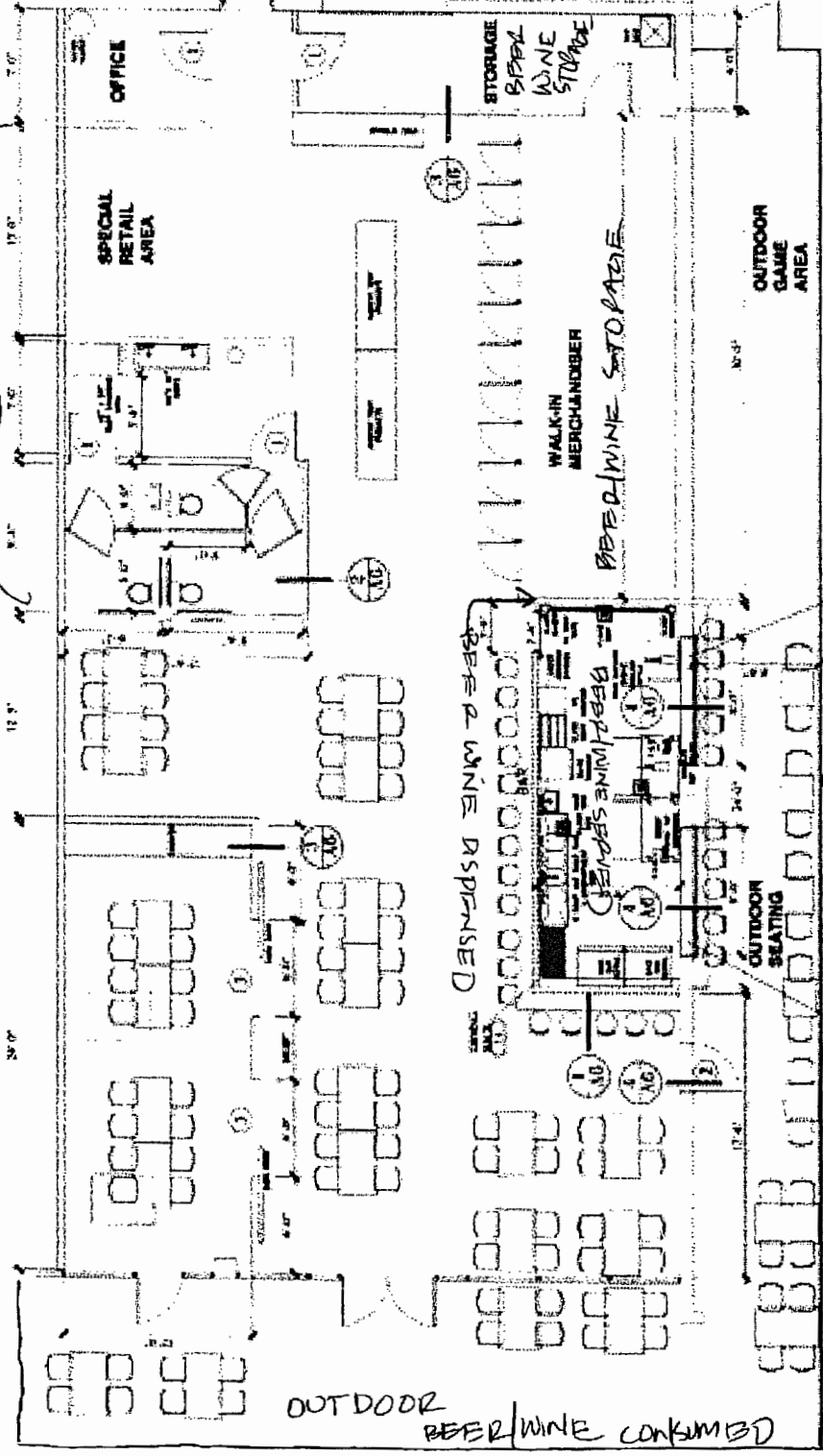

NOTARY

I, (Print Full Name) REBECCA DEBENDET SAFFORD, hereby declare that I am the Owner/Agent filing this application as stated in Section 4#1. I have read this application and verify all statements to be true, correct and complete.

X [Signature]
(Signature of CURRENT Individual Owner/Agent)

State of ARIZONA County of PIMA
The foregoing instrument was acknowledged before me this

My commission expires on: 7/22/19
Date

10th of MARCH, 2017
Day Month Year

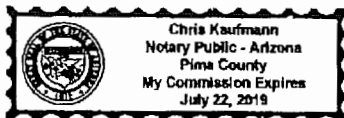

[Signature]
CHRIS KAUFMANN Signature of NOTARY PUBLIC

A.R.S. § 41-1030. Invalidity of rules not made according to this chapter; prohibited agency action; prohibited acts by state employees; enforcement; notice

B. An agency shall not base a licensing decision in whole or in part on a licensing requirement or condition that is not specifically authorized by statute, rule or state tribal gaming compact. A general grant of authority in statute does not constitute a basis for imposing a licensing requirement or condition unless a rule is made pursuant to that general grant of authority that specifically authorizes the requirement or condition.

D. THIS SECTION MAY BE ENFORCED IN A PRIVATE CIVIL ACTION AND RELIEF MAY BE AWARDED AGAINST THE STATE. THE COURT MAY AWARD REASONABLE ATTORNEY FEES, DAMAGES AND ALL FEES ASSOCIATED WITH THE LICENSE APPLICATION TO A PARTY THAT PREVAILS IN AN ACTION AGAINST THE STATE FOR A VIOLATION OF THIS SECTION.

E. A STATE EMPLOYEE MAY NOT INTENTIONALLY OR KNOWINGLY VIOLATE THIS SECTION. A VIOLATION OF THIS SECTION IS CAUSE FOR DISCIPLINARY ACTION OR DISMISSAL PURSUANT TO THE AGENCY'S ADOPTED PERSONNEL POLICY.

F. THIS SECTION DOES NOT ABROGATE THE IMMUNITY PROVIDED BY SECTION 12-820.01 OR 12-820.02.