

Pima County Clerk of the Board

Julie Castañeda

Melissa Manriquez
Deputy Clerk

Administration Division
130 W. Congress, 5th Floor
Tucson, AZ 85701
Phone: (520)724-8449 • Fax: (520)222-0448

Document and Micrographics Mgt. Division
1640 East Benson Highway
Tucson, Arizona 85714
Phone: (520) 351-8454 • Fax: (520) 791-6666

June 6, 2017

Jaudiel A. Gamez
Mi Ranchito Carniceria
3650 E. Benson Hwy.
Tucson, AZ 85706

RE: Arizona Liquor License No.: 10103817
d.b.a. Mi Ranchito Carniceria

Dear Mr. Gamez:

Enclosed is a copy of the Affidavit of Posting relative to your Liquor License Application for a Series 10, Beer and Wine Store, which was received in our office on May 3, 2017. The Hearing before the Pima County Board of Supervisors has been scheduled for Tuesday, June 20, 2017, at 9:00 a.m. or thereafter, at the following location:

Pima County Administration Building
Board of Supervisors Hearing Room
130 W. Congress, 1st Floor
Tucson, AZ 85701

Should you have any questions pertaining to this matter, please contact this office at (520)724-8449.

Sincerely,

A handwritten signature in black ink, appearing to read "Julie Castañeda".

Julie Castañeda
Clerk of the Board

Enclosure



Arizona Department of Liquor Licenses and Control
 800 W Washington 5th Floor
 Phoenix, AZ 85007-2934
 www.azliquor.gov
 (602) 542-5141

MAY 25 17 10 35 PM '17

AFFIDAVIT OF POSTING

Date of Posting: 5/24/17

Date of Posting Removal: 5/25/17

Applicant's Name: **Mi Ranchito Carniceria**
Gamez **Jaudiel** **A.**
Last First Middle

Business Address: **3650 E. Benson Highway** **Tucson** **85706**
Street City Zip

License #: 10103817

I hereby certify that pursuant to A.R.S. 4-201, I posted notice in a conspicuous place on the premises proposed to be licensed by the above applicant and said notice was posted for at least twenty (20) days.

FRANK R. HECHT 1775 Pima Co SHERIFF 520 310 4034
Print Name of City/County Official Title Phone Number

[Signature] 1775 5/25/17
Signature Date Signed

Return this affidavit with your recommendations (i.e., Minutes of Meeting, Verbatim, etc.) or any other related documents. If you have any questions please call (602) 542-5141 and ask for the Licensing Division.



Pima County Clerk of the Board

Julie Castañeda

Melissa Manriquez
Deputy Clerk

Administration Division
130 W. Congress, 5th Floor
Tucson, AZ 85701
Phone: (520) 724-8449 • Fax: (520)222-0448

Document and Micrographics Mgt. Division
1640 East Benson Highway
Tucson, Arizona 85714
Phone: (520) 351-8454 • Fax: (520) 791-6666

TO: Development Services, Zoning Division
FROM: Ricci Romero *RR*
Administrative Support Specialist Senior
DATE: May 3, 2017
RE: Zoning Report - Application for Liquor License

Attached is the application of:

Jaudiel A. Gamez
d.b.a. Mi Ranchito Carniceria
3650 E. Benson Highway
Tucson, AZ 85706

Arizona Liquor License No. 10103817
Series 10, Beer and Wine Store
New License X
Person Transfer
Location Transfer

ZONING REPORT

DATE: 5/17/17

Will current zoning regulations permit the issuance of the license at this location?

Yes No

If No, please explain:

[Handwritten Signature]

Pima County Zoning Inspector

When complete, please return to cob_mail@pima.gov

MAY 17 17 PM 04:49 PC CLK/DFR *RR*

17-15-9291



Arizona Department of Liquor Licenses and Control
800 W Washington 5th Floor
Phoenix, AZ 85007-2934
www.azliquor.gov
(602) 542-5141

DLIC USE ONLY	
License #	10103817
Date Accepted:	5/2/17
CSR:	<i>J</i>

Application for Liquor License
Type or Print with Black Ink

APPLICATION FEE AND INTERIM PERMIT FEES (IF APPLICABLE) ARE NOT REFUNDABLE
A service fee of \$25 will be charged for all dishonored checks (A.R.S. 6-44-6852)

SECTION 1 Type of License

- Interim Permit
- New License
- Person Transfer
- Location Transfer (series 6, 7 and 9)
- Probate/ Will Assignment/ Divorce Decree (No Fees)
- Seasonal

SECTION 2 Type of Ownership

- J.T.W.R.O.S.
- Individual
- Partnership
- Corporation
- Limited Liability Co
- Club
- Government
- Trust
- Tribe
- Other (Explain) _____

PAY TO THE ORDER OF CLERK OF SUPERIOR COURT

SECTION 3 Type of license

- Add Sampling Privilege for Series 9 and 10 only (Complete Sampling Privilege application) A.R.S. §4-206.01 (G), (H), (I) & (L)
- Add Growler privileges (restaurant, series 12, license only, 300-foot restriction applies) A.R.S. §4-207 (A) & (B)

1. Type of License (restaurant, bar etc.): BEER/WINE STORE SERIES 10 2. LICENSE # (if issued): 10103817

SECTION 4 Applicants

1. Agent's Name: GAMEZ JAUDIEL A P1071750
Last First Middle
2. Applicant/Licensee Name: GAMEZ MI RANCHITO LLC B1058740
(Ownership name for type of ownership checked on section 1)
3. Business Name (Doing Business As-DBA): MI RANCHITO CARNICERIA D1006988
4. Business Location Address: 3650 E BENSON HWY TUCSON AZ 85706 PIMA
(Do not use PO Box) Street City State Zip Code County
5. Mailing Address: 3650 E BENSON HWY TUCSON AZ 85706
(All correspondence will be mailed to this address) Street City State Zip Code County
6. Business Phone: (520)294-4631 Daytime Contact Phone: (520)343-7888
7. Email Address: dalejandra_94@outlook.com
8. Is the Business located within the incorporated limits of the above city or town? Yes No PIMA
If you checked no, in what City, Town, County or Tribal/Indian Community is this business located?

Fees: <u>\$100</u>	<u>\$100</u>	Department Use Only	<u>\$44</u>	<u>\$244</u>
Application	Interim Permit	Site Inspection	Finger Prints	Total of All Fees
Is Arizona Statement of Citizenship & Alien Status for State Benefits complete?				<input checked="" type="checkbox"/> Yes <input type="checkbox"/> No

SECTION 5 Background Check

EACH PERSON LISTED MUST SUBMIT A QUESTIONNAIRE, FINGERPRINT CARD ALONG WITH \$22. PROCESSING FEE PER CARD.

1. If the applicant is an entity, not an individual, answer questions 1 a-b.

a) Date Incorporated/Organized: 03/23/2017 State where Incorporated/Organized: AZ

b) AZ Corporation or AZ L.L.C. File No: L21716317 Date authorized to do business in AZ 03/24/2017

2. List any individual or entity that own a beneficial interest of 10% or more and/or controls the license. If the applicant is owned by another entity, attach an organizational chart showing the ownership structure. Attach additional sheets as needed to disclose any controlling person, member, shareholder or general partner who owns a beneficial interest of 10% or more of the license.

Last	First	Middle	Title	%Owned	Mailing Address	City	State	Zip
GAMEZ	JAUDIEL	A	MEMBER	50%	3650 E BENSON HWY TUCSON	AZ	85706	
GAMEZ AMAYA	DIANA	A	MEMBER	50%	3650 E BENSON HWY TUCSON	AZ	85706	

(Attach additional sheet if necessary)

SECTION 6 Interim Permit

If you intend to operate business while your application is pending you will need an interim permit pursuant to A.R.S. § 4-203.01 for approval of an interim permit:

- There **must** be a valid license of the same series issued to the current location you are applying for OR
- A Hotel/Motel license is being replaced with a restaurant license pursuant to A.R.S. § 4-203.01 (A)

1. Enter license number currently at the location: 10103717

2. Is the license currently in use? Yes No If no, how long has it been out of use? _____

I, (Signature) Deepa Patel declare that I am the CURRENT OWNER, AGENT, OR CONTROLLING PERSON on the stated license and location.

Attach a copy of the license currently issued at this location to this application.

NOTARY

State of Arizona }
 County of MARICOPA }

On this 07 Day of APRIL, 2017 before me personally appeared Deepa Kamleshkumar Patel
(Print Name of Document Signer)

Whose identity was proven to me on the basis of satisfactory evidence to be the person who he or she claims to be and acknowledged that he or she signed the above/attached document.

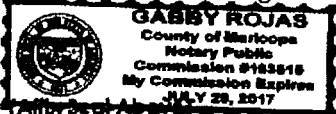

GABBY ROJAS
 County of Maricopa
 Notary Public
 Commission #163816
 My Commission Expires
 JULY 28, 2017

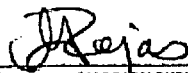

 Signature of NOTARY PUBLIC

SECTION 7 Probate, Receiver, Bankruptcy Trustee, Assignment, or Divorce Decree of an existing liquor license ARS § 4-204

EACH PERSON LISTED MUST SUBMIT A QUESTIONNAIRE, FINGERPRINT CARD ALONG WITH \$22. PROCESSING FEE PER CARD.

1. Current Licensee's Name: _____
(Exactly as it appears on the license) Last First Middle

2. Assignee's Name: _____
 Last First Middle

License Number: _____

ATTACH A COPY OF THE DOCUMENT THAT SPECIFICALLY ASSIGNS THE LIQUOR LICENSE TO THE ASSIGNEE.

SECTION 8 Government (for Cities, Towns or Counties only)

1. Government Entity: _____

2. Person/Designee: _____
Last First Middle Daytime Contact Phone #

A SEPARATE LICENSE MUST BE OBTAINED FOR EACH PREMISES FROM WHICH SPIRITUOUS LIQUOR IS SERVED.

SECTION 9 Person to Person – Current Licensee Information ARS§4-203(C), (D), (G)
(Bar and Liquor Stores only – Series 06, 07 and 09)

1. License #: _____

2. Current Agent Name: _____
Last First Middle

3. Current Licensee Name: _____
(Exactly as it appears on the license)

4. Current Business Name: _____
(Exactly as it appears on the license)

5. Current Daytime Phone: _____ Primary Email Address: _____

6. Does current licensee intend to operate the business while this application is pending? Yes No

7. I authorize the transfer of this license to the applicant: _____
Signature or Agent or Individual controlling person

NOTARY

State of Arizona }
County of _____ }

On this _____ Day of _____, 20____ before me personally appeared _____
Day Month Year (Print Name of Document Signer)

Whose identity was proven to me on the basis of satisfactory evidence to be the person who he or she claims to be and acknowledged that he or she signed the above/attached document.

Signature of NOTARY PUBLIC

(Affix Seal Above)

SECTION 10 Proximity to Church or School - Questions to be completed by 6, 7, 9, 10 and 12G applicants.

A.R.S. §4-207. (A) and (B) state that no retailer's license shall be issued for any premises which are at the time the license application is received by the director, within three hundred (300) horizontal feet of a church, within three hundred (300) horizontal feet of a public or private school building with kindergarten programs or grades one (1) through (12) or within three hundred (300) horizontal feet of a fenced recreational area adjacent to such school building.

The above paragraph DOES NOT apply to:

- a) Restaurants that do not sell growlers [A.R.S. §4-205.02] Series 12
- b) Hotel/motel license [A.R.S. §4-205.01] Series 11
- c) Microbrewery [A.R.S. §4-205.08] Series 3
- d) Craft Distillery [A.R.S. §4-205.10] Series 18
- e) Government license [A.R.S. §4-205.03] Series 5
- f) Playing area of a golf course [A.R.S. §4-207 (B)(5)]
- g) Wholesaler/Distributor Series 4
- h) Farm Winery Series 13
- i) Producer Series 1

1. Distance to nearest School: _____ Name of School: _____
(If less than one (1) mile note footage)

Address: _____

2. Distance to nearest Church: _____ Name of Church: _____
(If less than one (1) mile note footage)

Address: _____

SECTION 11 Business Financials A.R.S. §4-202(F)

1. I am the:

- Tenant: a person who holds the lease of a property; a lessee.
- Sub-tenant: a person who holds a lease which was given to another person (tenant) for all or part of a property.
- Owner
- Purchaser
- Management Company

2. If the premises is leased give lessors: Name: SIRVAN RAYES

Address: 9449 W QUAIL AVE PEORIA AZ 85382
Street City State Zip

3. What is the penalty if the lease is not fulfilled? \$ _____ or Other: DEFAULT MOVE-OUT

4. Total money borrowed for the Business not including lease? \$ 0

Please List Lenders/People you owe money to for business.

Last	First	Middle	Amount Owed	Mailing Address	City	State	Zip

(Attach additional sheet if necessary)

5. Has a license or a transfer license for the premises on this application been denied by the state within the past year?

Yes No If yes, attach explanation.

6. Does any spirituous liquor manufacture, wholesaler, or employee have an interest in your business?

Yes No If yes, attach explanation.

SECTION 12 Diagram of Premises

Check ALL boxes that apply to your business:

Walk-up or drive-through windows

Patio: Contiguous Non-Contiguous within 30 feet

1. Is your licensed premises now closed due to construction, renovation or redesign or rebuild?

Yes No If yes, what is your estimated completion date? _____/_____/_____

Please attach a diagram of the premises which clearly show only the areas where spirituous liquor will be sold, served, consumed, dispensed, possessed or stored. Include all entrances, exits, interior walls, bar areas, dining areas, dance floor, stage, game room and the kitchen. **DO NOT INCLUDE** parking lots, living quarters or areas where business is not conducted under this liquor license. When completing your premises diagram, please identify which orientation is North.

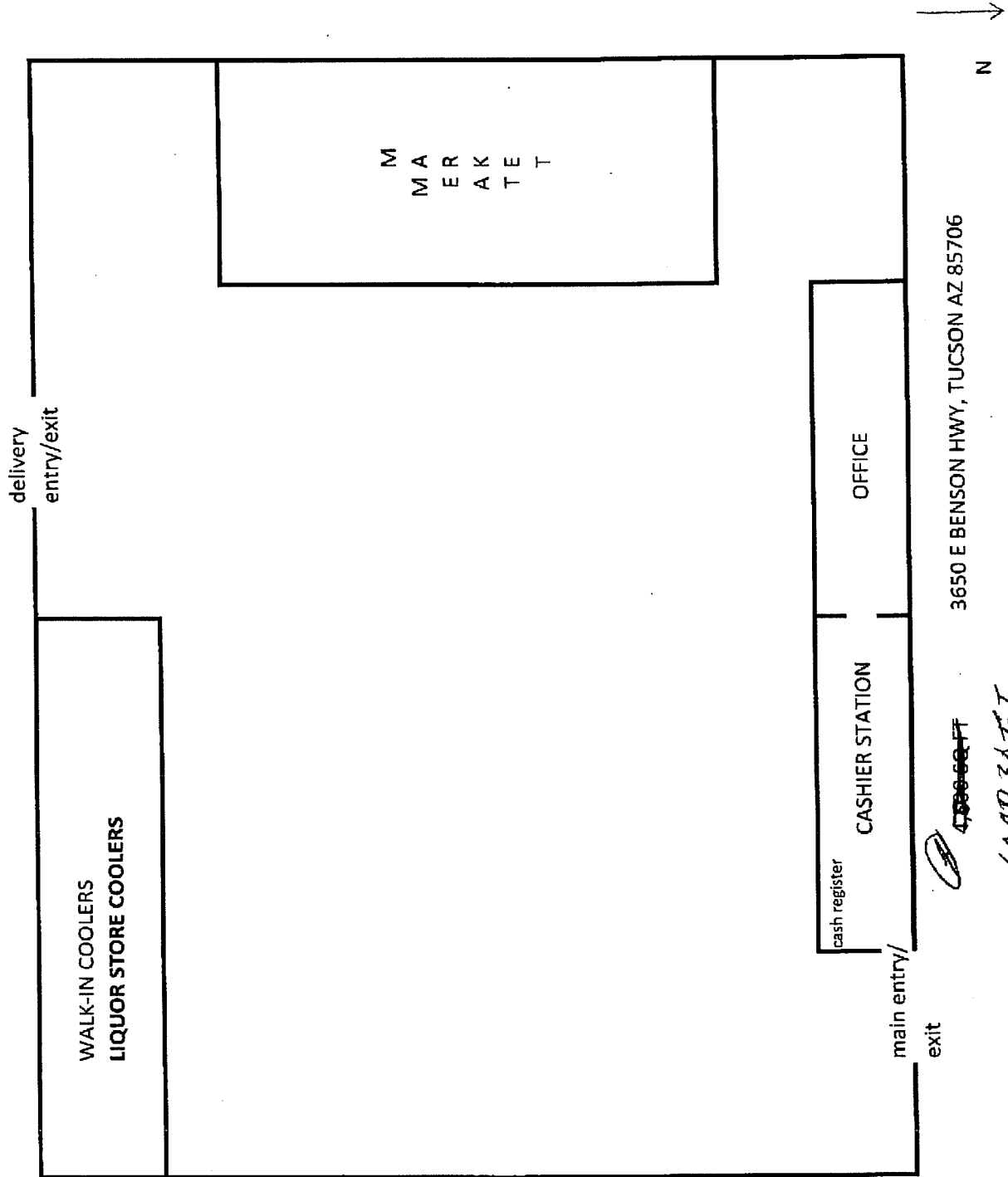

2. Provide the square footage or outside dimensions of the licensed premises. Please do not include non-licensed areas such as parking lots, living quarters, etc.

3. As stated in A.R.S. §4-207.01 (B), I understand it is my responsibility to notify the Department of Liquor Licenses and Control when there are changes to the service areas or the square footage of the licensed premises, either by increase or decrease.

J.A.G
Applicants Initials

RESTAURANTS AND HOTELS/MOTELS ONLY

(IMPORTANT NOTE: A site inspection must be conducted prior to activation of the license. The fee of \$50.00 will be due and payable upon submitting this application.)

4a. Provide a detailed drawing of the kitchen and dining areas, including the locations of all kitchen equipment and dining furniture, these are required as part of the diagram. A.R.S. §4-205.02(C)

4b. Provide a restaurant operation plan.

SECTION 13 SIGNATURE BLOCK

I, (Signature) JAUDIEL A GAMEZ *JAUDIEL A GAMEZ* hereby declare that I am the Owner/Agent filing this application, I have read this document and verify the content and all statements are true, correct and complete, to the best of my knowledge.

NOTARY

State of Arizona

County of PIMA

On this 4th Day of MARCH, 2017 before me personally appeared JAUDIEL A GAMEZ
(Print Name of Document Signer)

Whose identity was proven to me on the basis of satisfactory evidence to be the person who he or she claims to be and acknowledged that he or she signed the above/attached document.

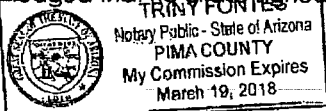

(Affix Seal Above)

Trinity Fortes
Signature of NOTARY PUBLIC

A.R.S. §41-1030. Invalidity of rules not made according to this chapter, prohibited agency action; prohibited acts by state employees; enforcement; notice

B. An agency shall not base a licensing decision in whole or in part on a licensing requirement or condition that is not specifically authorized by statute, rule or state tribal gaming compact. A general grant of authority in statute does not constitute a basis for imposing a licensing requirement or condition unless a rule is made pursuant to that general grant of authority that specifically authorizes the requirement or condition.

D. THIS SECTION MAY BE ENFORCED IN A PRIVATE CIVIL ACTION AND RELIEF MAY BE AWARDED AGAINST THE STATE. THE COURT MAY AWARD REASONABLE ATTORNEY FEES, DAMAGES AND ALL FEES ASSOCIATED WITH THE LICENSE APPLICATION TO A PARTY THAT PREVAILS IN AN ACTION AGAINST THE STATE FOR A VIOLATION OF THIS SECTION.

E. A STATE EMPLOYEE MAY NOT INTENTIONALLY OR KNOWINGLY VIOLATE THIS SECTION. A VIOLATION OF THIS SECTION IS CAUSE FOR DISCIPLINARY ACTION OR DISMISSAL PURSUANT TO THE AGENCY'S ADOPTED PERSONNEL POLICY.

F. THIS SECTION DOES NOT ABROGATE THE IMMUNITY PROVIDED BY SECTION 12-820.01 OR 12-820.02.