



BOARD OF SUPERVISORS AGENDA ITEM REPORT

Requested Board Meeting Date: June 12, 2018

Title: Easement to Southwest Gas Corporation ("SWG")
File # E-0094

Introduction/Background:

SWG has requested an extension of an existing easement across Pima County Flood Control District owned property lying within Section 18, Township 14, Range 14 G&SRM, Pima County, Arizona, as shown on the attached Location Map.

Discussion:

SWG has determined they need the extended easement for new pipeline to be installed within the Arroyo Chico basin.

Conclusion:

This request has been reviewed by appropriate County staff and they agree to granting the easement.

Recommendation:

Staff recommends that the Pima County Flood Control District Board of Directors approve the Easement by unanimous consent to avoid auctioning the easement. Upon approval, staff will record the necessary conveyance document.

Fiscal Impact:

Pima County Flood Control District received \$1300.00 which includes \$100.00 in revenue and \$1200.00 in reimbursement for the appraisal fee.

Board of Supervisor District:

1 2 3 4 5 All

Department: Real Property Services Telephone: 724-6311

Contact: Tim Murphy Telephone: 724-6379

Department Director Signature/Date:  5/15/18

Deputy County Administrator Signature/Date:  5/16/18

County Administrator Signature/Date:  5/17/18



BLOCK 57 UNIVERSITY HEIGHTS
BOOK 3 MAPS & PLATS PAGE 102

**13TH STREET
MONUMENT LINE**

1" = 50'

(ABANDONED PER SEQUENCE
NO. 20131960679)

FOUND 2" DIAM.
BRASS CAP WITH
PUNCH MARK
ONLY

P.O.T.

P.O.B.

EXISTING 15.00'
WIDE P.U.E. PER
SEQUENCE NO.
20110100414

**APN 124-12-274B
SEQUENCE NO. 20131960679**

BLOCK 64 UNIVERSITY HEIGHTS
BOOK 3 MAPS & PLATS PAGE 102

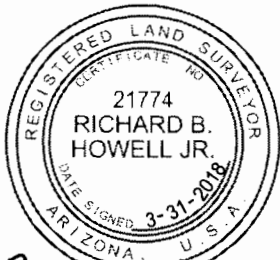

Richard B. Howell Jr.
EXPIRES 3/31/2021

N 00°55'06" W 286.00' (BASIS OF BEARINGS)
SANTA RITA AVENUE
(ABANDONED PER SEQUENCE
NO. 20131960679)

MANLOVE STREET MONUMENT LINE

S 89°05'27" W 480.26'

FOUND 2" DIAMETER BRASS
CAP WITH PUNCH MARK AND
STAMPED "RLS 15343"

LINE TABLE

NO.	BEARING	DISTANCE
L1	N 00°55'06" W	20.00'
L2	S 89°05'27" W	40.00'
L3	S 89°05'27" W	18.69'
L4	N 64°35'18" E	23.80'

P.O.C.

FOUND 2" DIAMETER BRASS
CAP WITH PUNCH MARK AND
STAMPED "RLS 15343"

PROPERTY OWNER: PIMA COUNTY, ARIZONA

DATE: MARCH 31, 2018

SOUTHWEST GAS CORPORATION
SOUTHERN ARIZONA DIVISION
3401 EAST GAS ROAD
TUCSON, ARIZONA 85714

EXHIBIT "B"
WR #3392049 LRS #5934
GRANT OF EASEMENT IN A PORTION OF THE NW 1/4 OF SECTION
18, TOWNSHIP 14 SOUTH, RANGE 14 EAST, GILA AND SALT RIVER
MERIDIAN, PIMA COUNTY, ARIZONA