

July 2, 2018

Arizona Department of Liquor and Control  
800 W. Washington 5<sup>th</sup> Floor  
Phoenix, AZ 85007-2934

To whom it may Concern,

I am writing about License #20961 D & K Market in Tucson. I am opposed to issuing this location the Beer and Wine license requested. Our neighborhood has 10 establishments to make such purchases already. One of these is directly behind the location of D & K Market. I feel this area is well represented in the sale of Beer and Wine and this new license is unnecessary for the community. I have enclosed a map of the area to better understand the amount of such establishments we have currently. I also include a picture of the proposed site with the existing liquor store immediately behind it. This area is predominantly residential with most of the business on Valencia Rd where there are six options to purchase alcohol already. If more choices are needed there is an additional five more stores three miles east on Valencia Rd.

I also question the posting of the notice of the application. It was placed at the front of the building on a piece of plywood protecting the glass door. This building was under renovation and each day this wood was opened to access the building. When wood was opened the notice was not visible during day time work hours, as it was on the backside of wood. I did not see this notice until the last week of posting early in the morning before work began. The public had little opportunity to see and read this notice during daylight and no lights at night to see the posting. Am I mistaken to think this should have been displayed more visibly?

I ask that the community's objections be taken into consideration when making the decision to issue this license.

Thank you for your time.

Laura Dailey  
5540 S. Holladay Pl.  
Tucson, AZ 85746

Enclosure

C. Pima County Board of Supervisors

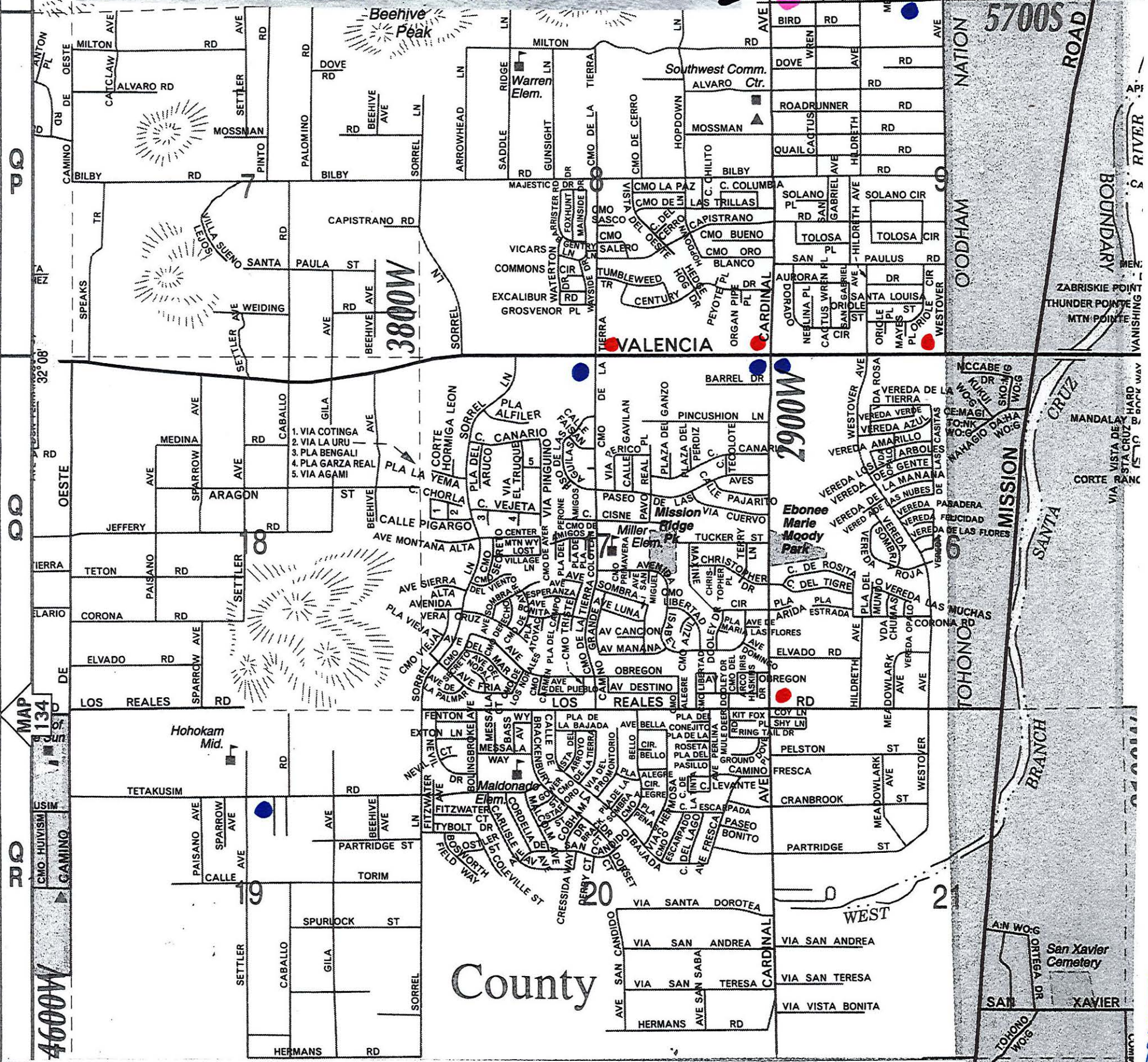
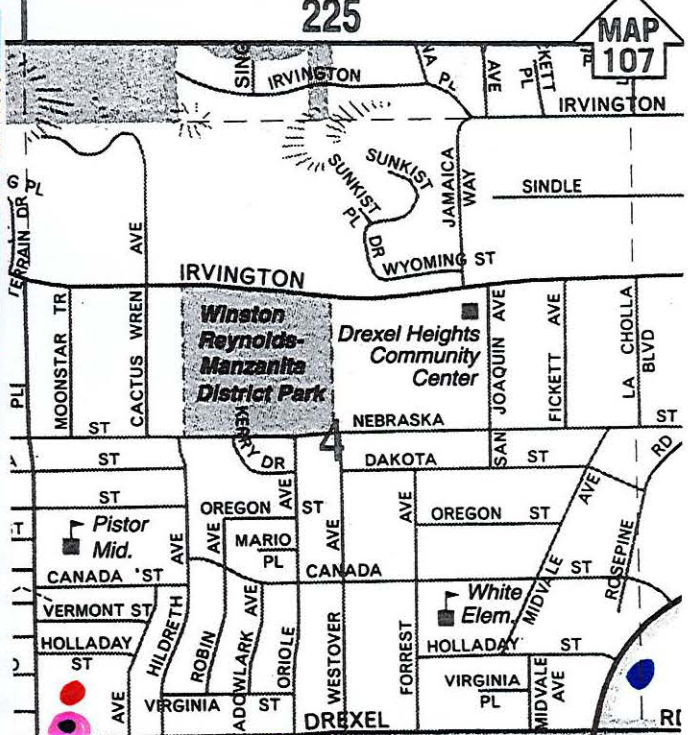

- Red dots are Liquor Stores
- Blue dots are Beer and Wine Stores

Data from AZ Dept. of Liquor Licenses and Control

*Lucas D'Amico*

