



## BOARD OF SUPERVISORS AGENDA ITEM REPORT

Requested Board Meeting Date: April 16, 2019

**Title:** Condominium Plat for Northwest Medical / Dental Condominiums Units A and B, Common Element A & Limited Common Elements. Final Plat DSD Record Number P18FP00027

**Introduction/Background:**

Final Plat to Create a Condominium Plat

**Discussion:**

Final Plat process to create a a Condominium Plat

**Conclusion:**

N/A

**Recommendation:**

Staff recommends approval.

**Fiscal Impact:**

N/A

**Board of Supervisor District:**

☒ 1      ☐ 2      ☐ 3      ☐ 4      ☐ 5      ☐ All

---

Department: Development Services      Telephone: 520-724-9900

Contact: Angie Rangel      Telephone: 520-724-6976

Department Director Signature/Date: Lauren G. Ortega      3/25/19

Deputy County Administrator Signature/Date: [Signature]      4/1/19

County Administrator Signature/Date: [Signature]      4/2/2019

---

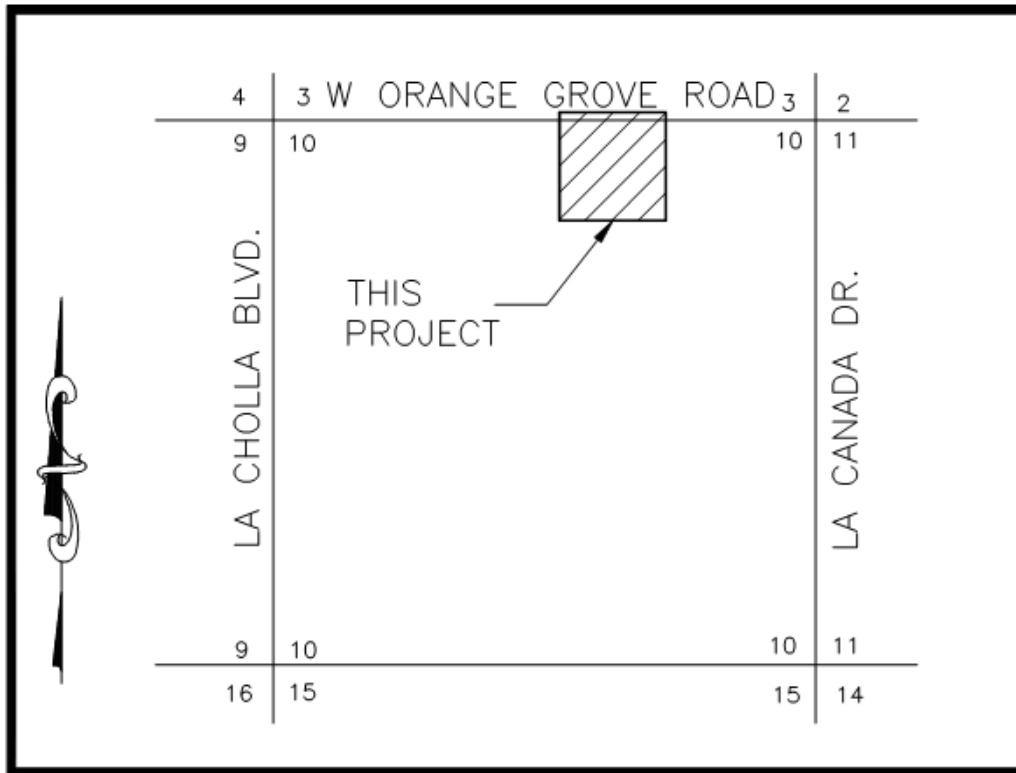

LOCATION SKETCH  
(NOT TO SCALE)

A PORTION OF THE NW 1/4 OF SECTION 10  
AND PORTION OF THE SW 1/4 OF SECTION 3  
T-13-S, R-13-E, G&S.R.M., PIMA CO., ARIZONA

Condominium Plat for Northwest Medical / Dental  
Condominiums Units A and B, Common Element A & Limited  
Common Elements. Final Plat DSD Record Number P18FP00027





The map shows a portion of Orange Grove Road at the top, with a centerline and right-of-way (R/W) line. Below the road, there are several lots and easements. Unit 'B' is a large rectangular lot with dimensions 171.47' (W) and 502.25' (S). It contains a smaller rectangular area labeled 'UNIT "C"' with dimensions 111.11' (W) and 111.11' (S). To the right of Unit 'B' is another large lot with dimensions 171.47' (W) and 502.25' (S). Further right is a lot with dimensions 111.11' (W) and 111.11' (S). The map also shows various easements, including a 'COMMON EASEMENT' and a 'COMMON EASEMENT' for 'UNIT "C"'. The map is labeled with 'UNIT "B"' and 'UNIT "C"' at the bottom. The map is a survey map showing lot boundaries, dimensions, and easements.

