



BOARD OF SUPERVISORS AGENDA ITEM REPORT

Requested Board Meeting Date: 1/23/2024

*= Mandatory, information must be provided

Click or tap the boxes to enter text. If not applicable, indicate "N/A".

***Title:**

Aerial Electric Easement to Tucson Electric Power Company ("TEP")

***Introduction/Background:**

On behalf of a private property owner, TEP has requested an electric easement across Pima County property located along the alignment of the Julian Wash, lying within Section 11, Township 15, Range 14, G&SRM, Pima County, Arizona, as shown on attached Location Map.

File # E-0344

***Discussion:**

TEP requests the easement for the connection of existing facilities to the residential subdivision known as Valencia Crossing.

***Conclusion:**

This request has been reviewed by appropriate County staff and they agree to granting the easment.

***Recommendation:**

Staff recommends that the Pima County Board of Supervisors approve the easement by unanimous consent to avoid auctioning the easement pursuant to ARS '11-251(9). Upon approval, staff will record the necessary conveyance document.

***Fiscal Impact:**

Pima County received \$1,200 in revenue, which is the appraised value of the easement.

***Board of Supervisor District:**

1 2 3 4 5 All

Attachment: Location Map

Department: Real Property

Telephone: 724-6313

Services Contact: Tim Murphy

Telephone: 724-6379

Department Director Signature: _____

Date: _____

1/2/2024

Deputy County Administrator Signature: _____

Date: _____

1/4/2024

County Administrator Signature: _____

Date: _____

1/4/2024

LOCATION MAP

SECTION 11
TOWNSHIP 15 SOUTH
RANGE 14 EAST

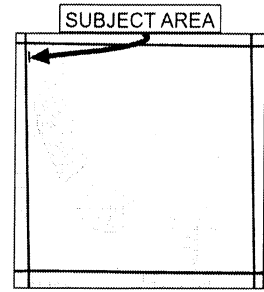

SECTION 11 G&SRM
PIMA COUNTY, ARIZONA

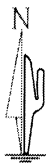
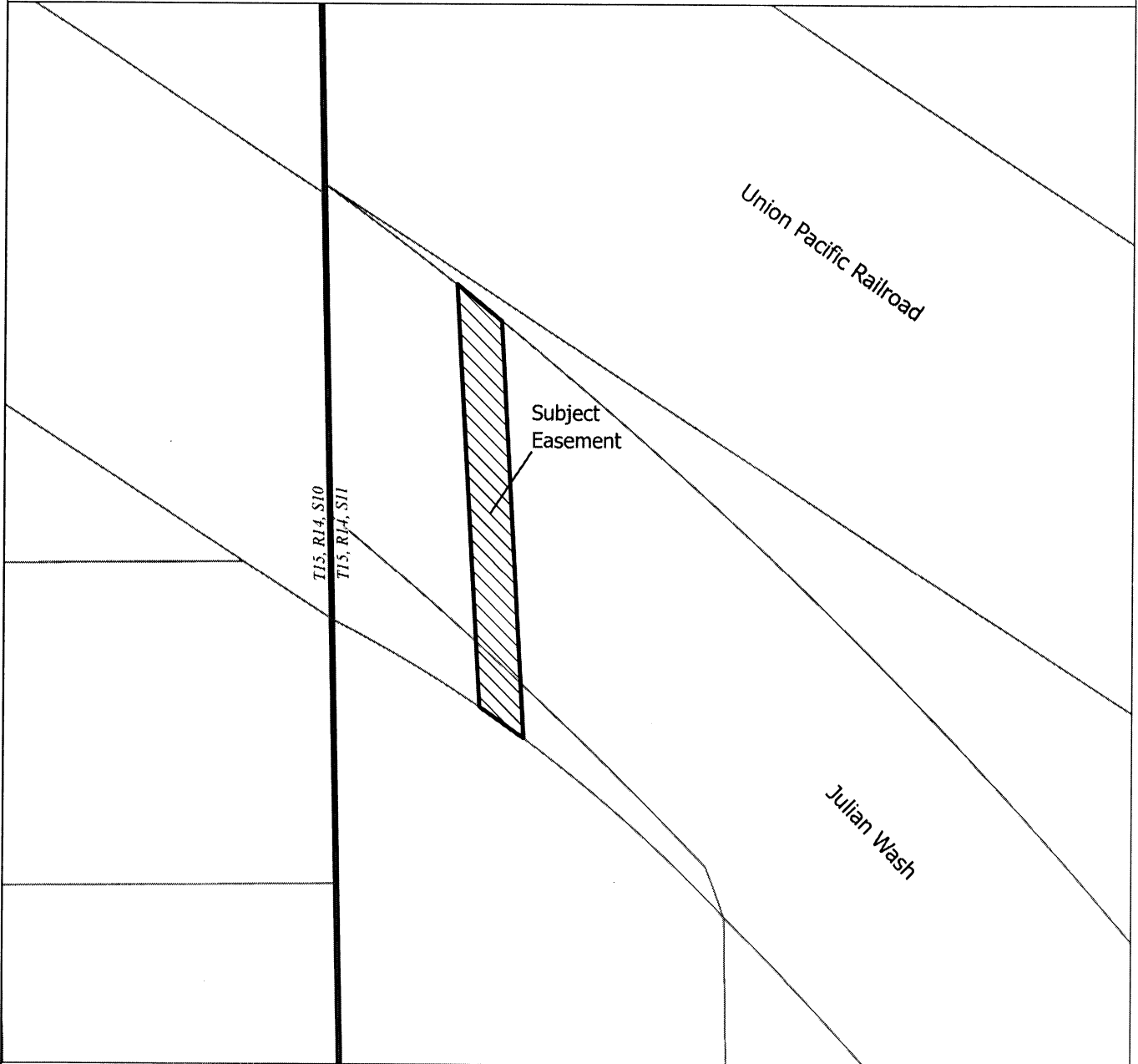

23161

**PIMA COUNTY DEPARTMENT OF TRANSPORTATION
ENGINEERING INFORMATION MANAGEMENT**

LEGEND

 Subject Easement

NOT TO SCALE

DRAWN BY: S SEARLES

DATE: DEC 2023