

Pima County Clerk of the Board

Melissa Manriquez

Katrina Martinez
Deputy Clerk

Administration Division
33 N. Stone Avenue, Suite 100
Tucson, AZ 85701
Phone: (520)724-8449 • Fax: (520)222-0448

Management of Information & Records Division
1640 East Benson Highway
Tucson, Arizona 85714
Phone: (520) 351-8454 • Fax: (520) 791-6666

March 26, 2025

Stephen Chung Sze
Lee Lee Oriental Supermart
2025 N. Dobson Road
Chandler, AZ 85224

RE: Arizona Liquor License Job No.: 330162
d.b.a. Lee Lee Oriental Supermart

Dear Mr. Sze:

Enclosed is a copy of the Affidavit of Posting relative to your Liquor License Application for a Series 10, Beer and Wine Store, which was received in our office on February 26, 2025. The Hearing before the Pima County Board of Supervisors has been scheduled for Tuesday, April 15, 2025, at 9:00 a.m. or thereafter, at the following location:

Pima County Administration Building
Board of Supervisors Hearing Room
130 W. Congress, 1st Floor
Tucson, AZ 85701

Should you have any questions pertaining to this matter, please contact this office at (520)724-8449.

Sincerely,

A handwritten signature in black ink, appearing to read "Melissa Manriquez", is written over a horizontal line.

Melissa Manriquez
Clerk of the Board

closure



POSTING

Job# _____
DLLC use only

Arizona Dept. of Liquor Licenses and Control
800 W. Washington St. 5th Floor Phoenix, AZ 85007
(602) 542-5141

Type or Print with Black Ink

Date of Posting: 3 / 3 / 25

Date of Posting Removal: 3 / 24 / 25

Applicant's Name: Lee Lee Oriental Supermart
Size Stephen Chung
Last First Middle

Business Address: 1990 W. Orange Grove Road Tucson 85704
Street City Zip

I hereby certify that pursuant to A.R.S. 4-201, I posted notice in a conspicuous place on the premises proposed to be licensed by the above applicant and said notice was posted for at least twenty (20) days.

Detective Jesus Gomez 1365
Print Name of City/County Official

Detective
Title

520
940-2469
Phone Number

[Signature] 1365
Signature

3.24.25
Date Signed

Return this affidavit with your recommendations or any other related documents.
If you have any questions please call (602) 542-5141 and ask for the Licensing Division.



Pima County Clerk of the Board
Melissa Manriquez

Katrina Martinez
Deputy Clerk

Administration Division
33 N. Stone Avenue, Suite 100
Tucson, AZ 85701
Phone: (520) 724-8449 • Fax: (520) 222-0448

Management of Information & Records Division
1640 East Benson Highway
Tucson, Arizona 85714
Phone: (520) 351-8454 • Fax: (520) 791-6666

TO: Development Services, Zoning Division
FROM: Jessie Roth
Administrative Specialist III
DATE: February 26, 2025
RE: Zoning Report - Application for Liquor License

Attached is the application of:

Stephen Chung Sze
d.b.a. Lee Lee Oriental Supermart
1990 W. Orange Grove Road
Tucson, AZ 85704

Arizona Liquor License Job No. 330162
Series 10, Beer and Wine Store
New License ☒
Person Transfer
Location Transfer

ZONING REPORT

DATE: 3/6/25

Will current zoning regulations permit the issuance of the license at this location?

Yes ☒ No ☐

If No, please explain:

Pima County Zoning Inspector

When complete, please return to cos_mail@pima.gov

MAR 06 25 AM 09:08 PM CLK OF BO

State of Arizona
Department of Liquor Licenses and Control

Local Governing Body Report

Number:		Type:	010 BEER AND WINE STORE
Name:	LEE LEE ORIENTAL SUPERMART		
State:	Pending		
Issue Date:		Expiration Date:	
Original Issue Date:			
Location:	1990 W ORANGE GROVE TUCSON, AZ 85704 USA		
Mailing Address:	2025 N DOBSON ROAD CHANDLER, AZ 85224 USA		
Phone:	(520)638-8329		
Alt. Phone:	(520)429-1888		
Email:	STEVESZE88@GMAIL.COM		

Name: STEPHEN CHUNG SZE
Gender: Male
Correspondence Address: 2025 N DOBSON ROAD
 CHANDLER, AZ 85224
 USA
Phone: (520)429-1888
Alt. Phone:
Email: STEVESZE88@GMAIL.COM

Name: LEE LEE ORIENTAL SUPERMART LLC
Contact Name: STEPHEN CHUNG SZE
Type: LIMITED LIABILITY COMPANY
AZ CC File Number: 23725996 State of Incorporation: AZ
Incorporation Date: 09/09/2024
Correspondence Address: 2025 N DOBSON ROAD
CHANDLER, AZ 85224
USA
Phone: (520)429-1888
Alt. Phone: (520)628-7445
Email: STEVESZE88@GMAIL.COM

Page 1 of 4

tab 26 260392-10 X0-33
JR

60th Day:
4/26/25

105th Day:
6/10/25

Name:
AZLL LLC

Title:
Manager-LLC

% Interest:
100.00

MAISON SOLUTIONS INC - CEO

Name: JOHN JUN XU
Gender: Male
Correspondence Address: 2025 N DOBSON ROAD
CHANDLER, AZ 85224
USA
Phone: (626)817-1488
Alt. Phone:
Email: JOHN.XU@MAISONSOLUTIONSINC.COM

AZLL LLC - Manager-LLC

Name: MAISON SOLUTIONS INC
Contact Name: STEPHAN CHUNG SZE
Type: CORPORATION
AZ CC File Number: State of Incorporation:
Incorporation Date:
Correspondence Address: 2025 N DOBSON ROAD
CHANDLER, AZ 85224
USA
Phone: (520)429-1888
Alt. Phone:
Email: STEVESZE88@GMAIL.COM

LEE LEE ORIENTAL SUPERMART LLC - Manager-LLC

Name: AZLL LLC
Contact Name: STEPHEN CHUNG SZE
Type: LIMITED LIABILITY COMPANY
AZ CC File Number: State of Incorporation:
Incorporation Date:
Correspondence Address: 2025 N DOBSON ROAD
CHANDLER, AZ 85224
USA
Phone: (520)429-1888
Alt. Phone:
Email: STEVESZE88@GMAIL.COM

MANAGERS

Name: AZLL LLC
Contact Name: STEPHEN CHUNG SZE
Type: LIMITED LIABILITY COMPANY
AZ CC File Number: State of Incorporation:
Incorporation Date:
Correspondence Address: 2025 N DOBSON ROAD
CHANDLER, AZ 85224
USA
Phone: (520)429-1888
Alt. Phone:
Email: STEVESZE88@GMAIL.COM

APPLICATION INFORMATION

Application Number: 330162
Application Type: New Application
Created Date: 01/24/2025

QUESTIONS & ANSWERS

010 Beer and Wine Store

- 1) Are you applying for an Interim Permit (INP)?
Yes
What date are you taking ownership? Please upload the Interim Permit Notary page when you reach the upload page.
02/25/2025
- 2) Provide name, address, and distance of nearest school.
(If less than one (1) mile note footage)
J ROBERT HENDRICKS ELEMENTARY SCHOOL
3400 E ORANGE GROVE RD, TUCSON, AZ 85741
1.8 MILES
- 3) Are you one of the following? Please indicate below.
Property Tenant
Subtenant
Property Owner
Property Purchaser
Property Management Company
TENANT
- 4) Is there a penalty if lease is not fulfilled?
Yes
What is the penalty?
SECURITY DEPOSIT OF \$400,000.
- 5) Is the Business located within the incorporated limits of the city or town of which it is located?
No
If no, in what City, Town, County or Tribal/Indian Community is this business located?
PIMA COUNTY
- 6) What is the total money borrowed for the business not including the lease?
Please list each amount owed to lenders/individuals.
\$10 MILLION
TRUONG MENG
2747 W HARRISON PL, CHANDLER, AZ 85224
- 7) Are there walk-up or drive-through windows on the premises?
No
- 8) Does the establishment have a patio?
No
- 9) Is your licensed premises now closed due to construction, renovation or redesign or rebuild?
No

State of Arizona
Department of Liquor Licenses and Control

Created 02/25/2025 @ 02:40:04 PM

Local Governing Body Report

LICENSE

Number:	INP100032112	Type:	INP INTERIM PERMIT
Name:	LEE LEE ORIENTAL SUPERMART		
State:	Active		
Issue Date:	02/25/2025	Expiration Date:	06/10/2025
Original Issue Date:	02/25/2025		
Location:	1990 W ORANGE GROVE TUCSON, AZ 85704 USA		
Mailing Address:	2025 N DOBSON ROAD CHANDLER, AZ 85224 USA		
Phone:	(520)638-8329		
Alt. Phone:	(520)429-1888		
Email:	STEVESZE88@GMAIL.COM		

AGENT

Name:	STEPHEN CHUNG SZE
Gender:	Male
Correspondence Address:	2025 N DOBSON ROAD CHANDLER, AZ 85224 USA
Phone:	(520)429-1888
Alt. Phone:	
Email:	STEVESZE88@GMAIL.COM

OWNER

Name:	LEE LEE ORIENTAL SUPERMART LLC		
Contact Name:	STEPHEN CHUNG SZE		
Type:	LIMITED LIABILITY COMPANY		
AZ CC File Number:	23725996	State of Incorporation:	AZ
Incorporation Date:	09/09/2024		
Correspondence Address:	2025 N DOBSON ROAD CHANDLER, AZ 85224 USA		
Phone:	(520)429-1888		
Alt. Phone:	(520)628-7445		
Email:	STEVESZE88@GMAIL.COM		

Officers / Stockholders

Name:
AZLL LLC

Title:
Manager-LLC

% Interest:
100.00

MAISON SOLUTIONS INC - CEO

Name: JOHN JUN XU
Gender: Male
Correspondence Address: 2025 N DOBSON ROAD
CHANDLER, AZ 85224
USA
Phone: (626)817-1488
Alt. Phone:
Email: JOHN.XU@MAISONSOLUTIONSINC.COM

AZLL LLC - Manager-LLC

Name: MAISON SOLUTIONS INC
Contact Name: STEPHAN CHUNG SZE
Type: CORPORATION
AZ CC File Number: State of Incorporation:
Incorporation Date:
Correspondence Address: 2025 N DOBSON ROAD
CHANDLER, AZ 85224
USA
Phone: (520)429-1888
Alt. Phone:
Email: STEVESZE88@GMAIL.COM

LEE LEE ORIENTAL SUPERMART LLC - Manager-LLC

Name: AZLL LLC
Contact Name: STEPHEN CHUNG SZE
Type: LIMITED LIABILITY COMPANY
AZ CC File Number: State of Incorporation:
Incorporation Date:
Correspondence Address: 2025 N DOBSON ROAD
CHANDLER, AZ 85224
USA
Phone: (520)429-1888
Alt. Phone:
Email: STEVESZE88@GMAIL.COM

MANAGERS

Name: AZLL LLC
Contact Name: STEPHEN CHUNG SZE
Type: LIMITED LIABILITY COMPANY
AZ CC File Number: State of Incorporation:
Incorporation Date:
Correspondence Address: 2025 N DOBSON ROAD
CHANDLER, AZ 85224
USA
Phone: (520)429-1888
Alt. Phone:
Email: STEVESZE88@GMAIL.COM

APPLICATION INFORMATION

Application Number: 333990
Application Type: New Application
Created Date: 02/21/2025

QUESTIONS & ANSWERS

INP Interim Permit

- 1) Enter License Number currently at location
10103722
- 2) Is the license currently in use?
Yes
- 3) Will you please submit section 5, page 6, of the license application when you reach the upload page?
Yes
A Document of type INTERIM NOTARY PAGE is required.

'25 JAN 23 Lic. Lic. #18 149

SECTION 5 Interim Permit

If you intend to operate business while the application is pending, you will need an interim permit pursuant to A.R.S. § 4-203.01. For approval of an interim permit: There must be a valid license of the same series currently issued to the location.

1. Current license number at the location: 10103722 2. Is the license currently in use? ☒ Yes ☐ No
2. If the license is **NOT** currently in use, how long has it been since the license was last used at this location? _____

I (Print Full Name) Stephen Chung Sze hereby declare that I am the Current Owner, Agent, or Controlling Person on the stated license and location.

Sign in front of Notary: _____

(Current Agent/Individual as listed on the license certificate)

State of <u>Arizona</u>	 DEAN VANDERWARKER Notary Public - Arizona Maricopa County Commission # 663977 My Commission Expires February 27, 2028 Notary Seal
County of <u>Maricopa</u>	
Signed before me on this <u>4</u> day of <u>January</u> , 20 <u>25</u> .	
Notary Signature <u>[Signature]</u>	
My commission expires on <u>02/27/2028</u>	

SECTION 6 Background Check

EACH PERSON LISTED MUST SUBMIT A QUESTIONNAIRE, FINGERPRINT CARD, AND \$22 PROCESSING FEE PER CARD.

1. If the applicant is an entity, and not an individual, answer questions 1a-b.

a) Date Incorporated/Organized: 09/09/2024 State where Incorporated/Organized: Arizona

b) AZ Corporation or AZ L.L.C. Entity No: 23725996 Approval Date: 09/10/2024

2. List any individual or entity that owns a beneficial interest of 10% or more and/or controls the applicant or licensee. If the applicant is owned by another entity, attach an organizational chart showing the ownership structure.

Last	First	Middle	Title	% Owned	Mailing Address	City	State	Zip
AZLL, LLC			manager	100%	8 W GRANT RD, TUCSON, AZ, 85705			

(Attach additional sheet if necessary)

Lee Lee Oriental
Supermart, LLC
Owned Wholly by

AZLL, LLC
Owned Wholly by

100%
manager

Maison Solutions, Inc
Publically owned

100%
CEO
John Xu



51242 Sq. ft

Liquor Storage

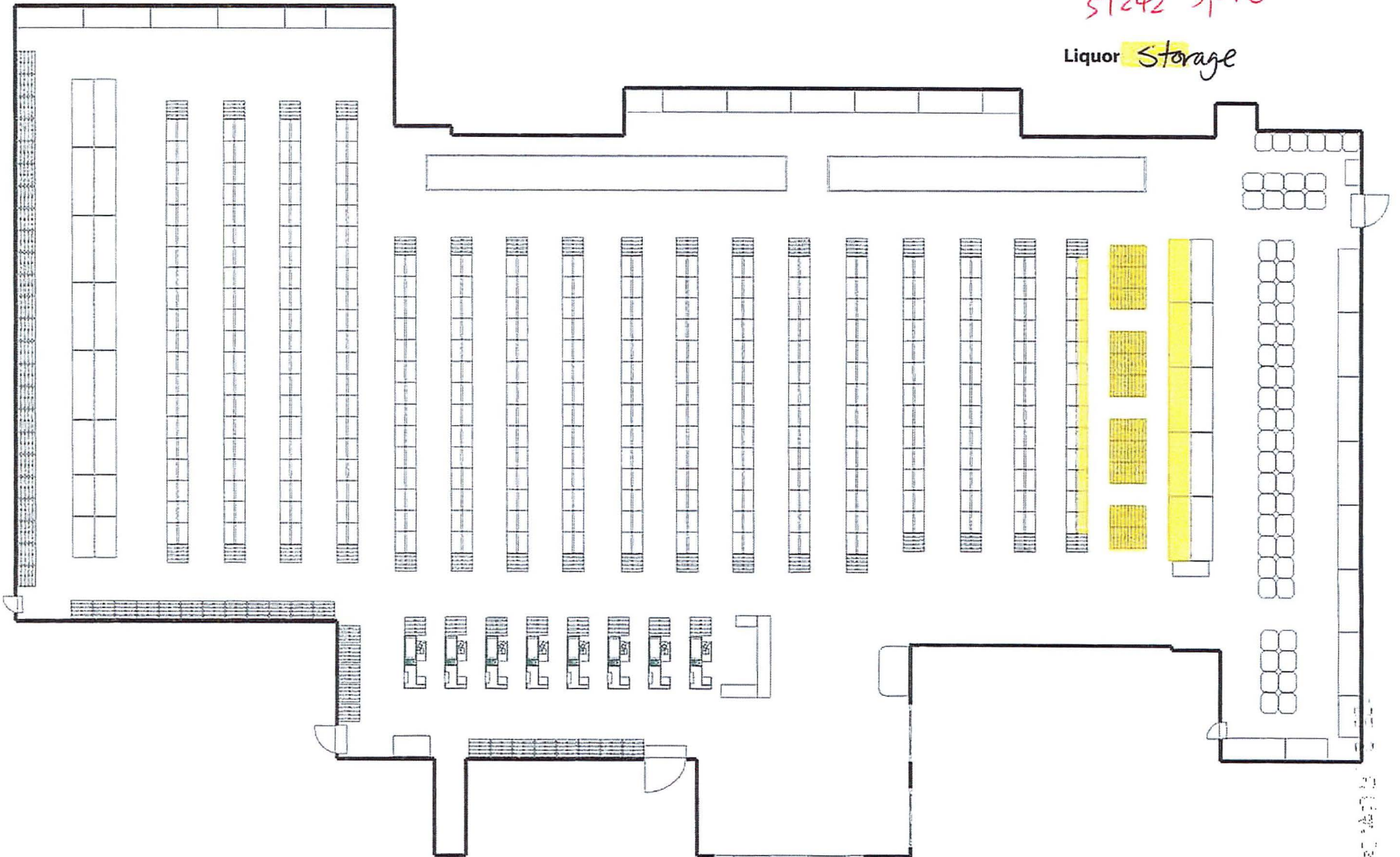

TUCSON

↑↑↑↑↑
Entrance & Exit