



Pima County Clerk of the Board

Melissa Manriquez

Katrina Martinez
Deputy Clerk

Administration Division
33 N. Stone Avenue, Suite 100
Tucson, AZ 85701
Phone: (520)724-8449 • Fax: (520)222-0448

Management of Information & Records Division
1640 East Benson Highway
Tucson, Arizona 85714
Phone: (520) 351-8454 • Fax: (520) 791-6666

February 3, 2025

Jesus Graciela Garcia Valle
Hacienda Azul Breakfast and Lunch
3220 W. Valencia Road
Tucson, AZ 85746

RE: Arizona Liquor License Job No.: 321483
d.b.a. Hacienda Azul Breakfast and Lunch

Dear Ms. Garcia Valle:

Enclosed is a copy of the Affidavit of Posting relative to your Liquor License Application for a Series 12, Restaurant, which was received in our office on January 6, 2025. The Hearing before the Pima County Board of Supervisors has been scheduled for Tuesday, February 18, 2025, at 9:00 a.m. or thereafter, at the following location:

Pima County Administration Building
Board of Supervisors Hearing Room
130 W. Congress, 1st Floor
Tucson, AZ 85701

Should you have any questions pertaining to this matter, please contact this office at (520)724-8449.

Sincerely,

A handwritten signature in black ink, appearing to read "Melissa Manriquez".

Melissa Manriquez
Clerk of the Board

Enclosure

JACE
1112



POSTING

Job# _____
DLC use only

Arizona Dept. of Liquor Licenses and Control
800 W. Washington St. 5th Floor Phoenix, AZ 85007
(602) 542-5141

Type or Print with Black Ink

Date of Posting: 1 / 10 / 25 Date of Posting Removal: 1 / 30 / 25

Applicant's Name: Hacienda Azul Breakfast and Lunch
Garcia Valle Jesus Graciela
Last First Middle

Business Address: 3220 W. Valencia Road Tucson 85746
Street City Zip

I hereby certify that pursuant to A.R.S. 4-201, I posted notice in a conspicuous place on the premises proposed to be licensed by the above applicant and said notice was posted for at least twenty (20) days.

J Judd 1112 DGPO04 3576996
Print Name of City/County Official Title Phone Number

[Signature] 1-30-25
Signature Date Signed

Return this affidavit with your recommendations or any other related documents.
If you have any questions please call (602) 542-5141 and ask for the Licensing Division.

JAN 31 25 11:51 AM PCLK JAC



Pima County Clerk of the Board
Melissa Manriquez

Katrina Martinez
Deputy Clerk

Administration Division
33 N. Stone Avenue, Suite 100
Tucson, AZ 85701
Phone: (520) 724-8449 • Fax: (520)222-0448

Management of Information & Records Division
1640 East Benson Highway
Tucson, Arizona 85714
Phone: (520) 351-8454 • Fax: (520) 791-6666

TO: Development Services, Zoning Division
FROM: Rosy Millan
Administrative Specialist I
DATE: January 7, 2025
RE: Zoning Report - Application for Liquor License

Attached is the application of:

Jesus Graciela Garcia Valle
d.b.a. Hacienda Azul Breakfast and Lunch
3220 W. Valencia Road
Tucson, AZ 85746

Arizona Liquor License Job No. 321483
Series 12, Restaurant
New License
Person Transfer
Location Transfer

ZONING REPORT

DATE: 1/13/25

Will current zoning regulations permit the issuance of the license at this location?

Yes No

If No, please explain:

Pima County Zoning Inspector

When complete, please return to cob_mail@pima.gov

JAN 13 25 AM 09:08 PM CLK OF BO
RM

25-01-9528

State of Arizona
Department of Liquor Licenses and Control

Created 01/06/2025 @ 07:53:52 AM

Local Governing Body Report

LICENSE

Number: Type: 012 RESTAURANT
Name: HACIENDA AZUL BREAKFAST AND LUNCH
State: Pending
Issue Date: Expiration Date:
Original Issue Date:
Location: 3220 W VALENCIA ROAD
TUCSON, AZ 85746
USA
Mailing Address: 3220 W VALENCIA ROAD
TUCSON, AZ 85746
USA
Phone: (520)940-8400
Alt. Phone:
Email: JESUSALONSOMENDOZA@YAHOO.COM

JAN 06 08:55 AM '25 RM

AGENT

Name: JESUS GRACIELA GARCIA VALLE
Gender: Female
Correspondence Address: 3220 W VALENCIA ROAD
TUCSON, AZ 85746
USA
Phone: (520)940-8400
Alt. Phone:
Email: JESUSALONSOMENDOZA@YAHOO.COM

OWNER

Name: HACIENDAVAL LLC
Contact Name: JESUS GRACIELA GARCIA VALLE
Type: LIMITED LIABILITY COMPANY
AZ CC File Number: 23694435 State of Incorporation: AZ
Incorporation Date: 06/17/2024
Correspondence Address: 1862 N HIGLEY ROAD
MESA, AZ 85205
USA
Phone: (520)940-8400
Alt. Phone:
Email: JESUSALONSOMENDOZA@YAHOO.COM

Officers / Stockholders

60th Day 3-7-25
105th Day 4-21-25

Name:	Title:	% Interest:
JESUS GRACIELA GARCIA VALLE	Member	51.00
JESUS ALONSO MENDOZA ABOYTES	Member	49.00

HACIENDAVAL LLC - Member

Name: JESUS GRACIELA GARCIA VALLE
Gender: Female
Correspondence Address: 3220 W VALENCIA ROAD
TUCSON, AZ 85746
USA
Phone: (520)940-8400
Alt. Phone:
Email: JESUSALONSOMENDOZA@YAHOO.COM

HACIENDAVAL LLC - Member

Name: JESUS ALONSO MENDOZA ABOYTES
Gender: Male
Correspondence Address: 3220 W VALENCIA ROAD
TUCSON, AZ 85746
USA
Phone: (520)904-0645
Alt. Phone:
Email: JESUSALONSOMENDOZA@YAHOO.COM

MANAGERS

Name: LIZDEBETH MENDOZA GARCIA
Gender: Female
Correspondence Address: 3220 W VALENCIA ROAD
TUCSON, AZ 85746
USA
Phone: (520)904-1957
Alt. Phone:
Email: LIZDEBETH.MENDOZA@YAHOO.COM

APPLICATION INFORMATION

Application Number: 321483
Application Type: New Application
Created Date: 12/04/2024

QUESTIONS & ANSWERS

012 Restaurant

- 1) Are you applying for an Interim Permit (INP)?
No

- 2) Are you one of the following? Please indicate below.
 Property Tenant
 Subtenant
 Property Owner *OWNER*
 Property Purchaser
 Property Management Company
 No
- 3) Is there a penalty if lease is not fulfilled?
 No
- 4) Is the Business located within the incorporated limits of the city or town of which it is located?
 Yes
- 5) What is the total money borrowed for the business not including the lease?
 Please list each amount owed to lenders/individuals.
 \$810,00 owed to Bank of America *100 N Tryon Street Charlotte Nc 28202*
- 6) Are there walk-up or drive-through windows on the premises?
 Yes
- 7) Does the establishment have a patio?
 Yes
 Is the patio contiguous or non-contiguous (within 30 feet)?
 Contiguous
- 8) Is your licensed premises now closed due to construction, renovation or redesign or rebuild?
 Yes
 If yes, what is your estimated completion date?
 January 5, 2025
- 9) What type of business will this license be used for?
 Restaurant

DOCUMENTS

DOCUMENT TYPE	FILE NAME	UPLOADED DATE
DIAGRAM/FLOOR PLAN	DIAGRAM.pdf	12/04/2024
MENU	Hacienda Azul Menu.pdf	12/04/2024
QUESTIONNAIRE	JAM Question page 1.pdf	12/04/2024
QUESTIONNAIRE	JAM Question Page 2.pdf	12/04/2024
QUESTIONNAIRE	JAM Backgorund.pdf	12/04/2024
QUESTIONNAIRE	JGG Question Page 1.pdf	12/04/2024
QUESTIONNAIRE	JGG Question page 2.pdf	12/04/2024
QUESTIONNAIRE	JGG Background Info.pdf	12/04/2024
QUESTIONNAIRE	Alien (Jesus Graciela).pdf	12/04/2024
QUESTIONNAIRE	Agent ID (Jesus Graciela).pdf	12/04/2024
RECORDS REQUIRED FOR AUDIT	Audit Records (1).pdf	12/04/2024
RECORDS REQUIRED FOR AUDIT	Audit Records (2).pdf	12/04/2024
RESTAURANT OPERATION PLAN	Operation plan (1).pdf	12/04/2024
RESTAURANT OPERATION PLAN	Operation plan (2).pdf	12/04/2024
ORGANIZATIONAL DOCUMENTS	liquor application.pdf	12/04/2024

Total Footage 4,825 feet

Staircase (dry)
Staircase

NOTES:
 1. ALL DEMOLITION SHALL BE ACCORDING TO LOCAL AND STATE REGULATIONS.
 2. ALL DEMOLITION SHALL BE ACCORDING TO LOCAL AND STATE REGULATIONS.
 3. ALL DEMOLITION SHALL BE ACCORDING TO LOCAL AND STATE REGULATIONS.

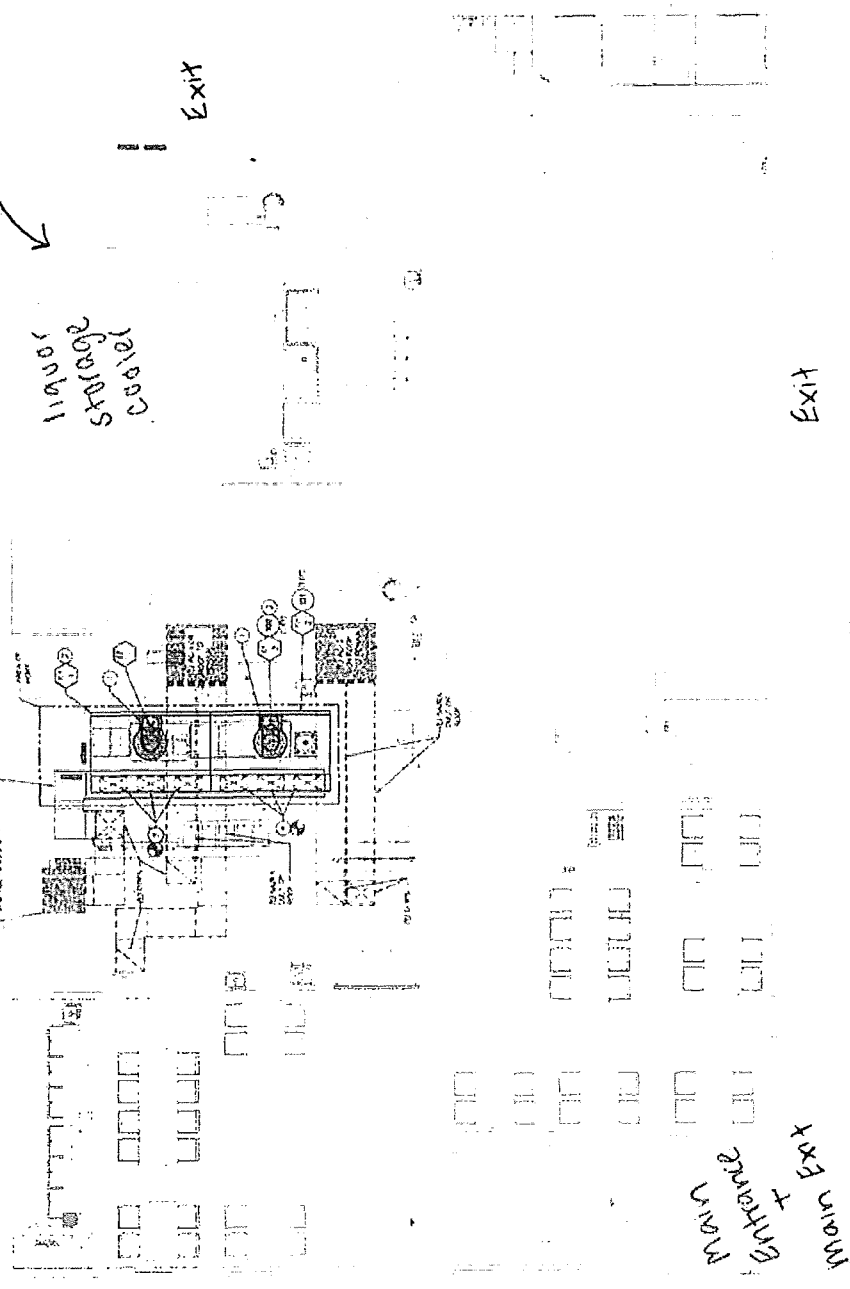

MECHANICAL DEMOLITION NOTES

- A. DEMONSTRATION OF ALL OVERHEAD HVAC
- B. ALL OVERHEAD HVAC SHALL BE DEMOLISHED
- C. ALL OVERHEAD HVAC SHALL BE DEMOLISHED
- D. ALL OVERHEAD HVAC SHALL BE DEMOLISHED
- E. ALL OVERHEAD HVAC SHALL BE DEMOLISHED
- F. ALL OVERHEAD HVAC SHALL BE DEMOLISHED
- G. ALL OVERHEAD HVAC SHALL BE DEMOLISHED
- H. ALL OVERHEAD HVAC SHALL BE DEMOLISHED
- I. ALL OVERHEAD HVAC SHALL BE DEMOLISHED
- J. ALL OVERHEAD HVAC SHALL BE DEMOLISHED

MECHANICAL LEGEND

SYMBOL	DESCRIPTION
[Symbol]	RY ROOF
[Symbol]	SA SUPPLY AIR DUCT
[Symbol]	RA RETURN AIR DUCT
[Symbol]	EA EXHAUST AIR DUCT
[Symbol]	PLC PLUMBING LINE
[Symbol]	DRG DRAINAGE
[Symbol]	SA SUPPLY AIR
[Symbol]	RA RETURN AIR
[Symbol]	EA EXHAUST AIR
[Symbol]	PLC PLUMBING
[Symbol]	DRG DRAINAGE
[Symbol]	SA SUPPLY AIR
[Symbol]	RA RETURN AIR
[Symbol]	EA EXHAUST AIR
[Symbol]	PLC PLUMBING
[Symbol]	DRG DRAINAGE

OUTSIDE AIR NOTE:
 1. ALL OUTSIDE AIR SHALL BE FILTERED THROUGH A MINIMUM OF TWO (2) STAGES OF MERV 11 FILTERS.
 2. ALL OUTSIDE AIR SHALL BE INTAKE THROUGH ROOFTOP UNITS.
 3. ALL OUTSIDE AIR SHALL BE INTAKE THROUGH ROOFTOP UNITS.
 4. ALL OUTSIDE AIR SHALL BE INTAKE THROUGH ROOFTOP UNITS.
 5. ALL OUTSIDE AIR SHALL BE INTAKE THROUGH ROOFTOP UNITS.

MECHANICAL PLAN
 SCALE 1/4" = 1'-0"



VVC DESIGN
 ARCHITECT
 TUCSON, AZ 85704-1000

HACIENDA AZUL
 11100 N. GILBERT AVENUE
 TUCSON, AZ 85731

DATE: 03/20/2023
 PROJECT: M1



RESTAURANT/HOTEL/MOTEL OPERATION PLAN

Arizona Dept. of Liquor Licenses and Control
800 W. Washington St. 5th Floor Phoenix, AZ 85007
(602) 542-5141

Type or Print with Black Ink

1. Name of restaurant (Please print): Hacienda Azul Breakfast and Lunch
2. Must indicate the equipment below by Make, Model, and Capacity:

LIST ONLY THE FOLLOWING - NO ATTACHMENTS

Grill	Vulcan (VCRG36m)
Oven	Waring, Amana, Southbend
Freezer	walk-in, aluminum walls 7x7, Kooltec
Refrigerator	Turbo Air (TSR-495D), Trve (T-49), Avanteo, Beverage Air
Sink	Krowne (KR24-125T), Economy
Dish Washing Facilities	Auto-Chlor
Food Preparation Counter (Dimensions)	30x60, Turbo Air Table (MST-48), Counter 31x36
Other	Fryer Gas - Cookrite (ATFS-50)

3. Attach a copy of your FULL menu with pricing **INCLUDING NON-ALCOHOLIC BEVERAGES**
4. What percentage of your public premises is used primarily for restaurant dining?
 (Do not include kitchen, bar, hi-top tables, or game area.) 50 %
5. Does your restaurant have a bar area that is distinct and separate from the dining area? YES No
 (If yes, what percentage of the public floor space does this area cover?) 5 %

6. List the **seating capacity** for:

a) Restaurant dining area of your premises: [28]

(DO NOT INCLUDE PATIO SEATING)

b) Bar area [+ 20]

TOTAL [= 48]

7. What type of dinnerware is primarily used in your restaurant? Reusable, Disposable Both

8. Does your restaurant contain any **games, televisions, or any other entertainment**? YES No

If yes, specify what types and how many (examples: 4-TV's, 2-Pool Tables, 1-Video Game, etc.)

9. Do you have live entertainment or dancing? YES No
If yes, what type and how often (example: DJ-2 x a week, Karaoke-2 x a month, Live Band-1 x a month, etc.)

10. List number of employees for each position:

Position	How many
Cooks	3
Bartenders	2
Hostesses	1
Managers	1
Servers	6
Other (dishwasher)	1
Other (prep)	2
Other ()	

I, (Print Full Name) Jesur A Mendez, hereby swear under penalty of perjury and in compliance with A.R.S. § 4-210(A)(2) and (3) that I have read and understand the foregoing and verify that the information and statements that I have made herein are true and correct to the best of my knowledge.

Applicant Signature: Jesur A Mendez

Menu Hacienda Azul

Omelettes \$14

- Norteno
- Vegetariano
- Americano

Signature Breakfasts

- Huevos Motulenos \$14
- Scrambled eggs with shrimp \$14
- Huevos divorciados \$13
- Chilaquiles divorciados \$13
- Corn tamal poblano style \$13
- Hacienda platter \$15

Scrambled eggs

- Mexican style \$12
- With chorizo \$13
- With ham \$13

Soups

- Caldo Tlapeno \$12
- Carne en su jugo \$14
- Menudo \$12
- Pozole \$12

Chilaquiles \$13

- Red or green or mixed
- Enmolados with chicken +\$3
- With egg +\$3
- With birria +\$3

Lunch entrees

- Enfrijoladas en salsa roja \$13
- Carne con chile \$13

- Chile Relleno \$13
- Enchiladas de mole \$13
- Chile relleno de camarón \$13
- Enchiladas Poblanas \$13
- Shrimp Empanadas \$14

Sweets

- Nutella crepes \$12
- Apple and chream cheese \$12
- Mazapan and banana \$12
- Pancakes \$9
- Waffles with fruit \$13
- Tres leches French toast \$13

Burritos \$12

- Norteno
- Gringo
- Mexa
- Machaca

Kids \$10

- Classic plate
- Mini pancakes
- Breakfast burrito
- Grilled cheese
- Chicken tenders

Beverages

- Freshly squeezed juices \$10
- Barista coffees \$12
- House coffee \$8
- N/A drinks (soda) \$6
- Mimosa \$10
- Bloody mary \$12

24 12 18 Liv. Dept AM 7:37

- Espresso Martini \$12
- Spiked coffee \$13
- Mexican bottled beer \$8



**RECORDS REQUIRED
FOR AUDIT
RESTAURANT/HOTEL/MOTEL**

Arizona Dept. of Liquor Licenses and Control
800 W. Washington St. 5th Floor Phoenix, AZ 85007
(602) 542-5141

Type or Print with **Black Ink**

In the event of an audit, you will be asked to provide to the Department any documents necessary to determine Compliance with A.R.S. §4-205.02(G). Such documents requested may include however, are not limited to:

1. Name of restaurant (Please print): Hacienda Azul Breakfast and Lunch
2. All invoices and receipts for the purchase of food and spirituous liquor for the licensed premises.
3. A list of **all** food and liquor vendors
4. The restaurant menu used during the audit period
5. A price list for alcoholic beverages during the audit period
6. Mark-up figures on food and alcoholic products during the audit period
7. A recent, **accurate** inventory of food and liquor (taken within two weeks of the Audit Interview Appointment)
8. Monthly Inventory Figures - beginning and ending figures for food and liquor
9. Chart of accounts (copy)
10. Financial Statements-Income Statements-Balance Sheets

11. General Ledger

A. Sales Journals/Monthly Sales Schedules

- 1) Daily sales Reports (to include the name of each waitress/waiter, bartender, etc. with sales for that day)
- 2) Daily Cash Register Tapes - Journal Tapes and Z-tapes
- 3) Dated Guest Checks
- 4) Coupons/Specials/Discounts
- 5) Any other evidence to support income from food and liquor sales

B. Cash Receipts/Disbursement Journals

- 1) Daily Bank Deposit Slips
- 2) Bank Statements and canceled checks

12. Tax Records

A. Transaction Privilege Sales, Use and Severance Tax Return (copies)

B. Income Tax Return - city, state and federal (copies)

C. Any supporting books, records, schedules or documents used in preparation of tax returns

13. Payroll Records

24 12 18 Lic. Dept #737

- A. Copies of all reports required by the State and Federal Government
- B. Employee Log (A.R.S. §4-119)
- C. Employee time cards (actual document used to sign in and out each work day)
- D. Payroll records for all employees showing hours worked each week and hourly wages

14. Off-site Catering Records (must be complete and separate from restaurant records)

- A. All documents which support the income derived from the sale of food off the license premises.
- B. All documents which support purchases made for food to be sold off the licensed premises.
- C. All coupons/specials/discounts

The sophistication of record keeping varies from establishment to establishment. Regardless of each licensee's accounting methods, the amount of gross revenue derived from the sale of food and liquor must be substantially documented.

**REVOCATION OF YOUR LIQUOR LICENSE MAY OCCUR IF YOU FAIL TO COMPLY WITH
A.R.S. §4-210(A)7 AND A.R.S. §4-205.02(G).**

A.R.S. §4-210(A)7

The licensee fails to keep for two years and make available to the department upon reasonable request all invoices, records, bills or other papers and documents relating to the purchase, sale and delivery of spirituous liquors and, in the case of a restaurant or hotel-motel licensee, all invoices, records, bills or other papers and documents relating to the purchase, sale and delivery of food.

A.R.S. §4-205.02(G)

For the purpose of this section:

- 1. "Restaurant" means an establishment which derives **at least forty percent (40%)** of its gross revenue from the sale of food
- 2. "Gross revenue" means the revenue derived from all sales of food and spirituous liquor on the licensed premises regardless of whether the sales of spirituous liquor are made under a restaurant license issued pursuant to this section or under any other license that has been issued for the premises pursuant to this article.

I, (Print Full Name) Jesús A. Mendoza hereby swear under penalty of perjury and in compliance with A.R.S. § 4-210(A)(2) and (3) that I have read and understand the foregoing and verify that the information and statements that I have made herein are true and correct to the best of my knowledge.

Applicant Signature: Jesús A. Mendoza

MAKE A COPY OF THIS DOCUMENT AND KEEP IT WITH RECORDS REQUIRED BY THE STATE