

# Pima County Clerk of the Board

Melissa Manriquez

Katrina Martinez  
Deputy Clerk

Administration Division  
33 N. Stone Avenue, Suite 100  
Tucson, AZ 85701  
Phone: (520)724-8449 • Fax: (520)222-0448

Management of Information & Records Division  
1640 East Benson Highway  
Tucson, Arizona 85714  
Phone: (520) 351-8454 • Fax: (520) 791-6666

March 15, 2023

Kevin Arnold Kramber  
Dos By Borderlands  
536 E. Wagon Bluff Drive  
Tucson, AZ 85704

RE: Arizona Liquor License Job No.: 231459  
d.b.a. Dos By Borderlands

Dear Mr. Kramber:

Enclosed is a copy of the Affidavit of Posting relative to your Liquor License Application for a Series 12, Restaurant, which was received in our office on February 21, 2023. The Hearing before the Pima County Board of Supervisors has been scheduled for Tuesday, April 4, 2023, at 9:00 a.m. or thereafter, at the following location:

Pima County Administration Building  
Board of Supervisors Hearing Room  
130 W. Congress, 1st Floor  
Tucson, AZ 85701

Should you have any questions pertaining to this matter, please contact this office at (520)724-8449.

Sincerely,

A handwritten signature in black ink, appearing to read "Melissa Manriquez".

Melissa Manriquez  
Clerk of the Board

Enclosure



# POSTING

Job# \_\_\_\_\_  
DLLC use only

Arizona Dept. of Liquor Licenses and Control  
800 W. Washington St. 5<sup>th</sup> Floor Phoenix, AZ 85007  
(602) 542-5141

Type or Print with Black Ink

Date of Posting: 02 / 23 / 23

Date of Posting Removal: 03 / 15 / 23

Applicant's Name: Dos By Borderlands  
Kramber Kevin Arnold  
Last First Middle

Business Address: 5605 E. River Road, No. 201 Tucson 85750  
Street City Zip

I hereby certify that pursuant to A.R.S. 4-201, I posted notice in a conspicuous place on the premises proposed to be licensed by the above applicant and said notice was posted for at least twenty (20) days.

DR McKillop PCSD  
Print Name of City/County Official Title Phone Number  
Process Server 520-288-1358

DR McKillop 03/15/23  
Signature Date Signed

Return this affidavit with your recommendations or any other related documents.  
If you have any questions please call (602) 542-5141 and ask for the Licensing Division.

Pull  
03/15/23

VERIFIED 03/15/23



# Pima County Clerk of the Board

Melissa Manriquez

**Katrina Martinez**  
Deputy Clerk

Administration Division  
33 N. Stone Avenue, Suite 100  
Tucson, AZ 85701  
Phone: (520) 724-8449 • Fax: (520)222-0448

Management of Information & Records Division  
1640 East Benson Highway  
Tucson, Arizona 85714  
Phone: (520) 351-8454 • Fax: (520) 791-6666

TO: Development Services, Zoning Division

FROM: Bernadette Russell *BR*  
Administrative Specialist

DATE: February 22, 2023

RE: Zoning Report - Application for Liquor License

Attached is the application of:

Kevin Arnold Kramber  
d.b.a. Dos By Borderlands  
5605 E. River Road, No. 201  
Tucson, AZ 85750

Arizona Liquor License Job No. 231459  
Series 12, Restaurant  
New License   
Person Transfer  
Location Transfer

ZONING REPORT

DATE: 2/22/23

Will current zoning regulations permit the issuance of the license at this location?

Yes  No

If No, please explain:

---



---



---



---

Pima County Zoning Inspector

When complete, please return to [cob\\_mail@pima.gov](mailto:cob_mail@pima.gov)

FEB 22 2023 09:05 PC CLK OF BD

● 23-07-9485

**State of Arizona**  
**Department of Liquor Licenses and Control**

Created 02/17/2023 @ 02:58:03 PM

Local Governing Body Report

**LICENSE**

Number:		Type:	012 RESTAURANT
Name:	DOS BY BORDERLANDS		
State:	Pending		
Issue Date:		Expiration Date:	
Original Issue Date:			
Location:	5605 E RIVER ROAD #201 TUCSON, AZ 85750 USA		
Mailing Address:	536 E WAGON BLUFF DRIVE TUCSON, AZ 85704 USA		
Phone:	(520)235-5684		
Alt. Phone:			
Email:	KKRAMBER75@GMAIL.COM		

**AGENT**

Name:	KEVIN ARNOLD KRAMBER
Gender:	Male
Correspondence Address:	536 E WAGON BLUFF DRIVE TUCSON, AZ 85704 USA
Phone:	(520)235-5684
Alt. Phone:	
Email:	KKRAMBER75@GMAIL.COM

**OWNER**

Name:	DOS CONCEPTS LLC		
Contact Name:	KEVIN ARNOLD KRAMBER		
Type:	LIMITED LIABILITY COMPANY		
AZ CC File Number:	23324491	State of Incorporation:	AZ
Incorporation Date:	01/24/2022		
Correspondence Address:	536 E WAGON BLUFF DRIVE TUCSON, AZ 85704 USA		
Phone:	(520)235-5684		
Alt. Phone:			
Email:	KKRAMBER75@GMAIL.COM		

Officers / Stockholders

FEB 23 2023 02:58:03 PM

Name:	Title:	% Interest:
ESTEBAN TERAN	MEMBER	40.00
MARIA JOSE MAZON	MEMBER	40.00
KEVIN ALEXANDER BLANKEVOORT	MEMBER	10.00

**DOS CONCEPTS LLC - MEMBER**

Name: ESTEBAN TERAN  
 Gender: Male  
 Correspondence Address: 536 E WAGON BLUFF DRIVE  
 TUCSON, AZ 85704  
 USA  
 Phone: (520)243-3685  
 Alt. Phone:  
 Email: ES@BORDERLANDSBREWING.COM

**DOS CONCEPTS LLC - MEMBER**

Name: KEVIN ALEXANDER BLANKEVOORT  
 Gender: Male  
 Correspondence Address: 536 E WAGON BLUFF DRIVE  
 TUCSON, AZ 85704  
 USA  
 Phone: (760)680-7680  
 Alt. Phone:  
 Email: KEVINBLANKEVOORT@GMAIL.COM

**DOS CONCEPTS LLC - MEMBER**

Name: MARIA JOSE MAZON  
 Gender: Female  
 Correspondence Address: 536 E WAGON BLUFF DRIVE  
 TUCSON, AZ 85704  
 USA  
 Phone: (520)304-1624  
 Alt. Phone:  
 Email: CHEF@BOCATACOS.COM

**APPLICATION INFORMATION**

Application Number: 231459  
 Application Type: New Application  
 Created Date: 02/07/2023 *Chap*

**QUESTIONS & ANSWERS**

**012 Restaurant**

- 1) Are you applying for an Interim Permit (INP)?  
 No

- 2) Are you one of the following? Please indicate below.  
 Property Tenant  
 Subtenant  
 Property Owner  
 Property Purchaser  
 Property Management Company  
 Property Tenant
- 3) Is there a penalty if lease is not fulfilled?  
 Yes  
 What is the penalty?  
 Loss of \$9,800 security deposit and Landlord lockout
- 4) Is the Business located within the incorporated limits of the city or town of which it is located?  
 No  
 If no, in what City, Town, County or Tribal/Indian Community is this business located?  
 Pima County
- 5) What is the total money borrowed for the business not including the lease?  
 Please list each amount owed to lenders/individuals.  
 None, capital contribution
- 6) Are there walk-up or drive-through windows on the premises?  
 No
- 7) Does the establishment have a patio?  
 Yes  
 Is the patio contiguous or non-contiguous (within 30 feet)?  
 Contiguous
- 8) Is your licensed premises now closed due to construction, renovation or redesign or rebuild?  
 Yes  
 If yes, what is your estimated completion date?  
 06/01/2023
- 9) What type of business will this license be used for?  
 Full service restaurant

**12G Restaurant Growler**

- 1) Have you uploaded a Growler application?  
 To obtain a Growler application copy and paste this link into your browser:  
[http://www.azliquor.gov/forms/lic\\_12GrowlerApplication.pdf](http://www.azliquor.gov/forms/lic_12GrowlerApplication.pdf)  
 Yes
- 2) Provide name, address, and distance of nearest school.  
 (If less than one (1) mile note footage)  
 Basis Tucson North  
 5740 E. River Rd., Tucson, AZ 85750  
 898 feet

<b>DOCUMENTS</b>
------------------

DOCUMENT TYPE	FILE NAME	UPLOADED DATE
QUESTIONNAIRE	Esteban Q Basic & Mgt.pdf	02/07/2023
DIAGRAM/FLOOR PLAN	Floor Plan.pdf	02/07/2023
GROWLER APPLICATION	Growler app.pdf	02/07/2023
QUESTIONNAIRE	Kevin B Q.pdf	02/07/2023
QUESTIONNAIRE	Kevin K Q.pdf	02/07/2023
QUESTIONNAIRE	Maria Q.pdf	02/07/2023
MENU	Menu.pdf	02/07/2023
RESTAURANT OPERATION PLAN	Rest Op Plan.pdf	02/07/2023

RECORDS REQUIRED FOR AUDIT

RRFA.pdf

02/07/2023

MISCELLANEOUS

Signed Affidavit.pdf

02/07/2023



23 FEB 10 07. 04 09 01

# APPLICANT/CONTROLLING PERSON AFFIDAVIT

Arizona Dept. of Liquor Licenses and Control  
800 W. Washington St. 5<sup>th</sup> Floor Phoenix, AZ 85007  
(602) 542-5141

Type or Print with Black Ink

BE COMPLETED BY THE ORGANIZATION'S PRESIDENT. IF THIS IS A CLUB, PARTNERSHIP, OR OTHER TYPE OF ORGANIZATION, A SIGNATURE OF EQUAL LEVEL IS REQUIRED.

Organization: Dos Concepts, LLC

Affidavit of: Esteban Teran

Position/Title: Member

State of: Arizona AZ Corp./L.L.C. #: 23324491

County of: Pima State Incorporated: Arizona

I, (Print Full Name) Esteban Teran Declares:

1. To obtain a liquor license to operate in Arizona, I have completed and delivered to the Arizona Dept. of Liquor Licenses and Control, the required questionnaire and fingerprint card. I have also submitted the required questionnaires and fingerprint cards of all officers, directors, regional managers, managing members, partners, etc., who are involved in the management of the policies involving spirituous liquor in the State of Arizona; and all stockholders who own ten percent (10%) or more of the corporation or limited liability company have also been completed and submitted.

Name and title of such individuals are as follows (or list attached):

- 1) Esteban Teran, Member
- 2) Maria Mazon, Member
- 3) Kevin Blankevoort, Member
- 4) \_\_\_\_\_

2. In addition to those submitting questionnaires and fingerprint cards, list other officers, limited liability members, and/or board members of this organization who are not submitting such information to the Arizona Department of Liquor Licenses and Control. None of these individuals are involved in the direction of the management of policies of this organization involving spirituous liquor in the State of Arizona.

Such members and positions, along with date and place of birth, are as follows (or list attached):

- 1) Michael Tyler Glazar, Member, February 12, 1976, Morgan City, LA USA
- 2) \_\_\_\_\_
- 3) \_\_\_\_\_
- 4) \_\_\_\_\_

3. Finally, on information and belief, none of the individuals listed under item #2 have at any time been convicted of a felony, had a liquor license revoked, or violated any provisions of a liquor license issued to that member.

**Declaration:**

I, (Print Name) Esteban Teran, declare under penalty of perjury that I am authorized to submit this application. I have read the contents of this application, and to the best of my knowledge believe all statements made on this application to be true, correct and complete.

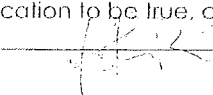
 \_\_\_\_\_  
Signature



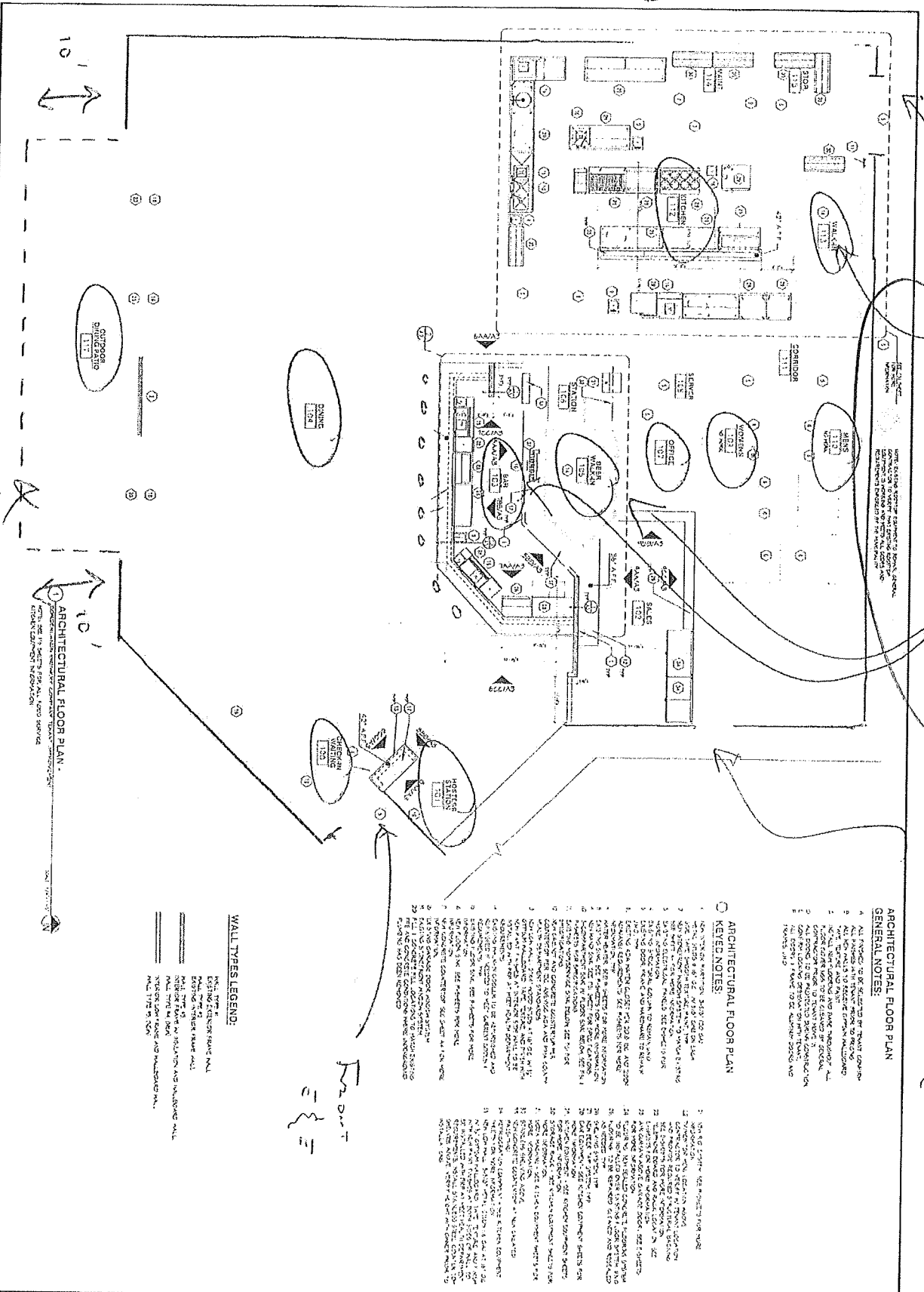

DELIVERED/EMERGENCY  
 U.I.R. STORE CASE

EMERGENCY CASE

5,045 SQ. FT.

65'

Range/Burner  
 Sinks w/ 4' surround

1200

10'  
 ARCHITECTURAL FLOOR PLAN

10'  
 ARCHITECTURAL FLOOR PLAN

**ARCHITECTURAL FLOOR PLAN**  
**GENERAL NOTES:**

1. ALL WORK TO BE ACCORDING TO THE LATEST EDITIONS OF THE BUILDING CODES AND REGULATIONS.
2. ALL WORK SHALL BE DONE IN ACCORDANCE WITH THE LATEST EDITIONS OF THE BUILDING CODES AND REGULATIONS.
3. ALL WORK SHALL BE DONE IN ACCORDANCE WITH THE LATEST EDITIONS OF THE BUILDING CODES AND REGULATIONS.
4. ALL WORK SHALL BE DONE IN ACCORDANCE WITH THE LATEST EDITIONS OF THE BUILDING CODES AND REGULATIONS.
5. ALL WORK SHALL BE DONE IN ACCORDANCE WITH THE LATEST EDITIONS OF THE BUILDING CODES AND REGULATIONS.

**ARCHITECTURAL FLOOR PLAN**  
**KEYED NOTES:**

1. SEE NOTE 1.
2. SEE NOTE 2.
3. SEE NOTE 3.
4. SEE NOTE 4.
5. SEE NOTE 5.
6. SEE NOTE 6.
7. SEE NOTE 7.
8. SEE NOTE 8.
9. SEE NOTE 9.
10. SEE NOTE 10.
11. SEE NOTE 11.
12. SEE NOTE 12.
13. SEE NOTE 13.
14. SEE NOTE 14.
15. SEE NOTE 15.
16. SEE NOTE 16.
17. SEE NOTE 17.
18. SEE NOTE 18.
19. SEE NOTE 19.
20. SEE NOTE 20.
21. SEE NOTE 21.
22. SEE NOTE 22.
23. SEE NOTE 23.
24. SEE NOTE 24.
25. SEE NOTE 25.
26. SEE NOTE 26.
27. SEE NOTE 27.
28. SEE NOTE 28.
29. SEE NOTE 29.
30. SEE NOTE 30.
31. SEE NOTE 31.
32. SEE NOTE 32.
33. SEE NOTE 33.
34. SEE NOTE 34.
35. SEE NOTE 35.
36. SEE NOTE 36.
37. SEE NOTE 37.
38. SEE NOTE 38.
39. SEE NOTE 39.
40. SEE NOTE 40.
41. SEE NOTE 41.
42. SEE NOTE 42.
43. SEE NOTE 43.
44. SEE NOTE 44.
45. SEE NOTE 45.
46. SEE NOTE 46.
47. SEE NOTE 47.
48. SEE NOTE 48.
49. SEE NOTE 49.
50. SEE NOTE 50.

**WALL TYPES LEGEND:**

- 1. 1/2" GYPSUM BOARD ON STUD WALL
- 2. 5/8" GYPSUM BOARD ON STUD WALL
- 3. 1" GYPSUM BOARD ON STUD WALL
- 4. 1 1/2" GYPSUM BOARD ON STUD WALL
- 5. 2" GYPSUM BOARD ON STUD WALL
- 6. 1/2" GYPSUM BOARD ON STUD WALL WITH INSULATION AND WOODWORK WALL
- 7. 1/2" GYPSUM BOARD ON STUD WALL WITH INSULATION AND WOODWORK WALL WITH 1/2" SOLID CORE
- 8. 1/2" GYPSUM BOARD ON STUD WALL WITH INSULATION AND WOODWORK WALL WITH 1/2" SOLID CORE AND 1/2" SOLID CORE

<p><b>BORDERLANDS BREWING COMPANY</b>  <b>TENANT IMPROVEMENT</b>  <b>ARCHITECTURAL FLOOR PLAN &amp; NOTES</b></p> <p>RIVER CENTER AT RIVER ROAD &amp; CRAYCRAFT ROAD        2625 E. RIVER ROAD, SUITE 201        DENVER, CO 80231</p>		<p><b>INTERTECH</b>  <b>ARCHITECTURAL</b>  <b>PRODUCTS</b></p> <p>1800 S. WASHINGTON ST.        DENVER, CO 80202        (303) 733-1111</p>	
<p>DATE: AUG. 2002</p> <p>SCALE: AS SHOWN</p> <p>PROJECT NO. 02-01</p> <p>REVISED: 02-11-05</p>	<p>DATE: AUG. 2002</p> <p>SCALE: AS SHOWN</p> <p>PROJECT NO. 02-01</p> <p>REVISED: 02-11-05</p>	<p>DATE: AUG. 2002</p> <p>SCALE: AS SHOWN</p> <p>PROJECT NO. 02-01</p> <p>REVISED: 02-11-05</p>	<p>DATE: AUG. 2002</p> <p>SCALE: AS SHOWN</p> <p>PROJECT NO. 02-01</p> <p>REVISED: 02-11-05</p>



## RESTAURANT/HOTEL/MOTEL OPERATION PLAN

Arizona Dept. of Liquor Licenses and Control  
800 W. Washington St. 5<sup>th</sup> Floor Phoenix, AZ 85007  
(602) 542-5141

Type or Print with Black Ink

1. Name of restaurant (Please print): DOS B: BORDENLANDS

2. Must indicate the equipment below by Make, Model, and Capacity:

**LIST ONLY THE FOLLOWING - NO ATTACHMENTS**

Grill	1- 48" SS GAS CHAR GRILL, 2- 36" SS COUNTERTOP GRIDDLE
Oven	1- 48" 6 BURNER GAS STOVE TOP W/OVEN, 1- SS UPRIGHT COMBI GAS OVEN
Freezer	1- 7' SS SINGLE DOOR UPRIGHT
Refrigerator	1- 7' SS SINGLE DOOR UPRIGHT, 1- 83" SS REFR., 4 DRAWER BASE, 1- 84" SS REFR. DRAWER BASE, 2- 48" SS REFR. SAND. Prep
Sink	2- 14" SS HAND SINKS, 1- 12" SS HAND SINK, 1- MOP SINK, 1- 8' SS 3 COMP. SINK
Dish Washing Facilities	1- COMM. DISHWASHER
Food Preparation Counter (Dimensions)	2- 36" SS PREP, 3- 72" SS PREP
Other	1- COMM. ICE MACHINE, 2- SS WARMING DRAWER, 2- SS HEAT LAMPS, 1- 14' SS HOOD W/AUSSOL, 1- 6' x 12' SS

WALK IN REFR.

3. Attach a copy of your FULL menu with pricing INCLUDING ALCOHOLIC BEVERAGES

4. What percentage of your public premises is used primarily for restaurant dining?

(Do not include kitchen, bar, hi-top tables, or game area.) 90 %

5. Does your restaurant have a bar area that is distinct and separate from the dining area?  YES  No

(If yes, what percentage of the public floor space does this area cover?) 10 %

6. List the seating capacity for:

a) Restaurant dining area of your premises: [ 60 ]

(DO NOT INCLUDE PATIO SEATING)

b) Bar area [ + 8 ]

TOTAL [ = 68 ]

7. What type of dinnerware is primarily used in your restaurant?  Reusable  Disposable  Both
8. Does your restaurant contain any games, televisions, or any other entertainment?  YES  No

If yes, specify what types and how many (examples: 4-TV's, 2-Pool Tables, 1-Video Game, etc.)

3 - 55" TO 60" Flat Screen TV's

9. Do you have live entertainment or dancing?  YES  No
- If yes, what type and how often (example: DJ-2 x a week, Karaoke-2 x a month, Live Band-1 x a month, etc.)

10. List number of employees for each position:

Position	How many
Cooks	12
Bartenders	4/5
Hostesses	4
Managers	3
Servers	10
Other (DISHWASHERS)	2
Other ( )	
Other ( )	

I, (Print Full Name) Kevin Andrew Krantz hereby swear under penalty of perjury and in compliance with A.R.S. § 4-210(A)(2) and (3) that I have read and understand the foregoing and verify that the information and statements that I have made herein are true and correct to the best of my knowledge.

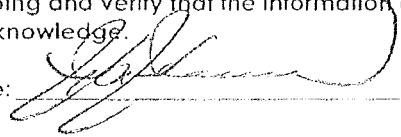
Applicant Signature: 



**RECORDS REQUIRED  
FOR AUDIT  
RESTAURANT/HOTEL/MOTEL**

Arizona Dept. of Liquor Licenses and Control  
800 W. Washington St. 5<sup>th</sup> Floor Phoenix, AZ 85007  
(602) 542-5141

Type or Print with Black Ink

In the event of an audit, you will be asked to provide to the Department any documents necessary to determine Compliance with A.R.S. §4-205.02(G). Such documents requested may include however, are not limited to:

1. Name of restaurant (Please print): DOE BY BONDENLANDS

- 2. All invoices and receipts for the purchase of food and spirituous liquor for the licensed premises.
- 3. A list of *all* food and liquor vendors
- 4. The restaurant menu used during the audit period
- 5. A price list for alcoholic beverages during the audit period
- 6. Mark-up figures on food and alcoholic products during the audit period
- 7. A recent, **accurate** inventory of food and liquor (taken within two weeks of the Audit Interview Appointment)
- 8. Monthly Inventory Figures - beginning and ending figures for food and liquor
- 9. Chart of accounts (copy)
- 10. Financial Statements-Income Statements-Balance Sheets

11. General Ledger

A. Sales Journals/Monthly Sales Schedules

- 1) Daily sales Reports (to include the name of each waitress/waiter, bartender, etc. with sales for that day)
- 2) Daily Cash Register Tapes - Journal Tapes and Z-tapes
- 3) Dated Guest Checks
- 4) Coupons/Specials/Discounts
- 5) Any other evidence to support income from food and liquor sales

B. Cash Receipts/Disbursement Journals

- 1) Daily Bank Deposit Slips
- 2) Bank Statements and canceled checks

12. Tax Records

A. Transaction Privilege Sales, Use and Severance Tax Return (copies)

B. Income Tax Return - city, state and federal (copies)

C. Any supporting books, records, schedules or documents used in preparation of tax returns

13. Payroll Records

23 FEB 10 10:41 AM '06

- A. Copies of all reports required by the State and Federal Government
- B. Employee Log (A.R.S. §4-119)
- C. Employee time cards (actual document used to sign in and out each work day)
- D. Payroll records for all employees showing hours worked each week and hourly wages

14. Off-site Catering Records (must be complete and separate from restaurant records)

- A. All documents which support the income derived from the sale of food off the license premises.
- B. All documents which support purchases made for food to be sold off the licensed premises.
- C. All coupons/specials/discounts

The sophistication of record keeping varies from establishment to establishment. Regardless of each licensee's accounting methods, the amount of gross revenue derived from the sale of food and liquor must be substantially documented.

**REVOCAION OF YOUR LIQUOR LICENSE MAY OCCUR IF YOU FAIL TO COMPLY WITH  
A.R.S. §4-210(A)7 AND A.R.S. §4-205.02(G).**

**A.R.S. §4-210(A)7**

The licensee fails to keep for two years and make available to the department upon reasonable request all invoices, records, bills or other papers and documents relating to the purchase, sale and delivery of spirituous liquors and, in the case of a restaurant or hotel-motel licensee, all invoices, records, bills or other papers and documents relating to the purchase, sale and delivery of food.

**A.R.S. §4-205.02(G)**

For the purpose of this section:

1. "Restaurant" means an establishment which derives at least forty percent (40%) of its gross revenue from the sale of food
2. "Gross revenue" means the revenue derived from all sales of food and spirituous liquor on the licensed premises regardless of whether the sales of spirituous liquor are made under a restaurant license issued pursuant to this section or under any other license that has been issued for the premises pursuant to this article.

I, (Print Full Name) Kevin Anthony Krantz hereby swear under penalty of perjury and in compliance with A.R.S. § 4-210(A)(2) and (3) that I have read and understand the foregoing and verify that the information and statements that I have made herein are true and correct to the best of my knowledge.

Applicant Signature: [Handwritten Signature]

**\*MAKE A COPY OF THIS DOCUMENT AND KEEP IT WITH RECORDS REQUIRED BY THE STATE\***

Smoked salmon tostadas -- Chipotle rubbed smoked salmon + Slaw + Tostadas \$18

Dry aged rib eye – Market Price

Tamal de Maíz topped with ox tail \$23

Caldo de Queso \$13

Ceviche de Nopal \$12

Quesadillas De Rajas \$13

Milanesas de Puerco over cherry tomato salad, panela, roasted green chiles \$19

Ribeye Tacos- Green onions- Frijoles charros \$16

Chile Relleno stuffed with Oaxaca cheese + Bean Chipotle Sauce \$14

Betabel + pistachios

Roasted beets in a achiote rub topped with pistachios and Requeson \$14

Tostones con Puerco Arroz Rojo \$17

Grilled Napa Cabbage with a honey chipotle miso \$12

Masa & Shrimp Tortitas \$15- Corn Masa + Shrimp Machaca + Cilantro Crema.

Tacos de Jamaica- \$12

Burger and Chorizo \$13

Chayote Rellenos- Roasted chayotes stuffed with picadillo over a tomato chipotle sauce \$14

Sopa Azteca

AZ Ale

10oz: \$4.52

16oz: \$5.98

32oz: \$10.12

64oz: \$22.60

Watermelon Ale

10oz: \$5.06

16oz: \$6.44

32oz: \$10.12

64oz: \$22.60

Citrana SW Gose

125 FEB 10 L.P. CO. #19 25

10oz: \$5.06  
16oz: \$6.94  
32oz: \$11.04  
64oz: \$22.60

**La Miche**

10oz: \$5.06  
16oz: \$6.94  
32oz: NA  
64oz: NA

**Lil' Toole**

10oz: \$5.06  
16oz: \$6.94  
32oz: \$11.04  
64oz: \$22.60

**Toole Ave**

10oz: \$6.06  
16oz: \$7.36  
32oz: \$12.96  
64oz: \$23.92

**Toole Ave Infusions (Peach Mango, Tangerine, Coconut Pineapple)**

10oz: \$6.06  
16oz: \$7.56  
32oz: \$12.96  
64oz: \$23.92

**Guava Goddess**

10oz: \$6.06  
16oz: \$7.36  
32oz: NA  
64oz: NA

**Prickly Pear Wheat**

10oz: \$5.06  
16oz: \$6.94  
32oz: \$11.96  
64oz: \$23.92

**Kapahi Lime Raspberry Wheat**

10oz: \$5.06  
16oz: \$6.94  
32oz: \$11.96  
64oz: \$23.92

**Cashmere Cactus**

985 FEB 10 12:04 PM '06

10oz: \$5.06  
16oz: \$6.44  
32oz: \$11.04  
64oz: \$22.60

**Horchata Cream**

10oz: \$5.06  
16oz: \$6.94  
32oz: \$11.96  
64oz: \$23.92

**Noche Dulce**

10oz: \$5.06  
16oz: \$7.40  
32oz: \$11.96  
64oz: \$23.92

**German Chocolate Cake**

10oz: \$5.98  
13oz: \$8.19  
32oz: \$16.96  
64oz: \$24.92

**La Sonorita**

10oz: \$5.06  
16oz: \$6.94  
32oz: \$11.04  
64oz: \$22.60

**4oz Sampler**

Any beer: \$2.50

**WINE**

**Chronic Cellars Red:**

Glass: \$8.05  
Bottle: \$17.00

**Conundrum Red:**

Glass: \$8.05  
Bottle: \$17.00

**Conundrum white:**

Glass: \$8.05  
Bottle: \$17.00

**Ménage A Trios Chardonnay:**

Glass: \$8.05



183 FEB 10 04:11:41 AM '05

Bottle: \$17.00

**Vera Cruz "Tequila"**

Tipsy shot: \$2.00

Shot: \$5.00

**MARGARITAS**

On The Rocks (Regular, Prickly Pear, Mango, Strawberry): \$6.00

Frozen (Prickly Pear & Mango): \$6.00

**CANS**

**White Claws:**

Mango/Black Cherry: \$5.00

Mango/Black Cherry with chamoy: \$6.00

**June Shine Kombucha:**

Grapefruit Paloma: \$7.00

**Non-Alcoholic Athletic Brewing:**

Run Wild Ipa: \$6.00

Upside Dawn Golden Ale: \$6.00

**Prickly Pear Wheat:**

6-pack: 13.99

**Horchata:**

6-pack: \$13.99

**Toole Ave Ipa:**

Single can: \$6.14

4 pack: \$18.50

**La Miche:**

Single can: \$5.50

4 pack: \$16.96

**SODA**

Coke: \$2.07

Sprite: \$2.07

Orange Fanta: \$2.07

Manzanita Apple Soda: \$2.07

Diet Coke: \$2.07

Perrier: \$3.07