



Contract Value: CT. WW-13*805-
 Effective Date: 7-1-13
 Term Date: 2-1-16
 Cost: 888,970.70
 Revenue: _____
 Total: _____
 Renewal By: _____
 Term: _____
 Reviewed by: UR

Procure Dept 05/28/13 AM 11:02

BOARD OF SUPERVISORS AGENDA ITEM SUMMARY

Requested Board Meeting Date: June 18, 2013

ITEM SUMMARY, JUSTIFICATION &/or SPECIAL CONSIDERATIONS:

This Utility Agreement is between the Arizona Department of Transportation (ADOT) and Pima County for the expansion of SR 77 (Oracle Rd) between Tangerine Rd and the Pima-Pinal County line. This agreement is for sewer design, construction and relocation work done in conjunction with the roadway project.

CONTRACT NUMBER: CT13*805

STAFF RECOMMENDATION(S):

This request will prepay RWRD's estimated construction portion as required by ADOT and this payment is budgeted in the Regional Wastewater Reclamation Department's CIP budget for the current fiscal year. Please be advised that this number is only an estimate at this point. Following a final audit, the County's cost share may be adjusted up or down. If additional funding is required, the parties will amend the authorized amount in the agreement. However, this agreement commits the County to pay the full cost of the relocation.

CORPORATE HEADQUARTERS: _____

To: COB - 6-5-13
 Agenda 6-18-13
 (2)

Procure Dept 05/28/13 AM 08:37

CLERK OF BOARD USE ONLY: BOS MTG. _____

ITEM NO. _____

PIMA COUNTY COST: \$888,970.70 and/or REVENUE TO PIMA COUNTY: \$0.00

FUNDING SOURCE(S): **RWRD Capital Improvement Program**
(i.e. General Fund, State Grant Fund, Federal Fund, Stadium D. Fund, etc.)

Advertised Public Hearing:

<input type="checkbox"/>	YES	<input checked="" type="checkbox"/>	NO
--------------------------	-----	-------------------------------------	----

Board of Supervisors District:

1	<input checked="" type="checkbox"/>	2	<input type="checkbox"/>	3	<input type="checkbox"/>	4	<input type="checkbox"/>	5	<input type="checkbox"/>	All	<input type="checkbox"/>
---	-------------------------------------	---	--------------------------	---	--------------------------	---	--------------------------	---	--------------------------	-----	--------------------------

IMPACT:

IF APPROVED: RWRD utility construction and relocation will be accomplished in an efficient manner with no service disruptions to RWRD customers while ADOT adds an additional lane to SR 77 between Tangerine Rd and the Pima – Pinal county line.

IF DENIED: RWRD will have to find an alternative to construct or relocate RWRD utilities for the ADOT SR 77 road widening project and that alternative would be more costly and coordination efforts between the RWRD and ADOT contractor will reduce efficiencies.

DEPARTMENT NAME:

CONTACT PERSON: John Munden, RWRD TELEPHONE NO.: (520) 724- 6357

ARIZONA DEPARTMENT OF TRANSPORTATION

UTILITY AND RAILROAD ENGINEERING SECTION

UTILITY AGREEMENT
Between
THE STATE OF ARIZONA

and

PIMA COUNTY

CONTRACT
NO. <i>CJ.WW-13000000000000000000805</i>
AMENDMENT NO. _____
<small>This number must appear on all invoices, correspondence and documents pertaining to this contract.</small>

Agreement No.: 3428-13-PCRWRD
CONSTRUCTION TRACS No. 077 PM 081 H6694 01C
CONSTRUCTION PROJECT NO. STP-077-A(204)T
Highway: Tucson-Oracle Junction-Globe Highway
Location: Tangerine Road to Pinal County Line

THIS AGREEMENT is made between the STATE OF ARIZONA, acting through its DEPARTMENT OF TRANSPORTATION, and Pima County, acting for its Regional Wastewater Reclamation Department.

All lettered exhibits are incorporated and made a part of this agreement by reference and attachment regardless of designation or alphabetical order.

INDEX

<u>Section</u>	<u>Page</u>
INDEX	2
I. RECITALS	4
II. DEFINITIONS	4
III. AGREEMENT	6
A. Construction Requirements	6
1. ADOT to Provide for the Construction of Facilities	6
2. Maintenance	6
B. Transfer of Land Interests	7
C. Permit	7
1. Normal Permit for non-prior rights facilities	7
2. Joint Occupancy	7
D. Traffic	7
E. Start/Completion Date	7
F. Subcontracting	7
G. Blue Stake	8
H. The Acceptance Date	8
IV. SCHEDULES AND PAYMENTS	8
A. Utility Construction Schedule	8
B. Payments	8
1. Changes in Scope of Work	9
2. Submission of Invoices	9
3. Payment of Invoices	9
4. Reimbursements	9
V. LIABILITY	9
A. Liability	9
VI. STATUTORILY MANDATED TERMS	9
A. Arbitration	10
B. Budget Limitations	10
C. Executive Orders 75-5 and 2009-9	10
D. Cancellation by Governor	10

VII. MISCELLANEOUS CONDITIONS	10
A. Communication for this AGREEMENT	10
B. AGREEMENT Content and Modification	10
C. Laws	11
D. Breach of AGREEMENT	11
Signature & Notary Public Page	12
Exhibit "A" Cost Estimate	
Exhibit "B" Plans for Relocation WORK	

I. RECITALS:

The purpose of this agreement is to enable the Arizona Department of Transportation to complete a highway project. In order to complete this PROJECT, it is necessary for the UTILITY to RELOCATE and/or improve existing facilities belonging to UTILITY. ADOT will RELOCATE the UTILITY's facilities which are in conflict with the PROJECT design and construct any BETTERMENTS identified in the PROJECT plans and this AGREEMENT.

The UTILITY's facilities to be relocated do not have PRIOR RIGHTS.

1. Construct approximately 449 feet of new 12-inch line along SR77 between station 949+77.14, 69.7' Lt. to Station 954+25.80, 68.8' and removal of two Manholes.
2. Construct retaining walls that connect to the wing walls of the concrete box culvert at Twenty Seven wash to provide access to a UTILITY manhole.
3. Construct approximately 24 feet of new 12-inch line connecting at the intersection of Mainsail Blvd and the removal of approximately of 17 feet of 12-inch line.
4. Eleven manhole adjustments and twelve manhole reconstructions.

In addition to the sewer RELOCATIONS, UTILITY will reimburse ADOT for the construction of a storm drain system that replaces the rainwater basin design concept on the west side of the roadway between Station 967+50 to Station 1042+00, A newly designed 24" RCP storm drain system and 2'x3' catch basins in shallow ditches that carry the drainage to the storm drain system on the east side of the roadway.

II. DEFINITIONS:

- A. ADOT means the ARIZONA DEPARTMENT OF TRANSPORTATION.
- B. ADOT EMERGENCY means a utility failure, which affects the safety of the motorist or the highway.

C. AGREEMENT means this specific agreement and all attachments incorporated by reference.

D. A.R.S. means Arizona Revised Statutes.

E. BETTERMENT means increased capacity or improvement in the UTILITY's facility.

F. CONSTRUCTION PROJECT NO. means the roadway construction project number utilized for ADOT construction PROJECT, which is 077 PM 081 H6694 01C

G. CONSTRUCTION TRACS NO. means the roadway construction Accounting number utilized for ADOT construction PROJECT, which is STP-077-A(204)T.

H. CONTROLLED ACCESS means locations where owners or occupants of abutting lands and other persons have no legal right of access, e.g., freeway lanes and freeway ramps.

I. MUTCD means the "Manual on Uniform Traffic Control Devices" and any amendments and/or revisions thereto.

J. PRIOR RIGHTS means rights associated with one party's use or occupancy of land, or with the facilities located on such land, that are, because of priority in time or other reasons, superior to the rights of the other party.

K. PROJECT means this ADOT roadway construction project.

L. RELOCATE or RELOCATION means to move or adjust the UTILITY facility to avoid conflict with PROJECT construction.

M. RELOCATED FACILITIES means the facilities so moved or adjusted.

N. UTILITY means PIMA COUNTY, specifically the Pima County Regional Wastewater Reclamation Department (PCRWRD).

O. UTILITY EMERGENCY means any failure or condition affecting UTILITY's relocated facilities that has a substantial effect on UTILITY's functions and requires immediate action to remedy the failure or condition.

P. WORK means construction administration, construction labor, materials and equipment called for in this AGREEMENT, including approved changes in scope.

Q. WORKING DAY means a calendar day, exclusive of Saturdays, Sundays and ADOT recognized holidays, on which weather conditions will permit the UTILITY construction operations to proceed for a major part of the day with the normal working force.

III AGREEMENT:

A. Construction Requirements. The UTILITY shall furnish all necessary engineering, design, plans, specifications, covering the RELOCATION of and/or adjustments to its existing facilities in accordance with the UTILITY plans marked exhibit "B".

1. ADOT to Provide for the Construction of Facilities. ADOT will provide in its contract with ADOT's contractor to RELOCATE UTILITY's non-prior right facilities and/or construct BETTERMENTS.

2. Maintenance. Maintenance operations and associated costs for the UTILITY's facilities covered by the AGREEMENT will be the responsibility of the UTILITY.

3. Ownership of Facilities. UTILITY shall be the sole owner of RELOCATED FACILITIES constructed under this AGREEMENT. Nothing herein shall be construed as conveying or granting any right, title or interest in the RELOCATED FACILITIES to anyone other than the UTILITY.

B. Transfer of Land Interests. Since the UTILITY does not have PRIOR RIGHTS no land interests are transferred.

C. Permit. The UTILITY will obtain a permit from ADOT and will provide applicable insurance for those facilities remaining within the highway right-of-way or for any work proposed within ADOT's right-of-way of the PROJECT.

1. Normal permit for non-prior rights facilities. ADOT will grant to the UTILITY a normal permit for non-prior rights facilities remaining within the highway right-of-way.

2. Joint Occupancy. The UTILITY understands ADOT's and all of its agents' right to construct, maintain and operate highway facilities over/under the UTILITY facilities within the highway Right-of-Way. ADOT retains the right to permit other occupancies.

D. Traffic. The UTILITY shall not maintain, construct, reconstruct, inspect or operate any of its facilities from highway traffic lanes or ramps within the CONTROLLED ACCESS right-of-way. In case of an ADOT EMERGENCY involving UTILITY's facilities, UTILITY shall have reasonable use of the roadway notwithstanding the foregoing restriction. In case of a UTILITY EMERGENCY, UTILITY shall have use of ADOT right of way outside the highway traffic lanes or ramps as it reasonably deems necessary to correct, repair, replace or reconstruct facilities affected by the UTILITY EMERGENCY. The UTILITY shall, as soon as practical during any ADOT EMERGENCY or UTILITY EMERGENCY repairs, provide appropriate safety devices to protect the highway user as set forth in the MUTCD (Including all official changes thereto), for all work within ADOT right of way.

E. Start/Completion Date. The RELOCATION will be accomplished during the PROJECT construction by ADOT.

F. Subcontracting. The RELOCATION will be performed by ADOT's contractor and/or subcontractor.

G. Blue Stake. For WORK performed by ADOT's contractor for the PROJECT, it is understood that ADOT is acting as a third party on behalf of the UTILITY, administering the construction of UTILITY's facilities. At no time is ADOT to be considered the owner of, or locator for, the UTILITY's facilities. ADOT's contractor for the PROJECT shall locate any underground facilities installed by ADOT's contractor (or subcontractor of any tier) for ADOT PROJECT as prescribed by A.R.S. 40-360.21 through 40-360.29, until (i) the PROJECT is accepted by ADOT and ADOT has given UTILITY one month's prior notice or (ii) until the time the facility is tested and placed into service by UTILITY, at which time (whichever is earlier) UTILITY shall assume Blue Staking responsibility. The transfer of Blue Stake responsibility to UTILITY shall not affect UTILITY's rights to inspect the RELOCATED FACILITIES, to require correction of any defects, or any other rights under this AGREEMENT.

H. The Acceptance Date. The acceptance date of this AGREEMENT shall be the day which the last party executes the AGREEMENT.

IV. SCHEDULES AND PAYMENTS:

A. Utility Construction Schedule. Any service connections and system startup work not shown on the Plans for RELOCATION WORK, Exhibit "B", is the UTILITY's responsibility and said work will accommodate the PROJECT construction schedule.

B. Payments. The UTILITY will be responsible for the cost of RELOCATION and BETTERMENT and any WORK performed by ADOT for non-prior rights facilities and/or BETTERMENT facilities. The UTILITY shall pay ADOT's total cost of performing WORK for

the UTILITY. It is agreed that the total cost shall consist of the actual amount paid to ADOT's contractor for performing any construction WORK for the UTILITY, all costs will be subject to the addition of 15% to cover ADOT's cost of construction engineering, inspection and administration. The estimated total cost for RELOCATION and/or BETTERMENT is set forth in exhibit "A".

1. Changes in Scope of Work. In the event conditions or circumstances require a change in the scope of work on the RELOCATION and/or BETTERMENT as set forth in exhibit "B", each party shall agree in writing to the changes, including payment responsibilities prior to doing the work.

2. Submission of Invoices. Following completion of the PROJECT, ADOT will determine the final total cost. If ADOT's final total cost differs from the estimated amount previously paid by the UTILITY, ADOT will refund the amount of overpayment, or will invoice the UTILITY for the additional amount due. ADOT will make any such refund within ninety (90) calendar days after completion of the PROJECT.

3. Payment of Invoices. The UTILITY shall attach payment in the amount of the estimated total cost as set forth in exhibit "A" when returning this AGREEMENT to ADOT for final execution. The UTILITY agrees to pay ADOT any additional amount due within ninety (90) days of receipt of the final invoice.

V. LIABILITY:

A. Liability. ADOT and the UTILITY each agree to be liable to the other party for its own acts of negligence and the negligence of its own employees.

VI. STATUTORILY MANDATED TERMS:

A. Arbitration. The parties shall use arbitration after exhausting applicable administrative remedies to resolve disputes arising out of this AGREEMENT where the sole relief sought is monetary damages of \$100,000 or less exclusive of interest and costs, as provided in A.R.S. § 12-1518.

B. Budget Limitations. This AGREEMENT is subject to the provisions of Chapter 1 of Title 35, Arizona Revised Statutes.

C. Executive order 75-5 and 2009-9. The UTILITY shall comply with all applicable provisions of Executive Order 75-5 and 2009-9, "Non-Discrimination in Employment by Government Contractors and Subcontractors".

D. Cancellation by Governor. All parties hereby are put on notice that this AGREEMENT is subject to cancellation by the Governor pursuant to A.R.S. § 38-511.

VII. MISCELLANEOUS CONDITIONS:

A. Communication for this AGREEMENT. Communication required to be given pursuant to this AGREEMENT shall be:

Arizona Department Of Transportation
Utility and Railroad Engineering Section
Attn.: Engineer - Manager
205 South 17th Avenue, Mail Drop 618E
Phoenix, AZ 85007

Pima County Regional Wastewater
Reclamation Department
Attn: Souren Naradikian
Public Works Building
201 N. Stone Avenue, 3rd Floor
Tucson, Arizona 85701-1207
FAX: 520 724 - 9812

B. AGREEMENT Content and Modification. This AGREEMENT, including any schedules, exhibits or attachments hereto, constitutes the entire agreement between the parties, and no understanding or obligation not expressly set forth herein shall be binding upon them. No modification, amendment or alteration of this AGREEMENT shall be valid unless it is in writing and signed by both parties.

C. Laws. This AGREEMENT shall be governed by the laws of the State of Arizona.

D. Breach of AGREEMENT. The waiver by either party of any breach or failure to provide full performance under any of the terms or conditions of this AGREEMENT shall not be construed as a waiver of any other term or condition, or of any subsequent breach of the same or any other term or condition.

IN WITNESS WHEREOF, the parties hereto have executed this AGREEMENT.
ARIZONA DEPARTMENT OF TRANSPORTATION
JOHN HALIKOWSKI, DIRECTOR

By: Benny Crockett
for Dallas Hammit
Senior Deputy State Engineer, Development

Date 5/22/13

Recommended by Victoria D. Bever
Victoria D. Bever
Utility & Railroad Engineering Manager

Date 5/22/2013

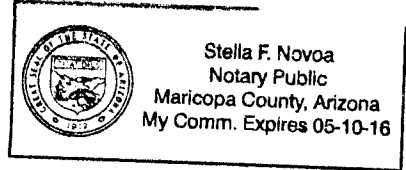

ACKNOWLEDGMENT BY STATE

STATE OF ARIZONA)
) ss
COUNTY OF MARICOPA)

The foregoing instrument was acknowledged before me this 22nd day of MAY, 2013, by Dallas Hammit Senior Deputy State Engineer, Development, Arizona Department of Transportation.

My Commission Expires: 05-10-16

Stella F. Novoa
Notary Public

ACKNOWLEDGMENT BY UTILITY

Pima County:

Chairman, Board of Supervisors

Date

Attest:

Lori Godoshian, Clerk of the Board

Approved as to Content:

Jackson Jenkins
Jackson Jenkins, Director
Pima County Regional Wastewater Reclamation Department

Approved as to Form:

Charles Wesselhoft
Charles Wesselhoft, Deputy County Attorney

5-23-13
Date

Exhibit A

Summary

3428-13-PCRWRD

PIMA COUNTY

SR77 TANGERINE ROAD TO PINAL COUNTY LINE

SUMMARY OF ESTIMATED COST

URS estimate 5/13/2013	\$773,018.00
ADOT mark up 15%	\$115,952.70
Total Due ADOT	\$888,970.70

SR 77 PCRWRD DETAILED ESTIMATE (Stage V)
 Design Widening SR 77 (Oracle Hwy) Tangerine Rd. to Pinal County Line
 H 6694 O1C

Item No	Item Description	Unit	Quantity	Unit Price	Amount
2020042	REMOVAL OF PIPE (SEWER)	L.FT.	478	\$35.00	\$16,730.00
2020054	REMOVE (SEWER MANHOLES)	EACH	3	\$500.00	\$1,500.00
2030901	BORROW	CU.YD.	850	\$8.00	\$6,800.00
4061004	PAVEMENT CUT & REPLACEMENT (DETAIL DX)	SQ.YD.	113	\$50.00	\$5,650.00
5011023	PIPE, REINFORCED CONCRETE, CLASS III, 24"	L.FT.	3,700	\$65.00	\$240,500.00
5030142	CONCRETE CATCH BASIN (MEDIAN) (C-15.80)	EACH	19	\$3,000.00	\$57,000.00
5050001	MANHOLE (C-18.10) (NO. 1) (FOR PIPES 6" TO 36")	EACH	3	\$3,000.00	\$9,000.00
5050202	RESET FRAME AND COVER FOR MANHOLE (ADJUST TO GRADE)	EACH	5	\$500.00	\$2,500.00
5050221	RECONSTRUCT MANHOLE	EACH	12	\$2,000.00	\$24,000.00
5050355	MANHOLE (SANITARY)(5-FT DIAMETER)	EACH	4	\$7,000.00	\$28,000.00
6110202	METAL HANDRAIL (PCDOT/COT STD DTL 105)	L.FT.	384	\$30.00	\$11,520.00
8090186	SEWER PIPE (12")(DUCTILE IRON)	L.FT.	463	\$260.00	\$120,380.00
9080303	CONCRETE DRIVEWAY	SQ.FT.	850	\$5.00	\$4,250.00
9130001	RIPRAP (DUMPED)	CU.YD.	40	\$80.00	\$3,200.00
9140121	RETAINING WALL (REINFORCED CONCRETE)	SQ.FT.	3,285	\$44.00	\$144,540.00
9201006	CONCRETE CHANNEL LINING (6")	SQ.YD.	50	\$60.00	\$3,000.00
9240054	MISCELLANEOUS WORK (FLOW MANAGEMENT PLAN-SEWER BYPASS)	L.SUM	1	\$112,000.00	\$112,000.00
PCRWRD CONSTRUCTION ITEMS TOTAL =					\$790,570.00
Drainage Excavation Costs Savings equals \$17,552 (to be deducted from Constr. Total) Revised Construction Total with Credit					\$773,018.00

Exhibit B

Plans for Relocation

EXHIBIT "B"

ARIZONA DEPARTMENT OF TRANSPORTATION SR 77 PUBLIC SEWER IMPROVEMENTS PCRWRD PLAN NO. G-2013-023



PARALLEL ROAD NO.	STATE	PROJECT NO.	SHEET TOTAL
9	AZ	SR-077-A(2013)	OF 5
			DATE: 077 PM 081

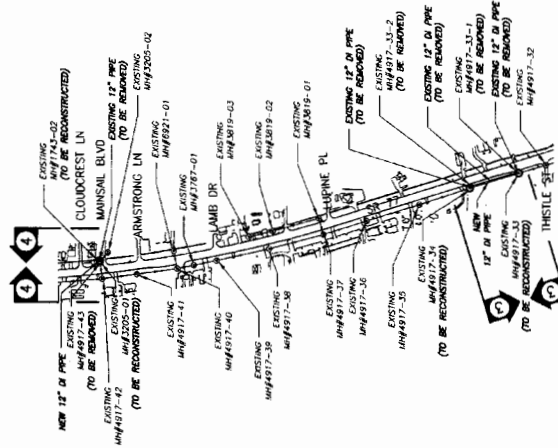

Ericson Volades, Chair
DISTRICT 2
Ann Eby
DISTRICT 1
Raymond Corral
DISTRICT 4
Sharon Branson
DISTRICT 3
Richard Eise
DISTRICT 5



PAGE	DWG NO.	SHEET	DESCRIPTION
	U-2.01	SS01	COVER AND SHEET INDEX
	U-2.02	SS02	GENERAL NOTES AND LEGEND
	U-2.03	SS03	PLAN AND PROFILE
	U-2.04	SS04	MARSHAL BLVD PLAN AND PROFILE DETAIL
	U-2.05	SS05	DETAIL SHEET

APPROVED BY:

 ERIC WICKHAM, PE
 DEPUTY DIRECTOR,
 PLANNING & ENGINEERING DIVISION
 CONFORMANCE SERVICES DIVISION
 DATE: May 1, 2013
 5/8/13

 DATE: 05-08-2013

PLAN VIEW
SCALE: 1"= 500'

UPC-2011-028		COVER AND SHEET INDEX		SS01 OF SS05
ARIZONA DEPARTMENT OF TRANSPORTATION		ROADSIDE DESIGN SECTION		
DESIGN	DATE	SCALE	PROJECT NO.	PROJECT NAME
SR 77	07/17/13	1"=500'	SR 77	SANITARY SEWER PLANS
LOCATION			TANGIERNE ROAD TO PINAL COUNTY LINE	
PROJECT NO.			SRP-077-A(2013)	
BY	DATE	DESCRIPTION		

URS
 201 N. Stone Ave. Tucson, AZ 85701
 Phone: (520) 740-0000

ARIZONA 801
 801 ARIZONA AVE. TUCSON, AZ 85701
 (520) 740-0000

EXHIBIT "B"

GENERAL SEWER NOTES

- ALL DESIGN STANDARDS, MATERIALS AND WORKMANSHIP FOR PUBLIC SANITARY SEWERS ARE TO BE IN ACCORDANCE WITH THE LATEST EDITIONS OF THE STANDARD SPECIFICATIONS AND DETAILS FOR CONSTRUCTION 2012 MANUAL AND ENGINEERING STANDARDS 2012 MANUAL. SAID MANUALS ARE ON FILE AT THE PINA COUNTY REGIONAL WASTEWATER RECLAMATION DEPARTMENT OFFICES AT 201 N. STONE AVENUE, 6TH FLOOR. (http://www.pina.gov/warty/wat/eng_standards)
- BASES AND RECORD OF BEARING (HORIZONTAL CONTROL) NAD83/92 BENCHMARK ELEVATIONS (VERTICAL CONTROL) ARE BASED ON NAVD83 DATUM SEE STATE HIGHWAY TUCSON-ORACLE JUNCTION-GLOBE HIGHWAY SR 77 (TANGIERNE ROAD TO PINA COUNTY LINE) ADJ. VERT. CONTROL, DMC NO. G-318.
- THE CONTRACTOR SHALL VERIFY LOCATIONS AND ELEVATIONS OF ALL EXISTING UTILITIES PRIOR TO ANY CONSTRUCTION. CALL "BLUE STAKE" AT 1-800-782-5448 A MINIMUM OF TWO (2) FULL WORKING DAYS PRIOR TO EXCAVATING.
- EXISTING PRESSURE AND SANITARY SEWER MAIN LOCATIONS WILL BE IDENTIFIED AND MARKED PER PINA COUNTY REGIONAL WASTEWATER RECLAMATION DEPARTMENT (PWRD) STANDARD SPECIFICATIONS AND DETAILS FOR CONSTRUCTION 2012 MANUAL, DETAIL PWRD 503.
- THE CONTRACTOR SHALL FIELD EXISTING SEWER ELEVATIONS AND ALIGNMENTS PRIOR TO CONSTRUCTION AND IMMEDIATELY REPORT ANY DISCREPANCIES TO THE PWRD. CONSTRUCTION AND IMMEDIATELY REPORT ANY DAMAGE TO OR THE PWRD. PWRD FIELD ENGINEERING (520-740-2651) OR PWRD COMPLIANCE DIVISION (520-724-3400) ON WEDNESDAYS, HOLIDAYS, OR BETWEEN 5:00 P.M. AND 7:00 A.M. IMMEDIATELY CALL PWRD CENTRAL CONTROL ROOM (CCR) AT 520-443-6048 AND REQUEST A PWRD REPRESENTATIVE TO BE DISPATCHED TO THE SITE. THE IMMEDIATE ACTION TO BE TAKEN BY THE CONTRACTOR IS TO STOP ALL WORK AND TO REPAIR THE SYSTEM FOR ANY EXPENSES TO MITIGATE THE RELEASE AND TO DISINFECT THE RELEASE AREAS AND FOR ANY REGULATORY PENALTIES LEVIED ON PWRD BECAUSE THE CONTRACTOR ENTERED A NATURAL OR CONSTRUCTED STORM WATER DRAINAGE SYSTEM. THE CONTRACTOR SHALL REPAIR ALL DAMAGE AS DIRECTED AND APPROVED BY PWRD.
- HOUSE OR BUSINESS CONNECTION SEWERS (HCS OR BCS) ARE NOT PART OF THE PUBLIC SANITARY SEWER CONVEYANCE SYSTEM. PRIVATE CONNECTION SEWERS CONSTRUCTED PRIOR TO JANUARY 2008 ARE NOT REQUIRED TO BE BLUE STAKED. ANY REVISIONS ENCOUNTERED PRIOR TO CONSTRUCTION SHALL BE REPORTED IMMEDIATELY TO THE PWRD. THE PWRD ENGINEER DICTATES PER PINA COUNTY REGIONAL WASTEWATER RECLAMATION DEPARTMENT (PWRD) STANDARD SPECIFICATIONS AND DETAILS FOR CONSTRUCTION 2012 MANUAL, DETAIL PWRD 400 AND TO NO EXPENSE TO THE PROPERTY OWNER OR THE PINA COUNTY REGIONAL WASTEWATER RECLAMATION DEPARTMENT.
- SEWER CONSTRUCTION SHALL NOT COMMENCE UNTIL:
 - ARIZONA DEPARTMENT OF ENVIRONMENTAL QUALITY (ADEQ) HAS ISSUED A CERTIFICATE OF "CONSTRUCTION AUTHORIZATION" FOR THIS PROJECT.
 - THE CONTRACTOR HAS OBTAINED A PUBLIC SEWER CONSTRUCTION PERMIT FROM THE PINA COUNTY REGIONAL WASTEWATER RECLAMATION DEPARTMENT 520-724-6369.
 - A PRE-CONSTRUCTION MEETING WITH THE ASSIGNED PINA COUNTY PROJECT INSPECTOR HAS BEEN HELD. THE PRE-CONSTRUCTION MEETING SHALL BE SUBMITTED TO FIELD ENGINEERING THIRTY (30) DAYS PRIOR TO THE PRE-CONSTRUCTION MEETING.
- IT IS THE CONTRACTOR'S RESPONSIBILITY TO ADJUST OR RECONSTRUCT ALL SANITARY SEWER MANHOLES TO FINISHED GRADE. ALL FRAMES AND COVER ADJUSTMENTS ARE TO BE IN ACCORDANCE WITH THE COORDINATED WASTEWATER RECLAMATION 2012 MANUAL, DETAIL PWRD 300. ALL MANHOLES SHALL BE FINISHED TO FINISHED GRADE (AS APPLICABLE) AND DETAIL PWRD 300A WHILE ADJUSTING THE FRAME AND COVER. THE CONTRACTOR SHALL BE RESPONSIBLE TO ENSURE THAT ALL MANHOLES AND COVERS ARE CLEANED OF ANY AND ALL ATTACHED MATERIALS (ASPHALT, PAINT, ETC.) AND THAT ANY VENT HOLES ARE OPEN AND CLEAR OF OBSTRUCTIONS. IF ANY OBSTRUCTIONS ARE FOUND, THE CONTRACTOR SHALL BE RESPONSIBLE TO REMOVE THEM AND TO BE PUT INTO PLACE. COSTS ASSOCIATED WITH THESE ACTIONS ARE THE RESPONSIBILITY OF THE CONTRACTOR. REFER TO PINA COUNTY REGIONAL WASTEWATER RECLAMATION DEPARTMENT STANDARD SPECIFICATIONS AND DETAILS FOR CONSTRUCTION 2012 MANUAL, DETAIL PWRD 213-218 FOR REQUIREMENTS FOR FRAME AND COVER ADJUSTMENTS.

- FORWARD STANDARD SPECIFICATIONS AND DETAIL FOR CONSTRUCTION 2012 MANUAL, SECTION 10.01. THE CONTRACTOR SHALL VERIFY THE LOCATION AND DEPTH OF ALL EXISTING PUBLIC SEWER LINES. PRECEDING ANY WORK THAT MAY AFFECT A LIVE SEWER, IT IS THE RESPONSIBILITY OF THE CONTRACTOR TO:
 - IDENTIFY AND INCLUDE ALL FLOW MANAGEMENT COSTS IN THE CONSTRUCTION BID AND PROVIDE A FLOW MANAGEMENT PLAN THIRTY (30) DAYS PRIOR TO A PRE-CONSTRUCTION MEETING. THE CONTRACTOR SHALL VERIFY THE LOCATION AND DEPTH OF ALL EXISTING PUBLIC SEWER LINES. PRECEDING ANY WORK THAT MAY AFFECT A LIVE SEWER, IT IS THE RESPONSIBILITY OF THE CONTRACTOR TO:
 - IDENTIFY AND INCLUDE ALL FLOW MANAGEMENT COSTS IN THE CONSTRUCTION BID AND PROVIDE A FLOW MANAGEMENT PLAN THIRTY (30) DAYS PRIOR TO A PRE-CONSTRUCTION MEETING. THE CONTRACTOR SHALL VERIFY THE LOCATION AND DEPTH OF ALL EXISTING PUBLIC SEWER LINES. PRECEDING ANY WORK THAT MAY AFFECT A LIVE SEWER, IT IS THE RESPONSIBILITY OF THE CONTRACTOR TO:
 - MANAGEMENT PLAN REQUIREMENTS. CALL REGIONAL WASTEWATER FIELD ENGINEERING AT 520-740-2851 REGARDING ALL QUESTIONS INVOLVING THE PREPARATION OF FLOW MANAGEMENT PLANS.
- EXISTING MANHOLES #4917-33-01, #4917-33-02, AND #4917-43 OF PLAN NO. G-66-46 ARE TO BE REMOVED. CONTRACTOR SHALL REMOVE THE FRAME AND COVER. THE SALVAGED FRAME AND COVER SHALL BE DELIVERED TO PWRD AT THE LOCATION SPECIFIED BY THE INSPECTOR. THE MANHOLES WILL BE COMPLETELY DEMOLISHED. THE CONTRACTOR SHALL REMOVE ALL MATERIALS FROM THE SITE AND SHALL DEMOLISH ALL OTHER APPROVED LOCATION.
- 460.83 LINEAR FEET OF EXISTING 12" DIP PUBLIC SEWER FROM MANHOLE #4917-33 TO MANHOLE #4917-34 AND 17.03' LINEAR FEET OF EXISTING 12" DIP PUBLIC SEWER FROM MANHOLE #4917-34 TO MANHOLE #4917-35 SHALL BE REMOVED. THE CONTRACTOR SHALL REMOVE SEWER COMPLETELY. SEWER SHALL NOT BE ABANDONED IN PLACE WITHOUT PWRD APPROVAL FROM PWRD.
- CONTRACTOR SHALL MAINTAIN ACCESS TO ALL SANITARY SEWER MANHOLE STRUCTURES AT ALL TIMES.
- ALL LANDSCAPING LOCATED WITHIN TEN (10) FEET HORIZONTALLY OF THE PUBLIC SANITARY SEWER AND MANHOLES AND/OR WITHIN THE PUBLIC SEWER EASEMENTS SHOWN HEREON SHALL BE IN ACCORDANCE WITH THE PLANTING GUIDELINES CONTAINED WITHIN PWRD ENGINEERING DESIGN STANDARDS 2012 MANUAL, SECTION 7.7 AND WITH THE SPECIAL PROVISIONS FOR THE SR 77 PROJECT.
- ALL STORM WATER POLLUTION PREVENTION PLAN (SWPPP) MEASURES SHALL BE INSTALLED SO AS TO PREVENT ALL STORM WATER, CONSTRUCTION WATER, FUELS, CHEMICALS, OR LIQUIDS TO BE DIRECTED INTO OR ONTO ANY SANITARY SEWER FACILITIES. PROTECTION OF SANITARY SEWER FACILITIES SHALL BE A PART OF THE APPROVED CONSTRUCTION SWPPP. THE CONTRACTOR SHALL MAINTAIN ACCESS TO ALL SANITARY SEWER FACILITIES THROUGHOUT THE PROJECT LIMITS. ADDITIONAL MEASURES SHALL INCLUDE BUT NOT BE LIMITED TO THE USE OF RAIN STOPPERS AND MANHOLE COVERS AS DEEMED NECESSARY BY PWRD.
- ALL PROJECT ACTIVITIES MUST BE KEPT WITHIN THE PROJECT AREAS. A CAUTION MUST BE NOTED CONCERNING HUMAN BURIALS, ANTHROPOLOGICAL CLEARANCE RECOMMENDATIONS DO NOT EXEMPT THE DEVELOPMENT FROM COMPLIANCE WITH STATE BURIAL PROTECTION LAWS. IN THE EVENT THAT HUMAN REMAINS, INCLUDING HUMAN SKELETAL REMAINS, CREMATIONS, AND/OR CEREMONIAL OBJECTS AND FUNERARY OBJECTS ARE DISCOVERED DURING THE COURSE OF THE DISCOVERY STATE LAWS ARS 41-860 AND ARS 41-844, REQUIRE THAT THE ARIZONA STATE MUSEUM BE NOTIFIED OF THE DISCOVERY AT (520) 621-4795 SO THAT CULTURAL GROUPS WHO CLAIM CULTURAL OR RELIGIOUS AFFINITY TO THEM CAN MAKE HUMAN REMAINS WILL BE REMOVED FROM THE SITE BY A PROFESSIONAL ANTHROPOLOGIST. PENDING CONSULTATION AND REVIEW BY THE ARIZONA STATE MUSEUM AND THE CONCERNED CULTURAL GROUPS.

LEGEND

EXISTING	NEW
EXISTING SEWER WITH SIZE, MATERIAL TYPE, PLAN NUMBER & FLOW DIRECTION ARROW	NEW SANITARY SEWER WITH FLOW DIRECTION ARROW
EXISTING WATER MAIN WITH SIZE, MATERIAL TYPE & PLAN NUMBER	NEW UNDERGROUND TELEPHONE
EXISTING UNDERGROUND ELECTRIC	NEW UNDERGROUND TELEPHONE
EXISTING UNDERGROUND TELEPHONE	NEW GAS
EXISTING UNDERGROUND TELEPHONE	NEW TIME WARNER FIBER OPTIC
EXISTING GAS WITH SIZE & MATERIAL TYPE	NEW UNDERGROUND COMCAST
EXISTING FIBER OPTIC	NEW UNDERGROUND AT&T
EXISTING CABLE TELEVISION	NEW SEWER MANHOLE
EXISTING RIGHT OF WAY CENTERLINE	EXISTING SEWER MANHOLE TO BE REMOVED
EXISTING PROPERTY LINE	NEW STORMDRAIN MANHOLE
EXISTING EASEMENT	NEW CATCH BASIN
EXISTING BENCHMARK	
EXISTING SEWER MANHOLE WITH MANHOLE NUMBER	
EXISTING WATER VALVE	
EXISTING SERVICE VALVE & METER BOX	
EXISTING STORMDRAIN MANHOLE	
EXISTING GUTTER	
EXISTING POWER POLE	
EXISTING ELECTRIC PULLBOX	
EXISTING CABLE BOX	
EXISTING FIBER OPTIC MANHOLE	
EXISTING TELEPHONE PEDESTAL	
EXISTING TELEPHONE MANHOLE	
EXISTING SIGN	

P.A.M.A. NUMBER	STATE	PROJECT NO.	SHEET NO.	TOTAL SHEETS	AS BUILT
9	AZ	SIP-077-A(204)1	077	081	

EXISTING UTILITIES SHOWN ON THESE PLANS ARE FROM EXISTING AS-BUILTS, UTILITY MAPS AND SURVEY INFORMATION. THE ENGINEER CANNOT GUARANTEE THE ACTUAL LOCATION OF ABOVE GROUND AND UNDERGROUND UTILITIES. THE CONTRACTOR SHALL VERIFY THE LOCATION OF ALL UTILITIES BY ANY MEANS AVAILABLE PRIOR TO CONSTRUCTION AND SHALL BE RESPONSIBLE FOR THE LOCATION OF ALL UTILITIES. THE RESPONSIBILITY OF THE CONTRACTOR.

GENERAL NOTES AND LEGEND **SS02 OF SS06**

ARIZONA DEPARTMENT OF TRANSPORTATION
INTERMODAL TRANSPORTATION DIVISION
ROADSIDE DESIGN SECTION

SR 77

URS

DATE: 11/13/13
SCALE: AS SHOWN

DESIGNED BY: M. ADRIANO
CHECKED BY: M. ADRIANO

PROJECT: SR 77
LOCATION: TANGIERNE ROAD TO PINA COUNTY LINE

DESIGNED BY: IRACS NO. H6694-01C
DATE: SIP-077-A(204)1

REV: DATE DESCRIPTION

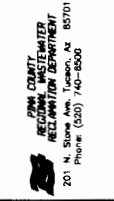
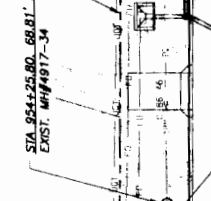

EXHIBIT "B"

PROJECT NO.	DATE	BY
STP-077-A(204)	077 PM 081	

STATE	COUNTY	TOWNSHIP	RANGE	SECTION
9				

AS BUILT	TOTAL SHEETS



KEYNOTES

- EXISTING MANHOLE AND BASE TO BE REMOVED. CONTRACTOR SHALL SALVAGE THE FRAME AND COVER. ALL SALVAGED ITEMS SHALL BE RETURNED TO FCRWHD CONVEYANCE DIVISION VIA FCRWHD INSPECTOR. THE MANHOLE RISER, TOP SLAB AND BASE SHALL BE PROPERLY RECORDED, COMPLETELY REMOVED AND DISPOSED OF PROPERLY.
- DISPATCH 4" DIA. MANHOLE TO FINAL GRADE PER R204 AND STD. 011 R204. 201" R204, R206, R208, R210, AND R214. INSTALL 24" WATER TIGHT FRAME AND COVER PER R204. (ORIENTATE CONE AND STEPS TOWARD NEW BACK OF CURB).

NOTE:
THE CONTRACTOR SHALL BECOME FAMILIAR WITH THE SITE CONDITIONS BEFORE BEGINNING WORK. THE CONTRACTOR SHALL BE RESPONSIBLE FOR OBTAINING ALL NECESSARY PERMITS AND SHALL BE RESPONSIBLE FOR OBTAINING ALL NECESSARY INFORMATION FROM THE DESIGNER. THE CONTRACTOR SHALL BE RESPONSIBLE FOR OBTAINING ALL NECESSARY INFORMATION FROM THE DESIGNER. THE CONTRACTOR SHALL BE RESPONSIBLE FOR OBTAINING ALL NECESSARY INFORMATION FROM THE DESIGNER.

EXISTING UTILITIES SHOWN ON THESE PLANS ARE FROM EXISTING RECORDS AND FIELD SURVEY. THE CONTRACTOR SHALL VERIFY THE LOCATION AND DEPTH OF ALL UTILITIES BEFORE CONSTRUCTION. THE CONTRACTOR SHALL BE RESPONSIBLE FOR OBTAINING ALL NECESSARY INFORMATION FROM THE DESIGNER. THE CONTRACTOR SHALL BE RESPONSIBLE FOR OBTAINING ALL NECESSARY INFORMATION FROM THE DESIGNER.

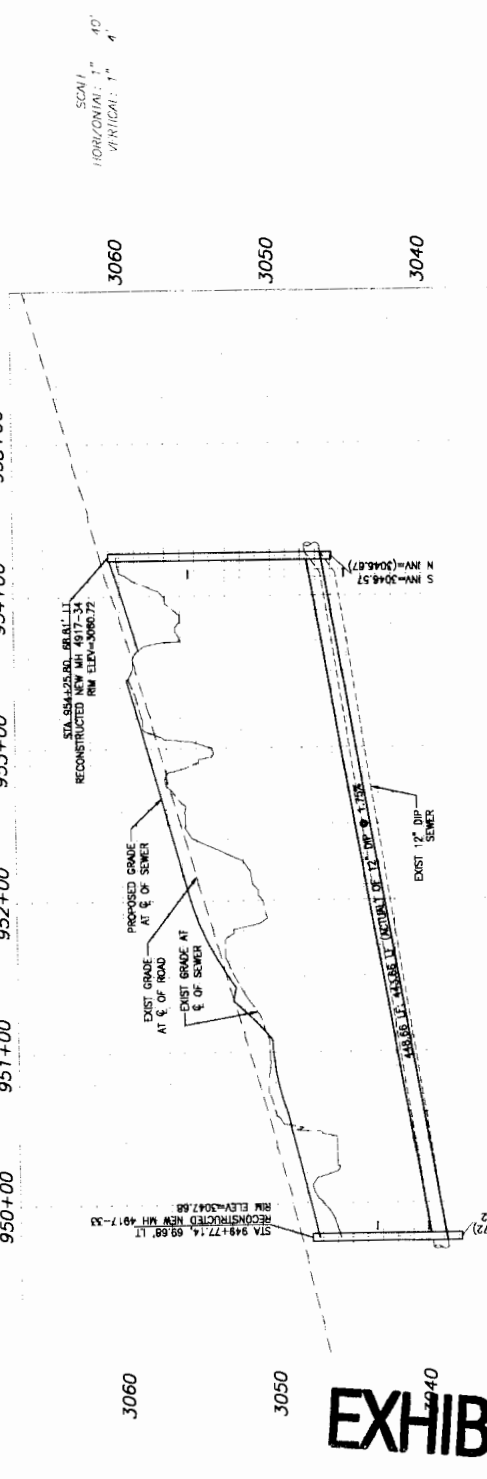
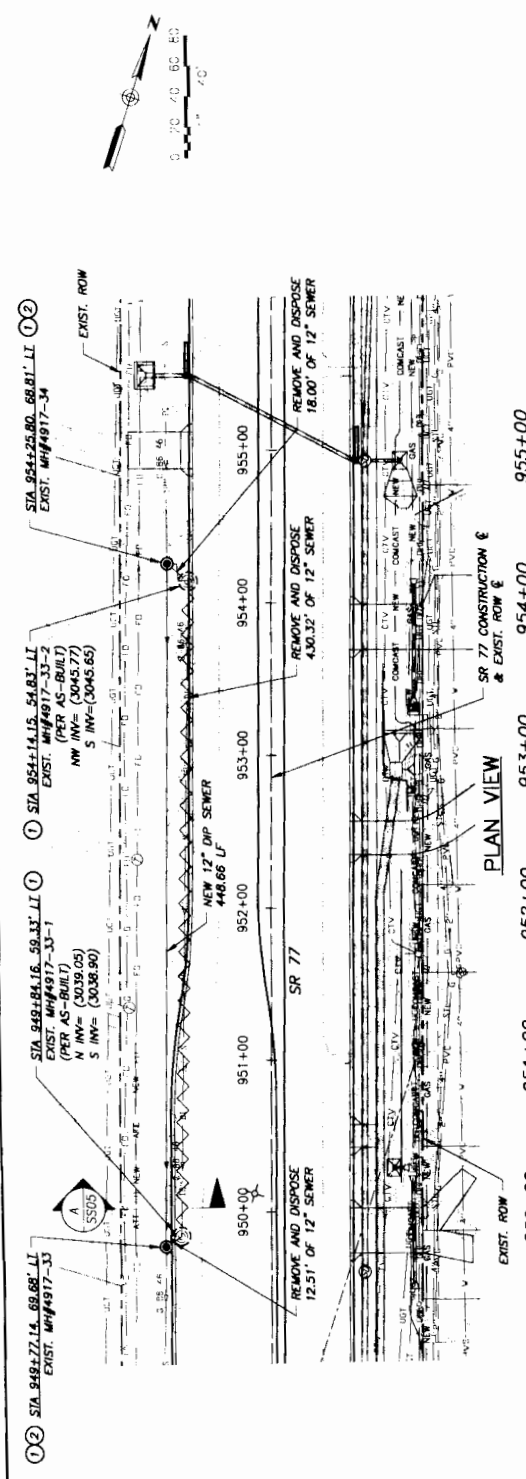

PLAN & PROFILE VIEW
SS03 OF SS05
 ARIZONA DEPARTMENT OF TRANSPORTATION
 INTERMODAL TRANSPORTATION DIVISION
 ROADSIDE DESIGN SECTION
 SR 77
 SANITARY SEWER PLANS
 TANGERINE ROAD TO PINAL COUNTY LINE
 STP-077-A(204)

URS
 CONSULTING ENGINEERS
 201 N. Stone Ave. Tempe, AZ 85281
 Phone: (480) 740-0800

DATE	BY	DESCRIPTION

STATE AZ	PROJECT NO. SIP-077-A(204)	SHEET NO. 077 PM 08T	TOTAL SHEETS 1	AS BUILT
9				

KEYNOTES

- EXISTING MANHOLE AND BASE TO BE REMOVED. CONTRACTOR SHALL SALVAGE THE FRAME AND COVER ALL SALVAGED ITEMS SHALL BE RETURNED TO PAVING CONVEYANCE DIVISION VIA PAVING INSPECTOR. THE MANHOLE RISER, TOP SLAB AND PAVING SURFACE SHALL BE COMPLETED REMOVED AND DISPOSED OF PROPERLY.
- RECONSTRUCT 57 DIA MANHOLE TO FINAL GRADE PER FORMWD STD DET. RWRD 2012. RWRD 2006. RWRD 2008. RWRD 212 AND INSTALL 24" FRAME AND COVER PER RWRD 212.
- FOR MANHOLE LOCATION AND ELEVATION INFORMATION SEE MANHOLE SCHEDULE IN UTILITY RELOCATION PLANS SHEET U-1.25.
- EXISTING MANHOLE TO BE REMOVED. CONTRACTOR SHALL SALVAGE THE FRAME AND COVER. ALL SALVAGED ITEMS SHALL BE RETURNED TO PAVING CONVEYANCE DIVISION VIA PAVING INSPECTOR. THE MANHOLE RISER AND TOP SLAB WILL BE DEMOLISHED, COMPLETELY REMOVED AND DISPOSED OF PROPERLY. MANHOLE BASE SHALL REMAIN SEE DETAIL 1, SHEET SS05.
- NEW MANHOLE SHALL BE COATED WITH INTERIOR CORROSION RESISTANT FINISH PER SECTION J3.13 (B) (WH) OF FORMWD'S STANDARD SPECIFICATIONS AND DETAILS FOR CONSTRUCTION 2012 EDITION.

EXISTING UTILITIES SHOWN ON THESE PLANS ARE FROM EXISTING RECORD DRAWINGS AND FIELD SURVEY DATA. CONTRACTOR CANNOT GUARANTEE THE ACTUAL LOCATION OF ABOVE GROUND AND BELOW GROUND STRUCTURES AND UTILITIES. IT IS THE CONTRACTOR'S RESPONSIBILITY TO VERIFY THE LOCATION OF ALL ABOVE GROUND UTILITIES BY ANY MEANS AVAILABLE PRIOR TO CONSTRUCTION. ANY DAMAGE TO STRUCTURES OR UTILITIES DURING CONSTRUCTION WILL BE THE RESPONSIBILITY OF THE CONTRACTOR.

**MAINSAIL BLVD
PLAN & PROFILE DETAIL SS04 OF SS05**

ARIZONA DEPARTMENT OF TRANSPORTATION
INTERMODAL TRANSPORTATION DIVISION
ROADSIDE DESIGN SECTION

	<table border="0"> <tr> <td>DATE</td> <td>8/13</td> </tr> <tr> <td>DESIGN</td> <td>8/13</td> </tr> <tr> <td>DRAWN</td> <td>8/13</td> </tr> <tr> <td>CHECKED</td> <td>8/13</td> </tr> </table>	DATE	8/13	DESIGN	8/13	DRAWN	8/13	CHECKED	8/13	
	DATE	8/13								
	DESIGN	8/13								
DRAWN	8/13									
CHECKED	8/13									
<table border="0"> <tr> <td>PROJECT NO.</td> <td>SR 77</td> </tr> <tr> <td>LOCATION</td> <td>TANGERINE ROAD TO PINAL COUNTY LINE</td> </tr> </table>	PROJECT NO.	SR 77	LOCATION	TANGERINE ROAD TO PINAL COUNTY LINE						
PROJECT NO.	SR 77									
LOCATION	TANGERINE ROAD TO PINAL COUNTY LINE									
<table border="0"> <tr> <td>REV.</td> <td>DATE</td> <td>DESCRIPTION</td> <td>BY</td> <td>TRACS NO.</td> </tr> <tr> <td> </td> <td> </td> <td> </td> <td> </td> <td> </td> </tr> </table>	REV.	DATE	DESCRIPTION	BY	TRACS NO.					
REV.	DATE	DESCRIPTION	BY	TRACS NO.						

**PINAL COUNTY
RECLAMATION DEPARTMENT**
201 N. Stone Ave., Tucson, AZ 85701
Phone: (520) 746-5500

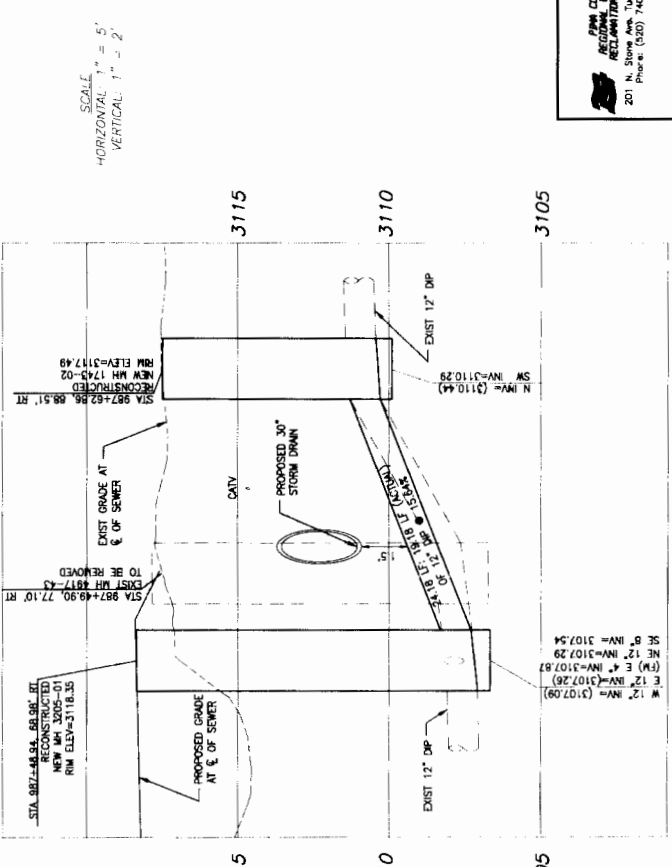
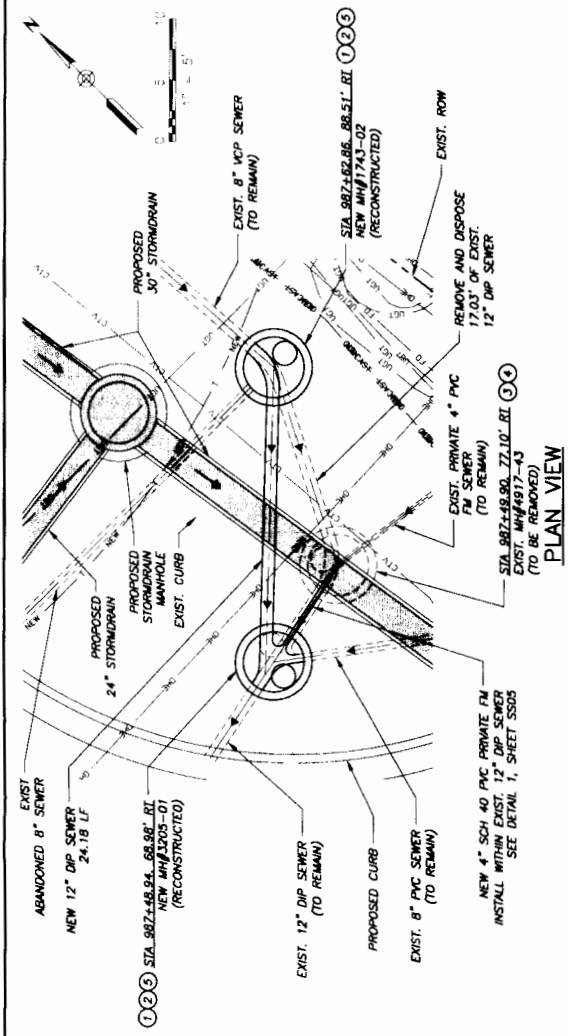
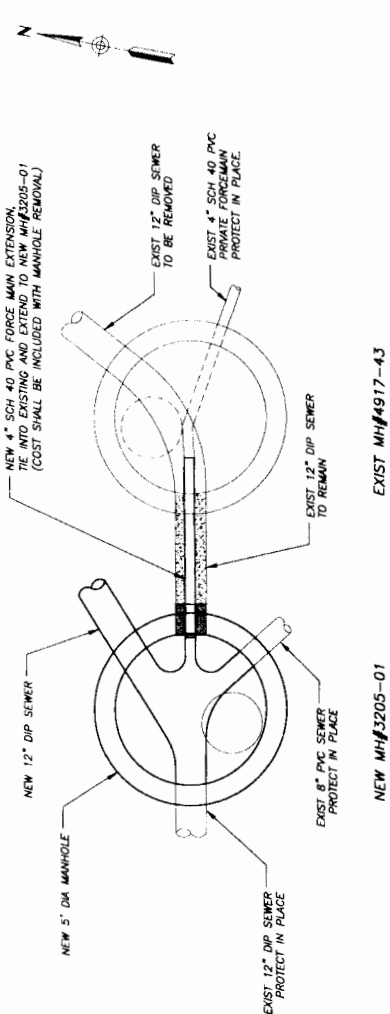

EXHIBIT "B"

**ARIZONA
PINAL BLVD RECLAMATION DEPARTMENT**

FEDERAL REGION	STATE	PROJECT NO.	SHEET NO.	TOTAL SHEETS	AS BUILT
9	AZ	SIP-07-A(204)	077	081	



PLAN
N.T.S.

NOTE:
SEE SHEET SS04 FOR PLAN AND PROFILE INFORMATION.

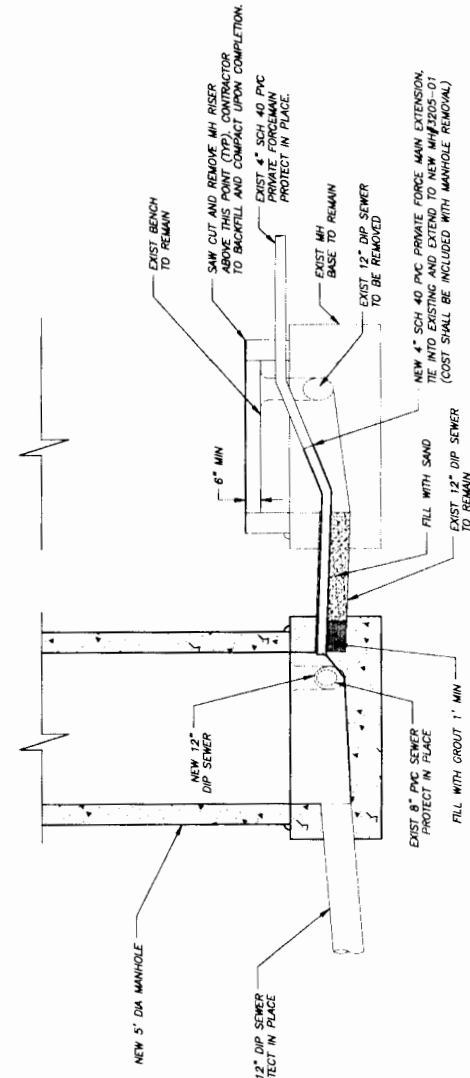

SECTION
N.T.S.

1 MH REMOVAL & FORCE MAIN EXTENSION DETAIL

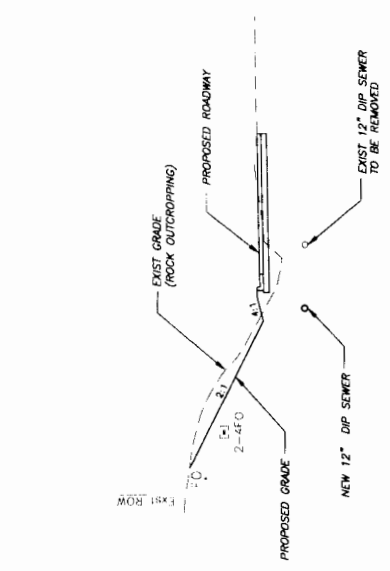

(A) TYPICAL SECTION
N.T.S. (SEE SS03)

DATE		DETAIL SHEET		SS05 OF SS05	
NAME	DATE	DATE	DATE	DATE	DATE
BY	BY	BY	BY	BY	BY
DESIGN	DESIGN	DESIGN	DESIGN	DESIGN	DESIGN
CHECK	CHECK	CHECK	CHECK	CHECK	CHECK
APPROVE	APPROVE	APPROVE	APPROVE	APPROVE	APPROVE
PROJECT NO.	PROJECT NO.	PROJECT NO.	PROJECT NO.	PROJECT NO.	PROJECT NO.
SIP-07-A(204)	SIP-07-A(204)	SIP-07-A(204)	SIP-07-A(204)	SIP-07-A(204)	SIP-07-A(204)
LOCATION		LOCATION		LOCATION	
TANGERINE ROAD TO PINAL COUNTY LINE		TANGERINE ROAD TO PINAL COUNTY LINE		TANGERINE ROAD TO PINAL COUNTY LINE	
TRACS NO. H6694-01C		TRACS NO. H6694-01C		TRACS NO. H6694-01C	
DESCRIPTION		DESCRIPTION		DESCRIPTION	
SANITARY SEWER PLANS		SANITARY SEWER PLANS		SANITARY SEWER PLANS	
SR 77		SR 77		SR 77	
ARIZONA DEPARTMENT OF TRANSPORTATION		ARIZONA DEPARTMENT OF TRANSPORTATION		ARIZONA DEPARTMENT OF TRANSPORTATION	
INTERNAL TRANSPORTATION DIVISION		INTERNAL TRANSPORTATION DIVISION		INTERNAL TRANSPORTATION DIVISION	
ROADSIDE DESIGN SECTION		ROADSIDE DESIGN SECTION		ROADSIDE DESIGN SECTION	
URS		URS		URS	
201 N. State Ave., Tucson, AZ 85701		201 N. State Ave., Tucson, AZ 85701		201 N. State Ave., Tucson, AZ 85701	
Phone: (520) 740-6000		Phone: (520) 740-6000		Phone: (520) 740-6000	



EXHIBIT "B"

STATE	PROJECT NO.	SHEET NO.	TOTAL SHEETS
9	STP-077-AC2041	290	611
077 PN 081			



970

965

960

50. If Cut Ditch
Detail D1, V Ditch
Sta 967+47.60, 82.75' LI
Elev 3088.00 to
Sta 967+57.34, 86.42' LI
Elev 3089.00
Remove
Elev 6' x 47' PVC Pipe
Remove 19' LI
EAST R/W

East 2'-35" x 24" x 50' ACMP
4 End Sections
Remove
180. If Cut Ditch
Detail D1, V Ditch
Sta 964+60, 85.71' LI
Elev 3080.00 to
Sta 965+50, 83.71' LI
Elev 3084.60

188. If Cut Ditch
Detail D1, Trapezoidal Ditch
Sta 960+28, 89.71' LI
Sta 962+16, 88.70' LI
Elev 3075.10
Riprap Outlet Protection
Detail D1
East 36" CMP x 48"
2 CB 4, 4 End Sections
Remove

East 2'-45" x 33" 112' ACMP
Elev 2'-35" x 24" x 60' ACMP
4 End Sections
Remove

East 18" x 70' CMP
2 End Sections
Remove
East 28" x 20' x 69' ACMP
2 End Sections
Remove

East 18" x 36'
2 End Sections
Remove
East 18" x 36'
CMP
2 End Sections
Remove

East 28" x 20' x 58' ACMP
2 End Sections
Remove

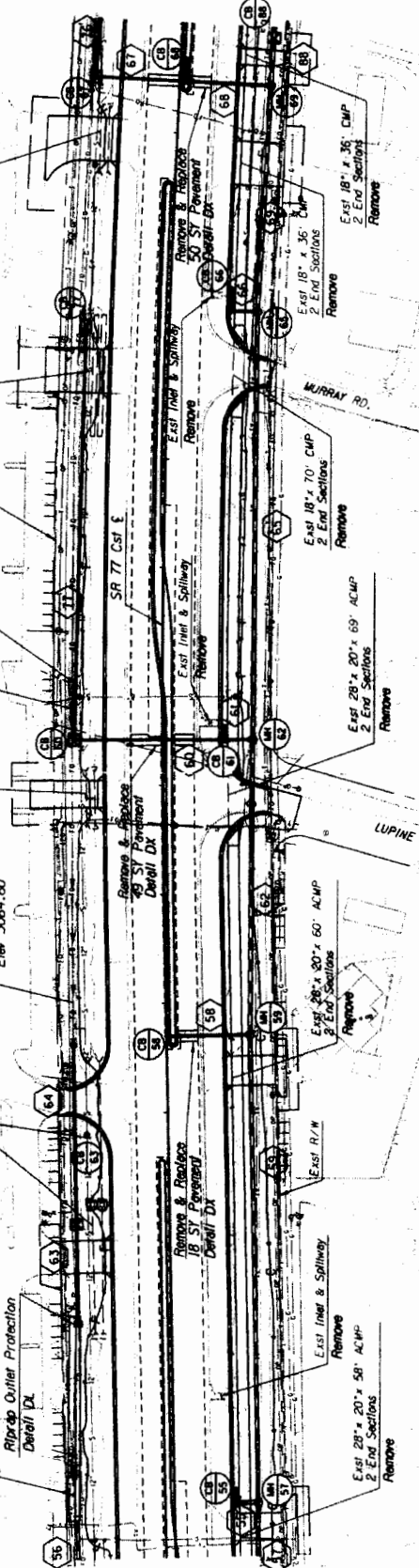

- Storm Drain to be
Paid for by PERWRD

DATE	BY	APP	CHECKED	SCALE	PROJECT NO.	SHEET NO.	TOTAL SHEETS
04/13					STP-077-AC2041	290	611
ARIZONA DEPARTMENT OF TRANSPORTATION ARIZONA HIGHWAY DEPARTMENT ROADWAY DESIGN SERVICES							
DRAINAGE PLAN SHEET STA 960+00 TO STA 974+00							
PROJECT LOCATION SR 77 TANGIERNE ROAD TO PINAL COUNTY LINE TRACS NO. H6694 DIC							
DRAWN BY CHECKED BY DATE							
PROJECT NO. SHEET NO. OF							

EXHIBIT "B"

PROJECT NO.	STATE	PROJECT NAME	SHEET NO.	TOTAL SHEETS	DATE
9	9	STP-07-A0001T	292	671	077 PM 081



0001

566

066

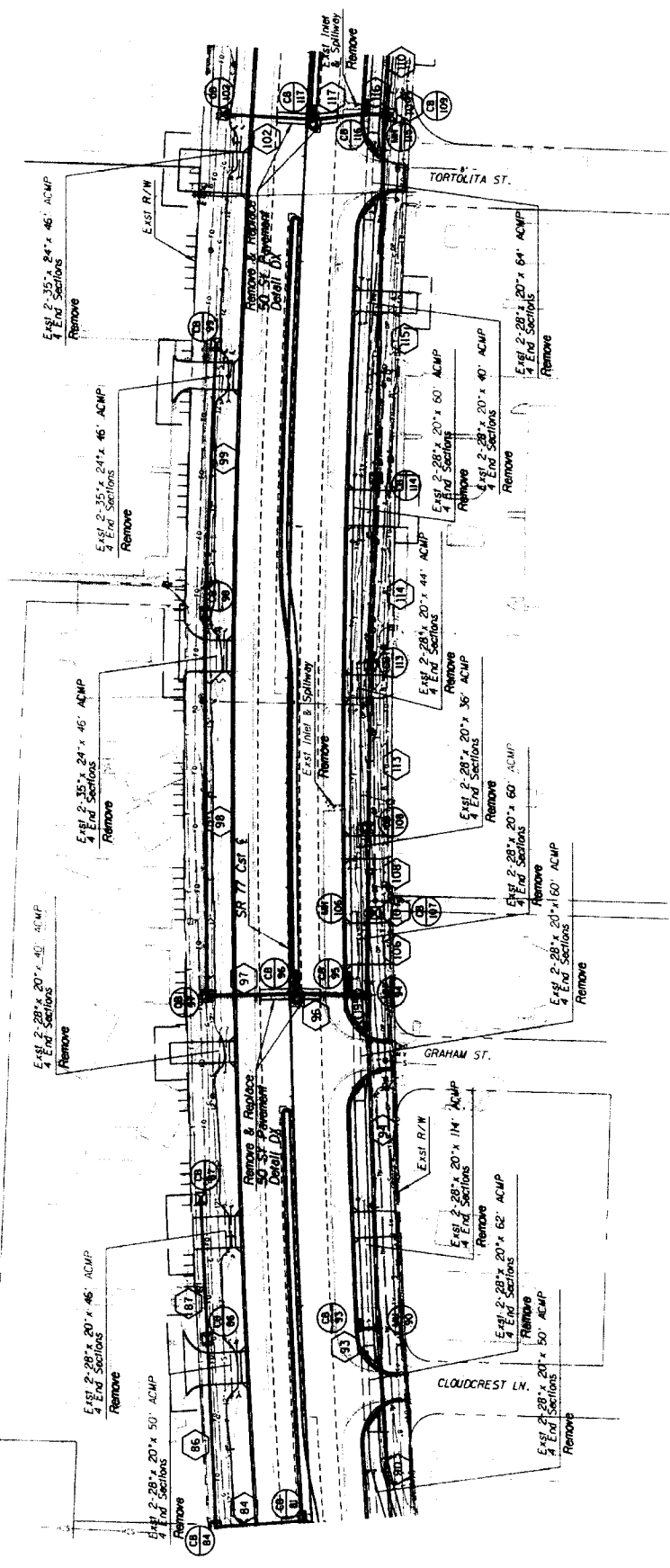

NAME	ARIZONA DEPARTMENT OF TRANSPORTATION
ADDRESS	INTERMODAL TRANSPORTATION DIVISION
CITY	ROADWAY DESIGN SERVICES
STATE	PHOENIX, ARIZONA
PROJECT NO.	STP-07-A0001T
SHEET NO.	292
TOTAL SHEETS	671
DATE	077 PM 081

DATE	10/13/13
BY	10/13/13
CHKD	10/13/13
DATE	10/13/13

DRAINAGE PLAN SHEET
 STA 983+00 TO STA 1002+00

SR 77 TANGERINE ROAD TO PINAL COUNTY LINE
 TRACS NO. H6594 OIC
 STP-07-A(204)1

EXHIBIT "B"

STATE	PROJECT NO.	SHEET	NO. OF SHEETS
9	STP-077-A204MT 294	671	671
DATE		017 PM 081	



1030

1025

1020

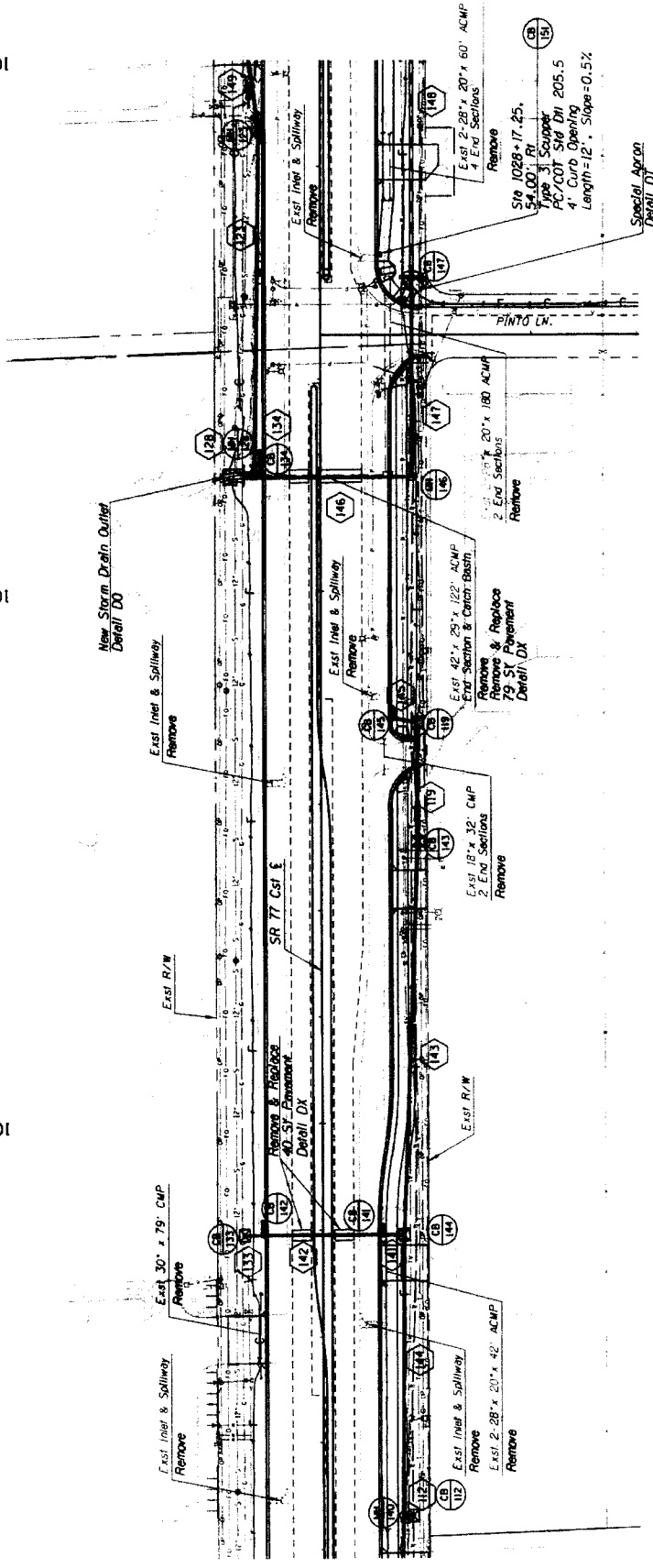

DATE	BY	APP'D	PROJECT
04/13	04/13	04/13	STP-077-A204MT
ARIZONA DEPARTMENT OF TRANSPORTATION INTERNAL TRANSPORTATION DIVISION ROADWAY DESIGN SERVICES			
DRAINAGE PLAN SHEET			
S18 1016+00 TO S16 1030+00			
SR 77 TANGERINE ROAD TO PINAL COUNTY LINE			
TRACS NO. H6694 DIC			
SHEET NO. 671 OF 671			

EXHIBIT "B"

PLAN NO.	DATE	PROJECT NO.	SHEET NO.	TOTAL SHEETS	BY
9		SIP-077-102011	295	671	
					077 PM 081

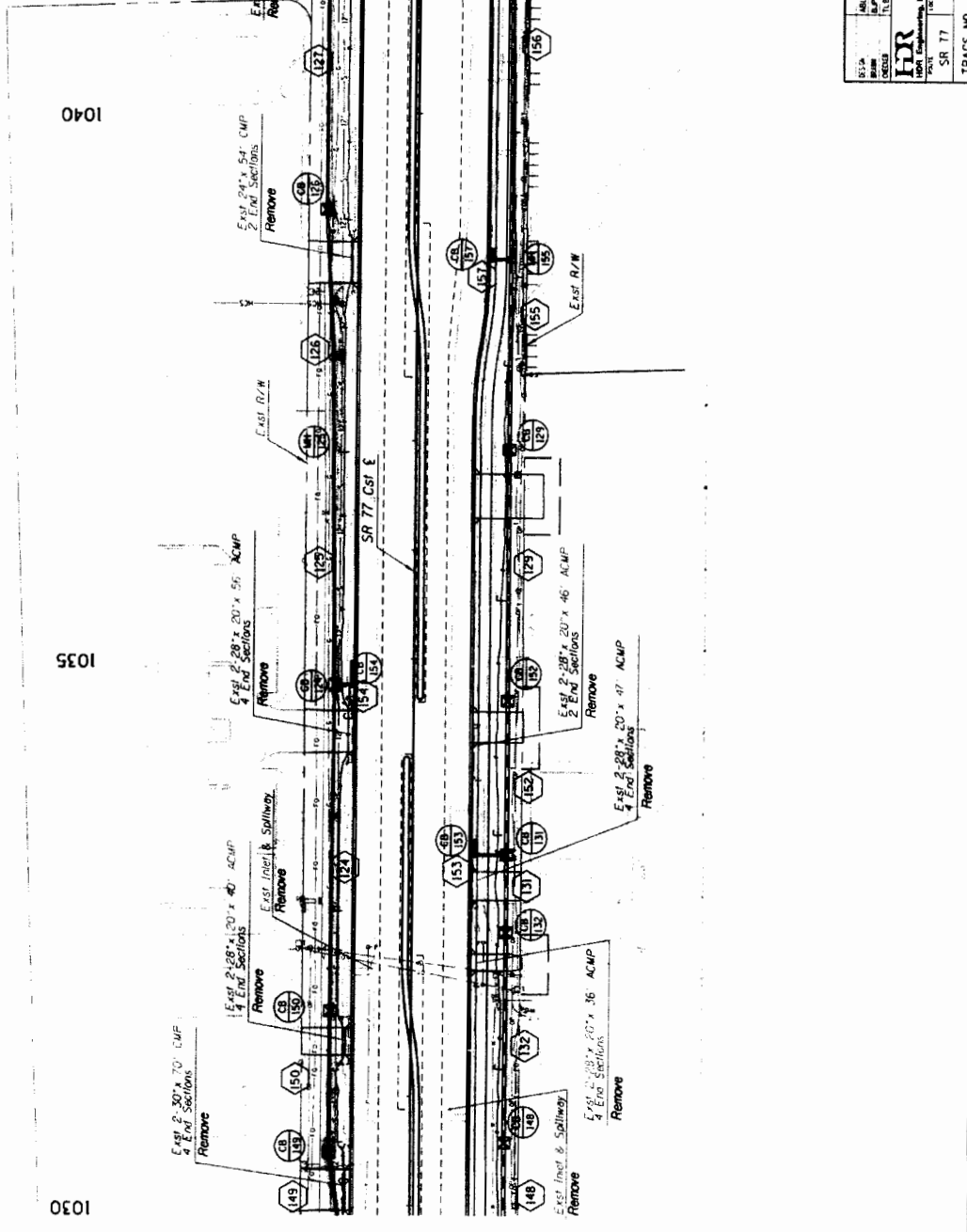

DESIGNER	DATE	SCALE	PROJECT NO.	SHEET NO.	TOTAL SHEETS	BY
IBR	04/13		SIP-077-102011	295	671	
CHECKER	DATE	SCALE	PROJECT NO.	SHEET NO.	TOTAL SHEETS	BY
	04/13		SIP-077-102011	295	671	
ARIZONA DEPARTMENT OF TRANSPORTATION TRANSPORTATION PROGRAM ROADWAY DESIGN SERVICES						
DRAINAGE PLAN SHEET Sta 1030+00 To Sta 1044+00						
FILE NO. SR 77 TANGIERNE ROAD TO PINAL COUNTY LINE TRACS NO. M6694 01C STP-077-102011 OF						

EXHIBIT "B"

9	STP-071-A20-D11 953 611
	OTT PM 081

NOTES:

1. Wall Stationing is to the Front Face of Wall. SD Sid 7.01 Case 1-Level Fill. See Wall Height (H).
2. Control Joint Spacing is 30' Max.
3. Handrail not Shown in Elevation for Clarity.
4. Refer to Architectural Treatment Sheets For Wall Asphalt Treatment.
5. Refer to the Project Layout and Summary Sheets For Wildlife Fence, Wildlife Fence Gates, R/W Fence and Gates.
6. Portion of Retaining Wall Footing is below the Wing Wall Footing. Construction Should be Sequenced Accordingly.

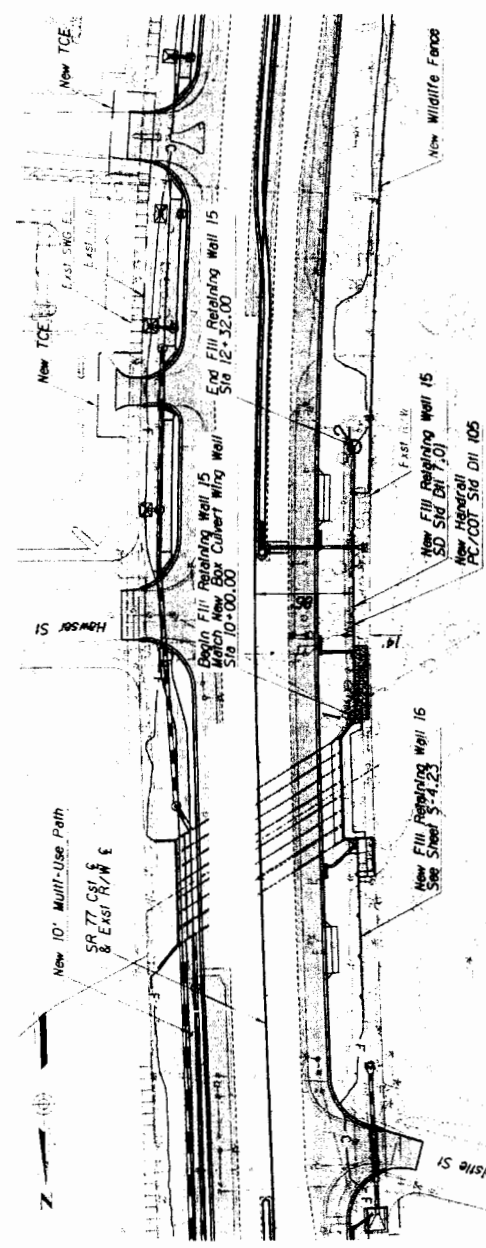

940

FILL RETAINING WALL 15		
POINT	NORTHING	EASTING STATION AND OFFSET
1	541497.14	1006597.66 943+62.23, 86.00' LT
2	541273.48	1006650.80 941+26.93, 86.00' LT

945

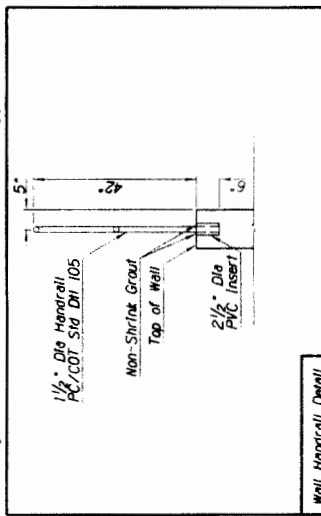

Wall Handrail Detail NTS

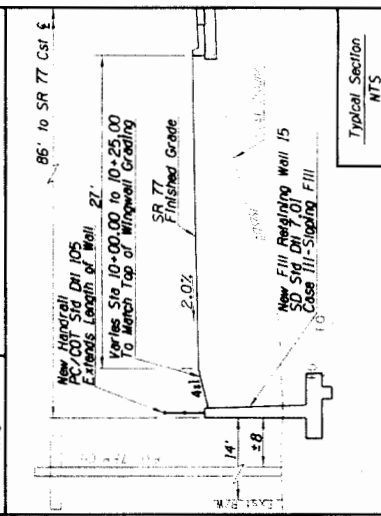

Typical Section NTS

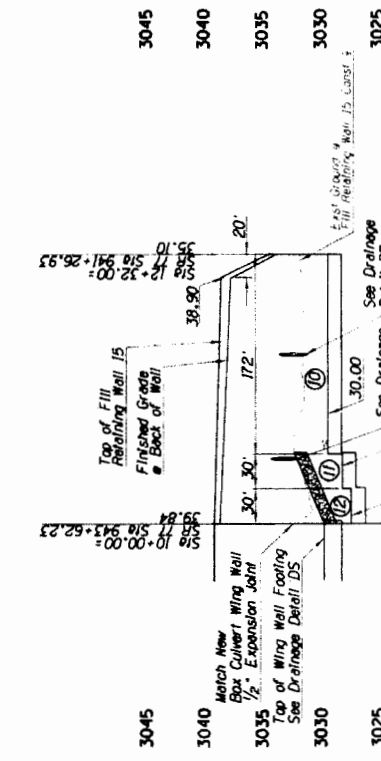

FILL RETAINING WALL 15 - ELEVATION VIEW
Total Length = 232 LF

10+00	11+00	12+00
-------	-------	-------

URS

ARIZONA DEPARTMENT OF TRANSPORTATION
REGIONAL TRANSPORTATION DIVISION
ROADWAY DESIGN SERVICES

WALL 15 PLAN & PROFILE
Sta 10+00 to 12+32

SR 77 TANGERINE ROAD TO PINAL COUNTY LINE
TRACS NO. H6694 01C STP-071-A20-D11

Express Interchange OF

9
STP-07T-A1204IT 154 51
077 PM DBI

NOTES:

1. Wall Stationing is to the Front Face of Wall. SD Sid 7.01 Case III - Sloping Fill. See Wall Height (H)
2. Control Joint Spacing is 30' Max.
3. Handrail not Shown in Elevation for Clarity.
4. Refer to Architectural Treatment Sheets for Wall Aesthetic Treatment.
5. Portion of Retaining Wall Footing is below the Wing Wall Footing. Construction Should be Sequenced Accordingly.

New TCE

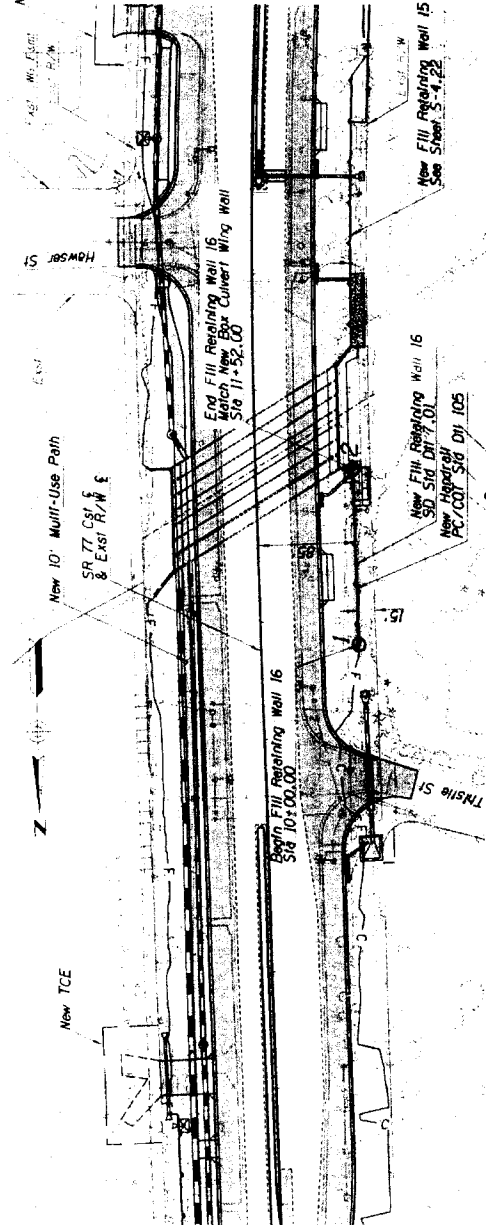

FILL RETAINING WALL 16		
POINT	NORTHING	EASTING STATION AND OFFSET
1	54744.50	1006522.91 946+22.01, 85.00' LI
2	541599.32	1006567.95 944+69.61, 85.00' LI

950

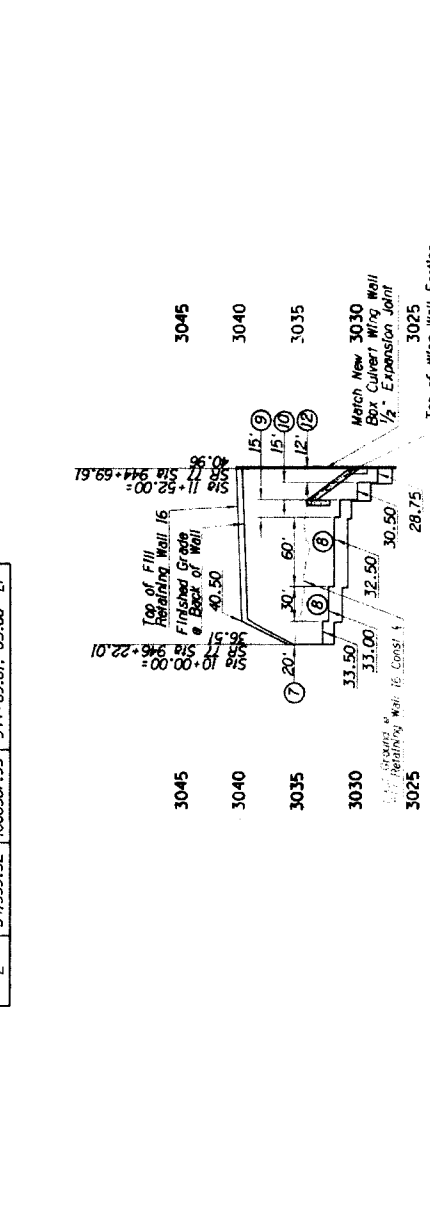
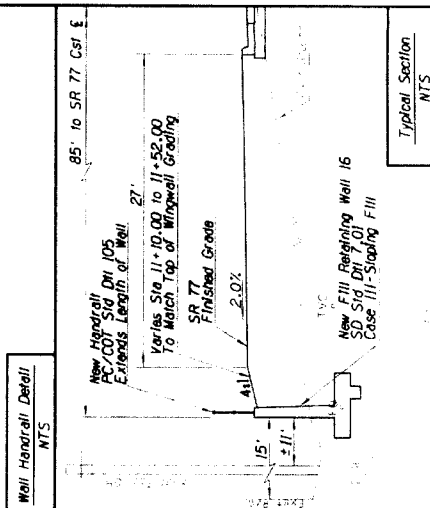

URS
ARIZONA DEPARTMENT OF TRANSPORTATION
REGIONAL TRANSPORTATION DIVISION
ROADWAY DESIGN SERVICES
WALL 16 PLAN & PROFILE
Sta 10+00 TO 11+92
SR 77 TANGERINE ROAD TO PINAL COUNTY LINE
TRACS NO. H6694 01C
STP-07T-A1204IT 01

EXHIBIT "B"