

## BOARD OF SUPERVISORS AGENDA ITEM REPORT

Requested Board Meeting Date: March 15, 2016

**Title:** North Rillito Interceptor Project

### **Introduction/Background:**

The Pima County Regional Wastewater Reclamation Department plans to construct and maintain certain sewer improvements for the North Rillito Interceptor Project (the "Project") and requires certain interests in real property for the Project

### **Discussion:**

This Resolution will authorize the County Attorney to acquire property under the County's eminent domain authority where necessary for the construction and maintenance of the North Rillito Sewer Interceptor.

### **Conclusion:**

Acquisition of property for relocation of sewer facilities will be obtained by condemnation if needed.

### **Recommendation:**

It is recommended that the Board of Supervisors approve the Resolution to condemn real property interests for the construction and maintenance of the North Rillito Sewer Interceptor.

### **Fiscal Impact:**

Undetermined

### **Board of Supervisor District:**

☒ 1      ☐ 2      ☐ 3      ☐ 4      ☐ 5      ☐ All

Department: Real Property      Telephone: 520-724-6313

Department Director Signature/Date: [Signature] 3-8-16

Deputy County Administrator Signature/Date: [Signature] 3/8/16

County Administrator Signature/Date: [Signature] 3/8/16

1997-01-01 15:00:00

**RESOLUTION NO. 2016- \_\_\_\_\_**

**RESOLUTION OF THE PIMA COUNTY BOARD OF SUPERVISORS  
AUTHORIZING THE PIMA COUNTY ATTORNEY TO CONDEMN  
REAL PROPERTY INTERESTS WHERE NECESSARY FOR THE  
NORTH RILLITO INTERCEPTOR IN SECTION 25 OF TOWNSHIP  
13 SOUTH, RANGE 14 EAST AND SECTION 32 OF TOWNSHIP 13  
SOUTH, RANGE 15 EAST, G&SRM**

**The Board of Supervisors of Pima County, Arizona finds:**

1. Pima County plans to construct and maintain certain sewer improvements for the North Rillito Interceptor Project (the "Project") located in Section 25 of Township 13 South, Range 14 East and Section 32 of Township 13 South, Range 15 East, G&SRM, for the use and benefit of the public;
2. On September 1, 2015, the Board of Supervisors of Pima County enacted Resolution No. 2015-65, authorizing the Pima County Attorney to exercise its authority of eminent domain to acquire real property interests for the Project;
3. Two parcels from which property interests are necessary to the Project were erroneously excluded from the parcels depicted in Exhibit A attached to Resolution 2015-65;
4. The attached **Exhibit A** corrects the error by depicting all the parcels originally depicted in Exhibit A to Resolution 2015-65, as well as the two additional parcels; and
5. It is necessary to exercise Pima County's powers of eminent domain, pursuant to A.R.S. § 12-1111, to acquire interests in the real property depicted in attached **Exhibit A** in order to construct the Project;

**NOW, THEREFORE, BE IT RESOLVED** that the Pima County Attorney be and is hereby authorized and directed to institute condemnation proceedings to acquire real property interests for the above described Project, from the real property shown on the attached **Exhibit A**.

**BE IT FURTHER RESOLVED** that this Resolution repeals and replaces Resolution 2015-65.

Board of Supervisors Approval:		S <u>25</u> /T <u>13S</u> /R <u>14E</u> S <u>32</u> /T <u>13S</u> / R <u>15E</u>	
Agent: gf	File #:11,341 & 11,342	Project Code #: 3NRI14	P [ ] De [ ] Do [ ] E [ ]

Passed and adopted, this this \_\_\_\_ day of \_\_\_\_\_, 2016.

\_\_\_\_\_  
Chair, Pima County Board of Supervisors

ATTEST:

APPROVED AS TO FORM:

\_\_\_\_\_  
Clerk of the Board of Supervisors

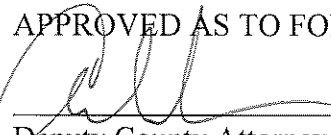
  
\_\_\_\_\_  
Deputy County Attorney

**ANDREW FLAGG**

Board of Supervisors Approval:		S <u>25</u> /T <u>13</u> S/R <u>14</u> E    S <u>32</u> /T <u>13</u> S/ R <u>15</u> E	
Agent: gf	File #:11,341 & 11,342	Project Code #: 3NRI14	P <input type="checkbox"/> De <input type="checkbox"/> Do <input type="checkbox"/> E <input type="checkbox"/>

# EXHIBIT A

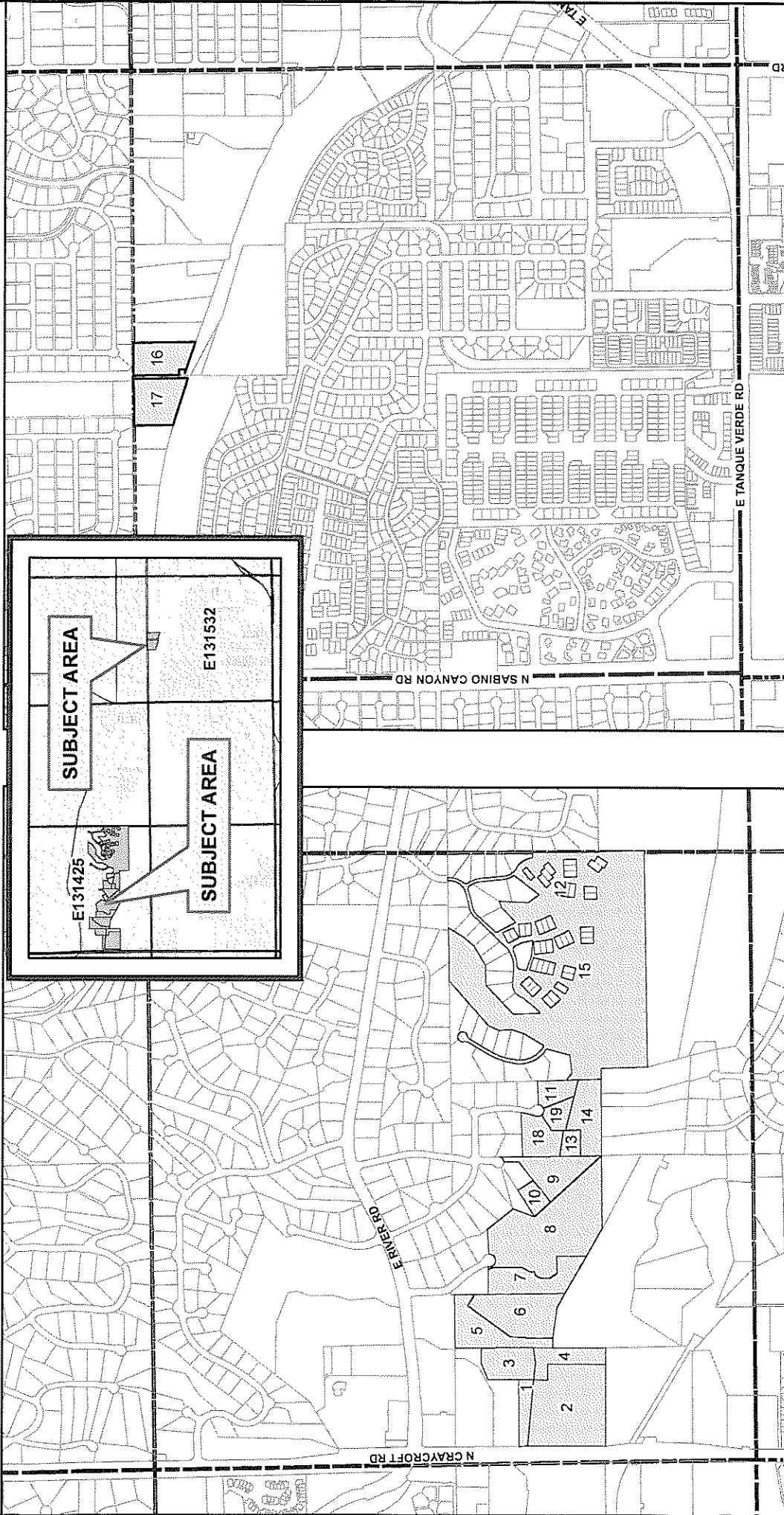

TOWNSHIP 13 SOUTH  
RANGE 15 EAST  
SECTION 32 G&SRM  
PIMA COUNTY, ARIZONA

TOWNSHIP 13 SOUTH  
RANGE 14 EAST  
SECTION 25 G&SRM  
PIMA COUNTY, ARIZONA

## Legend

- Parcel Region
- Township Border
- <all other values>
- 1. 109-22-005L
- 2. 109-22-005K
- 3. 109-22-005G
- 4. 109-22-005F
- 5. 109-22-006B
- 6. 109-22-006A
- 7. 109-22-008D
- 8. 109-22-008C
- 9. 109-22-1920
- 10. 109-22-191B
- 11. 109-22-1990
- 12. 109-22-2200
- 13. 109-22-011E
- 14. 109-22-011F
- 15. 109-22-2800
- 16. 114-46-008P
- 17. 114-46-010H
- 18. 109-22-011D
- 19. 109-22-2000

**PIMA COUNTY**  
**DEPARTMENT OF TRANSPORTATION**  
**ENGINEERING INFORMATION MANAGEMENT**

DRAWN BY: RFREER

DATE: 3/7/2016

DRAWING NOT TO SCALE

15025