

# Pima County Clerk of the Board

Robin Brigode

Julie Castañeda  
Deputy Clerk

Administration Division  
130 W. Congress, 5<sup>th</sup> Floor  
Tucson, AZ 85701  
Phone: (520)724-8449 • Fax: (520)222-0448

Document and Micrographics Mgt. Division  
1640 East Benson Highway  
Tucson, Arizona 85714  
Phone: (520) 351-8454 • Fax: (520) 791-6666

November 2, 2016

Jeremy Julian Pye  
Copper Mine Brewing Company, L.L.C.  
3455 S. Palo Verde Road, Suite 135  
Tucson, AZ 85713

RE: Arizona Liquor License No.: 03103030  
d.b.a. Copper Mine Brewing Company, L.L.C.

Dear Mr Pye:

Enclosed is a copy of the Affidavit of Posting relative to your Liquor License Application for a Series 3, In-State Microbrewery, which was received in our office on October 12, 2016. The Hearing before the Pima County Board of Supervisors has been scheduled for Tuesday, November 22, 2016, at 9:00 a.m. or thereafter, at the following location:

Pima County Administration Building  
Board of Supervisors Hearing Room  
130 W. Congress, 1st Floor  
Tucson, AZ 85701

Should you have any questions pertaining to this matter, please contact this office at (520)724-8449.

Sincerely,

A handwritten signature in cursive script that reads "Robin Brigode".

Robin Brigode  
Clerk of the Board

Enclosure



Arizona Department of Liquor Licenses and Control  
 800 W Washington 5th Floor  
 Phoenix, AZ 85007-2934  
 www.azliquor.gov  
 (602) 542-5141

NEW 07/16 AND 01/18 PC CLK OF BD #R

**AFFIDAVIT OF POSTING**

Date of Posting: 10/13/16 Date of Posting Removal: 11/1/16

**Copper Mine Brewing Company,  
L.L.C.**

Applicant's Name: Pye Jeremy Julian  
Last First Middle

Business Address: 3455 S. Palo Verde Road, Suite 135 Tucson 85713  
Street City Zip

License #: 03103030

I hereby certify that pursuant to A.R.S. 4-201, I posted notice in a conspicuous place on the premises proposed to be licensed by the above applicant and said notice was posted for at least twenty (20) days.

M. Powell Process Server 351.6000  
Print Name of City/County Official Title Phone Number

M. Powell 11/1/16  
Signature Date Signed

Return this affidavit with your recommendations (i.e., Minutes of Meeting, Verbatim, etc.) or any other related documents. If you have any questions please call (602) 542-5141 and ask for the Licensing Division.

11/1/16

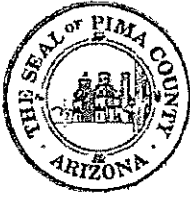

Pima County Clerk of the Board
Robin Brigode

Julie Castañeda
Deputy Clerk

Administration Division
130 W. Congress, 5th Floor
Tucson, AZ 85701
Phone: (520) 724-8449 • Fax: (520)222-0448

Document and Micrographics Mgt. Division
1640 East Benson Highway
Tucson, Arizona 85714
Phone: (520) 351-8454 • Fax: (520) 791-6666

TO: Development Services, Zoning Division
FROM: Ricci Romero RR: Administrative Support Specialist
DATE: October 12, 2016
RE: Zoning Report - Application for Liquor License

Attached is the application of:

Jeremy Julian Pye
d.b.a. Copper Mine Brewing Company, L.L.C.
3455 S. Palo Verde Road, Suite 135
Tucson, AZ 85713

Arizona Liquor License No. 03103030
Series 3, In-State Microbrewery
New License X
Person Transfer
Location Transfer

ZONING REPORT

DATE: 10/12/16

Will current zoning regulations permit the issuance of the license at this location?

Yes [checked] No [ ]

If No, please explain:

[Blank lines for explanation]

[Handwritten signature]
Pima County Zoning Inspector

When complete, please return to cob\_mail@pima.gov

OCT 13 16 PM 03:52 P.C. CLK OF BO [RR]

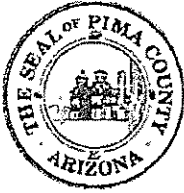

# Pima County Clerk of the Board

Robin Brigode

Julie Castañeda  
Deputy Clerk

Administration Division  
130 W. Congress, 5<sup>th</sup> Floor  
Tucson, AZ 85701  
Phone: (520) 724-8449 • Fax: (520)222-0448

Document and Micrographics Mgt. Division  
1640 East Benson Highway  
Tucson, Arizona 85714  
Phone: (520) 351-8454 • Fax: (520) 791-6666

TO: Pima County Sheriff's Department  
Investigative Support Unit

FROM: Ricci Romero *RR*  
Administrative Support Specialist

DATE: October 12, 2016

RE: Sheriff's Report - Application for Liquor License

Attached is the application of:

Jeremy Julian Pye  
d.b.a. Copper Mine Brewing Company, L.L.C.  
3455 S. Palo Verde Road, Suite 135  
Tucson, AZ 85713

Arizona Liquor License No. 03103030  
 Series 3 In-State Microbrewery  
 New License X  
 Person Transfer       
 Location Transfer     

SHERIFF'S REPORT

DATE: 10/19/16

Is there any reason this application should not be recommended for approval?

- NOTHING NOTED

\_\_\_\_\_

\_\_\_\_\_

\_\_\_\_\_

*TT Hilliker # 1226*  
 Investigative Support Unit Supervisor

When complete, please return to [cob\\_mail@pima.gov](mailto:cob_mail@pima.gov)

OCT 20 16 ANDERSON PC CLK OF PD *RR*



16 OCT 4 Licr. Dept AM1157

16 SEP 14 Licr. Dept PM1228

Arizona Department of Liquor Licenses and Control
800 W Washington 5th Floor
Phoenix, AZ 85007-2934
www.azliquor.gov
(602) 542-5141

16-23-9246

Application for Liquor License
Type or Print with Black Ink

APPLICATION FEE AND INTERIM PERMIT FEES (IF APPLICABLE) ARE NOT REFUNDABLE
A service fee of \$25 will be charged for all dishonored checks (A.R.S. § 44-6852)

16 OCT 11 Licr. Lic. PM 3:17

SECTION 1 This application is for a:

- Interim Permit (Complete Section 5)
New License (Complete Sections 2, 3, 4, 13, 14, 15, 16)
Person Transfer (Complete Section 2, 3, 4, 12, 13, 14, 16)
Location Transfer (Bars and Liquor Stores Only)
Probate/ Will Assignment/ Divorce Decree
Government (Complete Sections 2, 3, 4, 10, 13, 16)
Seasonal

SECTION 2 Type of Ownership:

- J.T.W.R.O.S. (Complete Section 6)
Individual (Complete Section 6)
Partnership (Complete Section 6)
Corporation (Complete Section 7)
Limited Liability Co (Complete Section 7)
Club (Complete Section 8)
Government (Complete Section 10)
Trust (Complete Section 6)
Tribe (Complete Section 6)
Other (Explain)

SECTION 3 Type of license

1. Type of License: In-state Microbrewery LICENSE # 03103030

SECTION 4 Applicants

- Individual Owner/Agent's Name: Pye Jeremy Julian
Owner Name: Copper Mine Brewing Company, LLC
Business Name: Copper Mine Brewing Company
Business Location Address: 3455 S Palo Verde Rd. Suite 135 Tucson AZ 85713 Pima
Mailing Address: 3455 S Palo Verde Rd. Suite 135 Tucson AZ 85713 Pima
Business Phone: 520-333-6140 Daytime Contact Phone: 520-481-5246 973-420-5638
Email Address: info@copperminebrewing.com

- 8. Is the Business located within the incorporated limits of the above city or town?
9. Does the Business location address have a street address for a City or Town but is actually in the boundaries of another City, Town or Tribal Reservation?

10. Total Price paid for Series 6 Bar, Series 7 Beer & Wine Bar or Series 9 Liquor Store (license only) \$

Fees: Application \$100.00, Interim Permit, Site Inspection, Finger Prints \$44.00, Total of All Fees \$144.00
Is Arizona Statement of Citizenship & Alien Status for State Benefits complete? Yes
Accepted by: [Signature] Date: 10/11/16 License # 03103030

16 OCT 11 10:06 PM CLK OF PD

**SECTION 5 Interim Permit**

- If you intend to operate business when your application is pending you will need an interim permit pursuant to ARS § 4-203.01
- There **MUST** be a valid license of the same type you are applying for currently issued to the location or for the replacement of a Hotel/Motel license with a Restaurant license pursuant to A.R.S. § 4-203.01.

1. Enter license number currently at the location: \_\_\_\_\_

2. Is the license currently in use?  Yes  No If no, how long has it been out of use? \_\_\_\_\_

**Attach a copy of the license currently issued at this location to this application.**

I, _____ (Print Full Name)		declare that I am the CURRENT OWNER, AGENT, OR CONTROLLING PERSON on the stated license and location.	
X _____ (Signature of CURRENT Individual Owner/Agent)	State of _____	County of _____	The foregoing instrument was acknowledged before me this _____
My commission expires on: _____ Date	_____ Day	of _____ Month	_____ Year
		_____ Signature of NOTARY PUBLIC	

**SECTION 6 Individual, Partnership, J.T.W.R.O.S, Trust, Tribe Ownerships**

**EACH PERSON LISTED MUST SUBMIT A COMPLETED QUESTIONNAIRE, AN "APPLICANT" TYPE FINGERPRINT CARD AND \$22 PROCESSING FEE FOR EACH CARD.**

**Individual**

Last	First	Middle	%Owned	Mailing Address	City	State	Zip Code

Is any person other than above, going to share in profit/losses of the business?  Yes  No

If Yes, give name, current address, and telephone number of person(s). Use additional sheets if necessary.

Last	First	Middle	Mailing Address	City	State	Zip Code	Phone #

**Partnership**

Name of Partnership: \_\_\_\_\_

General-Limited	Last	First	Middle	%Owned	Mailing Address	City	State	Zip Code
<input type="checkbox"/> <input type="checkbox"/>								
<input type="checkbox"/> <input type="checkbox"/>								
<input type="checkbox"/> <input type="checkbox"/>								
<input type="checkbox"/> <input type="checkbox"/>								

**J.T.W.R.O.S (Joint Tenant with Rights of Survivorship)**

Name of J.T.W.R.O.S: \_\_\_\_\_

Last	First	Middle	Mailing Address	City	State	Zip Code

**TRUST**

Name of Trust: \_\_\_\_\_

Last	First	Middle	Mailing Address	City	State	Zip Code

**TRIBE**

Name of Tribal Ownership: \_\_\_\_\_

Last	First	Middle	Mailing Address	City	State	Zip Code

**SECTION 7 Corporations/ Limited Liability Co**

EACH PERSON LISTED MUST SUBMIT A COMPLETED QUESTIONNAIRE, AN "APPLICANT" TYPE FINGERPRINT CARD AND \$22 PROCESSING FEE FOR EACH CARD.

- Corporation Complete Questions 1, 2, 3, 4, 5, 6, and 7  
 L.L.C. Complete Questions 1, 2, 3, 4, 5, 6, and 7

1. Name of Corporation/ L.L.C: Copper Mine Brewing Company, LLC  
 2. Date Incorporated/Organized: 4/17/2015 State where Incorporated/Organized: Arizona  
 3. AZ Corporation or AZ L.L.C File No: L19993879 Date authorized to do Business in AZ: 5/5/2015  
 4. Is Corp/L.L.C. Non Profit?  Yes  No  
 5. List Directors, Officers, Members in Corporation/L.L.C:

Last	First	Middle	Title	Mailing Address	City	State	Zip Code
Kaber	Jeffrey	Adam	Owner MEMBER	15068 S Camino Rio Puerco	Sahuarita	AZ	85629
Pye	Jeremy	Julian	Owner MEMBER	14484 S Camino Tierra Monte	Sahuarita	AZ	85629

(Attach additional sheet if necessary)

6. List all Stockholders / percentage owners who own 10% or more:

Last	First	Middle	%Owned	Mailing Address	City	State	Zip Code
Kaber	Jeffrey	Adam	50%	15068 S Camino Rio Puerco	Sahuarita	AZ	85629
Pye	Jeremy	Julian	50%	14484 S Camino Tierra Monte	Sahuarita	AZ	85629

(Attach additional sheet if necessary)

7. If the corporation/ L.L.C are owned by another entity, attach an Organizational **FLOWCHART** showing the structure of the ownership. Attach additional sheets as needed in order to disclose the Officers, Directors, Members, Managers, Partners, Stockholders and percentage owners of those entities.

**SECTION 8 Club Applicants**

**EACH PERSON LISTED MUST SUBMIT A COMPLETED QUESTIONNAIRE, AN "APPLICANT" TYPE FINGERPRINT CARD AND \$22 PROCESSING FEE FOR EACH CARD**

- 1. Name of Club: \_\_\_\_\_
- 2. Is Club non-profit?  Yes  No
- 3. List all controlling members (minimum of four (4) requested)

Last	First	Middle	Mailing Address	City	State	Zip Code

(Attach additional sheet if necessary)

**SECTION 9 Probate, Will Assignment or Divorce Decree of an existing Liquor License**

1. Current Licensee's Name: \_\_\_\_\_  
(Exactly as it appear on the license) Last First Middle

2. Assignee's Name: \_\_\_\_\_  
Last First Middle

3. License Type: \_\_\_\_\_ License Number: \_\_\_\_\_

**ATTACH TO THIS APPLICATION A CERTIFIED COPY OF THE WILL, PROBATE DISTRIBUTION INSTRUMENT, OR DIVORCE DECREE THAT SPECIFICALLY DISTRIBUTES THE LIQUOR LICENSE TO THE ASSIGNEE.**

**SECTION 10 Government (for cities, towns, or counties only)**

1. Government Entity: \_\_\_\_\_

2. Person/Designee: \_\_\_\_\_  
First Last Middle Day time Contact Phone #

**A SEPARATE LICENSE MUST BE OBTAINED FOR EACH PREMISE FROM WHICH SPIRITUOUS LIQUOR IS SERVED.**

**SECTION 11 Location to Location Transfer: Series 6 Bar, Series 7 Beer & Wine Series 9 Liquor Stores only)**

1. Current Business: Name: \_\_\_\_\_  
Address: \_\_\_\_\_  
(Exactly as it appears on license)

2. New Business: Name: \_\_\_\_\_  
Address: \_\_\_\_\_

1. License Type: \_\_\_\_\_ License Number: \_\_\_\_\_



**SECTION 12 Person to Person Transfer**

Questions to be completed by Current Licensee (Bar and Liquor Stores Only- Series, 06, 07, and 09)

1. Individual Owner / Agent Name: \_\_\_\_\_ Entity: \_\_\_\_\_  
Last First Middle (Individual, Agent, Etc.)

2. Ownership Name: \_\_\_\_\_  
(Exactly as it appears on license)

3. Business Name: \_\_\_\_\_  
(Exactly as it appears on license)

4. Business Location Address: \_\_\_\_\_  
Street City State Zip

5. License Type: \_\_\_\_\_ License Number: \_\_\_\_\_

6. Current Mailing Address: \_\_\_\_\_  
Street City State Zip

7. Have all creditors, lien holders, interest holders, etc. been notified?  Yes  No

8. Does the applicant intend to operate the business while this application is pending?  Yes  No

If yes, complete Section 5 (Interim Permit) of this application; attach fee, and current license to this application.

9. I, (Print Full Name) \_\_\_\_\_ hereby authorize the department to process this Application to transfer the privilege of the license to the applicant provided that all terms and conditions of sale are met. Based on the fulfillment of these conditions, I certify that the applicant now owns or will own the property rights of the license by the date of issue.

I, (Print Full Name) \_\_\_\_\_ declare that I am the **CURRENT OWNER, MEMBER, PARTNER STOCKHOLDER or LICENSEE** of the stated license. I have read the above Section 12 and confirm that all statements are true, correct, and complete.

**NOTARY**

X \_\_\_\_\_ State of \_\_\_\_\_ County of \_\_\_\_\_  
(Signature of CURRENT Individual Owner/Agent) The foregoing instrument was acknowledged before me this

My commission expires on: \_\_\_\_\_ of \_\_\_\_\_  
Date Day Month Year

\_\_\_\_\_  
Signature of NOTARY PUBLIC

**SECTION 13 Proximity to Church or School**

Questions to be completed by all in-state applicants.

A.R.S. § 4-207. (A) and (B) state that no retailer's license shall be issued for any premises which are at the time the license application is received by the director, within three hundred (300) horizontal feet of a church, within three hundred (300) horizontal feet of a public or private school building with kindergarten programs or grades one (1) through (12) or within three hundred (300) horizontal feet of a fenced recreational area adjacent to such school building.

The above paragraph DOES NOT apply to:

- a) Restaurant license (§ 4-205.02) Series 12
- b) Hotel/motel license (§ 4-205.01) Series 11
- c) Microbrewery Series 3
- d) Craft Distillery Series 18
- e) Government license (§ 4-205.03) Series 5
- f) Fenced playing area of a golf course (§ 4-207(B)(5))
- g) Wholesaler Series 4
- h) Farm Winery Series 13

1. Distance to nearest School: 3.4 miles Name of School: Howenstine High School  
(If less than one (1) mile note footage)  
 Address: 555 South Tucson Boulevard, Tucson, AZ 85716

2. Distance to nearest Church: 1.2 miles Name of Church: OUR LADY QUEEN OF ALL SAINTS PARISH  
(If less than one (1) mile note footage)  
 Address: 2915 E 36th St, Tucson, AZ 85713

**SECTION 14 Business Financials**

1. I am the:  Lessee  Sub-lessee  Owner  Purchaser  Management Company

2. If the premise is leased give lessors: Name: 3455 South Palo Verde Rd LLC  
 Address: P.O Box 26927 Tucson, AZ 85726  
Street City State Zip

3. Monthly Rent/ Lease Rate: \$ 1270.50

4. What is the remaining length of the lease? Yrs. 5 Months 6

5. What is the penalty if the lease is not fulfilled? \$ \_\_\_\_\_ or Other: Personal Guarantee  
(Give details-attach additional sheet if necessary)

6. Total money borrowed for the Business not including lease? \$ 40,000  
 Please List Lenders/People you owe money to for business.

Last	First	Middle	Amount Owed	Mailing Address	City	State	Zip
Pye	Anthony		\$40,000	1551 E Via Soledad	Tucson, AZ		85718

(Attach additional sheet if necessary)

7. What type of business will this license be used for (be specific)?  
Microbrewery

8. Has a license or a transfer license for the premises on this application been denied by the state with in the past (1) year?  Yes  No If yes, attach explanation.

9. Does any spirituous liquor manufacture, wholesaler, or employee have an interest in your business?  Yes  No

10. Is the premises currently license with a liquor license?  Yes  No

If yes, give license number and licensee's name:

License #: \_\_\_\_\_ Individual Owner /Agent Name: \_\_\_\_\_  
(Exactly as it appears on license)

PROMISSORY NOTE

\$40,000

June 20, 2016  
Tucson, Arizona

FOR VALUE RECEIVED, the undersigned, ("Maker"), hereby promises to pay to the order of Anthony I. Pye and/or Margaret R. Pye (the "Holder"), the principal sum of Forty Thousand U.S. Dollars (\$40,000.00), pursuant to the terms and conditions set forth herein.

**PAYMENT OF PRINCIPAL.** The principal amount of this Promissory Note (the "Note") shall be due and payable in twelve (12) consecutive equal quarterly installments of Two Thousand Five Hundred Dollars (\$2,500.00), beginning one year following the Commencement Date, as defined herein, together with a separate final payment of Ten Thousand Dollars (\$10,000.00) to be made on the fourth anniversary of the Commencement Date. The Commencement Date shall be that date upon which Maker shall have notified Holder that Maker has commenced retail operations. Holder agrees that Maker shall have absolute discretion as to the selection of the Commencement Date, provided only that the Commencement Date must occur no later than March 31, 2017. All payments under this Note shall be applied first to accrued but unpaid interest, and next to outstanding principal. If not sooner paid, the entire remaining indebtedness (including accrued interest) shall be due and payable no later than four (4) years from the Commencement Date.

**INTEREST.** The interest payable on this Note shall be as follows. Commencing thirty (30) days following the Commencement Date, interest shall be payable in equal monthly installments of Four Hundred Dollars (\$400.00), until such time as the outstanding principal shall have been reduced to Twenty Thousand Dollars (\$20,000.00). At such time as the outstanding principal balance shall have been reduced to Twenty Thousand Dollars (\$20,000.00), interest shall thereafter be payable in equal monthly installments of Three Hundred Thirty Three and 33/100 Dollars (\$333.33) until the principal balance of the Note shall have been paid in full.

**PREPAYMENT.** Subject to the foregoing, Maker shall have the right at any time and from time to time to prepay this Note in whole or in part without premium or penalty.

**REMEDIES.** No delay or omission on part of Holder in exercising any right hereunder shall operate as a waiver of any such right or of any other right of Holder, nor shall any delay, omission or waiver on any one occasion be deemed a bar to or waiver of the same or any other right on any future occasion. The rights and remedies of Holder shall be cumulative and may be pursued singly, successively, or together, in the sole discretion of Holder.

**EVENTS OF ACCELERATION.** The occurrence of any of the following shall constitute an "Event of Acceleration" by Maker under this Note:

- (a) Maker's failure to pay any part of the principal or interest as and when due under this Note; or

16 OCT 11 11:47 AM 1229

(b) Maker's becoming insolvent or not paying its debts as they become due.

**ACCELERATION.** Upon the occurrence of an Event of Acceleration under this Note, and in addition to any other rights and remedies that Holder may have, Holder shall have the right, at its sole and exclusive option, to declare this Note immediately due and payable.

**SUBORDINATION.** Maker's obligations under this Promissory Note are subordinated to all indebtedness, if any, of Maker, to any unrelated third party lender, to the extent such indebtedness is outstanding on the date of this Note and such subordination is required under the loan documents providing for such indebtedness.

**WAIVERS BY MAKER.** All parties to this Note including Maker and any sureties, endorsers, and guarantors hereby waive protest, presentment, notice of dishonor, and notice of acceleration of maturity and agree to continue to remain bound for the payment of principal, interest and all other sums due under this Note notwithstanding any change or changes by way of release, surrender, exchange, modification or substitution of any security for this Note, or by way of any extension or extensions of time for the payment of principal and interest; and all such parties waive all and every kind of notice of such change or changes and agree that the same may be made without notice or consent of any of them.

**EXPENSES.** In the event any payment under this Note is not paid when due, the Maker agrees to pay, in addition to the principal and interest hereunder, reasonable attorneys' fees not exceeding a sum equal to 15% of the then outstanding balance owing on the Note, plus all other expenses reasonably incurred by Holder in exercising any of their rights and remedies upon default.

**GOVERNING LAW.** This Note shall be governed by, and construed in accordance with, the laws of the State of Arizona.

**SUCCESSORS.** All of the foregoing is the promise of Maker and shall bind Maker and Maker's successors, heirs and assigns; provided, however, that Maker may not assign any of its rights or delegate any of its obligations hereunder without the prior written consent of the holder of this Note.

16 OCT 11 11:47 AM '18

IN WITNESS WHEREOF, Maker has executed this Promissory Note as of the day and year first above written.

Maker: COPPER MINE BREWING COMPANY, LLC

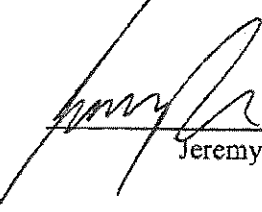
By:   
Jeremy Pye

By:   
Jeffrey Kaber

16 OCT 11 11:47 AM '18

#  
Pye, Jeremy

**SECTION 15 Restaurant or hotel/motel license applicants**

- 1. Is there an existing Restaurant or Hotel/Motel Liquor License at the proposed location?  Yes  No
- 2. If the answer to Question 1 is YES, you may qualify for an Interim Permit to operate while your application is pending; consult A.R.S. § 4-203.01; and complete SECTION 5 of this application.
- 3. All Restaurant and Hotel/Motel applicants must complete a Restaurant Operation Plan form provided by the Department of Liquor Licenses and Control.
- 4. As stated in A.R.S. § 4-205.02. (H)(2), a Restaurant is an establishment which derives at least forty (40) percent of its gross revenue from the sale of food. Gross revenue is the revenue derived from sales of food and spirituous liquor on the licensed premises. By applying for this  Restaurant  Hotel/Motel, I certify that I understand that I must maintain a minimum of forty (40) percent food sales based on these definitions and have included the Restaurant Hotel/Motel Records Required for Audit form with this application.

\_\_\_\_\_  
(Applicant's Signature)

5. I understand it is my responsibility to contact the Department of Liquor Licenses and Control to schedule an inspection when all tables and chairs are on site, kitchen equipment, and, if applicable, patio barriers are in place on the licensed premises. With the exception of the patio barriers, these items are not required to be properly installed for this inspection. Failure to schedule an inspection will delay issuance of the license. If you are not ready for your inspection 90 days after filing your application, please request an extension in writing; specify why the extension is necessary; and the new inspection date you are requesting.

\_\_\_\_\_  
(Applicant's Initials)

**SECTION 14 Diagram of Premises**

Check ALL boxes that apply to your business:

- Entrances/Exits       Liquor storage areas      Patio:  Contiguous
- Walk-up windows       Drive-through windows       Non Contiguous

1. Is your licensed premises currently closed due to construction, renovation or redesign?  Yes  No  
If yes, what is your estimated completion date? December 15, 2016

\_\_\_\_\_  
Month/Day/Year

- 2. Restaurant and Hotel/Motel applicants are required to draw a detailed floor plan of the kitchen and dining areas including the locations of all kitchen equipment and dining furniture. Place for diagram is on section 16 number 6.
- 3. The diagram (a detailed floor plan) you provide is required to disclose only the area(s) where spirituous liquor is to be sold, served, consumed, dispensed, possessed or stored on the premises unless it is a restaurant (see # 3 above).
- 4. Provide the square footage or outside dimensions of the licensed premises. Please do not include non-licensed premises such as parking lots, living quarters, etc.
- 5. As stated in A.R.S. § 4-207.01 (B), I understand it is my responsibility to notify the Department of Liquor Licenses and Control when there are changes to the boundaries, entrances, exits, added or deleted doors, windows, service windows or increase or decrease to the square footage after submitting this initial diagram.

*[Handwritten Signature]*  
\_\_\_\_\_  
(Applicant's Initials)

16 OCT 11 11:47 AM '16

**SECTION 15 Restaurant or hotel/motel license applicants**

- 1. Is there an existing Restaurant or Hotel/Motel Liquor License at the proposed location?  Yes  No
- 2. If the answer to Question 1 is YES, you may qualify for an Interim Permit to operate while your application is pending; consult A.R.S. § 4-203.01; and complete SECTION 5 of this application.
- 3. All Restaurant and Hotel/Motel applicants must complete a Restaurant Operation Plan form provided by the Department of Liquor Licenses and Control.
- 4. As stated in A.R.S. § 4-205.02. (H)(2), a Restaurant is an establishment which derives at least forty (40) percent of its gross revenue from the sale of food. Gross revenue is the revenue derived from sales of food and spirituous liquor on the licensed premises. By applying for this  Restaurant  Hotel/Motel, I certify that I understand that I must maintain a minimum of forty (40) percent food sales based on these definitions and have included the Restaurant Hotel/Motel Records Required for Audit form with this application.

\_\_\_\_\_  
(Applicant's Signature)

5. I understand it is my responsibility to contact the Department of Liquor Licenses and Control to schedule an inspection when all tables and chairs are on site, kitchen equipment, and, if applicable, patio barriers are in place on the licensed premises. With the exception of the patio barriers, these items are not required to be properly installed for this inspection. Failure to schedule an inspection will delay issuance of the license. If you are not ready for your inspection 90 days after filing your application, please request an extension in writing; specify why the extension is necessary; and the new inspection date you are requesting.

\_\_\_\_\_  
(Applicant's Initials)

**SECTION 16 Diagram of Premises**

Check ALL boxes that apply to your business:

- Entrances/Exits       Liquor storage areas      **Patio:**  Contiguous
- Walk-up windows       Drive-through windows       Non Contiguous

1. Is your licensed premises currently closed due to construction, renovation or redesign?  Yes  No  
If yes, what is your estimated completion date? December 15, 2016

\_\_\_\_\_  
Month/Day/Year

- 2. **Restaurants and Hotel/Motel** applicants are required to draw a detailed floor plan of the kitchen and dining areas including the locations of all kitchen equipment and dining furniture. Place for diagram is on section 16 number 6.
- 3. The diagram (a detailed floor plan) you provide is required to disclose only the area(s) where spirituous liquor is to be sold, served, consumed, dispensed, possessed or stored on the premises unless it is a restaurant (see # 3 above).
- 4. Provide the square footage or outside dimensions of the licensed premises. Please do not include non-licensed premises such as parking lots, living quarters, etc.
- 5. **As stated in A.R.S. § 4-207.01 (B), I understand it is my responsibility to notify the Department of Liquor Licenses and Control when there are changes to the boundaries, entrances, exits, added or deleted doors, windows, service windows or increase or decrease to the square footage after submitting this initial diagram.**

\_\_\_\_\_  
(Applicant's Initials)

18 OCT 11 AM 1:14 PM '16

**SECTION 16** Diagram of Premises – continued

6. On the diagram please show only the areas where spirituous liquor is to be sold, served, consumed, dispensed, possessed or stored. It must show all entrances, exits, interior walls, bars, hi-top tables, dining tables, dining chairs, dance floor, stage, game room, and the kitchen. DO NOT include parking lots, living quarters, etc. When completing diagram, North is up ↑.

If a legible copy of a rendering or drawing of your diagram of the premises is attached to this application, please write the words "DIAGRAM ATTACHED" in the box provided for the diagram on the application.

**DIAGRAM OF PREMISES**

Diagram Attached

16 OCT 11 09:14 PM 3:19



16 OCT 11 11:47 AM

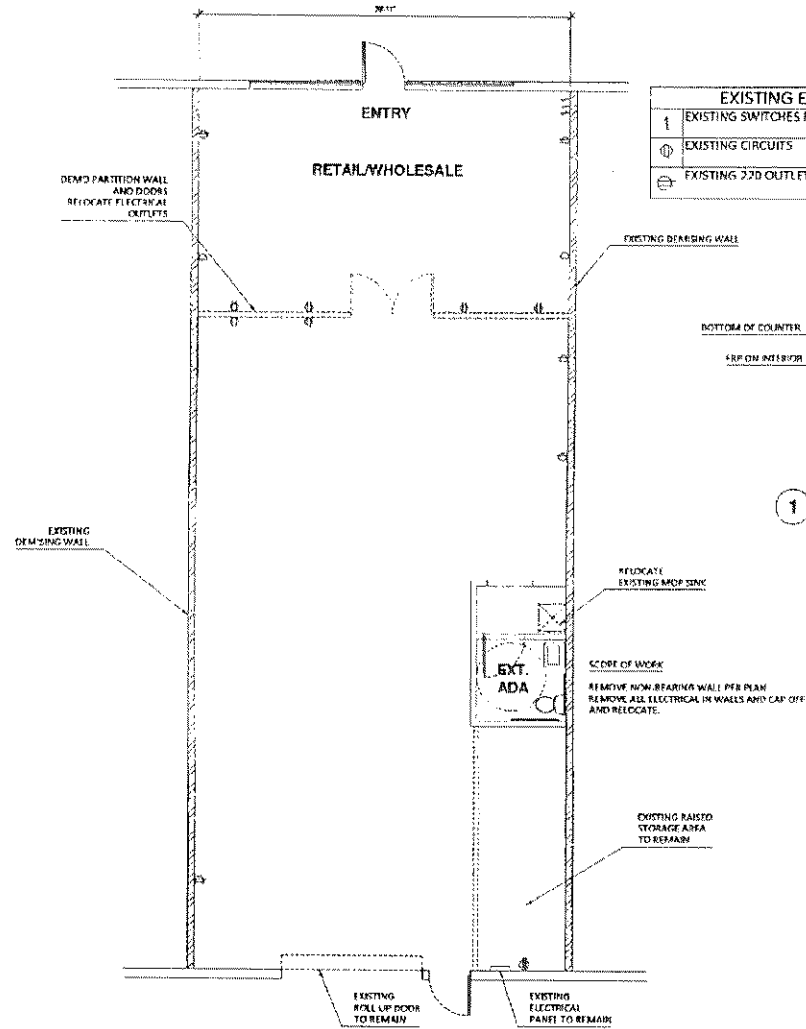

EXISTING ELECTRICAL LEGEND	
⌚	EXISTING SWITCHES RELOCATE AS NEEDED
⊕	EXISTING CIRCUITS
⊖	EXISTING 220 OUTLET

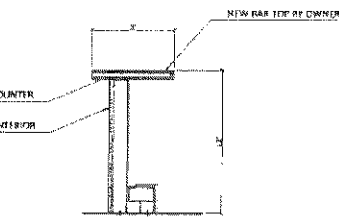

1 BAR SECTION

Beer/Liquor Storage

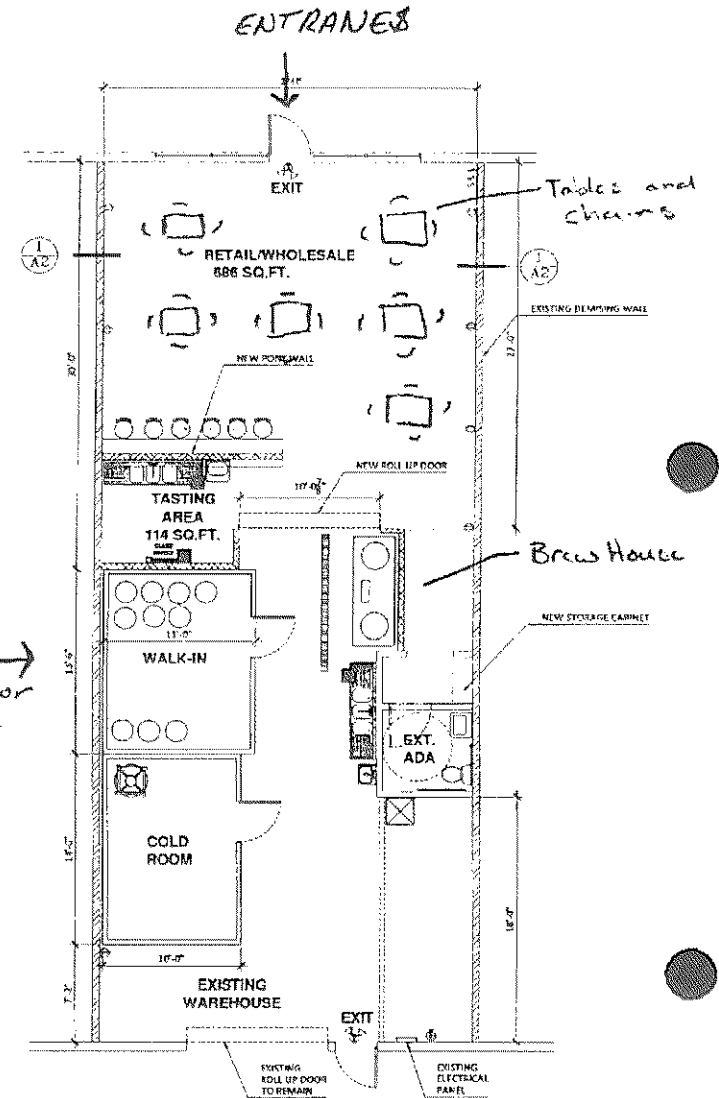

FLOOR PLAN

SCALE 1/4" = 1'-0"

DEMO - EXISTING FLOOR PLAN  
SCALE 1/4" = 1'-0"

Progress Set  
*John P. Calton*

<b>VVC DESIGN</b> ARCHITECT 1930 N. CASSIDY LN TUCSON, AZ 85705-7240	
COPPER MINE BREWING 2418 S. PALO VERDE #105 DRAWN BY DATE REVISION SHEET PROJECT #	A1 2

NOTARY

JEREMY JULIAN PYE

I, (Print Full Name) Jeremy Pye, hereby declare that I am the Owner/Agent filing this application as stated in Section 4 # 1 I have read this application and verify all statements to be true, correct and complete.

X [Signature]  
(Signature of CURRENT Individual Owner/Agent)

State of Arizona County of Pima  
The foregoing instrument was acknowledged before me this

My commission expires on: Sept 23, 2017  
Date

12<sup>th</sup> of Sept Month, 2016 Year

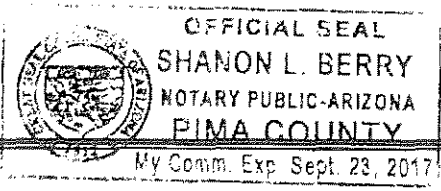

[Signature]  
Signature of NOTARY PUBLIC

**A.R.S. § 41-1030. Invalidity of rules not made according to this chapter; prohibited agency action; prohibited acts by state employees; enforcement; notice**

B. An agency shall not base a licensing decision in whole or in part on a licensing requirement or condition that is not specifically authorized by statute, rule or state tribal gaming compact. A general grant of authority in statute does not constitute a basis for imposing a licensing requirement or condition unless a rule is made pursuant to that general grant of authority that specifically authorizes the requirement or condition.

D. THIS SECTION MAY BE ENFORCED IN A PRIVATE CIVIL ACTION AND RELIEF MAY BE AWARDED AGAINST THE STATE. THE COURT MAY AWARD REASONABLE ATTORNEY FEES, DAMAGES AND ALL FEES ASSOCIATED WITH THE LICENSE APPLICATION TO A PARTY THAT PREVAILS IN AN ACTION AGAINST THE STATE FOR A VIOLATION OF THIS SECTION.

E. A STATE EMPLOYEE MAY NOT INTENTIONALLY OR KNOWINGLY VIOLATE THIS SECTION. A VIOLATION OF THIS SECTION IS CAUSE FOR DISCIPLINARY ACTION OR DISMISSAL PURSUANT TO THE AGENCY'S ADOPTED PERSONNEL POLICY.

F. THIS SECTION DOES NOT ABROGATE THE IMMUNITY PROVIDED BY SECTION 12-820.01 OR 12-820.02.