



BOARD OF SUPERVISORS AGENDA ITEM REPORT

Requested Board Meeting Date: September 5, 2017

Title: Andrada Ranch, Lots 1-27, P16SC00045, Developer/Owner: C. Stone Holdings LLC

Introduction/Background:

Acceptance of the above referenced Project/Roadway into the Pima County Maintenance System.

Discussion:

Project/Roadway Improvements have been completed and dedicated to Pima County and Recorded as Public Right-of-Way. Recommendation is made to accept the attached roadways into the Pima County Maintenance System.

Conclusion:

If Approved:

Public improvements completed adjacent to these Subdivision Lots and/or Roadway will be maintained by the Pima County Department of Transportation.

If Denied:

Recently completed improvements to the above referenced Project/Roadway will not be maintained by the Pima County Department of Transportation.

Recommendation:

Acceptance of the attached roadways/subdivision improvements into the Pima County Maintenance System.

Fiscal Impact:

No cost to the Department for these improvements. If accepted into the Maintenance System there will be a cost associated with the maintenance, however not immediately since it is new construction.

Board of Supervisor District:

1 2 3 4 5 All

Department: Transportation Telephone: 520-724-2819

Department Director Signature/Date: [Signature] 8/16/17

Deputy County Administrator Signature/Date: [Signature] 8/16/17

County Administrator Signature/Date: C. Durberry 8/17/17

AUG 21 17 AM 11:45 POC CLK OF BD
[Signature]

- CONSTRUCTION NOTES**
- ① INSTALL SURVEY MONUMENT PER PAG STD. DTL. 103.
 - ② INSTALL CONCRETE MONUMENT PER PAG STD. DTL. 213.
 - ③ SMOOTH, TACK, TRIM AND MATCH EXISTING.

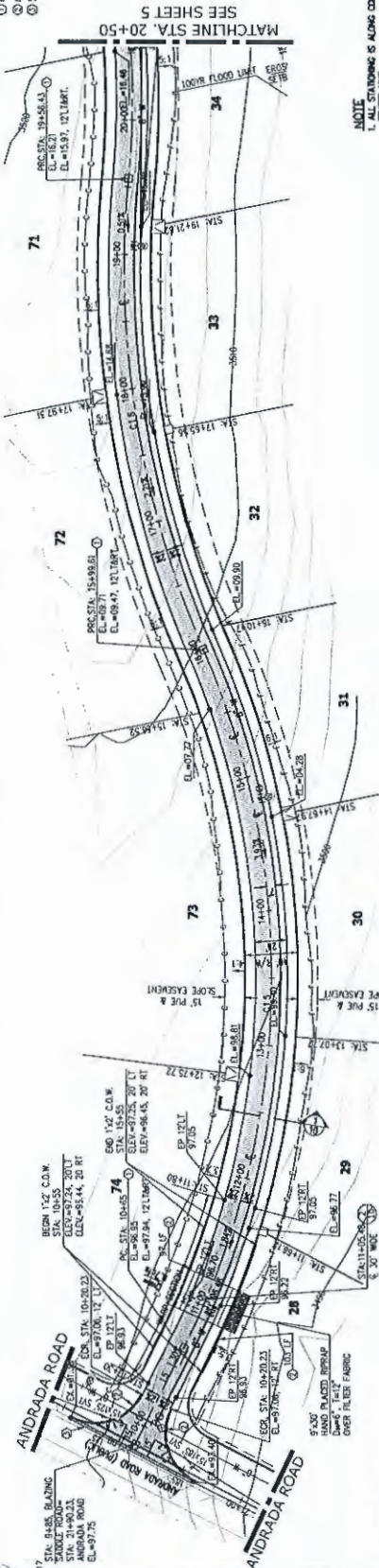

NOTE
 1. ALL STATIONING IS ALONG CONSTRUCTION CENTER LINE.
 2. SEE SHEET # FOR CURB AND GUTTER VALUES.

BLAZING SADDLE ROAD (PUBLIC STREET)

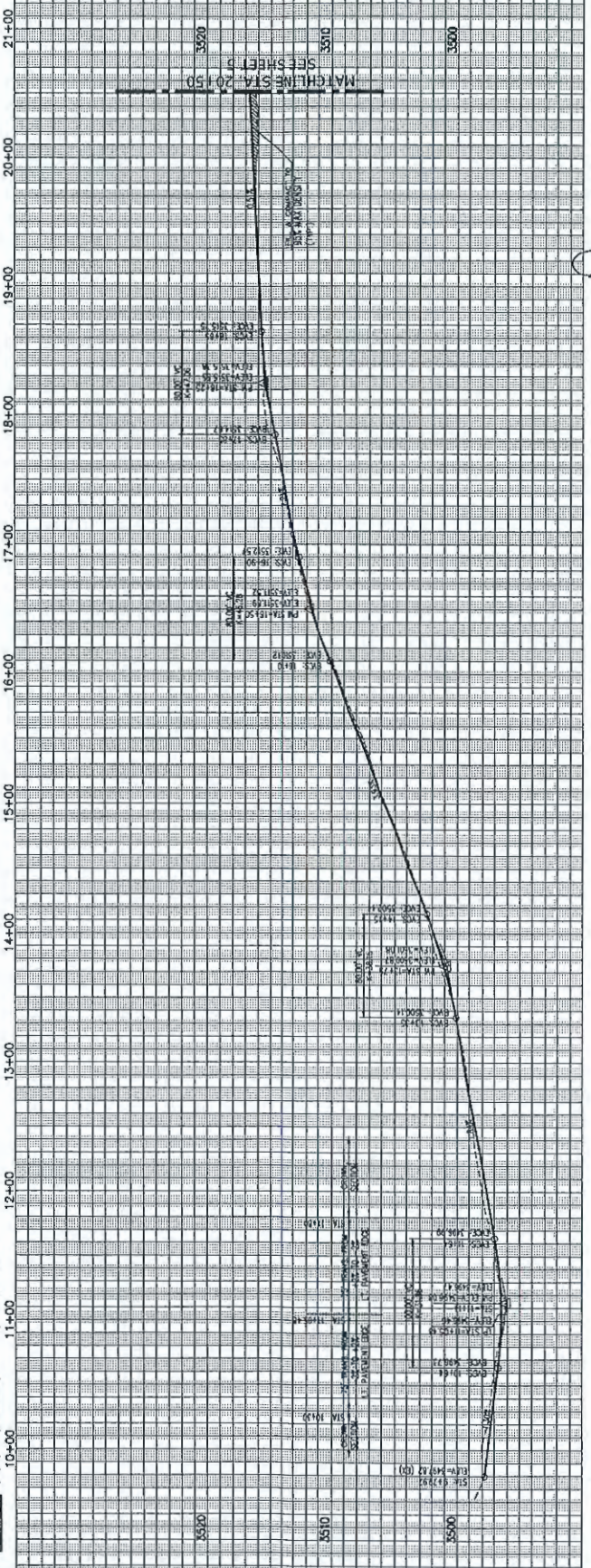

CONRAD ENGINEERING & DEVELOPMENT, INC.
 1870 W. PINEHURST BLVD., SUITE 200, TUCSON, AZ 85724
 PHONE: (520) 622-0811
 FAX: (520) 622-0812

PLAN & PROFILE

DATE: _____
 DRAWN BY: _____
 CHECKED BY: _____
 PROJECT NO.: _____
 SHEET NO.: _____

DATE: _____
 DRAWN BY: _____
 CHECKED BY: _____
 PROJECT NO.: _____
 SHEET NO.: _____

1-800-702-5348
 Call for the location of
 your local office

CONSTRUCTION NOTES:
 1. ALL STAKING IS ALONG CONSTRUCTION CENTER LINE.
 2. SEE SHEET 9 FOR CURB AND GUTTER VALUE.

NOTE:
 1. ALL STAKING IS ALONG CONSTRUCTION CENTER LINE.
 2. SEE SHEET 9 FOR CURB AND GUTTER VALUE.

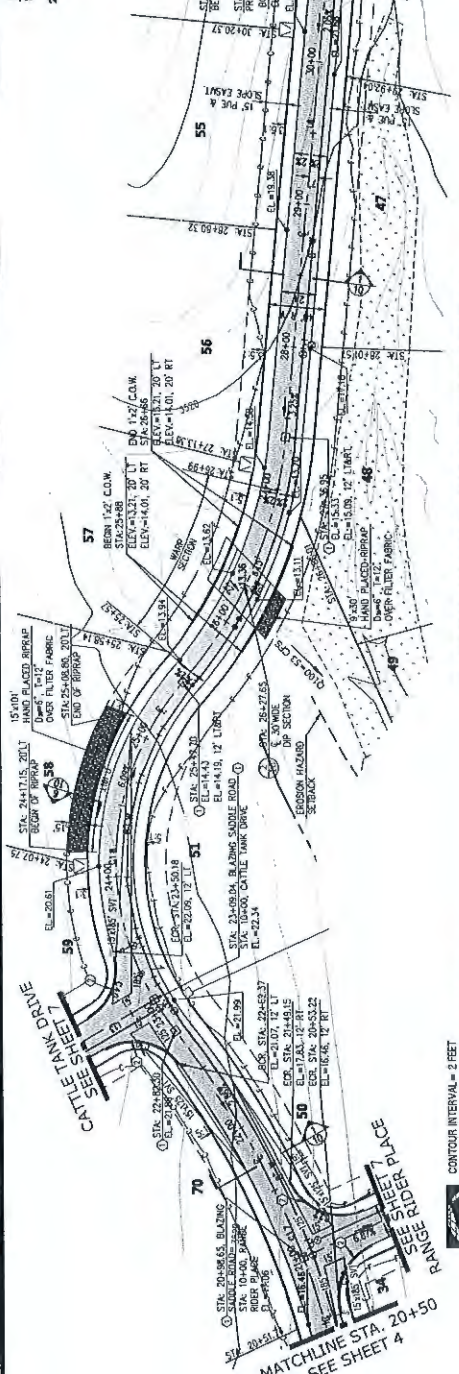

BLAZING SADDLE ROAD (PUBLIC STREET)

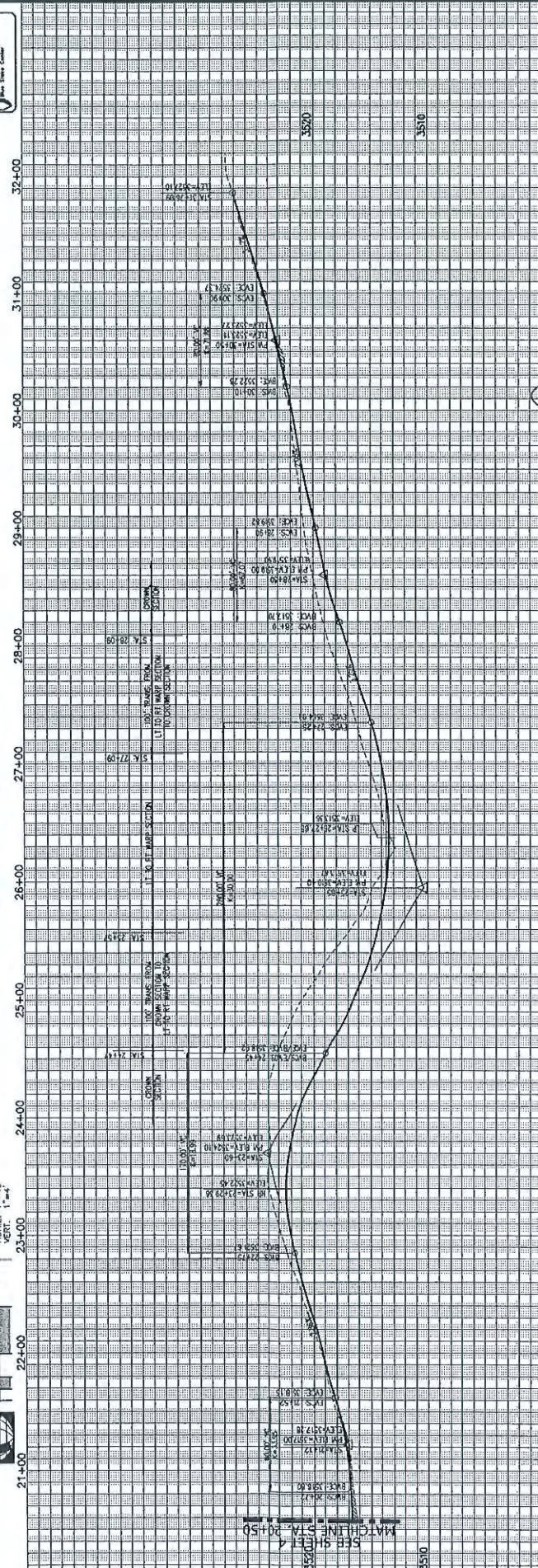

APPROVED: [Signature]
 DATE: [Date]

ANDRADA RANCH
 PAVING PLAN
 LOTS 1 THRU 4 & COMMON AREA 'A'

PROJECT NO. ANDRADA-R-001
 SHEET NO. 5
 DATE: 03-17-17
 DRAWN BY: [Name]
 CHECKED BY: [Name]
 SCALE: AS SHOWN

CONRADO ENGINEERING & DEVELOPMENT, INC.
 1511 W. PARKWAY
 SUITE 100
 PHOENIX, AZ 85026
 WWW.CONRADO.COM

PLAN & PROFILE

CONRADO ENGINEERING & DEVELOPMENT, INC.
 1511 W. PARKWAY
 SUITE 100
 PHOENIX, AZ 85026
 WWW.CONRADO.COM

CONSTRUCTION NOTES

- INSTALL SURVEY MONUMENT PER PAC STD. DTL. 101.
- INSTALL CONCRETE HEADER PER PAC STD. DTL. 213.
- SAW-CUT, TACK, TRIM AND MATCH EXISTING.

NOTE

- ALL STATIONING IS ALONG CONSTRUCTION CENTER LINE.
- SEE SHEET 9 FOR CURB AND LINE TABLE VALUE.

1-800-782-3348
New York, New York
New York, New York

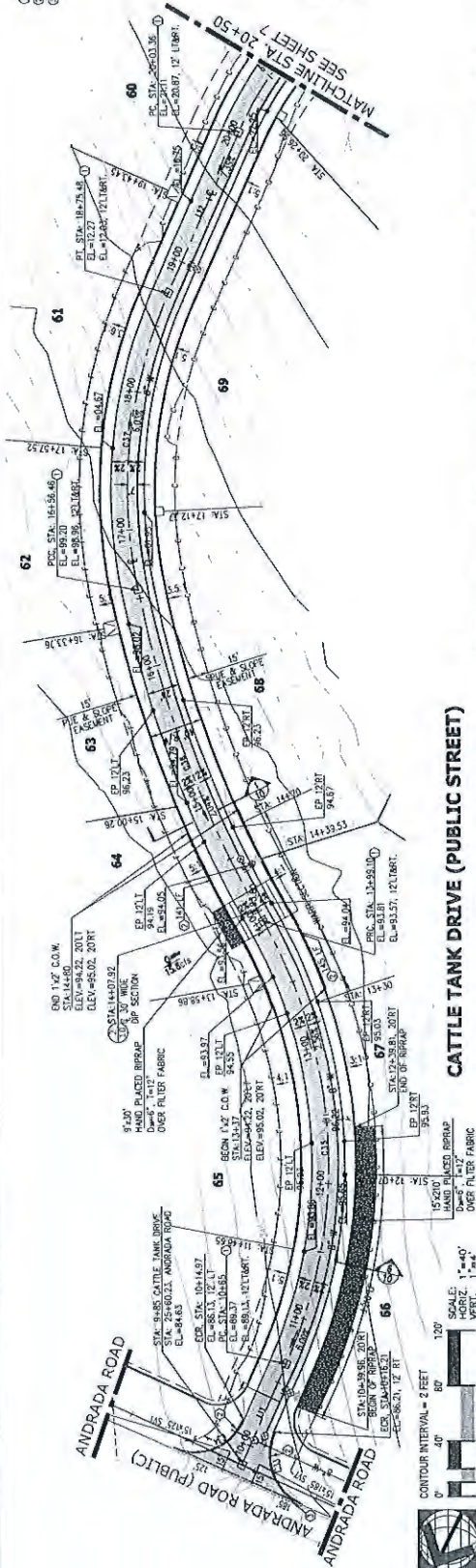

CATTLE TANK DRIVE (PUBLIC STREET)

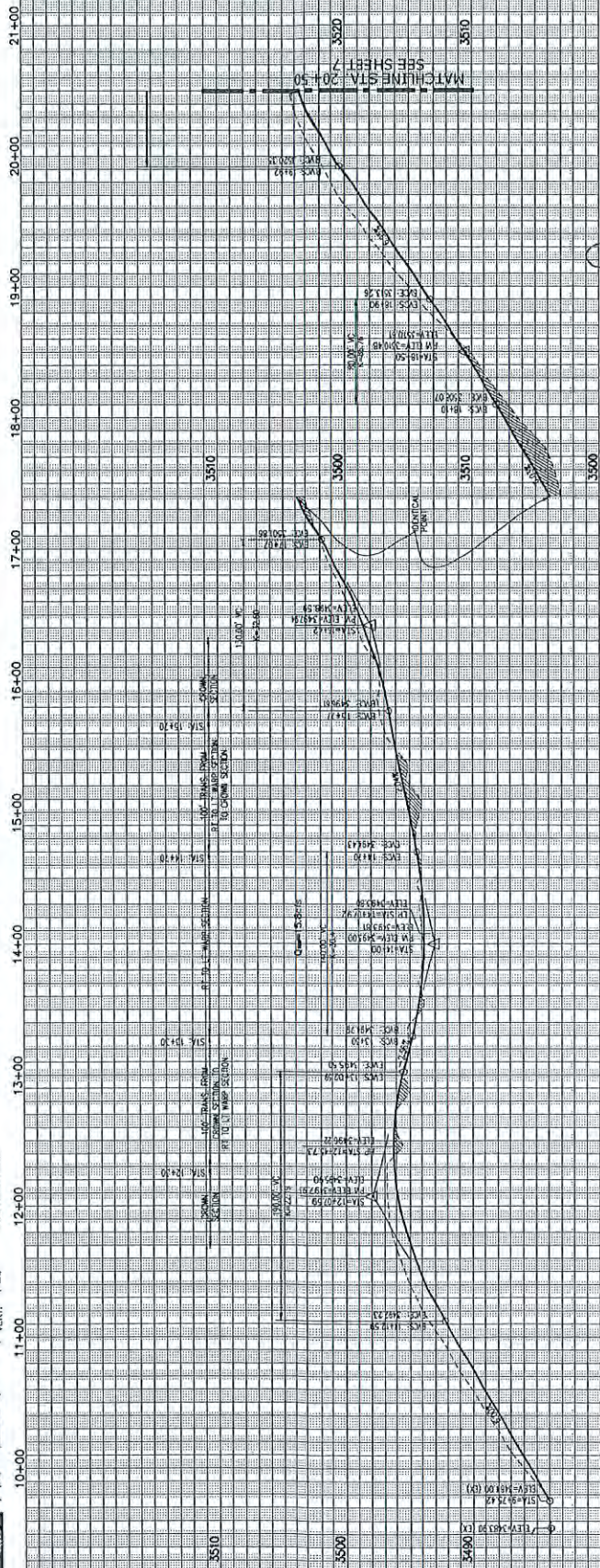

CONRAD ENGINEERS & DEVELOPMENT, INC.
100 W. ARCADE ST., SUITE 203, TAMPA, FL 33606
PH: 813-281-1000
WWW.CONRADINC.COM

DATE: 03/13/16
PROJECT: 16-0000000000
SHEET: 12 OF 12
SCALE: AS SHOWN

CONRAD ENGINEERS & DEVELOPMENT, INC.
100 W. ARCADE ST., SUITE 203, TAMPA, FL 33606
PH: 813-281-1000
WWW.CONRADINC.COM

DATE: 03/13/16
PROJECT: 16-0000000000
SHEET: 12 OF 12
SCALE: AS SHOWN

CONRAD ENGINEERS & DEVELOPMENT, INC.
100 W. ARCADE ST., SUITE 203, TAMPA, FL 33606
PH: 813-281-1000
WWW.CONRADINC.COM

DATE: 03/13/16
PROJECT: 16-0000000000
SHEET: 12 OF 12
SCALE: AS SHOWN

CONRAD ENGINEERS & DEVELOPMENT, INC.
100 W. ARCADE ST., SUITE 203, TAMPA, FL 33606
PH: 813-281-1000
WWW.CONRADINC.COM

DATE: 03/13/16
PROJECT: 16-0000000000
SHEET: 12 OF 12
SCALE: AS SHOWN

CONRAD ENGINEERS & DEVELOPMENT, INC.
100 W. ARCADE ST., SUITE 203, TAMPA, FL 33606
PH: 813-281-1000
WWW.CONRADINC.COM

DATE: 03/13/16
PROJECT: 16-0000000000
SHEET: 12 OF 12
SCALE: AS SHOWN



Approved: 03/13/16
Project: 16-0000000000
Sheet: 12 OF 12

CONRAD ENGINEERS & DEVELOPMENT, INC.
100 W. ARCADE ST., SUITE 203, TAMPA, FL 33606
PH: 813-281-1000
WWW.CONRADINC.COM

CONSTRUCTION NOTES.
 ① INSTALL SURVEY MONUMENT PER PAG STD. DTL. 103.
 ② INSTALL POST BARRICADE GALING PAG STD. DTL. 106.

NOTE
 1. ALL STATIONING IS ALONG CONSTRUCTION CENTER LINE

CONVE.	LENGTH	WIDTH	AREA	THICKNESS
C1	50.61	11.00	5.5671	18.50
C2	101.58	232.00	23553.16	84.27
C3	144.84	208.00	30128.32	75.55
C4	20.60	33.00	680.10	16.50
C5	153.20	220.00	33704.00	78.91
C6	17.17	28.00	480.76	12.00
C7A	103.13	42.00	4331.46	13.41

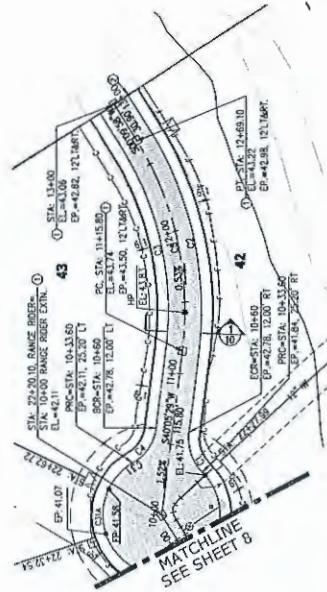

RANGE RIDER PLACE EXTENSION (PUBLIC STREET)



1-800-782-5348
 State Street Center

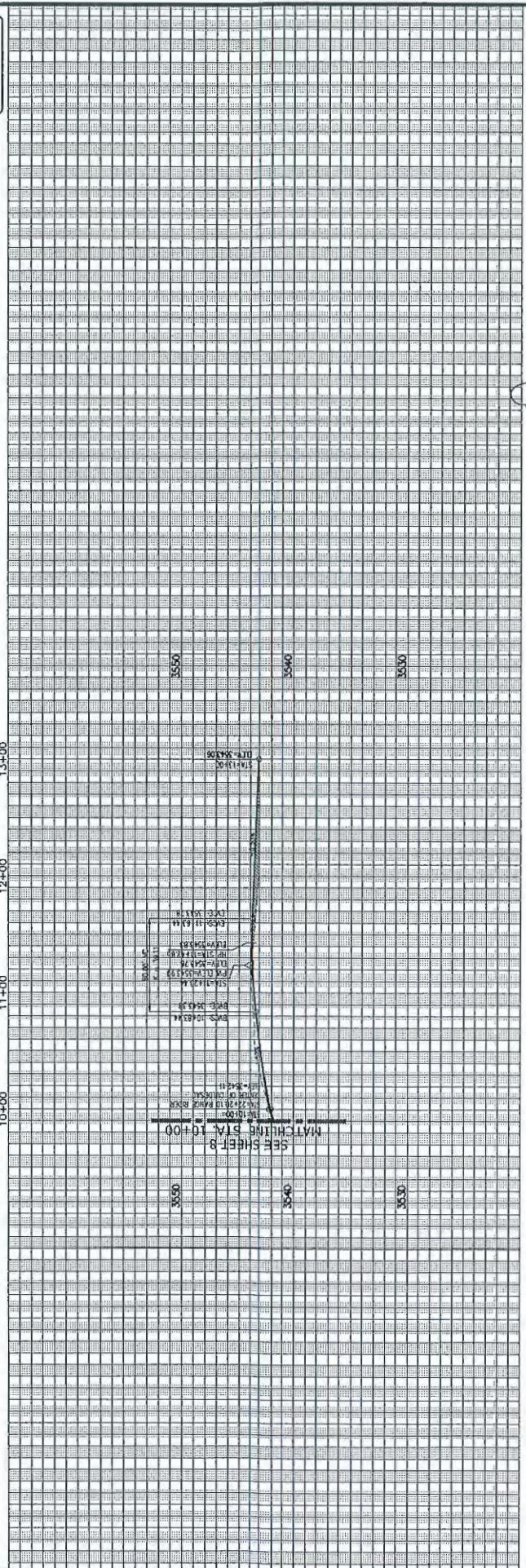

ANDRADA RANCH
 PAVING PLAN
 LOTS 1 THRU 74 & COMMON AREA "A"

Coronado Engineering & Development, Inc.
 1875 W. Pinalo Ave. Suite 202, Mesa, AZ 85205
 www.cedesign.com

DATE: 03-17
 DRAWN BY: [Name]
 CHECKED BY: [Name]
 PROJECT NO.: [Number]
 SHEET NO.: 9 OF 12



LINE	LENGTH	BEARING	LINE TABLE	CHWAVE TABLE	PIVOT POINT	ANGLE
C1	62.48	40.00	89°57'24"	40.00	89°57'24"	39.31
L1	529.34	40.00	90°00'00"	40.00	90°00'00"	40.37
L2	298.49	40.00	89°59'44"	40.00	89°59'44"	40.00
L3	31.14	50.00	50°00'00"	50.00	50°00'00"	40.00
L4	259.16	50.00	50°00'00"	50.00	50°00'00"	22.07
L5	439.14	50.00	50°00'00"	50.00	50°00'00"	38.31
L6	37.48	50.00	50°00'00"	50.00	50°00'00"	132.26
L7	30.00	50.00	50°00'00"	50.00	50°00'00"	132.26
L8	37.48	50.00	50°00'00"	50.00	50°00'00"	132.26
L9	342.57	50.00	50°00'00"	50.00	50°00'00"	132.26
L10	127.88	40.00	89°59'44"	40.00	89°59'44"	38.31
L11	127.88	40.00	89°59'44"	40.00	89°59'44"	38.31
L12	127.88	40.00	89°59'44"	40.00	89°59'44"	38.31
L13	66.31	40.00	89°59'44"	40.00	89°59'44"	38.31

LINE	LENGTH	BEARING
L1	529.34	40.00
L2	298.49	40.00
L3	31.14	50.00
L4	259.16	50.00
L5	439.14	50.00
L6	37.48	50.00
L7	30.00	50.00
L8	37.48	50.00
L9	342.57	50.00
L10	127.88	40.00
L11	127.88	40.00
L12	127.88	40.00
L13	66.31	40.00

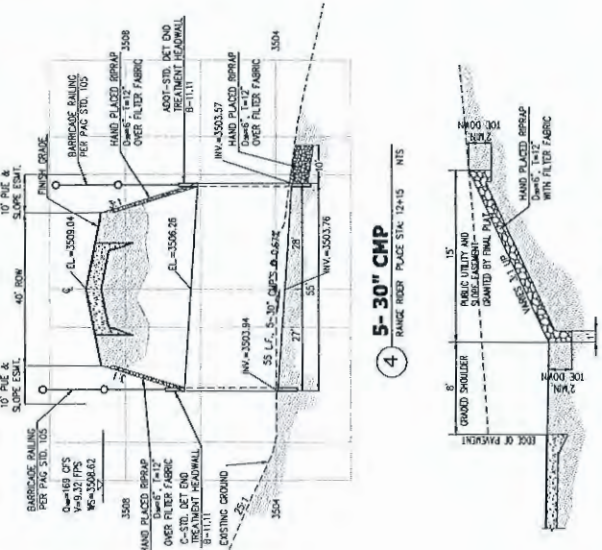

4 5-30' CMP
RANGE RIDER PLACED STA: 12+10 NTS

6 SLOPE PROTECTION
SEE PLAN FOR LOCATION
NTS

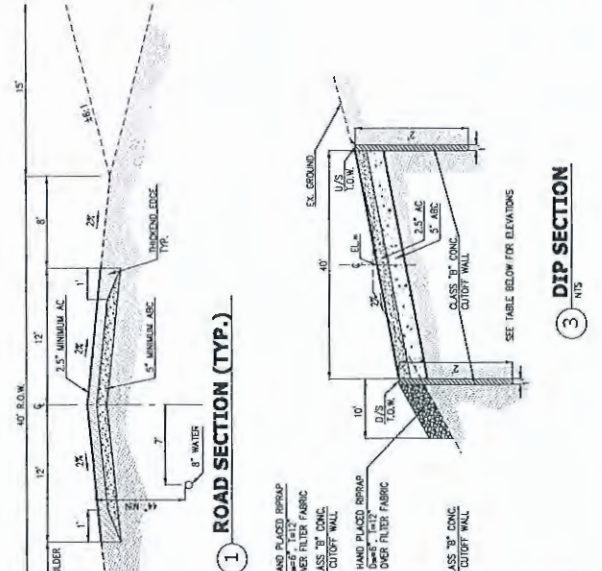

1 ROAD SECTION (TYP.)

3 DIP SECTION
SEE TABLE BELOW FOR ELEVATIONS
NTS

STREET NAME	DIP SECTION	STATION	ELEVATIONS	TOP OF WALL
BLOSSOMING PLACE	13+71.46 - 5' RT	91.84	92.34	91.54
BLADING SHOULDER	11+05.08 - 0' RT	96.48	95.85	95.00
BLADING SHOULDER	28+27.85 - 0' RT	93.80	94.20	93.40
CATTLE HANG DR.	11+07.92 - 0' RT	93.80	94.20	93.40

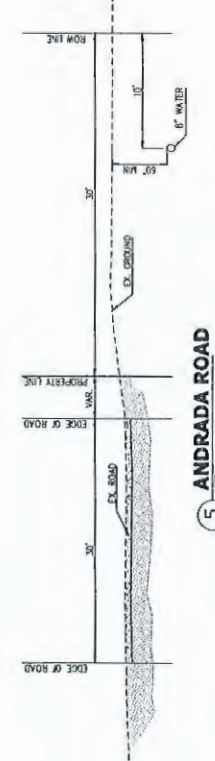

5 ANDRADA ROAD
NTS

AS NOTED
DATE: 03-17
BY: [Signature]
CHECKED BY: [Signature]
DESIGNED BY: [Signature]

PROJECT NO. P180200045
SHEET NO. 10 OF 12

ANDRADA RANCH
PAVING PLAN
LOTS 1 THRU 74 & COMMON AREA "A"

Contract Engineering & Development, Inc.
1870 W. Pinedale Rd., Suite 205, Yukon, AZ 85375
www.contracteng.com

DETAILS & CURVE TABLE

CONTRACT ENGINEERING & DEVELOPMENT, INC. 1870 W. PINEDALE RD., SUITE 205, YUKON, AZ 85375
www.contracteng.com