

Pima County Clerk of the Board

Robin Brigode

Mary Jo Furphy
Deputy Clerk

Administration Division
130 W. Congress, 5th Floor
Tucson, AZ 85701
Phone: (520)724-8449 • Fax: (520) 222-0448

Document and Micrographics Mgt. Division
1640 East Benson Highway
Tucson, Arizona 85714
Phone: (520) 351-8454 • Fax: (520) 351-8456

October 16, 2013

Mr. Brian E. Metzger
The Abbey
6960 E. Sunrise Drive, No. 110
Tucson, AZ 85750

RE: Application for Extension of Premises/Patio Permit
License No.: 12104075
The Abbey
Permanent Change

Dear Mr. Metzger:

Notice is hereby given that the Pima County Board of Supervisors will hold a hearing in reference to the above Extension of Premises/Patio Permit application. Please be advised that the hearing has been scheduled for Tuesday, November 5, 2013, at 9:00 a.m. or thereafter, to be held at the following location:

Pima County Administration Building
Board of Supervisors Hearing Room
130 West Congress, 1st Floor
Tucson, Arizona 85701

If you have any questions pertaining to this hearing, please contact this office at (520)724-8449.

Sincerely,

Robin Brigode
Robin Brigode
Clerk of the Board

ARIZONA DEPARTMENT OF LIQUOR LICENSES & CONTROL

800 W Washington 5th Floor
Phoenix AZ 85007-2934
www.azliquor.gov
(602) 542-5141

Date payment received _____

CSR Initials _____

APPLICATION FOR EXTENSION OF PREMISES/PATIO PERMIT

THIS APPLICATION MUST BE RETURNED TO THE DEPARTMENT OF LIQUOR

- ☒ Permanent change of area of service. A non-refundable \$50 fee will apply. Specific purpose for change: _____
- ☐ Temporary change for date(s) of: ____/____/____ through ____/____/____ List specific purpose for change: _____

1. Licensee's Name: Metzger, Brian E
2. Mailing Address: 6960 E Sunrise Dr #110 Tucson, AZ 85750
3. Business Name: The Abbey LICENSE #: 12104075
4. Business Address: 6960 E Sunrise Dr #110 Tucson Pima AZ 85750
5. Business Phone: (520) 299-3132 Residence Phone: (520) 248-9620
6. Do you understand Arizona Liquor Laws and Regulations? ☒ YES ☐ NO Fax #: (520) 299-3134
7. Have you received approved Liquor Law Training? ☐ NO ☒ YES If so, when does your Certificate expire? 11/16/13
8. What security precautions will be taken to prevent liquor violations in the extended area? Fence
- Does this extension bring your premises within 300 feet of a church or school? ☐ YES ☒ NO
10. IMPORTANT: ATTACH THE REVISED FLOOR PLAN CLEARLY DEPICTING YOUR LICENSED PREMISES AND WHAT YOU PROPOSE TO ADD.

- ☐ Barrier Exemption: an exception to the requirement of barriers surrounding a patio/outdoor serving area may be requested. Barrier exemptions are granted based on public safety, pedestrian traffic, and other factors unique to a licensed premises. List specific reasons for exemption: _____

Investigation Recommendation ☐ Approval ☐ Disapproval by: _____ Date: ____/____/____

****After completing sections 1-10, please take this application to your local Board of Supervisors, City Council or Designate for their recommendation. This recommendation is not binding on the Department of Liquor.

This change in premises is RECOMMENDED by the local Board of Supervisors, City Council or Designate:

(Authorized Signature)

(Title)

(Agency)

I, Brian E. Metzger, being first duly sworn upon oath, hereby depose, swear and declare,

(Print full name)
under penalty of perjury, that I am the APPLICANT making the foregoing application. I have read this application and the contents and all statements are true, correct and complete.

State of Arizona County of Pima

SUBSCRIBED IN MY PRESENCE AND SWORN TO before me this date

(Signature of Owner or Agent)

Day

Month

Year

My commission expires on: 11/14/15



RJ Evans
Notary Public
Pima County, Arizona
My Comm. Expires 11-14-15

(Signature of NOTARY PUBLIC)

Investigation Recommendation ☐ Approval ☐ Disapproval by: _____ Date: ____/____/____

Director Signature required for Disapprovals _____ Date: ____/____/____

12/26/2012 *Disabled individuals requiring special accommodation, please call the Department(602) 542-9027.

The Abbey
6960 E SUNRISE DR.
TULSON, AZ 85750

Aprox sq ft = 300
added seats = 21

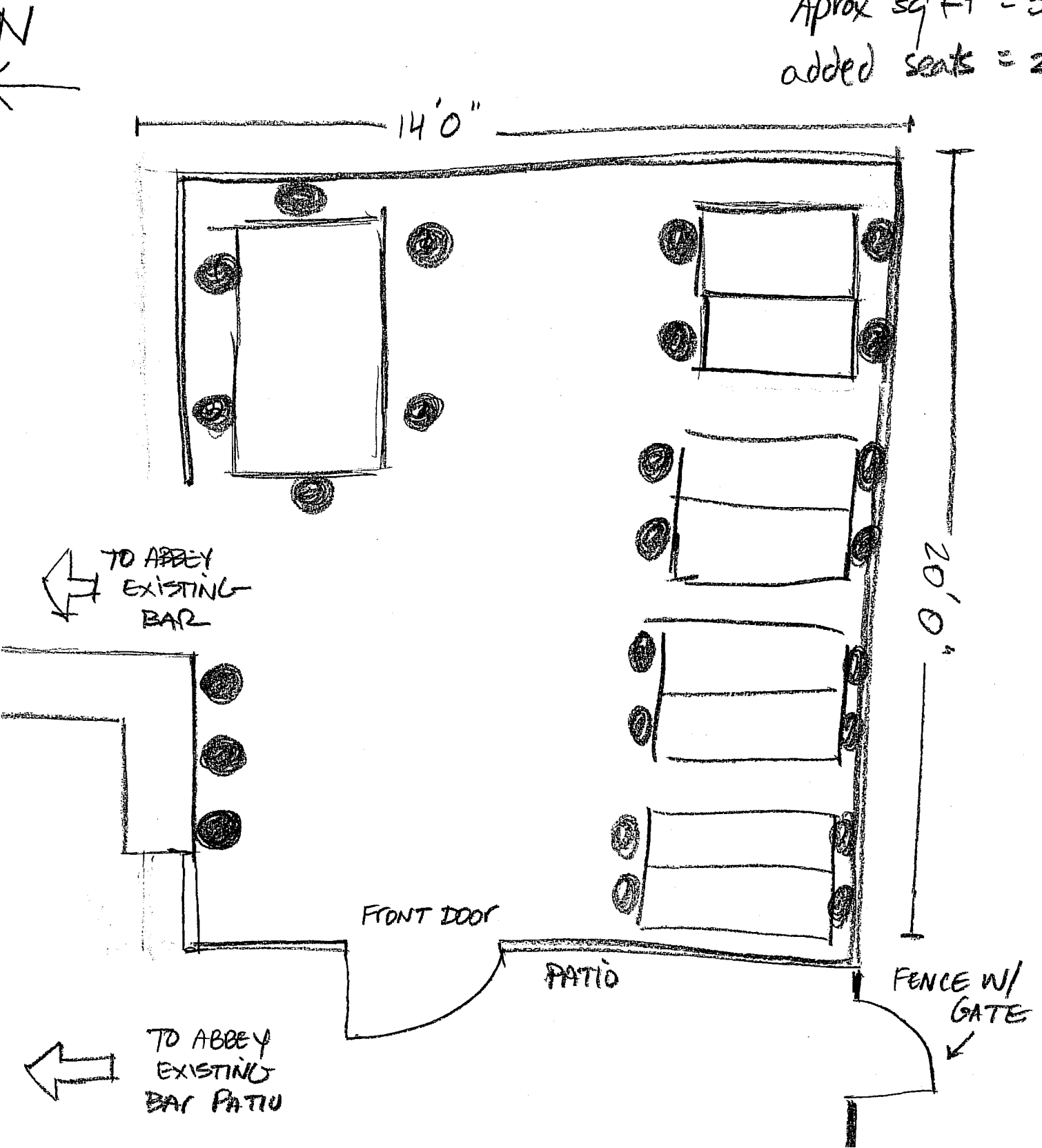



Pima County Clerk of the Board

Robin Brigode

Mary Jo Furphy
Deputy Clerk

Administration Division
130 W. Congress, 5th Floor
Tucson, AZ 85701
Phone: (520) 724-8449 • Fax: (520) 222-0448

Document and Micrographics Mgt. Division
1640 East Benson Highway
Tucson, Arizona 85714
Phone: (520) 351-8454 • Fax: (520) 351-8456

TO: Development Services, Zoning Division

FROM: Katrina Martinez *KM*,
Administrative Support Specialist

DATE: October 9, 2013

RE: Zoning Report - Permanent Extension of Premises/Patio Permit

Attached find the application of:

Brian E. Metzger
d.b.a. The Abbey
6960 E. Sunrise Drive, No. 110
Tucson, AZ 85750

ZONING REPORT

DATE: 10/15/13

Will current regulations permit the issuance of the permanent extension of premises/patio permit at this location?

Yes ☒ No ☐

If No, please explain:

[Signature]
Pima County Zoning Inspector

00151370215 PCC CLK-J-BD (4)