

# Pima County Clerk of the Board

Robin Brigode

Mary Jo Furphy  
Deputy Clerk

Administration Division  
130 W. Congress, 5<sup>th</sup> Floor  
Tucson, AZ 85701  
Phone: (520) 724-8449 • Fax: (520) 222-0448

Document and Micrographics Mgt. Division  
1640 East Benson Highway  
Tucson, Arizona 85714  
Phone: (520) 351-8454 • Fax: (520) 351-8456

April 4, 2013

Mr. Ricky Lynn Riddle  
Bear Track Winery  
4743 E. Sunrise Drive  
Tucson, AZ 85718

RE: Application for Wine Festival License  
License No.: 13103005  
Bear Track Winery  
Temporary Change for May 10 and 11, 2013

Dear Mr. Riddle:

Notice is hereby given that the Pima County Board of Supervisors will hold a hearing in reference to the above Wine Festival License application. Please be advised that the hearing has been scheduled for Tuesday, April 16, 2013, at 9:00 a.m. or thereafter, to be held at the following location:

Pima County Administration Building  
Board of Supervisors Hearing Room  
130 West Congress, 1st Floor  
Tucson, Arizona 85701

If you have any questions pertaining to this hearing, please contact this office at (520) 724-8449.

Sincerely,

A handwritten signature in cursive script that reads "Robin Brigode".

Robin Brigode  
Clerk of the Board

c: Sheriff's Dept., Investigative Support Unit Division

State of Arizona Department of Liquor Licenses and Control  
800 W. Washington, 5th Floor  
Phoenix, AZ 85007  
www.azliquor.gov  
(602)542-5141

**APPLICATION FOR WINE FESTIVAL LICENSE/WINE FAIR LICENSE**

FEE = \$15.00 per event

A service fee of \$25.00 will be charged for all dishonored checks (A.R.S. 44-6852)

A separate license is needed when days are not consecutive. Only twenty-five (25) licenses per calendar year for up to seventy-five calendar days may be issued, excluding sanctioned county or state fair licenses.

1. Applicant's Name: Riddle Ricky Lynn  
Last First Middle
2. Business Name: BEAR TRACK Winery D.F.W. Lic#: 13103005  
(Domestic Farm Winery License #)
3. Location of Festival: 4743 E Sunrise Tucson Pima 85718  
(Physical location - Do not use PO Box) City County Zip
4. Mailing Address: 4743 E Sunrise Tucson Az 85718  
City State Zip

5. Date and hours of festival:

DATE	DAY OF WEEK	HOURS FROM	HOURS TO
<u>5-10-13</u>	<u>Fri.</u>	<u>5</u> a.m./ <u>p.m.</u>	<u>10</u> a.m./ <u>p.m.</u>
<u>5-11-13</u>	<u>SAT</u>	<u>12</u> a.m./ <u>p.m.</u>	<u>10</u> a.m./ <u>p.m.</u>
_____	_____	_____ a.m./p.m.	_____ a.m./p.m.
_____	_____	_____ a.m./p.m.	_____ a.m./p.m.
_____	_____	_____ a.m./p.m.	_____ a.m./p.m.
_____	_____	_____ a.m./p.m.	_____ a.m./p.m.
_____	_____	_____ a.m./p.m.	_____ a.m./p.m.
_____	_____	_____ a.m./p.m.	_____ a.m./p.m.
_____	_____	_____ a.m./p.m.	_____ a.m./p.m.
_____	_____	_____ a.m./p.m.	_____ a.m./p.m.
_____	_____	_____ a.m./p.m.	_____ a.m./p.m.

6. Name and address of site owner: Romano Bruce \_\_\_\_\_  
Last First Middle
- 3900 E VIA PALOMITA Tucson Az 85718  
Address City State Zip
7. Phone Numbers: (520) 577-1000 (520) 975-0050 (575) 937-1299  
Site Owner Applicant's Business Applicant's Residence

\* Disabled individuals requiring special accommodation, please call (602) 542-9027.

WINE FESTIVAL/FAIR LICENSED PREMISES DIAGRAM

(This diagram must be completed with this application)

NOTE: Show nearest cross streets, highway, or road if location doesn't have an address.  
(Show dimensions, serving areas, and label type of enclosure and security positions)

N↑

See  
Attached

DEAR  
EXTENSION DIAGRAM

7

LICENSED  
PREMISES

SEALED  
OFF w/  
ORANGE  
Fence  
ENCLOSURE

CONSENTED  
AREA

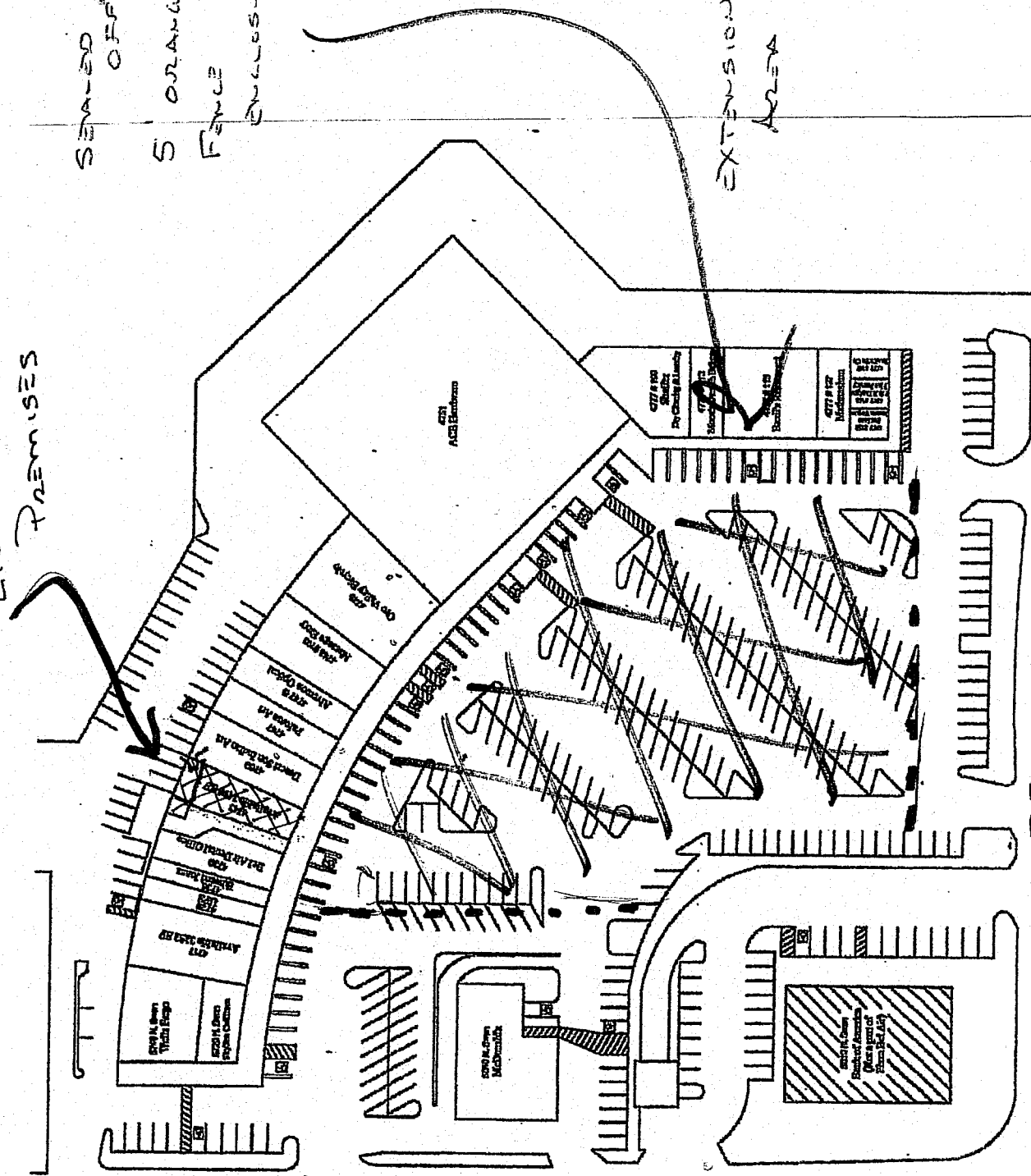

SUNRISE DRIVE

N 3 4 2

N 0 4 2

8. Has the festival site owner given permission for use of the site and for the sale of spirituous liquors? YES ☒ NO ☐

9. Are the spirituous liquors to be sold or served Arizona Domestic Farm Winery Products **ONLY**? YES ☒ NO ☐

10. How many wine festival licenses have you applied for this calendar year, including this one? 0

Give the total number of days you have held licensed wine festivals this year 0

11. What security and control measures will you take to prevent violations of state liquor laws at this event?  
(List type and number of security/police personnel and type of fencing or control barriers if applicable)

2 # Police ☐ Fencing  
4 # Security personnel ☒ Barriers

12. Your licensed premises is that area in which you are authorized to sell, dispense, or serve spirituous liquors under the provisions of your license. The following page is to be used to prepare a diagram of your wine festival/fair licensed premises. Please show dimensions, serving areas, fencing, barricades or other control measures and security positions.

I, Ricky Lynn Rodden, hereby declare that I am the APPLICANT filing this application. I  
(Print full name)  
have read the application and the contents and all statements are true, correct and complete.

X [Signature]  
(Signature of APPLICANT)

State of Arizona County of Pima  
The foregoing instrument was acknowledged before me this

3 day of April, 2013  
Day Month Year

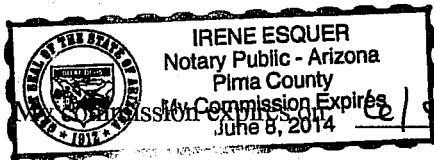

[Signature]  
(Signature of NOTARY PUBLIC)

\*\*\* FOR USE BY LOCAL GOVERNING AUTHORITY ONLY \*\*\*

I, \_\_\_\_\_, hereby ☐ APPROVE ☐ DISAPPROVE this application on behalf of  
(Government Official)

\_\_\_\_\_  
(City, Town, or County) (Title) X (Signature of OFFICIAL)

\*\*\* FOR USE BY DLLC ONLY \*\*\*

☐ APPROVED ☐ DISAPPROVED

By: \_\_\_\_\_ Date: \_\_\_\_\_