



BOARD OF SUPERVISORS AGENDA ITEM REPORT

Requested Board Meeting Date: 7/25/2023

**= Mandatory, information must be provided*

Click or tap the boxes to enter text. If not applicable, indicate "N/A".

***Title:**

Right-of-Way Dedications on Ruthrauff Road and Wetmore Roads

***Introduction/Background:**

Quit Claim deeds will be recorded for the sole purpose of designating specific portions of Pima County property as public road right-of-way, as shown on the attached Location Map. File #PR-0310.

***Discussion:**

Pima County originally acquired parcels from 1986 to 2004 as part of the Ruthrauff/Wetmore Road Capital Improvement Project. At the time of the Project, the parcels acquired for the roadway were never separated to define the limits of the roadway. In order to establish the limits of the right-of-way for Ruthrauff/Wetmore Roads, deeds will need to be recorded to separate the right-of-way from the remainder of the parcels as shown on the attached Location Map. The process of conveying from the County to the County follows the customary method of splitting the property, which is required by the Assessor's Office in order to distinguish the new public right-of-way being dedicated.

***Conclusion:**

This right-of-way dedication request has been reviewed and approved by appropriate County staff. Recording a Quit Claim deed will create a new public right-of-way necessary for the County. Additionally, a formal establishment proceeding will be completed by PCDOT following dedication of the right-of-way.

***Recommendation:**

Staff recommends approval of the needed right-of-way conveniences. Upon approval, Staff will record a Quit Claim deed for each parcel as needed.

***Fiscal Impact:**

None

***Board of Supervisor District:**

☐ 1 ☐ 2 ☒ 3 ☐ 4 ☐ 5 ☐ All

Department: Real Property Services

Telephone: 724-6633

Contact: Dante Olono

Telephone: 724-6624

Department Director Signature: _____

Date: _____

Deputy County Administrator Signature: _____

Date: _____

County Administrator Signature: _____

Date: _____

Location Map

SECTION 22
TOWNSHIP 13 SOUTH
RANGE 13 EAST

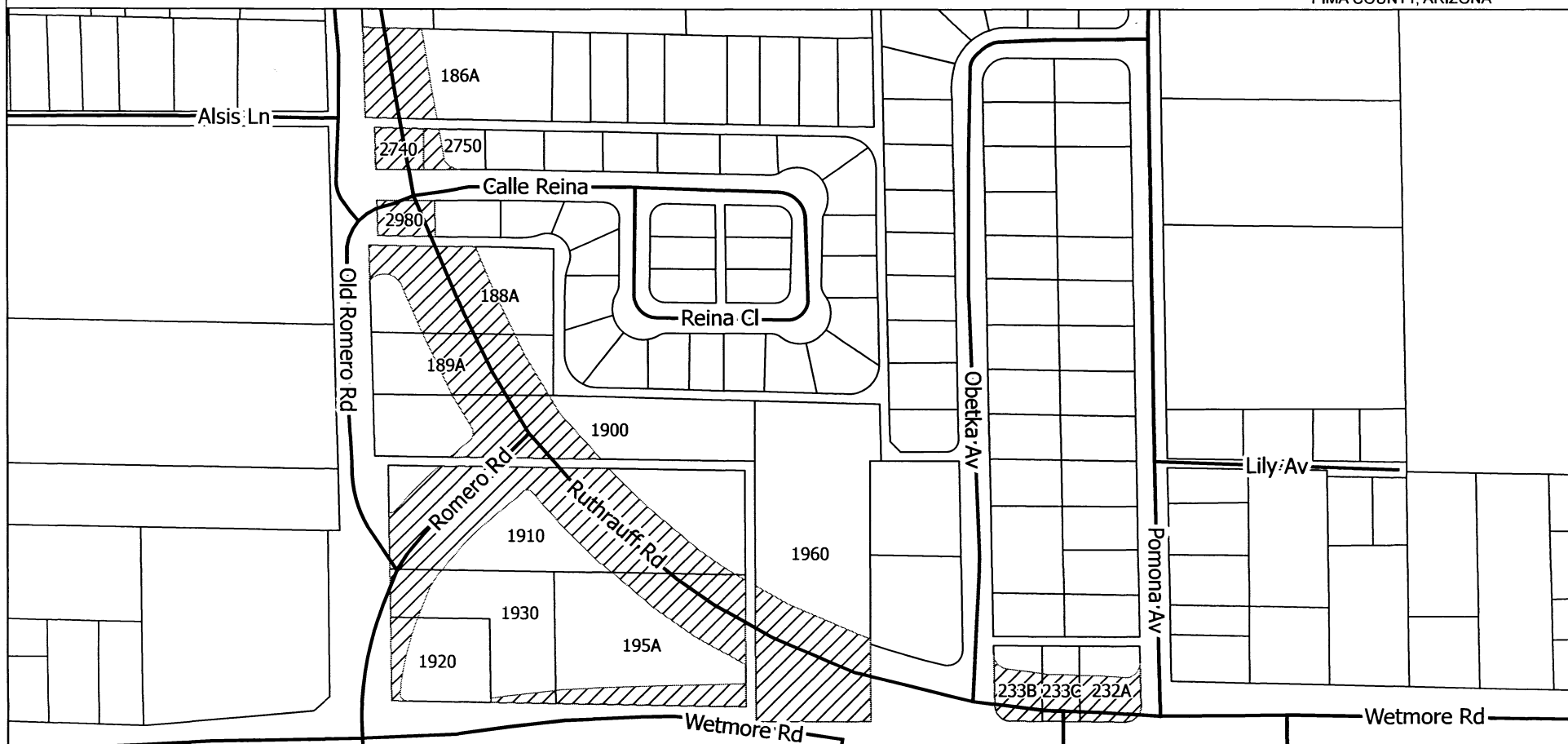
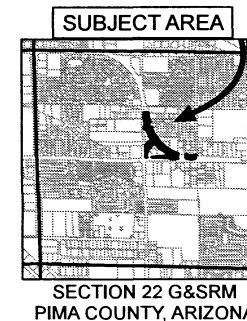

23078

**PIMA COUNTY DEPARTMENT OF TRANSPORTATION
ENGINEERING INFORMATION MANAGEMENT**

DRAWING NOT TO SCALE

DRAWN BY: C BARNETT

DATE: JUN 2023

LEGEND

 Right-of-way