

**BOARD OF SUPERVISORS AGENDA ITEM SUMMARY**

Requested Board Meeting Date: November 19, 2013  
TRANSPORTATION AGENDA

---

ITEM SUMMARY, JUSTIFICATION and/or SPECIAL CONSIDERATIONS:

**Seeking permission to advertise on December 6, and December 13, 2013.**

Establishment of public road, this road being:

Magee Road  
Road Establishment No. 3017  
Ally Miller - District 1

Hearing Date: December 17, 2013

The purpose of Road Proceeding No. 3017 is to establish a segment of road right-of-way along the intersection of Magee Road at La Cholla Boulevard. This establishment would reflect the intersection improvements completed under Pima County roadway project number 4TLCHM and Project Name: "Intersection Improvements: La Cholla Blvd/Magee Road (North and South Intersections)."

**Seeking Permission to Advertise**

CONTRACT NUMBER (If applicable)

---

STAFF RECOMMENDATION(S): The Transportation Department recommends that the Board of Supervisors approve permission to advertise.

---

CLERK OF THE BOARD USE ONLY BOS MTG. \_\_\_\_\_  
ITEM NO. \_\_\_\_\_

PIMA COUNTY COST: \$ Minimal and/or REVENUE TO PIMA COUNTY \$ \_\_\_\_\_

FUNDING SOURCE(S): \_\_\_\_\_  
(i.e. General Fund, State Grant Fund, Federal Fund, Stadium District Fund, etc.)

ADVERTISED PUBLIC HEARING: YES NO X

BOARD OF SUPERVISORS DISTRICT: 1 X 2 3 4 5 All

IMPACT:

IF APPROVED:

Will proceed to advertise on: December 6 and December 13, 2013.

IF DENIED:

Will not advertise and will not pursue establishment of road and there will not be a clear delineation of road right-of-way along the intersection of Magee Road at La Cholla Boulevard.

---

DEPARTMENT NAME: Transportation

CONTACT PERSON: Claire Logue

TELEPHONE NO.: 724-6332 ext: 6737

DEPARTMENT DIRECTOR: 

DATE: 10/21/13

---



DEPARTMENT OF TRANSPORTATION  
201 NORTH STONE AVENUE, FOURTH FLOOR  
TUCSON, ARIZONA 85701-1207

PRISCILLA S. CORNELIO, P. E.  
DIRECTOR

(520) 724-6410  
FAX (520) 724-6439

PETITION FOR PUBLIC HIGHWAY  
PROCEEDING NO. 3017

Honorable Board of Supervisors  
Pima County, Arizona

Honorable members of the Board of Supervisors:

The undersigned, being residents and taxpayers of Pima County, respectfully petition that the road as described herein be established and declared a county highway.

The establishment of said road(s) to be Varies in width.

The road to be known as Magee Road or Road No. 3017.

Dated at Tucson, Arizona, this 3 day of Oct., 2013

	<u>PRINT NAME</u>	<u>SIGNATURE</u>	<u>ADDRESS</u>	<u>ZIP CODE</u>
1.	Clarisa R. Lopez	C.R. Lopez	4760 N. Bamboo Cir.	85749
2.	GAIL TEBOCKHORST	Gail Tebockhorst	8420 E. Brookside Lane	85710
3.	LINDA SAALENAGA	Linda Saalenaga	4601 S. CAMINO DE OESTE	85746
4.	Robert Young	Robert Young	835 W. Calle Ranunculo	85704
5.	Jonathan Crowe	Jonathan Crowe	939 N. 9th Ave	85705
6.	MATT ZOLL	M. Zoll	4010 E. Palomar Dr.	85711
7.	SANDRA R Butler	Sandra R Butler	7195 S Monks Tale Dr	85756
8.	Leticia Haros	Leticia Haros	182 W. Calle Nido Amor	85706
9.	SUSAN VOS	Susan Vos	1890 W Moonshadow St.	85737
10.	Diana Torres	Diana Torres	5764 S. Helena Strav.	85706

## NOTICE OF PUBLIC HEARING

### PIMA COUNTY BOARD OF SUPERVISORS

Notice is hereby given that the Pima County Board of Supervisors will hold a public hearing for the proposed Establishment of Magee Road this county road is situated within portion of Section 33, T12S, R13E, Gila and Salt River Meridian, Pima County, Arizona. MORE PARTICULARLY DESCRIBED AS FOLLOWS:

#### SEE EXHIBIT "A"

The public hearing for the Establishment of this road will be held on **Tuesday, December 17<sup>th</sup>, 2013 at 9:00 A.M.**, or thereafter, located at the Pima County Administration Building, Board of Supervisors Hearing Room, 130 West Congress, 1<sup>st</sup> Floor, Tucson, Arizona.

A copy of the proposed Establishment for the aforementioned road can be obtained at the Pima County Department of Transportation, EIM/Mapping and Records; 201 North Stone Avenue, 5<sup>th</sup> Floor or by calling (520) 724-6332.

Dated this 21<sup>st</sup> day of October, 2013



Priscilla S. Cornelio, P.E., Director  
Pima County Department of Transportation

Published: Daily Territorial  
December 6<sup>th</sup> and December 13<sup>th</sup>, 2013





Pima County  
Survey

16 September 2013

**EXHIBIT "A"**  
**LEGAL DESCRIPTION**  
**ESTABLISHMENT PROCEEDINGS NUMBER 3017**  
**MAGEE ROAD**

A portion of Camino Del Sol Amended, a subdivision recorded in Book 33 of Maps and Plats at Page 78, together with portions of Lot 5 and Common Area "B" of Magee Center, a subdivision recorded in Book 56 of Maps and Plats at Page 94, recorded in the office of the County Recorder, Pima County, Arizona, and being within the northeast quarter of Section 33, Township 12 South, Range 13 East, Gila and Salt River Meridian, Pima County, Arizona more particularly described as follows:

**COMMENCING** at the northeast corner of said Section 33, to which the east quarter corner of said Section 33 bears South 00°38'37" East a distance of 2,641.74 feet;

**THENCE** along the east line of Section 33 South 00°38'37" East a distance of 1,320.66 feet;

**THENCE** South 89°21'23" West a distance of 75.00 feet to the west right of way line of La Cholla Boulevard and the **POINT OF BEGINNING**;

**THENCE** along said right of way line South 00°38'37" East a distance of 298.70 feet to the beginning of a tangent curve concave to the northwest having a radius of 25.00 feet and a central angle of 90°08'02";

**THENCE** along the arc of said curve to the right a distance of 39.33 feet to a point of tangency on the north right of way line of Magee Road;

**THENCE** along said north right of way line South 89°29'25" West a distance of 599.79 feet;

**THENCE** North 74°10'52" East a distance of 298.37 feet to the beginning of a non-tangent curve concave to the northwest and having a radius of 925.00 feet and a central angle of 19°53'12" to which a radial line bears South 24°18'43" East;

**THENCE** along the arc of said curve to the left a distance of 321.06 feet to a point of tangency;

**THENCE** North  $45^{\circ}48'05''$  East a distance of 97.75 feet to the **POINT OF BEGINNING**.

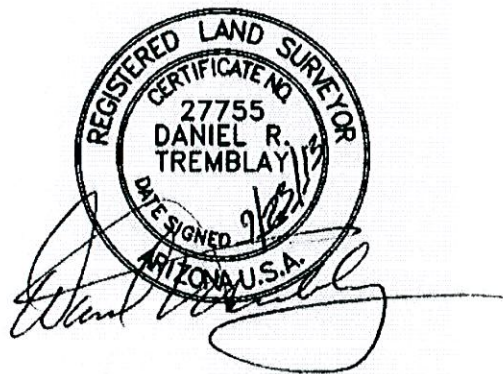

**Expires 31 March 2015**

# MAGEE/LA CHOLLA DEPICTION OF EXHIBIT "A"

SECTION 33  
TOWNSHIP 12 SOUTH  
RANGE 13 EAST

SUBJECT AREA

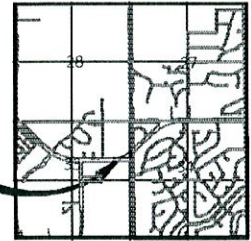

SECTION 33 G&SRM  
PIMA COUNTY, ARIZONA

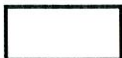
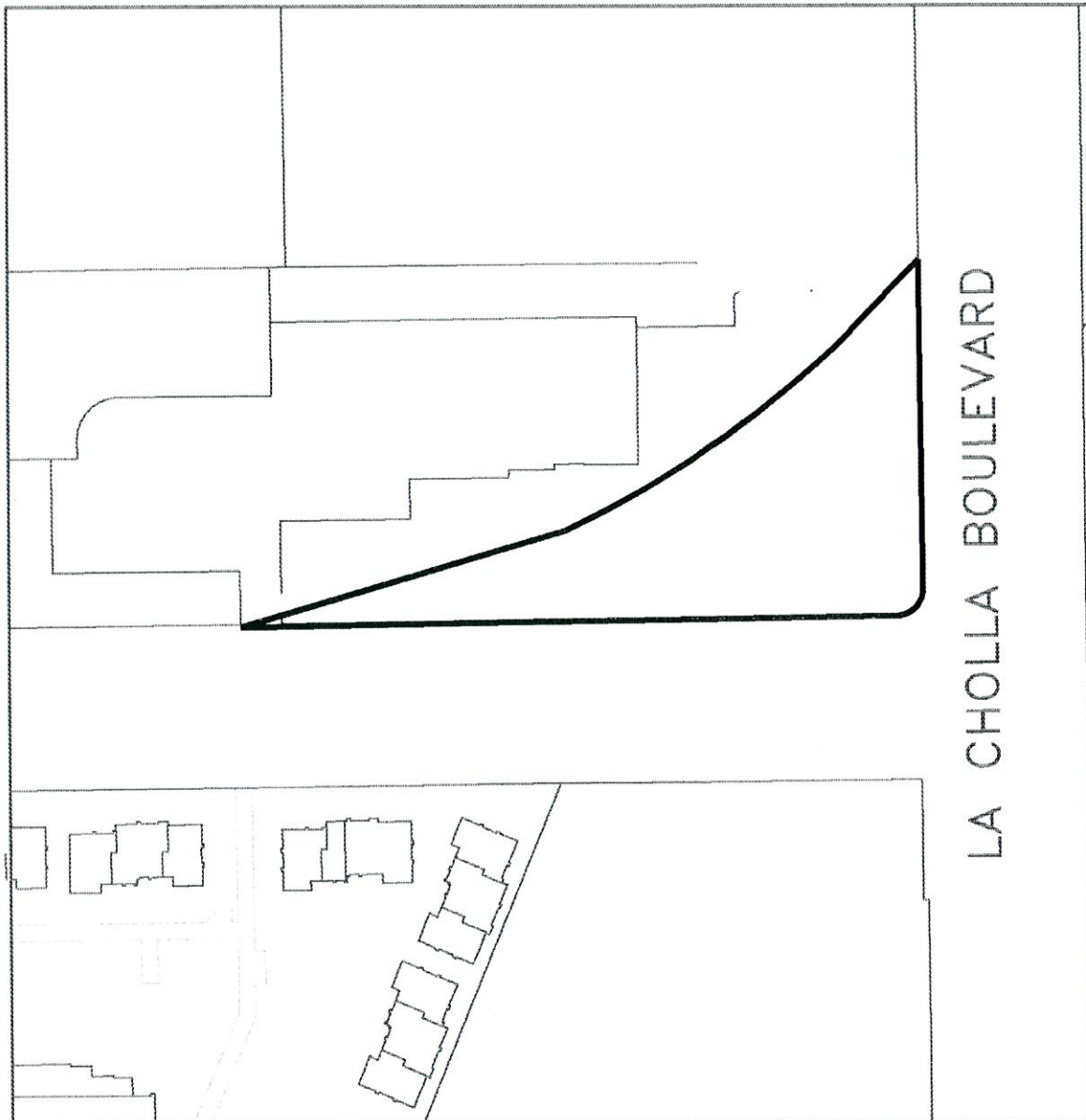

MAGEE/LA CHOLLA ESTABLISHMENT #3017

N



3017

PIMA COUNTY DEPARTMENT OF TRANSPORTATION  
ENGINEERING INFORMATION MANAGEMENT

DRAWING NOT TO SCALE

DRAWN BY: SRBUTLER

DATE: JUNE 2013