

**Mary Jo Furphy**  
Deputy Clerk

# Pima County Clerk of the Board

Robin Brigode

Administration Division  
130 W. Congress, 5<sup>th</sup> Floor  
Tucson, AZ 85701  
Phone: (520)724-8449 • Fax: (520) 222-0448

Document and Micrographics Mgt. Division  
1640 East Benson Highway  
Tucson, Arizona 85714  
Phone: (520) 351-8454 • Fax: (520) 351-8456

November 20, 2013

Mr. Mark Bradford Cave  
Arizona Stronghold Vineyards  
17235 N. 75th Ave., Suite D-145  
Glendale, AZ 85308

RE: Application for Wine Festival License  
License No.: 13133015  
Arizona Stronghold Vineyards  
Temporary Change for December 14, 2013 from 3:00 p.m. to 8:30 p.m.

Dear Mr. Cave:

Notice is hereby given that the Pima County Board of Supervisors will hold a hearing in reference to the above Wine Festival License application. Please be advised that the hearing has been scheduled for Tuesday, December 3, 2013, at 9:00 a.m. or thereafter, to be held at the following location:

Pima County Administration Building  
Board of Supervisors Hearing Room  
130 West Congress, 1st Floor  
Tucson, Arizona 85701

If you have any questions pertaining to this hearing, please contact this office at (520)724-8449.

Sincerely,

  
Robin Brigode  
Clerk of the Board

c: Sheriff's Dept., Investigative Support Unit Division



8. Has the festival site owner given permission for use of the site and for the sale of spirituous liquors? YES ☒ NO ☐

9. Are the spirituous liquors to be sold or served Arizona Domestic Farm Winery Products **ONLY**? YES ☒ NO ☐

10. How many wine festival licenses have you applied for this calendar year, including this one? 21

Give the total number of days you have held licensed wine festivals this year 46

11. What security and control measures will you take to prevent violations of state liquor laws at this event?  
(List type and number of security/police personnel and type of fencing or control barriers if applicable)

0 # Police ☒ Fencing  
4 # Security personnel ☒ Barriers

There will be Security personnel at the entrants/exits checking IDs and ensuring wine does not leave the fenced area.

Additionally, we will have roaming Security personnel to ensure individuals are only entering the area at the designated entrants/exits points.

12. Your licensed premises is that area in which you are authorized to sell, dispense, or serve spirituous liquors under the provisions of your license. The following page is to be used to prepare a diagram of your wine festival/fair licensed premises. Please show dimensions, serving areas, fencing, barricades or other control measures and security positions.

I, Mark Bradford Cave, hereby declare that I am the APPLICANT filing this application. I  
(Print full name)

have read the application and the contents and all statements are true, correct and complete.

X MARK BRADFORD CAVE  
(Signature of APPLICANT)

State of Arizona County of Yavapai  
The foregoing instrument was acknowledged before me this

24 day of October, 2013  
Day Month Year

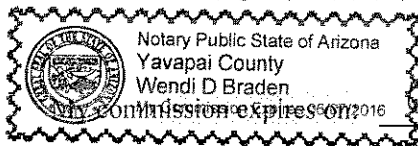

Wendy D. Braden  
(Signature of NOTARY PUBLIC)

\*\*\* FOR USE BY LOCAL GOVERNING AUTHORITY ONLY \*\*\*

I, \_\_\_\_\_, hereby ☐ APPROVE ☒ DISAPPROVE this application on behalf of  
(Government Official)

\_\_\_\_\_  
(City, Town, or County)

\_\_\_\_\_  
(Title)

X \_\_\_\_\_  
(Signature of OFFICIAL)

\*\*\* FOR USE BY DLLC ONLY \*\*\*

☐ APPROVED

☐ DISAPPROVED

By:

\_\_\_\_\_

Date:

\_\_\_\_\_

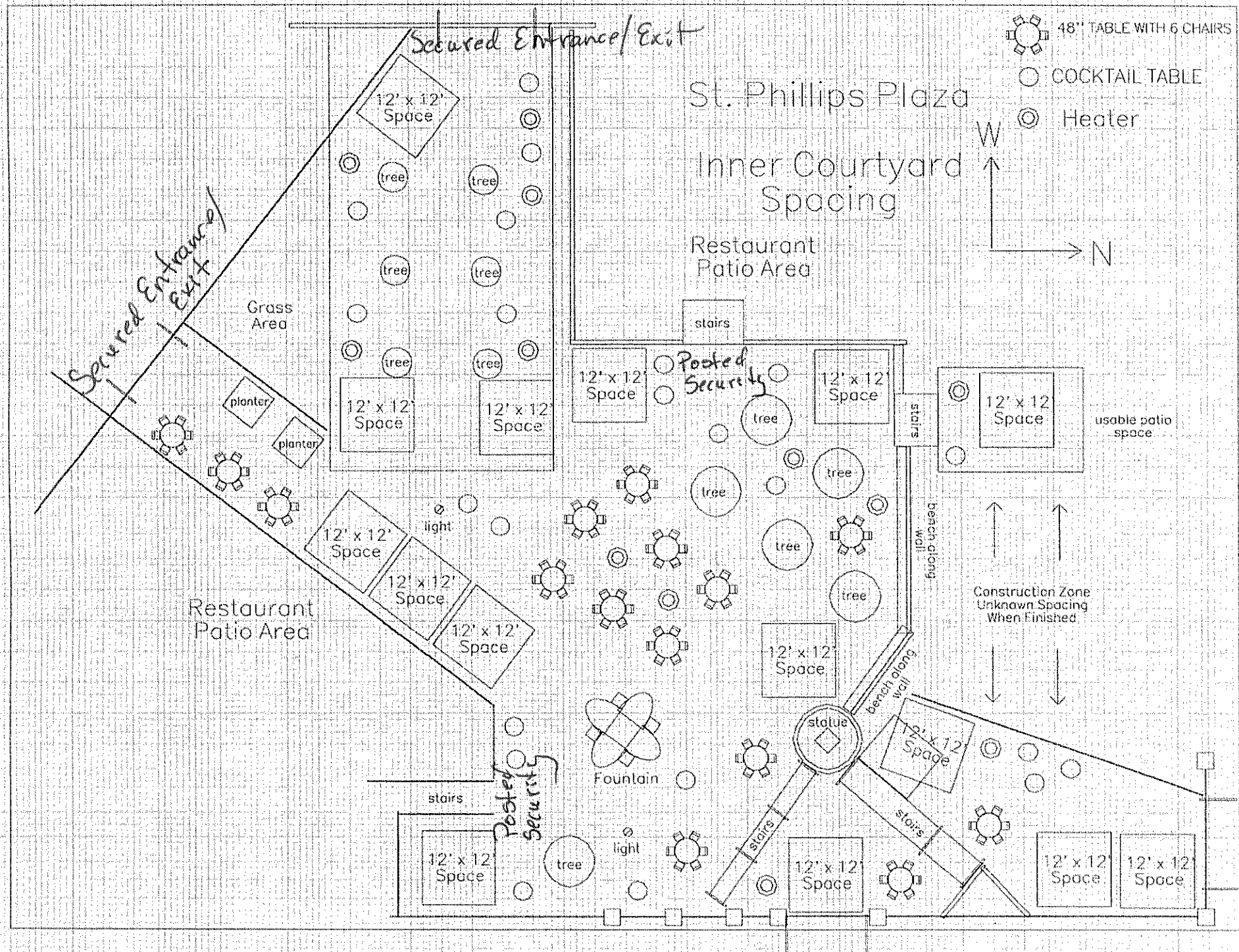

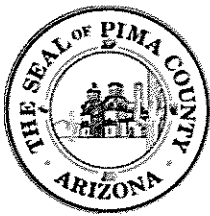

**Mary Jo Furphy**  
Deputy Clerk

# Pima County Clerk of the Board

Robin Brigode

Administration Division  
130 W. Congress, 5<sup>th</sup> Floor  
Tucson, AZ 85701  
Phone: (520)724-8449 • Fax: (520) 222-0448

Document and Micrographics Mgt. Division  
1640 East Benson Highway  
Tucson, Arizona 85714  
Phone: (520) 351-8454 • Fax: (520) 351-8456

November 20, 2013

Mr. Kent Allan Callaghan  
Callaghan Vineyards  
17235 N. 75th Ave., Suite D-145  
Glendale, AZ 85308

RE: Application for Wine Festival License  
License No.: 13123004  
Callaghan Vineyards  
Temporary Change for December 14, 2013 from 3:00 p.m. to 8:30 p.m.

Dear Mr. Callaghan:

Notice is hereby given that the Pima County Board of Supervisors will hold a hearing in reference to the above Wine Festival License application. Please be advised that the hearing has been scheduled for Tuesday, December 3, 2013, at 9:00 a.m. or thereafter, to be held at the following location:

Pima County Administration Building  
Board of Supervisors Hearing Room  
130 West Congress, 1st Floor  
Tucson, Arizona 85701

If you have any questions pertaining to this hearing, please contact this office at (520)724-8449.

Sincerely,

A handwritten signature in cursive script, appearing to read "Robin Brigode", is written over the typed name.

Robin Brigode  
Clerk of the Board

c: Sheriff's Dept., Investigative Support Unit Division

FEE = \$15.00 per event

A service fee of \$25.00 will be charged for all dishonored checks (A.R.S. 44-6852)

A separate license is needed when days are not consecutive. Only twenty-five (25) licenses per calendar year for up to seventy-five calendar days may be issued, excluding sanctioned county or state fair licenses.

calendar days may be issued, excluding sanctioned county or state fair licenses.

1. Applicant's Name: Callaghan Kent Allan  
Last First Middle

2. Business Name: Collaghan Vineyards D.F.W. Lic#: 13123004  
(Domestic Farm Winery License #)

3. Location of Festival:	4280 N. Campbell Ave., Ste 212	Tucson	Pima	85718
	(Physical location - Do not use PO Box)	City	County	Zip

4. Mailing Address:	17235 N. 75th Ave., Ste D-145	Glendale	AZ	85308
		City	State	Zip

5. Date and hours of festival:

[illegible]

6. Name and address of site owner:	Selby	Robert		
	Last	First	Middle	
	4280 N. Campbell Ave., Ste 212	Tucson	AZ	85718
	Address	City	State	Zip

7. Phone Numbers: (520) 529-2775 (520) 455-5322 (520) 444-5893  
Site Owner Applicant's Business Applicant's Residence

\* Disabled individuals requiring special accommodation, please call (602) 542-9027.

8. Has the festival site owner given permission for use of the site and for the sale of spirituous liquors? YES ☒ NO ☐

9. Are the spirituous liquors to be sold or served Arizona Domestic Farm Winery Products **ONLY**? YES ☐ NO ☐

10. How many wine festival licenses have you applied for this calendar year, including this one? 2

Give the total number of days you have held licensed wine festivals this year 2

11. What security and control measures will you take to prevent violations of state liquor laws at this event?  
(List type and number of security/police personnel and type of fencing or control barriers if applicable)

0 # Police ☒ Fencing  
4 # Security personnel ☒ Barriers

There will be Security personnel at the entrants/exits checking IDs and ensuring wine does not leave the fenced area.

Additionally, we will have roaming Security personnel to ensure individuals are only entering the area at the designated entrants/exits points.

12. Your licensed premises is that area in which you are authorized to sell, dispense, or serve spirituous liquors under the provisions of your license. The following page is to be used to prepare a diagram of your wine festival/fair licensed premises. Please show dimensions, serving areas, fencing, barricades or other control measures and security positions.

I, Rent Allan Callaghan, hereby declare that I am the APPLICANT filing this application. I  
(Print full name)  
have read the application and the contents and all statements are true, correct and complete.

X \_\_\_\_\_  
(Signature of APPLICANT)

State of Arizona County of Santa Cruz  
The foregoing instrument was acknowledged before me this

25th day of October, 2013  
Day Month Year

My commission expires on May 10, 2016

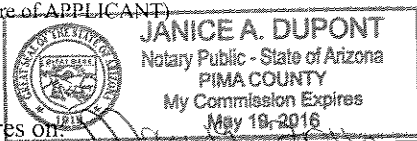

Janice A. Dupont  
(Signature of NOTARY PUBLIC)

\*\*\* FOR USE BY LOCAL GOVERNING AUTHORITY ONLY \*\*\*

I, \_\_\_\_\_, hereby ☐ APPROVE ☒ DISAPPROVE this application on behalf of  
(Government Official)

\_\_\_\_\_  
(City, Town, or County)

\_\_\_\_\_  
(Title)

X \_\_\_\_\_  
(Signature of OFFICIAL)

\*\*\* FOR USE BY DLLC ONLY \*\*\*

☐ APPROVED

☐ DISAPPROVED

By: \_\_\_\_\_

Date: \_\_\_\_\_

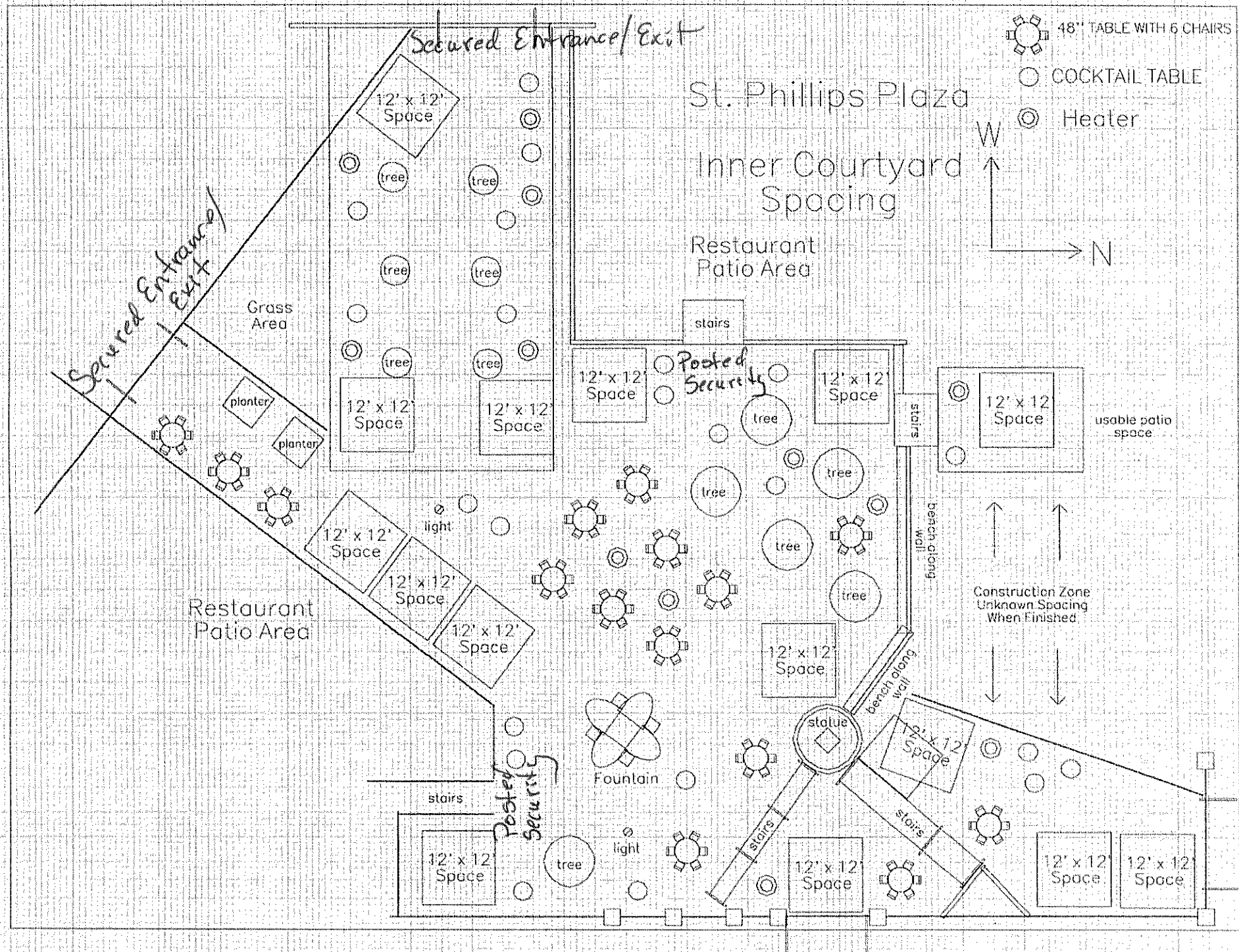



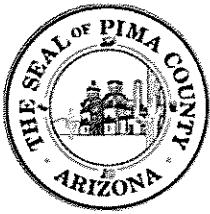

**Mary Jo Furphy**  
Deputy Clerk

# Pima County Clerk of the Board

Robin Brigode

Administration Division  
130 W. Congress, 5<sup>th</sup> Floor  
Tucson, AZ 85701  
Phone: (520)724-8449 • Fax: (520) 222-0448

Document and Micrographics Mgt. Division  
1640 East Benson Highway  
Tucson, Arizona 85714  
Phone: (520) 351-8454 • Fax: (520) 351-8456

November 20, 2013

Mr. Milton Elsworth Craig  
Charron Vineyards and Winery  
17235 N. 75th Ave., Suite D-145  
Glendale, AZ 85308

RE: Application for Wine Festival License  
License No.: 13103003  
Charron Vineyards and Winery  
Temporary Change for December 14, 2013 from 3:00 p.m. to 8:30 p.m.

Dear Mr. Craig:

Notice is hereby given that the Pima County Board of Supervisors will hold a hearing in reference to the above Wine Festival License application. Please be advised that the hearing has been scheduled for Tuesday, December 3, 2013, at 9:00 a.m. or thereafter, to be held at the following location:

Pima County Administration Building  
Board of Supervisors Hearing Room  
130 West Congress, 1st Floor  
Tucson, Arizona 85701

If you have any questions pertaining to this hearing, please contact this office at (520)724-8449.

Sincerely,

  
Robin Brigode  
Clerk of the Board

c: Sheriff's Dept., Investigative Support Unit Division



8. Has the festival site owner given permission for use of the site and for the sale of spirituous liquors? YES ☒ NO ☐

9. Are the spirituous liquors to be sold or served Arizona Domestic Farm Winery Products **ONLY**? YES ☒ NO ☐

10. How many wine festival licenses have you applied for this calendar year, including this one? 2

Give the total number of days you have held licensed wine festivals this year 3

11. What security and control measures will you take to prevent violations of state liquor laws at this event?  
(List type and number of security/police personnel and type of fencing or control barriers if applicable)

0 # Police ☒ Fencing  
4 # Security personnel ☒ Barriers

There will be Security personnel at the entrants/exits checking IDs and ensuring wine does not leave the fenced area.

Additionally, we will have roaming Security personnel to ensure individuals are only entering the area at the designated entrants/exits points.

12. Your licensed premises is that area in which you are authorized to sell, dispense, or serve spirituous liquors under the provisions of your license. The following page is to be used to prepare a diagram of your wine festival/fair licensed premises. Please show dimensions, serving areas, fencing, barricades or other control measures and security positions.

I, MILTON ELSWORTH CRAIG, hereby declare that I am the APPLICANT filing this application. I  
(Print full name)  
have read the application and the contents and all statements are true, correct and complete.

[Signature]

State of AZ County of Pima

The foregoing instrument was acknowledged before me this

8<sup>th</sup> day of November, 2013  
Day Month Year

My commission expires on My Comm. Expires Sep 30, 2017

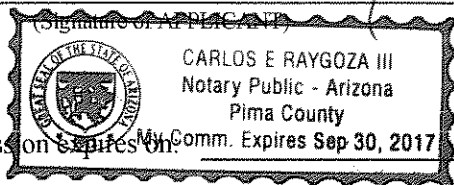

[Signature]  
(Signature of NOTARY PUBLIC)

\*\*\* FOR USE BY LOCAL GOVERNING AUTHORITY ONLY \*\*\*

I, \_\_\_\_\_, hereby ☐ APPROVE ☐ DISAPPROVE this application on behalf of  
(Government Official)

\_\_\_\_\_  
(City, Town, or County)

\_\_\_\_\_  
(Title)

X \_\_\_\_\_  
(Signature of OFFICIAL)

\*\*\* FOR USE BY DLLC ONLY \*\*\*

☐ APPROVED

☐ DISAPPROVED

By: \_\_\_\_\_

Date: \_\_\_\_\_

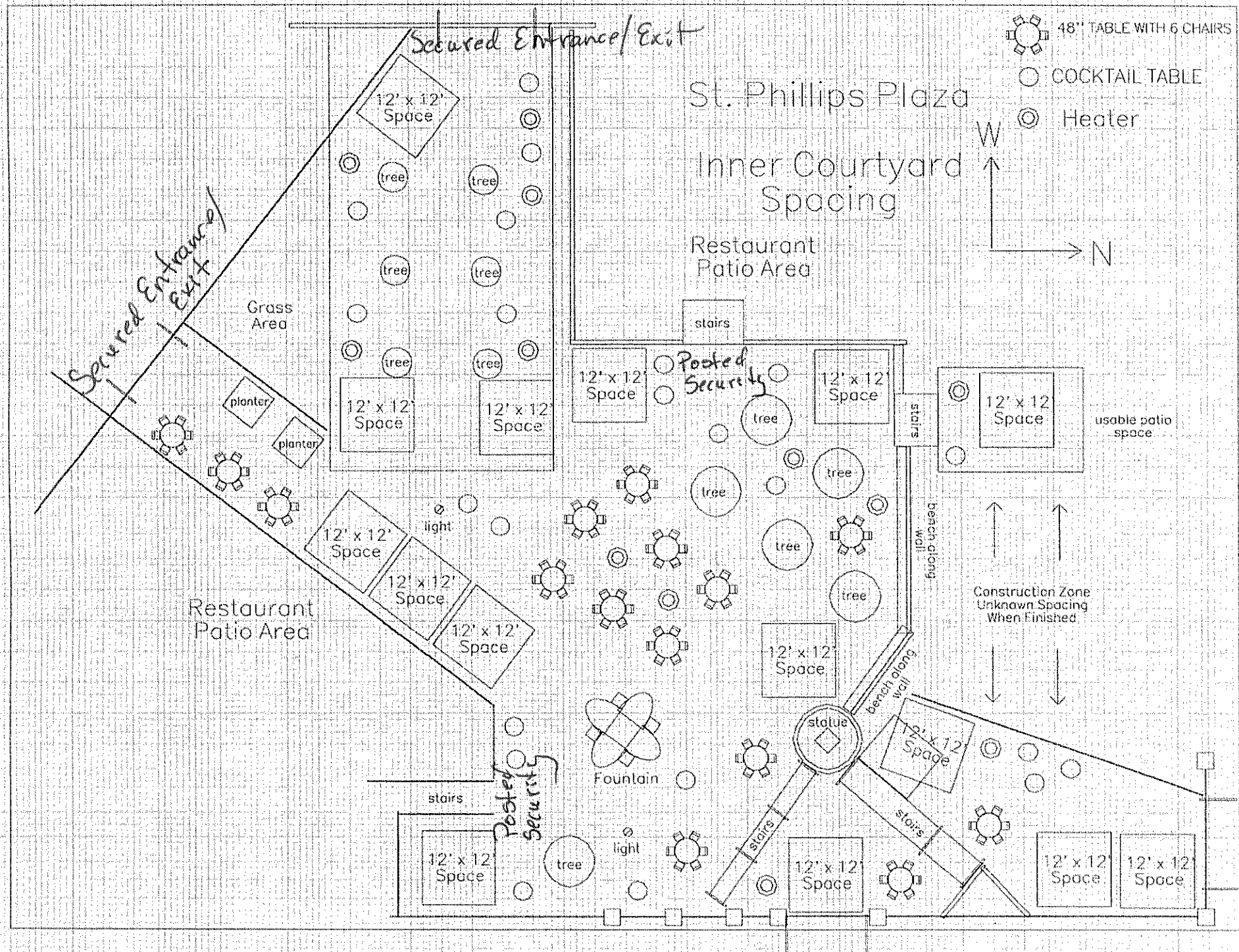

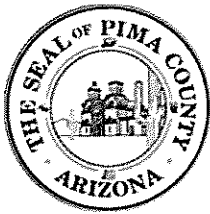

**Mary Jo Furphy**  
Deputy Clerk

# Pima County Clerk of the Board

Robin Brigode

Administration Division  
130 W. Congress, 5<sup>th</sup> Floor  
Tucson, AZ 85701  
Phone: (520)724-8449 • Fax: (520) 222-0448

Document and Micrographics Mgt. Division  
1640 East Benson Highway  
Tucson, Arizona 85714  
Phone: (520) 351-8454 • Fax: (520) 351-8456

November 20, 2013

Mr. Mark Walter Beres  
Flying Leap Vineyards, Inc.  
17235 N. 75th Ave., Suite D-145  
Glendale, AZ 85308

RE: Application for Wine Festival License  
License No.: 13123014  
Flying Leap Vineyards, Inc.  
Temporary Change for December 14, 2013 from 3:00 p.m. to 8:30 p.m.

Dear Mr. Beres:

Notice is hereby given that the Pima County Board of Supervisors will hold a hearing in reference to the above Wine Festival License application. Please be advised that the hearing has been scheduled for Tuesday, December 3, 2013, at 9:00 a.m. or thereafter, to be held at the following location:

Pima County Administration Building  
Board of Supervisors Hearing Room  
130 West Congress, 1st Floor  
Tucson, Arizona 85701

If you have any questions pertaining to this hearing, please contact this office at (520)724-8449.

Sincerely,

  
Robin Brigode  
Clerk of the Board

c: Sheriff's Dept., Investigative Support Unit Division



8. Has the festival site owner given permission for use of the site and for the sale of spirituous liquors? YES ☒ NO ☐

9. Are the spirituous liquors to be sold or served Arizona Domestic Farm Winery Products **ONLY**? YES ☒ NO ☐

10. How many wine festival licenses have you applied for this calendar year, including this one? 5

Give the total number of days you have held licensed wine festivals this year 7

11. What security and control measures will you take to prevent violations of state liquor laws at this event?  
(List type and number of security/police personnel and type of fencing or control barriers if applicable)

0 # Police ☒ Fencing  
4 # Security personnel ☒ Barriers

There will be Security personnel at the entrants/exits checking IDs and ensuring wine does not leave the fenced area.

Additionally, we will have roaming Security personnel to ensure individuals are only entering the area at the designated entrants/exits points.

12. Your licensed premises is that area in which you are authorized to sell, dispense, or serve spirituous liquors under the provisions of your license. The following page is to be used to prepare a diagram of your wine festival/fair licensed premises. Please show dimensions, serving areas, fencing, barricades or other control measures and security positions.

I, MARK WALTER BERES, hereby declare that I am the APPLICANT filing this application. I  
(Print full name)

have read the application and the contents and all statements are true, correct and complete.

X Mark Walter Beres  
(Signature of APPLICANT)

State of ARIZONA County of PIMA  
The foregoing instrument was acknowledged before me this  
29TH day of OCTOBER, 2013  
Day Month Year

My commission expires on: 9/12/2017 Matthew Lynn  
(Signature of NOTARY PUBLIC)

\*\*\* FOR USE BY LOCAL GOVERNING AUTHORITY ONLY \*\*\*



I, \_\_\_\_\_, hereby ☐ APPROVE ☐ DISAPPROVE this application on behalf of  
(Government Official)

\_\_\_\_\_  
(City, Town, or County) (Title) X \_\_\_\_\_  
(Signature of OFFICIAL)

\*\*\* FOR USE BY DLLC ONLY \*\*\*

☐ APPROVED ☐ DISAPPROVED

By: \_\_\_\_\_ Date: \_\_\_\_\_

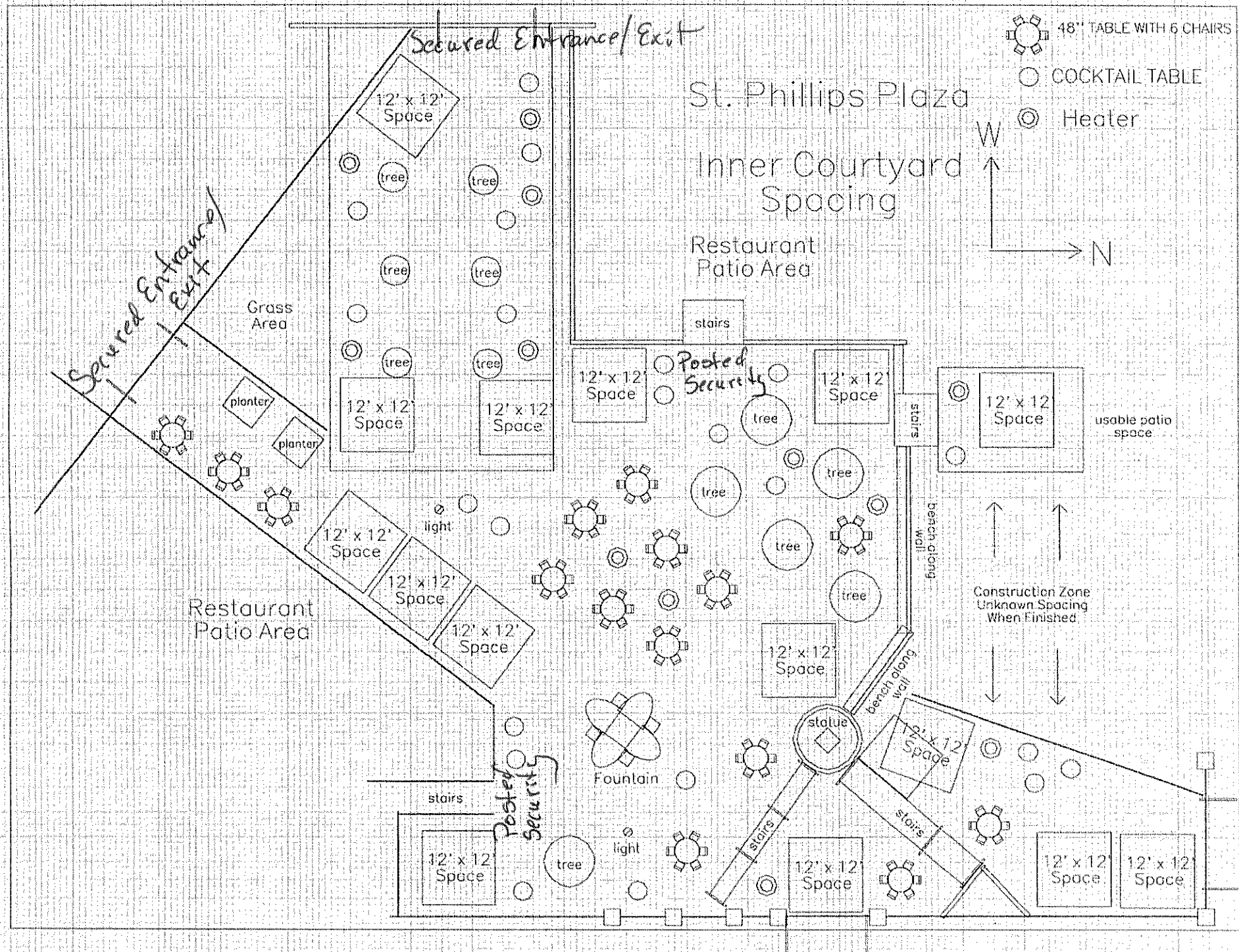



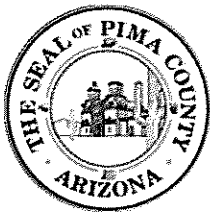

**Mary Jo Furphy**  
Deputy Clerk

# Pima County Clerk of the Board

Robin Brigode

Administration Division  
130 W. Congress, 5<sup>th</sup> Floor  
Tucson, AZ 85701  
Phone: (520)724-8449 • Fax: (520) 222-0448

Document and Micrographics Mgt. Division  
1640 East Benson Highway  
Tucson, Arizona 85714  
Phone: (520) 351-8454 • Fax: (520) 351-8456

November 20, 2013

Mr. Ray Frances Freitas  
Freitas Vineyard  
17235 N. 75th Ave., Suite D-145  
Glendale, AZ 85308

RE: Application for Wine Festival License  
License No.: 13133002  
Freitas Vineyard  
Temporary Change for December 14, 2013 from 3:00 p.m. to 8:30 p.m.

Dear Mr. Freitas:

Notice is hereby given that the Pima County Board of Supervisors will hold a hearing in reference to the above Wine Festival License application. Please be advised that the hearing has been scheduled for Tuesday, December 3, 2013, at 9:00 a.m. or thereafter, to be held at the following location:

Pima County Administration Building  
Board of Supervisors Hearing Room  
130 West Congress, 1st Floor  
Tucson, Arizona 85701

If you have any questions pertaining to this hearing, please contact this office at (520)724-8449.

Sincerely,

  
Robin Brigode  
Clerk of the Board

c: Sheriff's Dept., Investigative Support Unit Division

State of Arizona Department of Liquor Licenses and Control  
800 W. Washington, 5th Floor  
Phoenix, AZ 85007  
www.azliquor.gov  
(602)542-5141

## APPLICATION FOR WINE FESTIVAL LICENSE/WINE FAIR LICENSE

FEE = \$15.00 per event

A service fee of \$25.00 will be charged for all dishonored checks (A.R.S. 44-6852)

A separate license is needed when days are not consecutive. Only twenty-five (25) licenses per calendar year for up to seventy-five calendar days may be issued, excluding sanctioned county or state fair licenses.

1. Applicant's Name: FREITHS RAY FRANCES  
Last First Middle
2. Business Name: FREITAS VINEYARD D.F.W. Lic#: 13133002  
(Domestic Farm Winery License #)
3. Location of Festival: 4280 N. Campbell Ave., Ste 212 Tucson Pima 85718  
(Physical location - Do not use PO Box) City County Zip
4. Mailing Address: 17235 N. 75th Ave., Ste D-145 Glendale AZ 85308  
City State Zip

5. Date and hours of festival:

DATE	DAY OF WEEK	HOURS FROM	HOURS TO
12/14/2013	Saturday	3:00 a.m./p.m.	8:30 a.m./p.m.
		a.m./p.m.	a.m./p.m.
		a.m./p.m.	a.m./p.m.
		a.m./p.m.	a.m./p.m.
		a.m./p.m.	a.m./p.m.
		a.m./p.m.	a.m./p.m.
		a.m./p.m.	a.m./p.m.
		a.m./p.m.	a.m./p.m.
		a.m./p.m.	a.m./p.m.
		a.m./p.m.	a.m./p.m.

6. Name and address of site owner: Selby Robert  
Last First Middle
- 4280 N. Campbell Ave., Ste 212 Tucson AZ 85718  
Address City State Zip
7. Phone Numbers: (520) 529-2775 ( ) ( )  
Site Owner Applicant's Business Applicant's Residence

\* Disabled individuals requiring special accommodation, please call (602) 542-9027.

8. Has the festival site owner given permission for use of the site and for the sale of spirituous liquors? YES ☒ NO ☐

9. Are the spirituous liquors to be sold or served Arizona Domestic Farm Winery Products **ONLY**? YES ☒ NO ☐

10. How many wine festival licenses have you applied for this calendar year, including this one? 2

Give the total number of days you have held licensed wine festivals this year 4

11. What security and control measures will you take to prevent violations of state liquor laws at this event?  
(List type and number of security/police personnel and type of fencing or control barriers if applicable)

0          # Police ☒ Fencing  
4          # Security personnel ☒ Barriers

There will be Security personnel at the entrants/exits checking IDs and ensuring wine does not leave the fenced area.

Additionally, we will have roaming Security personnel to ensure individuals are only entering the area at the designated entrants/exits points.

12. Your licensed premises is that area in which you are authorized to sell, dispense, or serve spirituous liquors under the provisions of your license. The following page is to be used to prepare a diagram of your wine festival/fair licensed premises. Please show dimensions, serving areas, fencing, barricades or other control measures and security positions.

I, RAY FRANCES FREITAS, hereby declare that I am the APPLICANT filing this application. I  
(Print full name)  
have read the application and the contents and all statements are true, correct and complete.

X Ray Frances Freitas  
(Signature of APPLICANT)

State of Arizona County of Yavapai  
The foregoing instrument was acknowledged before me this

9 day of November, 2013  
Day Month Year

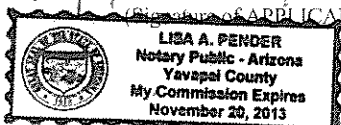

My commission expires on: 11/20/13

[Signature]  
(Signature of NOTARY PUBLIC)

\*\*\* FOR USE BY LOCAL GOVERNING AUTHORITY ONLY \*\*\*

I, \_\_\_\_\_, hereby ☐ APPROVE ☐ DISAPPROVE this application on behalf of  
(Government Official)

\_\_\_\_\_  
(City, Town, or County)

\_\_\_\_\_  
(Title)

X \_\_\_\_\_  
(Signature of OFFICIAL)

\*\*\* FOR USE BY DLLC ONLY \*\*\*

☐ APPROVED ☐ DISAPPROVED

By:

\_\_\_\_\_

Date:

\_\_\_\_\_

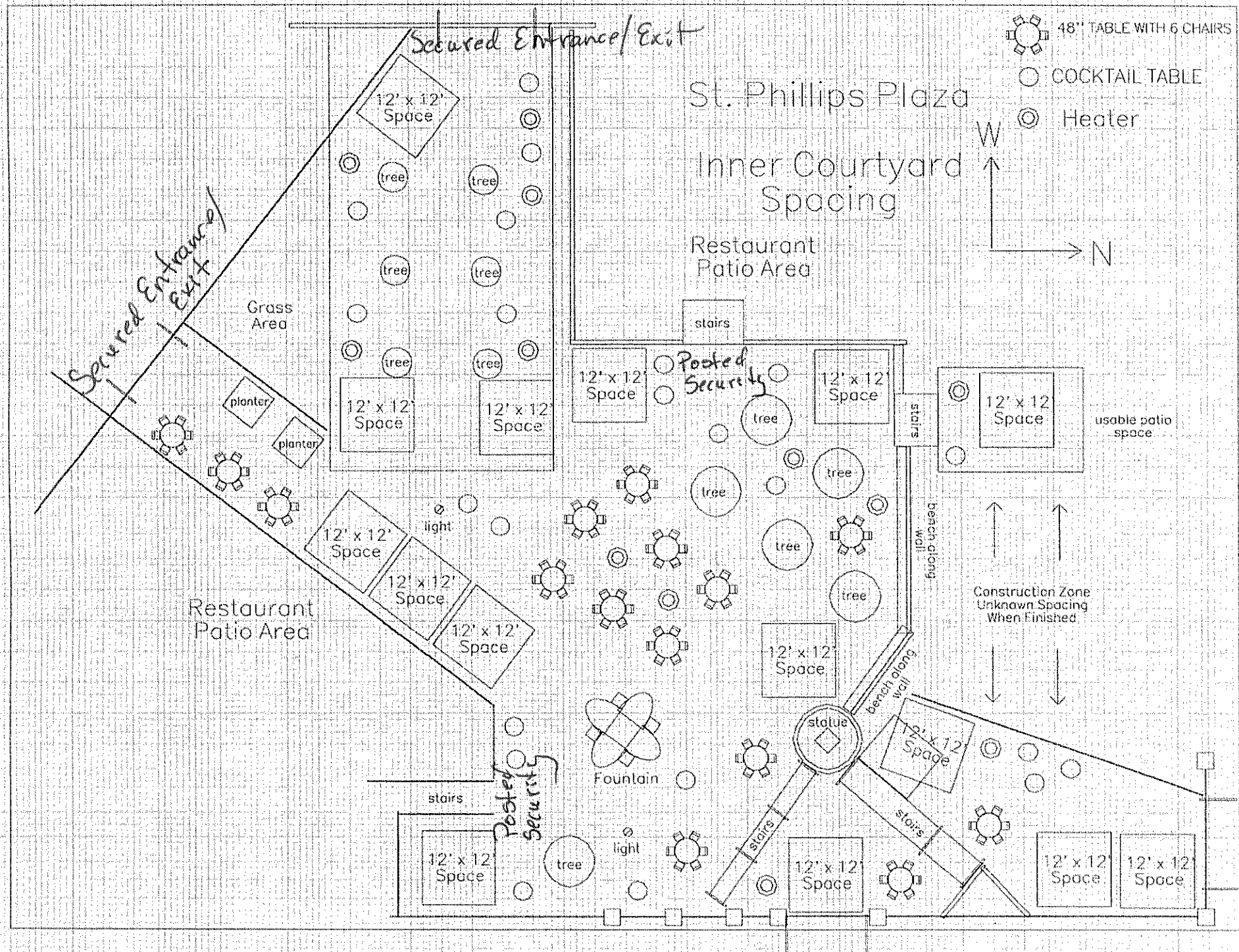

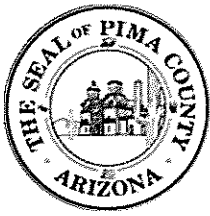

**Mary Jo Furphy**  
Deputy Clerk

# Pima County Clerk of the Board

Robin Brigode

Administration Division  
130 W. Congress, 5<sup>th</sup> Floor  
Tucson, AZ 85701  
Phone: (520)724-8449 • Fax: (520) 222-0448

Document and Micrographics Mgt. Division  
1640 East Benson Highway  
Tucson, Arizona 85714  
Phone: (520) 351-8454 • Fax: (520) 351-8456

November 20, 2013

Mr. Gavin Richard Gallifant  
Gallifant Cellars, L.L.C.  
17235 N. 75th Ave., Suite D-145  
Glendale, AZ 85308

RE: Application for Wine Festival License  
License No.: 13023024  
Gallifant Cellars, L.L.C.  
Temporary Change for December 14, 2013 from 3:00 p.m. to 8:30 p.m.

Dear Mr. Gallifant:

Notice is hereby given that the Pima County Board of Supervisors will hold a hearing in reference to the above Wine Festival License application. Please be advised that the hearing has been scheduled for Tuesday, December 3, 2013, at 9:00 a.m. or thereafter, to be held at the following location:

Pima County Administration Building  
Board of Supervisors Hearing Room  
130 West Congress, 1st Floor  
Tucson, Arizona 85701

If you have any questions pertaining to this hearing, please contact this office at (520)724-8449.

Sincerely,

  
Robin Brigode  
Clerk of the Board

c: Sheriff's Dept., Investigative Support Unit Division



8. Has the festival site owner given permission for use of the site and for the sale of spirituous liquors? YES ☒ NO ☐
9. Are the spirituous liquors to be sold or served Arizona Domestic Farm Winery Products **ONLY**? YES ☒ NO ☐
10. How many wine festival licenses have you applied for this calendar year, including this one? 6

Give the total number of days you have held licensed wine festivals this year 11

11. What security and control measures will you take to prevent violations of state liquor laws at this event?  
(List type and number of security/police personnel and type of fencing or control barriers if applicable)

0 \_\_\_\_\_ # Police ☒ Fencing  
4 \_\_\_\_\_ # Security personnel ☒ Barriers

There will be Security personnel at the entrants/exits checking IDs and ensuring wine does not leave the fenced area.

Additionally, we will have roaming Security personnel to ensure individuals are only entering the area at the designated entrants/exits points.

12. Your licensed premises is that area in which you are authorized to sell, dispense, or serve spirituous liquors under the provisions of your license. The following page is to be used to prepare a diagram of your wine festival/fair licensed premises. Please show dimensions, serving areas, fencing, barricades or other control measures and security positions.

I, Barvin Richard Galufant, hereby declare that I am the APPLICANT filing this application. I  
(Print full name)

have read the application and the contents and all statements are true, correct and complete.

X [Signature] (Signature of APPLICANT) Arizona State of Maricopa County of 504 day of October, 2013 Year  
VEDRANA PROHASKA  
Notary Public - Arizona  
Maricopa County  
My Comm. Expires Nov 9, 2015  
My commission expires on: Nov 9, 2015 [Signature] (Signature of NOTARY PUBLIC)

\*\*\* FOR USE BY LOCAL GOVERNING AUTHORITY ONLY \*\*\*

I, \_\_\_\_\_, hereby ☐ APPROVE ☐ DISAPPROVE this application on behalf of  
(Government Official)

\_\_\_\_\_  
(City, Town, or County) (Title) X \_\_\_\_\_  
(Signature of OFFICIAL)

\*\*\* FOR USE BY DLLC ONLY \*\*\*

☐ APPROVED ☐ DISAPPROVED

By: \_\_\_\_\_ Date: \_\_\_\_\_

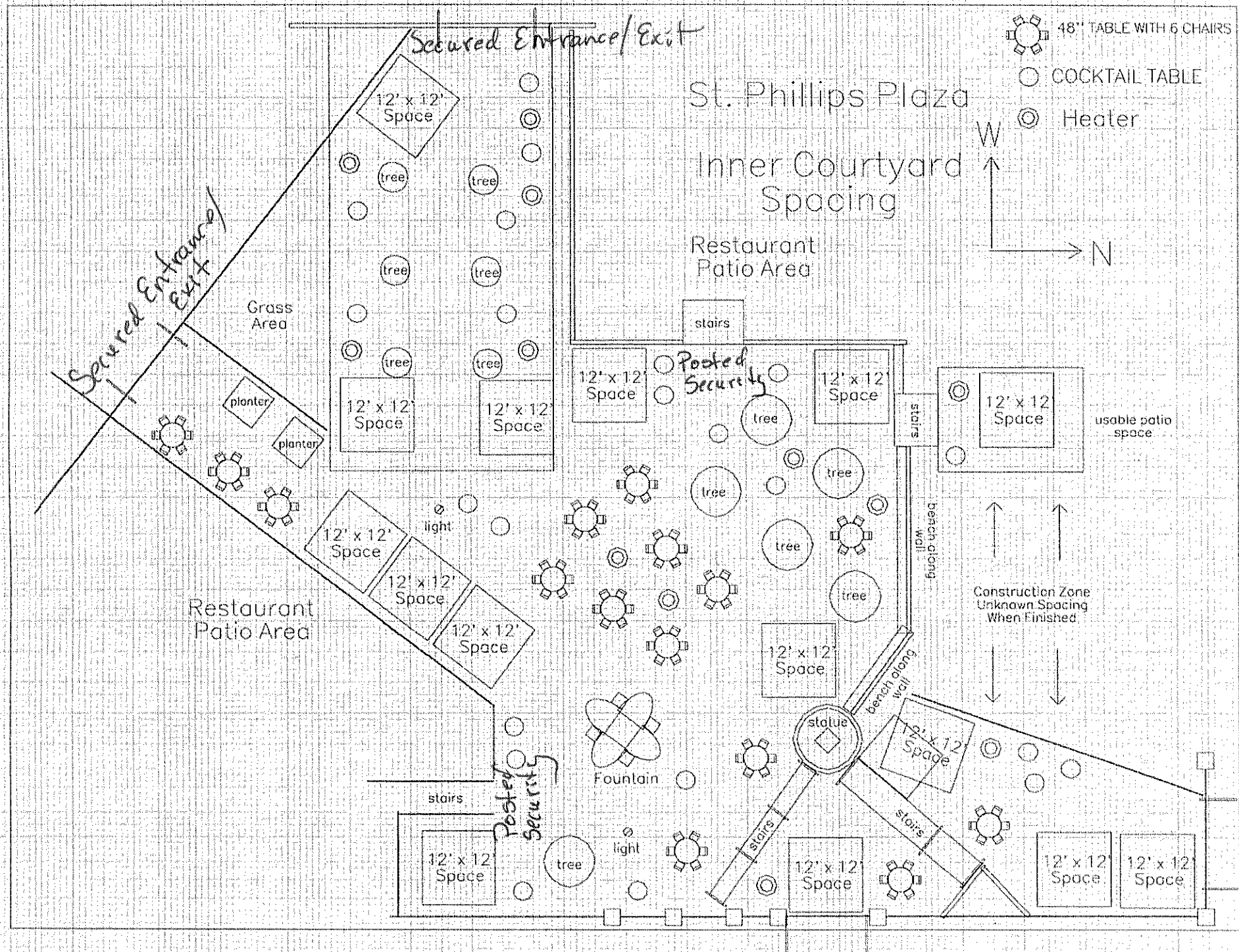



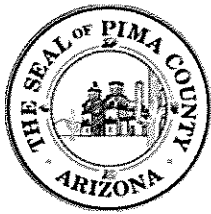

**Mary Jo Furphy**  
Deputy Clerk

# Pima County Clerk of the Board

Robin Brigode

Administration Division  
130 W. Congress, 5<sup>th</sup> Floor  
Tucson, AZ 85701  
Phone: (520)724-8449 • Fax: (520) 222-0448

Document and Micrographics Mgt. Division  
1640 East Benson Highway  
Tucson, Arizona 85714  
Phone: (520) 351-8454 • Fax: (520) 351-8456

November 20, 2013

Mr. James Hill Graham  
Golden Rule Vineyards  
17235 N. 75th Ave., Suite D-145  
Glendale, AZ 85308

RE: Application for Wine Festival License  
License No.: 13023032  
Golden Rule Vineyards  
Temporary Change for December 14, 2013 from 3:00 p.m. to 8:30 p.m.

Dear Mr. Graham:

Notice is hereby given that the Pima County Board of Supervisors will hold a hearing in reference to the above Wine Festival License application. Please be advised that the hearing has been scheduled for Tuesday, December 3, 2013, at 9:00 a.m. or thereafter, to be held at the following location:

Pima County Administration Building  
Board of Supervisors Hearing Room  
130 West Congress, 1st Floor  
Tucson, Arizona 85701

If you have any questions pertaining to this hearing, please contact this office at (520)724-8449.

Sincerely,

  
Robin Brigode  
Clerk of the Board

c: Sheriff's Dept., Investigative Support Unit Division

FEE = \$15.00 per event

A service fee of \$25.00 will be charged for all dishonored checks (A.R.S. 44-6852)

A separate license is needed when days are not consecutive. Only twenty-five (25) licenses per calendar year for up to seventy-five calendar days may be issued, excluding sanctioned county or state fair licenses.

1. Applicant's Name:	GRAHAM	JAMES	HILL
	Last	First	Middle
2. Business Name:	GOLDEN RULE VINEYARDS		D.F.W. Lic#: 13023032
	(Domestic Farm Winery License #)		
3. Location of Festival:	4280 N. Campbell Ave., Ste 212	Tucson	Pima 85718
	(Physical location - Do not use PO Box)	City	County Zip
4. Mailing Address:	17235 N. 75th Ave., Ste D-145	Glendale	AZ 85308
		City	State Zip

5. Date and hours of festival:

[illegible]

6. Name and address of site owner:	Selby		Robert	
	Last		First	Middle
	4280 N. Campbell Ave., Ste 212		Tucson	AZ 85718
	Address		City	State Zip
7. Phone Numbers:	(520) 529-2775	(520) 507-2400	(520) 507-1776	
	Site Owner		Applicant's Business	Applicant's Residence

\* Disabled individuals requiring special accommodation, please call (602) 542-9027.

8. Has the festival site owner given permission for use of the site and for the sale of spirituous liquors? YES ☒ NO ☐
9. Are the spirituous liquors to be sold or served Arizona Domestic Farm Winery Products **ONLY**? YES ☒ NO ☐
10. How many wine festival licenses have you applied for this calendar year, including this one? 3

Give the total number of days you have held licensed wine festivals this year 5

11. What security and control measures will you take to prevent violations of state liquor laws at this event?  
(List type and number of security/police personnel and type of fencing or control barriers if applicable)

0 # Police ☒ Fencing  
4 # Security personnel ☒ Barriers

There will be Security personnel at the entrants/exits checking IDs and ensuring wine does not leave the fenced area.

Additionally, we will have roaming Security personnel to ensure individuals are only entering the area at the designated entrants/exits points.

12. Your licensed premises is that area in which you are authorized to sell, dispense, or serve spirituous liquors under the provisions of your license. The following page is to be used to prepare a diagram of your wine festival/fair licensed premises. Please show dimensions, serving areas, fencing, barricades or other control measures and security positions.

I, JAMES HILL GRAHAM

\_\_\_\_\_, hereby declare that I am the APPLICANT filing this application. I  
 (Print full name)

have read the application and the contents and all statements are true, correct and complete.

X James Hill Graham  
 (Signature of APPLICANT)

State of ARIZONA County of COCHISE  
 The foregoing instrument was acknowledged before me this  
30TH day of OCTOBER, 2013  
 Day Month Year

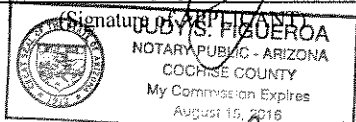

My commission expires on: August 15, 2016

Judy S. Figueroa  
 (Signature of NOTARY PUBLIC)

\*\*\* FOR USE BY LOCAL GOVERNING AUTHORITY ONLY \*\*\*

I, \_\_\_\_\_, hereby ☐ APPROVE ☒ DISAPPROVE this application on behalf of  
 (Government Official)

\_\_\_\_\_  
 (City, Town, or County) (Title) X (Signature of OFFICIAL)

\*\*\* FOR USE BY DLLC ONLY \*\*\*

☐ APPROVED ☐ DISAPPROVED

By: \_\_\_\_\_ Date: \_\_\_\_\_

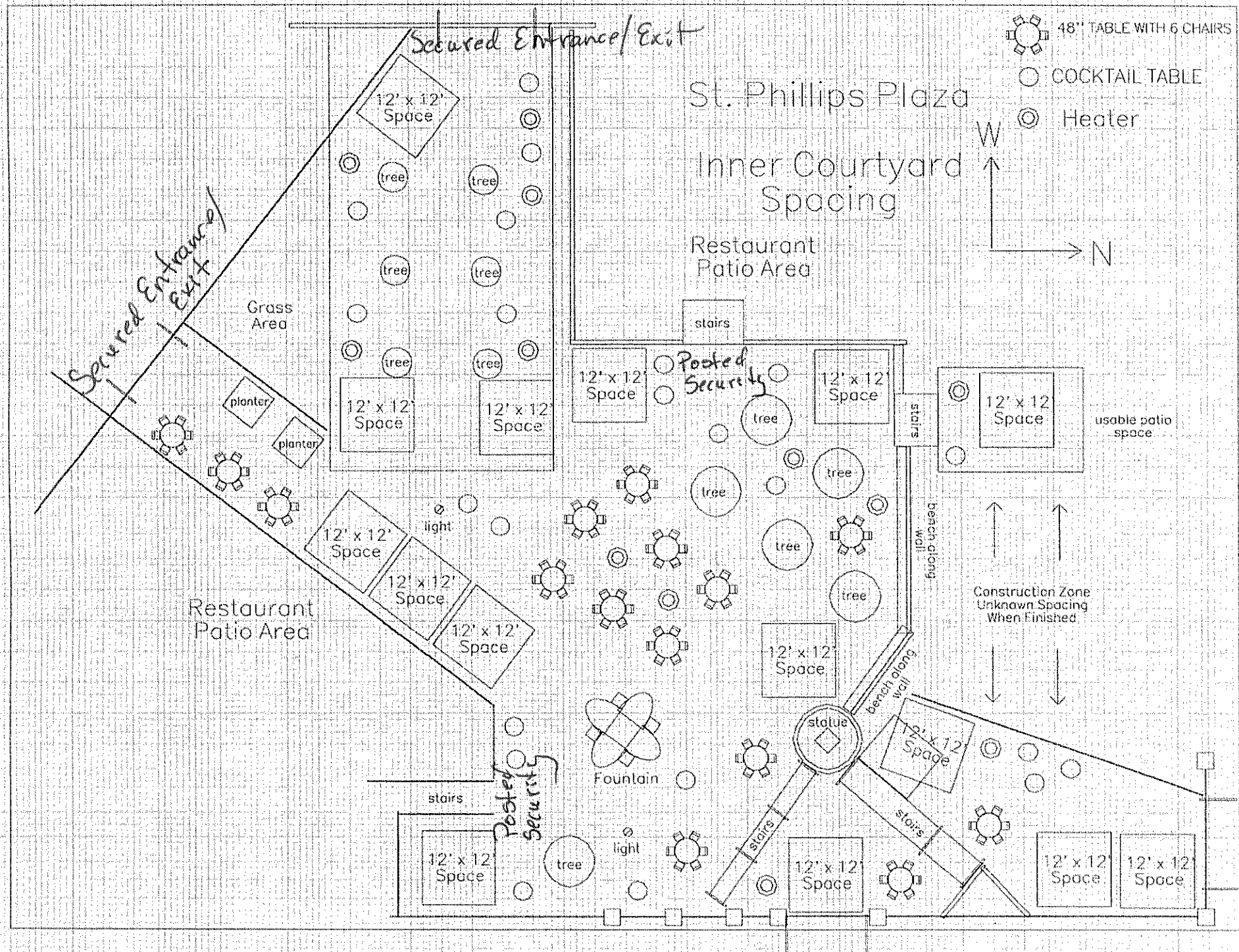

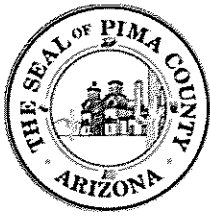

**Mary Jo Furphy**  
Deputy Clerk

# Pima County Clerk of the Board

Robin Brigode

Administration Division  
130 W. Congress, 5<sup>th</sup> Floor  
Tucson, AZ 85701  
Phone: (520)724-8449 • Fax: (520) 222-0448

Document and Micrographics Mgt. Division  
1640 East Benson Highway  
Tucson, Arizona 85714  
Phone: (520) 351-8454 • Fax: (520) 351-8456

November 20, 2013

Ms. Charlene Rae Manning  
Kief - Joshua Vineyards  
17235 N. 75th Ave., Suite D-145  
Glendale, AZ 85308

RE: Application for Wine Festival License  
License No.: 13123006  
Kief - Joshua Vineyards  
Temporary Change for December 14, 2013 from 3:00 p.m. to 8:30 p.m.

Dear Ms. Manning:

Notice is hereby given that the Pima County Board of Supervisors will hold a hearing in reference to the above Wine Festival License application. Please be advised that the hearing has been scheduled for Tuesday, December 3, 2013, at 9:00 a.m. or thereafter, to be held at the following location:

Pima County Administration Building  
Board of Supervisors Hearing Room  
130 West Congress, 1st Floor  
Tucson, Arizona 85701

If you have any questions pertaining to this hearing, please contact this office at (520)724-8449.

Sincerely,

  
Robin Brigode  
Clerk of the Board

c: Sheriff's Dept., Investigative Support Unit Division

State of Arizona Department of Liquor Licenses and Control  
800 W. Washington, 5th Floor  
Phoenix, AZ 85007  
www.azliquor.gov  
(602)542-5141

**APPLICATION FOR WINE FESTIVAL LICENSE/WINE FAIR LICENSE**

FEE = \$15.00 per event

A service fee of \$25.00 will be charged for all dishonored checks (A.R.S. 44-6852)

A separate license is needed when days are not consecutive. Only twenty-five (25) licenses per calendar year for up to seventy-five calendar days may be issued, excluding sanctioned county or state fair licenses.

1. Applicant's Name: Manning Chardone Rae  
Last First Middle

2. Business Name: Kief Joshua Vineyards D.F.W. Lic#: 13123006  
(Domestic Farm Winery License #)

3. Location of Festival: 4280 N. Campbell Ave., Ste 212 Tucson Pima 85718  
(Physical location - Do not use PO Box) City County Zip

4. Mailing Address: 17235 N. 75th Ave., Ste D-145 Glendale AZ 85308  
City State Zip

5. Date and hours of festival:

DATE	DAY OF WEEK	HOURS FROM	HOURS TO
<u>12/14/2013</u>	<u>Saturday</u>	<u>3:00</u> a.m./p.m.	<u>8:30</u> a.m./p.m.
_____	_____	_____ a.m./p.m.	_____ a.m./p.m.
_____	_____	_____ a.m./p.m.	_____ a.m./p.m.
_____	_____	_____ a.m./p.m.	_____ a.m./p.m.
_____	_____	_____ a.m./p.m.	_____ a.m./p.m.
_____	_____	_____ a.m./p.m.	_____ a.m./p.m.
_____	_____	_____ a.m./p.m.	_____ a.m./p.m.
_____	_____	_____ a.m./p.m.	_____ a.m./p.m.
_____	_____	_____ a.m./p.m.	_____ a.m./p.m.
_____	_____	_____ a.m./p.m.	_____ a.m./p.m.

6. Name and address of site owner: Selby Robert  
Last First Middle

4280 N. Campbell Ave., Ste 212 Tucson AZ 85718  
Address City State Zip

7. Phone Numbers: (520) 529-2775 (520) 455 5782 (480) 650 8651  
Site Owner Applicant's Business Applicant's Residence

\* Disabled individuals requiring special accommodation, please call (602) 542-9027.

8. Has the festival site owner given permission for use of the site and for the sale of spirituous liquors? YES ☒ NO ☐
9. Are the spirituous liquors to be sold or served Arizona Domestic Farm Winery Products **ONLY**? YES ☒ NO ☐
10. How many wine festival licenses have you applied for this calendar year, including this one? 12

Give the total number of days you have held licensed wine festivals this year 26

11. What security and control measures will you take to prevent violations of state liquor laws at this event?  
(List type and number of security/police personnel and type of fencing or control barriers if applicable)

2 # Police ☐ Fencing  
2 # Security personnel ☐ Barriers

There will be security personnel at both the entrance and exit to monitor IDs and to ensure that guests do not leave the premises with open containers. They will also monitor guests to ensure they use the correct entrance and exit.

12. Your licensed premises is that area in which you are authorized to sell, dispense, or serve spirituous liquors under the provisions of your license. The following page is to be used to prepare a diagram of your wine festival/fair licensed premises. Please show dimensions, serving areas, fencing, barricades or other control measures and security positions.

I, Charlene Rae Manning, hereby declare that I am the APPLICANT filing this application. I  
(Print full name)  
have read the application and the contents and all statements are true, correct and complete.

X Charlene Rae Manning

State of Arizona County of Santa Cruz  
The foregoing instrument was acknowledged before me this

3rd day of October, 2012  
Day Month Year

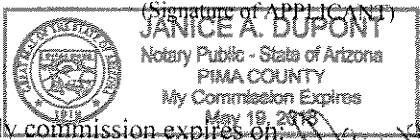

My commission expires on: May 19, 2015

Janice A. Dupont  
(Signature of NOTARY PUBLIC)

\*\*\* FOR USE BY LOCAL GOVERNING AUTHORITY ONLY \*\*\*

I, \_\_\_\_\_, hereby ☐ APPROVE ☐ DISAPPROVE this application on behalf of  
(Government Official)

\_\_\_\_\_  
(City, Town, or County)

\_\_\_\_\_  
(Title)

X \_\_\_\_\_  
(Signature of OFFICIAL)

\*\*\* FOR USE BY DLLC ONLY \*\*\*

☐ APPROVED ☐ DISAPPROVED

By: \_\_\_\_\_ Date: \_\_\_\_\_

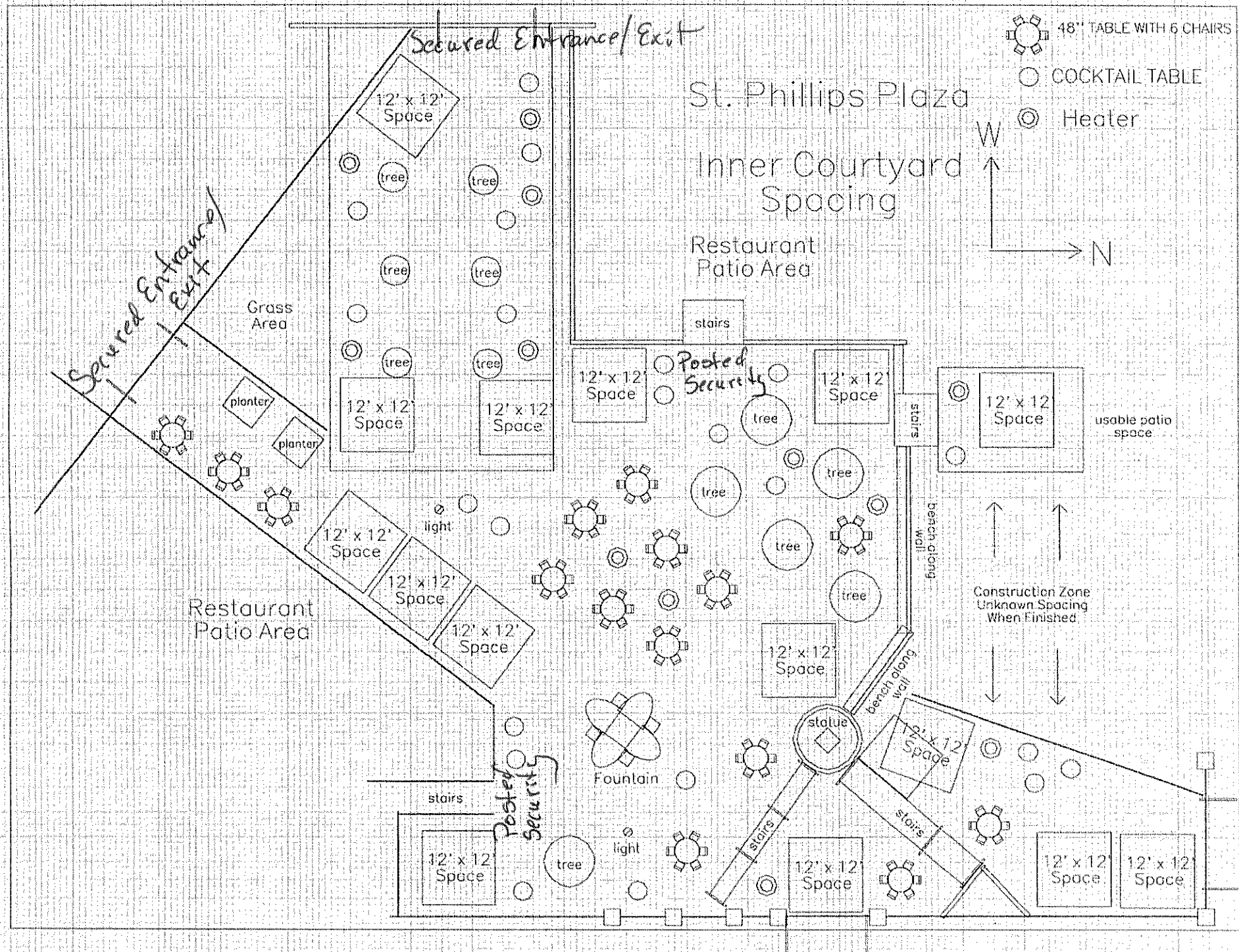



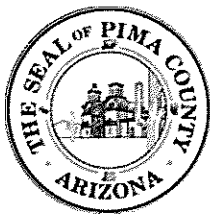

**Mary Jo Furphy**  
Deputy Clerk

# Pima County Clerk of the Board

Robin Brigode

Administration Division  
130 W. Congress, 5<sup>th</sup> Floor  
Tucson, AZ 85701  
Phone: (520)724-8449 • Fax: (520) 222-0448

Document and Micrographics Mgt. Division  
1640 East Benson Highway  
Tucson, Arizona 85714  
Phone: (520) 351-8454 • Fax: (520) 351-8456

November 20, 2013

Ms. Peggy Ann Fiandaca  
Lawrence Dunham Vineyards, L.L.C.  
17235 N. 75th Ave., Suite D-145  
Glendale, AZ 85308

RE: Application for Wine Festival License  
License No.: 13023022  
Lawrence Dunham Vineyards, L.L.C.  
Temporary Change for December 14, 2013 from 3:00 p.m. to 8:30 p.m.

Dear Ms. Fiandaca:

Notice is hereby given that the Pima County Board of Supervisors will hold a hearing in reference to the above Wine Festival License application. Please be advised that the hearing has been scheduled for Tuesday, December 3, 2013, at 9:00 a.m. or thereafter, to be held at the following location:

Pima County Administration Building  
Board of Supervisors Hearing Room  
130 West Congress, 1st Floor  
Tucson, Arizona 85701

If you have any questions pertaining to this hearing, please contact this office at (520)724-8449.

Sincerely,

  
Robin Brigode  
Clerk of the Board

c: Sheriff's Dept., Investigative Support Unit Division

State of Arizona Department of Liquor Licenses and Control  
800 W. Washington, 5th Floor  
Phoenix, AZ 85007  
www.azliquor.gov  
(602)542-5141

**APPLICATION FOR WINE FESTIVAL LICENSE/WINE FAIR LICENSE**

FEE = \$15.00 per event

A service fee of \$25.00 will be charged for all dishonored checks (A.R.S. 44-6852)

A separate license is needed when days are not consecutive. Only twenty-five (25) licenses per calendar year for up to seventy-five calendar days may be issued, excluding sanctioned county or state fair licenses.

1. Applicant's Name: Fiandaca, Peggy Ann

Last

First

Middle

2. Business Name: Lawrence Dunham Vineyards LLC

D.F.W. Lic#: 13023022

(Domestic Farm Winery License #)

3. Location of Festival: 4280 N. Campbell Ave., Ste 212

Tucson

Pima

85718

(Physical location - Do not use PO Box)

City

County

Zip

4. Mailing Address: 17235 N. 75th Ave., Ste D-145

Glendale

AZ

85308

City

State

Zip

5. Date and hours of festival:

DATE

DAY OF WEEK

HOURS FROM

HOURS TO

12/14/2013

Saturday

3:00

a.m./p.m.

8:30

a.m./p.m.

a.m./p.m.

a.m./p.m.

a.m./p.m.

a.m./p.m.

a.m./p.m.

a.m./p.m.

a.m./p.m.

a.m./p.m.

a.m./p.m.

a.m./p.m.

a.m./p.m.

a.m./p.m.

a.m./p.m.

a.m./p.m.

a.m./p.m.

a.m./p.m.

a.m./p.m.

a.m./p.m.

6. Name and address of site owner: Selby

Robert

Last

First

Middle

4280 N. Campbell Ave., Ste 212

Tucson

AZ

85718

Address

City

State

Zip

7. Phone Numbers: (520)

529-2775

(602)

320-1485

(480)

816-1815

Site Owner

Applicant's Business

Applicant's Residence

\* Disabled individuals requiring special accommodation, please call (602) 542-9027.

8. Has the festival site owner given permission for use of the site and for the sale of spirituous liquors? YES ☒ NO ☐

9. Are the spirituous liquors to be sold or served Arizona Domestic Farm Winery Products **ONLY**? YES ☒ NO ☐

10. How many wine festival licenses have you applied for this calendar year, including this one? 6

Give the total number of days you have held licensed wine festivals this year 11

11. What security and control measures will you take to prevent violations of state liquor laws at this event?  
(List type and number of security/police personnel and type of fencing or control barriers if applicable)

0 # Police ☒ Fencing  
4 # Security personnel ☒ Barriers

There will be Security personnel at the entrants/exits checking IDs and ensuring wine does not leave the fenced area.

Additionally, we will have roaming Security personnel to ensure individuals are only entering the area at the designated entrants/exits points.

12. Your licensed premises is that area in which you are authorized to sell, dispense, or serve spirituous liquors under the provisions of your license. The following page is to be used to prepare a diagram of your wine festival/fair licensed premises. Please show dimensions, serving areas, fencing, barricades or other control measures and security positions.

I, Peggy A. Fiandaca, hereby declare that I am the APPLICANT filing this application. I  
(Print full name)  
have read the application and the contents and all statements are true, correct and complete.

X Peggy A. Fiandaca  
(Signature of APPLICANT)

State of Arizona County of Maricopa  
The foregoing instrument was acknowledged before me this  
31 day of October, 2013  
Day Month Year

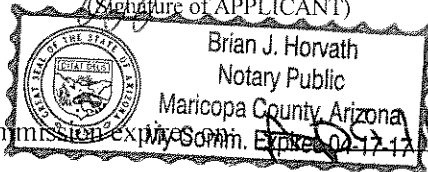
My commission expires 02-17-17  
  
Brian J. Horvath  
Notary Public  
Maricopa County, Arizona

(Signature of NOTARY PUBLIC)

\*\*\* FOR USE BY LOCAL GOVERNING AUTHORITY ONLY \*\*\*

I, \_\_\_\_\_, hereby ☐ APPROVE ☐ DISAPPROVE this application on behalf of  
(Government Official)

\_\_\_\_\_  
(City, Town, or County)

\_\_\_\_\_  
(Title)

X \_\_\_\_\_  
(Signature of OFFICIAL)

\*\*\* FOR USE BY DLLC ONLY \*\*\*

☐ APPROVED ☐ DISAPPROVED

By: \_\_\_\_\_

Date: \_\_\_\_\_

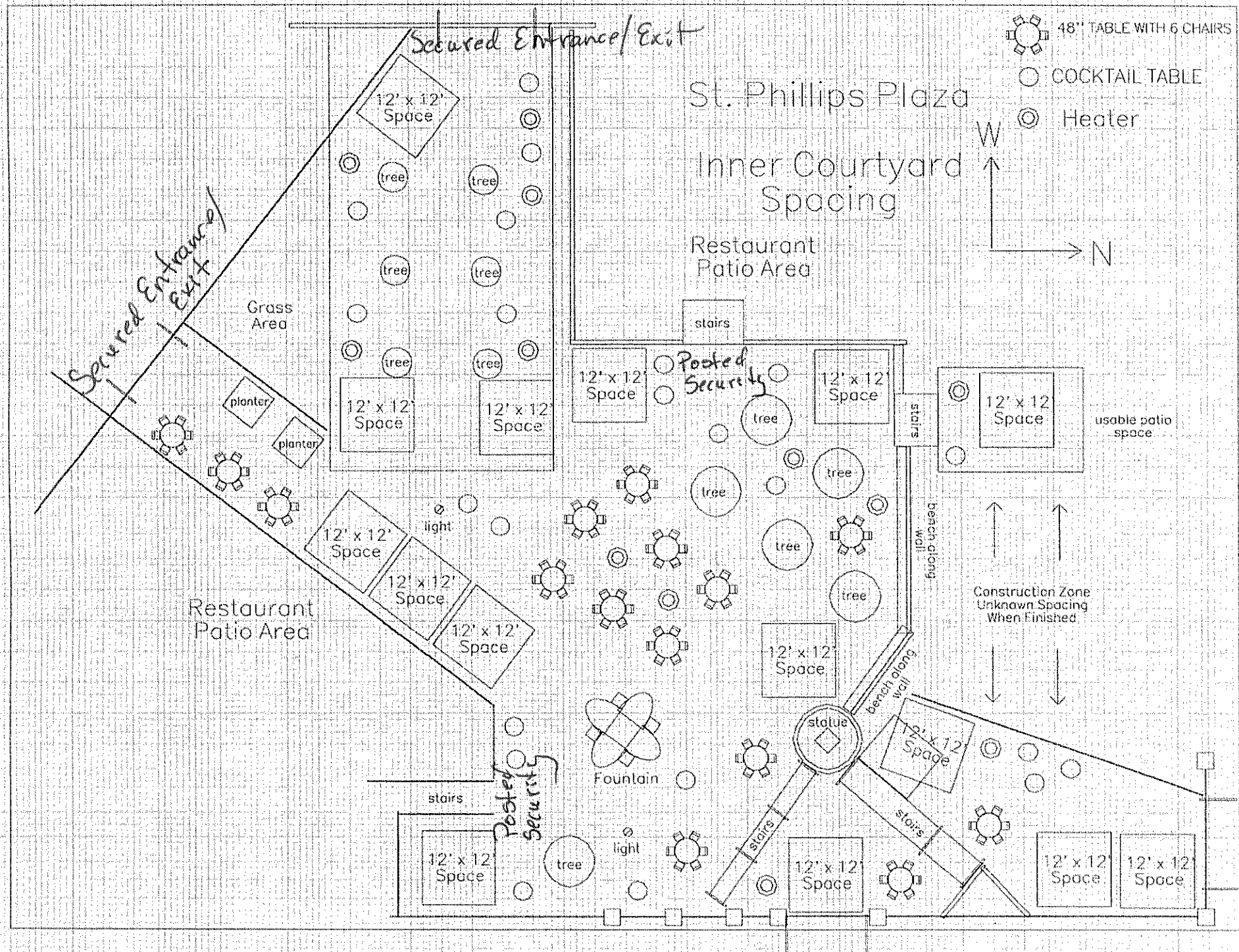

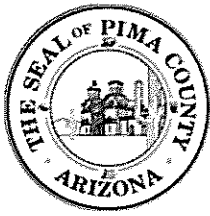

**Mary Jo Furphy**  
Deputy Clerk

# Pima County Clerk of the Board

Robin Brigode

Administration Division  
130 W. Congress, 5<sup>th</sup> Floor  
Tucson, AZ 85701  
Phone: (520)724-8449 • Fax: (520) 222-0448

Document and Micrographics Mgt. Division  
1640 East Benson Highway  
Tucson, Arizona 85714  
Phone: (520) 351-8454 • Fax: (520) 351-8456

November 20, 2013

Ms. Ann Bernadette Roncone  
Lightning Ridge Cellars  
17235 N. 75th Ave., Suite D-145  
Glendale, AZ 85308

RE: Application for Wine Festival License  
License No.: 13123011  
Lightning Ridge Cellars  
Temporary Change for December 14, 2013 from 3:00 p.m. to 8:30 p.m.

Dear Ms. Roncone:

Notice is hereby given that the Pima County Board of Supervisors will hold a hearing in reference to the above Wine Festival License application. Please be advised that the hearing has been scheduled for Tuesday, December 3, 2013, at 9:00 a.m. or thereafter, to be held at the following location:

Pima County Administration Building  
Board of Supervisors Hearing Room  
130 West Congress, 1st Floor  
Tucson, Arizona 85701

If you have any questions pertaining to this hearing, please contact this office at (520)724-8449.

Sincerely,

  
Robin Brigode  
Clerk of the Board

c: Sheriff's Dept., Investigative Support Unit Division

FEE = \$15.00 per event

A service fee of \$25.00 will be charged for all dishonored checks (A.R.S. 44-6852)

1. Applicant's Name: RONCONE ANN BERNADETTE 

2. Business Name: LIGHTNING RIDGE CELLARS D.F.W. Lic#: 13123011  
(Domestic Farm Winery License #)

3. Location of Festival:	4280 N. Campbell Ave., Ste 212	Tucson	Pima	85718
	(Physical location - Do not use PO Box)	City	County	Zip

4. Mailing Address:	17235 N. 75th Ave., Ste D-145	Glendale	AZ	85308
		City	State	Zip

[illegible]

6. Name and address of site owner:	Selby	Robert		
	Last	First	Middle	
	4280 N. Campbell Ave., Ste 212	Tucson	AZ	85718
	Address	City	State	Zip

7. Phone Numbers: (520) 529-2775 (520) 455-5383 (520) 404-3755  
Site Owner Applicant's Business Applicant's Residence

\* Disabled individuals requiring special accommodation, please call (602) 542-9027.

8. Has the festival site owner given permission for use of the site and for the sale of spirituous liquors? YES ☒ NO ☐

9. Are the spirituous liquors to be sold or served Arizona Domestic Farm Winery Products **ONLY**? YES ☒ NO ☐

10. How many wine festival licenses have you applied for this calendar year, including this one? 3

Give the total number of days you have held licensed wine festivals this year 3

11. What security and control measures will you take to prevent violations of state liquor laws at this event?  
(List type and number of security/police personnel and type of fencing or control barriers if applicable)

0 # Police ☒ Fencing  
4 # Security personnel ☒ Barriers

There will be Security personnel at the entrants/exits checking IDs and ensuring wine does not leave the fenced area.

Additionally, we will have roaming Security personnel to ensure individuals are only entering the area at the designated entrants/exits points.

12. Your licensed premises is that area in which you are authorized to sell, dispense, or serve spirituous liquors under the provisions of your license. The following page is to be used to prepare a diagram of your wine festival/fair licensed premises. Please show dimensions, serving areas, fencing, barricades or other control measures and security positions.

I, ANN RONCONE, hereby declare that I am the APPLICANT filing this application. I  
(Print full name)

have read the application and the contents and all statements are true, correct and complete.

X AR Roncone  
(Signature of APPLICANT)

State of Arizona County of Santa Cruz  
The foregoing instrument was acknowledged before me this

24th day of October, 2013  
Day Month Year

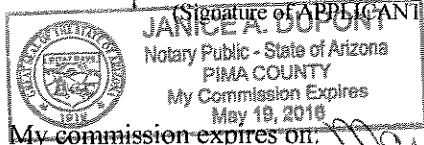

My commission expires on: May 19, 2016

Janice A. Dupont  
(Signature of NOTARY PUBLIC)

\*\*\* FOR USE BY LOCAL GOVERNING AUTHORITY ONLY \*\*\*

I, \_\_\_\_\_, hereby ☐ APPROVE ☐ DISAPPROVE this application on behalf of  
(Government Official)

\_\_\_\_\_  
(City, Town, or County) (Title) X (Signature of OFFICIAL)

\*\*\* FOR USE BY DLLC ONLY \*\*\*

☐ APPROVED ☐ DISAPPROVED

By: \_\_\_\_\_ Date: \_\_\_\_\_

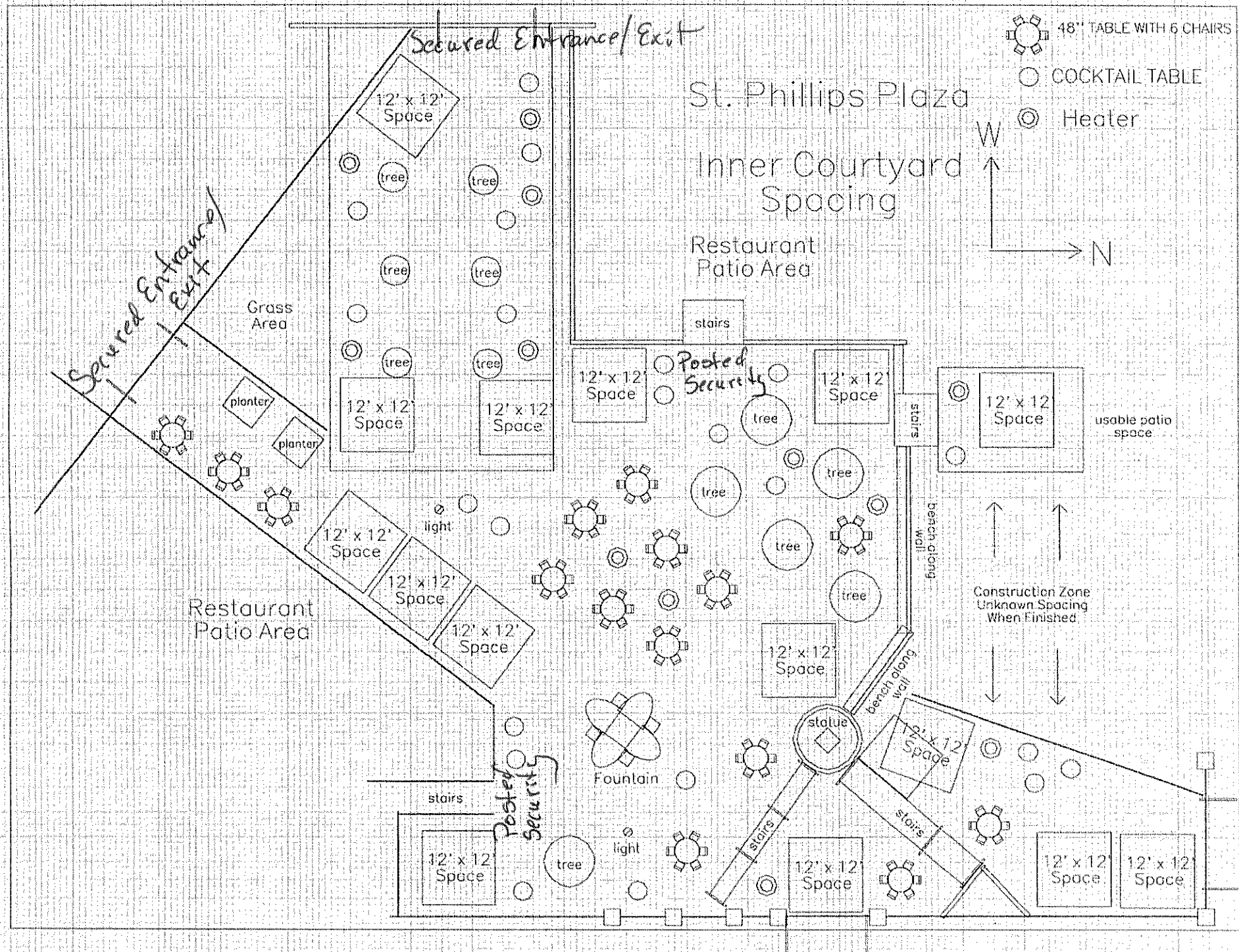



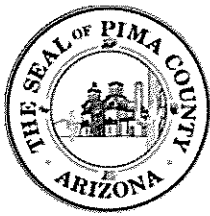

**Mary Jo Furphy**  
Deputy Clerk

# Pima County Clerk of the Board

Robin Brigode

Administration Division  
130 W. Congress, 5<sup>th</sup> Floor  
Tucson, AZ 85701  
Phone: (520)724-8449 • Fax: (520) 222-0448

Document and Micrographics Mgt. Division  
1640 East Benson Highway  
Tucson, Arizona 85714  
Phone: (520) 351-8454 • Fax: (520) 351-8456

November 20, 2013

Mr. Eric Steven Glomski  
Page Springs Cellars  
1500 N. Page Springs Road  
Cornville, AZ 86325

RE: Application for Wine Festival License  
License No.: 13133004  
Page Springs Cellars  
Temporary Change for December 14, 2013 from 3:00 p.m. to 8:30 p.m.

Dear Mr. Glomski:

Notice is hereby given that the Pima County Board of Supervisors will hold a hearing in reference to the above Wine Festival License application. Please be advised that the hearing has been scheduled for Tuesday, December 3, 2013, at 9:00 a.m. or thereafter, to be held at the following location:

Pima County Administration Building  
Board of Supervisors Hearing Room  
130 West Congress, 1st Floor  
Tucson, Arizona 85701

If you have any questions pertaining to this hearing, please contact this office at (520)724-8449.

Sincerely,

  
Robin Brigode  
Clerk of the Board

c: Sheriff's Dept., Investigative Support Unit Division

FEE = \$15.00 per event

A separate license is needed when days are not consecutive. Only twenty-five (25) licenses per calendar year for up to seventy-five calendar days may be issued, excluding sanctioned county or state fair licenses.

2. Business Name: Page Springs Cellars D.F.W. Lic#: 13133004  
(Domestic Farm Winery License #)

5. Date and hours of festival:

7. Phone Numbers: (520) 529-2775 (928) 639-3004 (928) 301-0977  
 Site Owner Applicant's Business Applicant's Residence

LIC0118 05/2009

8. Has the festival site owner given permission for use of the site and for the sale of spirituous liquors? YES ☒ NO ☐
9. Are the spirituous liquors to be sold or served Arizona Domestic Farm Winery Products **ONLY**? YES ☐ NO ☐
10. How many wine festival licenses have you applied for this calendar year, including this one? 12

Give the total number of days you have held licensed wine festivals this year 19

11. What security and control measures will you take to prevent violations of state liquor laws at this event?  
(List type and number of security/police personnel and type of fencing or control barriers if applicable)

0 # Police ☒ Fencing  
4 # Security personnel ☒ Barriers

There will be security personnel at the entrances/exits checking IDs and ensuring wine does not leave the event area. Additionally, we will have roaming security personnel to ensure individuals are only entering the area at the designated entrances and exits.

12. Your licensed premises is that area in which you are authorized to sell, dispense, or serve spirituous liquors under the provisions of your license. The following page is to be used to prepare a diagram of your wine festival/fair licensed premises. Please show dimensions, serving areas, fencing, barricades or other control measures and security positions.

I, Eric Steven Glomski, hereby declare that I am the APPLICANT filing this application. I  
(Print full name)  
have read the application and the contents and all statements are true, correct and complete.

X [Signature] State of Arizona County of Yavapai  
(Signature of APPLICANT) The foregoing instrument was acknowledged before me this

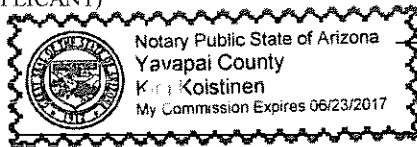

1st day of November, 2013  
Day Month Year

My commission expires on:

[Signature]  
(Signature of NOTARY PUBLIC)

\*\*\* FOR USE BY LOCAL GOVERNING AUTHORITY ONLY \*\*\*

I, \_\_\_\_\_, hereby ☐ APPROVE ☐ DISAPPROVE this application on behalf of  
(Government Official)

\_\_\_\_\_  
(City, Town, or County) (Title) X \_\_\_\_\_  
(Signature of OFFICIAL)

\*\*\* FOR USE BY DLLC ONLY \*\*\*

☐ APPROVED ☐ DISAPPROVED

By: \_\_\_\_\_ Date: \_\_\_\_\_

---

**From:** Lukas Bernard  
**Sent:** Tuesday, November 19, 2013 2:32 PM  
**To:** COB\_mail  
**Subject:** Request to change hours on application

To whom this may concern

I'm the offsite events coordinator for Eric Steven Glomski and Page Springs Cellars. Please adjust the hours on our liquor license application for December 14th from 2:00-9:30 to the correct hours of 3:00-8:30. Please let me know if there is other information or different verbiage that is required for this request.

Thanks

Luke Bernard  
Off-site Events Coordinator &  
Assistant Tasting Room Manager  
Page Springs Cellars

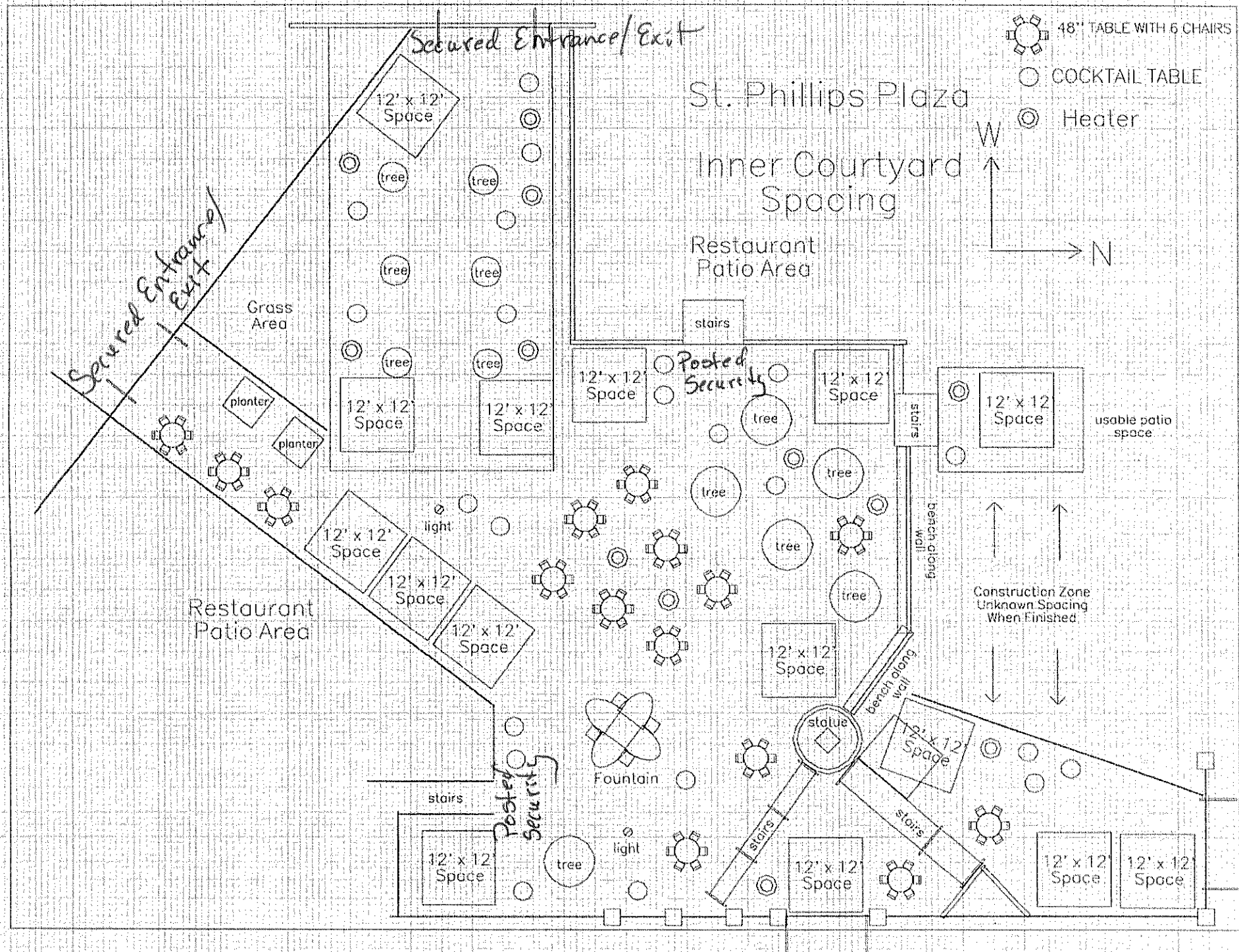

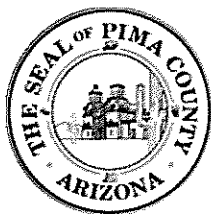

**Mary Jo Furphy**  
Deputy Clerk

# Pima County Clerk of the Board

Robin Brigode

Administration Division  
130 W. Congress, 5<sup>th</sup> Floor  
Tucson, AZ 85701  
Phone: (520)724-8449 • Fax: (520) 222-0448

Document and Micrographics Mgt. Division  
1640 East Benson Highway  
Tucson, Arizona 85714  
Phone: (520) 351-8454 • Fax: (520) 351-8456

November 20, 2013

Ms. Barbara Jean Pierce  
Pierce Wines Arizona, L.L.C.  
17235 N. 75th Ave., Suite D-145  
Glendale, AZ 85308

RE: Application for Wine Festival License  
License No.: 13023027  
Pierce Wines Arizona, L.L.C.  
Temporary Change for December 14, 2013 from 3:00 p.m. to 8:30 p.m.

Dear Ms. Pierce:

Notice is hereby given that the Pima County Board of Supervisors will hold a hearing in reference to the above Wine Festival License application. Please be advised that the hearing has been scheduled for Tuesday, December 3, 2013, at 9:00 a.m. or thereafter, to be held at the following location:

Pima County Administration Building  
Board of Supervisors Hearing Room  
130 West Congress, 1st Floor  
Tucson, Arizona 85701

If you have any questions pertaining to this hearing, please contact this office at (520)724-8449.

Sincerely,

Robin Brigode  
Clerk of the Board

A handwritten signature in cursive script, appearing to read "Mary Jo Furphy", is written over the typed name and title of the Deputy Clerk.

c: Sheriff's Dept., Investigative Support Unit Division

State of Arizona Department of Liquor Licenses and Control  
800 W. Washington, 5th Floor  
Phoenix, AZ 85007  
www.azliquor.gov  
(602)542-5141

**APPLICATION FOR WINE FESTIVAL LICENSE/WINE FAIR LICENSE**

FEE = \$15.00 per event

A service fee of \$25.00 will be charged for all dishonored checks (A.R.S. 44-6852)

A separate license is needed when days are not consecutive. Only twenty-five (25) licenses per calendar year for up to seventy-five calendar days may be issued, excluding sanctioned county or state fair licenses.

1. Applicant's Name: Pierce Barbara Jean  
Last First Middle

2. Business Name: Pierce Wines Arizona, LLC D.F.W. Lic#: 13023027  
(Domestic Farm Winery License #)

3. Location of Festival: 4280 N. Campbell Ave., Ste 212 Tucson Pima 85718  
(Physical location - Do not use PO Box) City County Zip

4. Mailing Address: 17235 N. 75th Ave., Ste D-145 Glendale AZ 85308  
City State Zip

5. Date and hours of festival:

<u>DATE</u>	<u>DAY OF WEEK</u>	<u>HOURS FROM</u>	<u>HOURS TO</u>
<u>12/14/2013</u>	<u>Saturday</u>	<u>3:00</u> a.m./p.m.	<u>8:30</u> a.m./p.m.
<u>                    </u>	<u>                    </u>	<u>                    </u> a.m./p.m.	<u>                    </u> a.m./p.m.
<u>                    </u>	<u>                    </u>	<u>                    </u> a.m./p.m.	<u>                    </u> a.m./p.m.
<u>                    </u>	<u>                    </u>	<u>                    </u> a.m./p.m.	<u>                    </u> a.m./p.m.
<u>                    </u>	<u>                    </u>	<u>                    </u> a.m./p.m.	<u>                    </u> a.m./p.m.
<u>                    </u>	<u>                    </u>	<u>                    </u> a.m./p.m.	<u>                    </u> a.m./p.m.
<u>                    </u>	<u>                    </u>	<u>                    </u> a.m./p.m.	<u>                    </u> a.m./p.m.
<u>                    </u>	<u>                    </u>	<u>                    </u> a.m./p.m.	<u>                    </u> a.m./p.m.
<u>                    </u>	<u>                    </u>	<u>                    </u> a.m./p.m.	<u>                    </u> a.m./p.m.
<u>                    </u>	<u>                    </u>	<u>                    </u> a.m./p.m.	<u>                    </u> a.m./p.m.

6. Name and address of site owner: Selby Robert  
Last First Middle

4280 N. Campbell Ave., Ste 212 Tucson AZ 85718  
Address City State Zip

7. Phone Numbers: (520) 529-2775 (602) 320-1722 (602) 320-1622  
Site Owner Applicant's Business Applicant's Residence

\* Disabled individuals requiring special accommodation, please call (602) 542-9027.

8. Has the festival site owner given permission for use of the site and for the sale of spirituous liquors? YES ☒ NO ☐
9. Are the spirituous liquors to be sold or served Arizona Domestic Farm Winery Products **ONLY**? YES ☒ NO ☐
10. How many wine festival licenses have you applied for this calendar year, including this one? 5

Give the total number of days you have held licensed wine festivals this year 7

11. What security and control measures will you take to prevent violations of state liquor laws at this event?  
(List type and number of security/police personnel and type of fencing or control barriers if applicable)

0

# Police

☒ Fencing

4

# Security personnel

☒ Barriers

There will be Security personnel at the entrants/exits checking IDs and ensuring wine does not leave the fenced area.

Additionally, we will have roaming Security personnel to ensure individuals are only entering the area at the designated entrants/exits points.

12. Your licensed premises is that area in which you are authorized to sell, dispense, or serve spirituous liquors under the provisions of your license. The following page is to be used to prepare a diagram of your wine festival/fair licensed premises. Please show dimensions, serving areas, fencing, barricades or other control measures and security positions.

I, Barbara J Pierce, hereby declare that I am the APPLICANT filing this application. I  
(Print full name)  
have read the application and the contents and all statements are true, correct and complete.

X Barbara J Pierce  
(Signature of APPLICANT)

State of Arizona County of Maricopa  
The foregoing instrument was acknowledged before me this  
25 day of October, 2013  
Day Month Year  
[Signature]  
(Signature of NOTARY PUBLIC)

My commission expires Oct 15, 2016

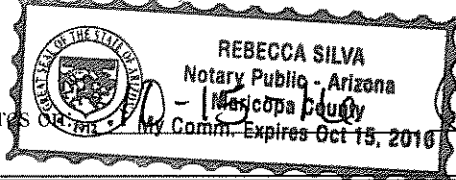

\*\*\* FOR USE BY LOCAL GOVERNING AUTHORITY ONLY \*\*\*

I, \_\_\_\_\_, hereby ☐ APPROVE ☐ DISAPPROVE this application on behalf of  
(Government Official)

\_\_\_\_\_  
(City, Town, or County)

\_\_\_\_\_  
(Title)

X \_\_\_\_\_  
(Signature of OFFICIAL)

\*\*\* FOR USE BY DLLC ONLY \*\*\*

☐ APPROVED

☐ DISAPPROVED

By:

\_\_\_\_\_

Date:

\_\_\_\_\_



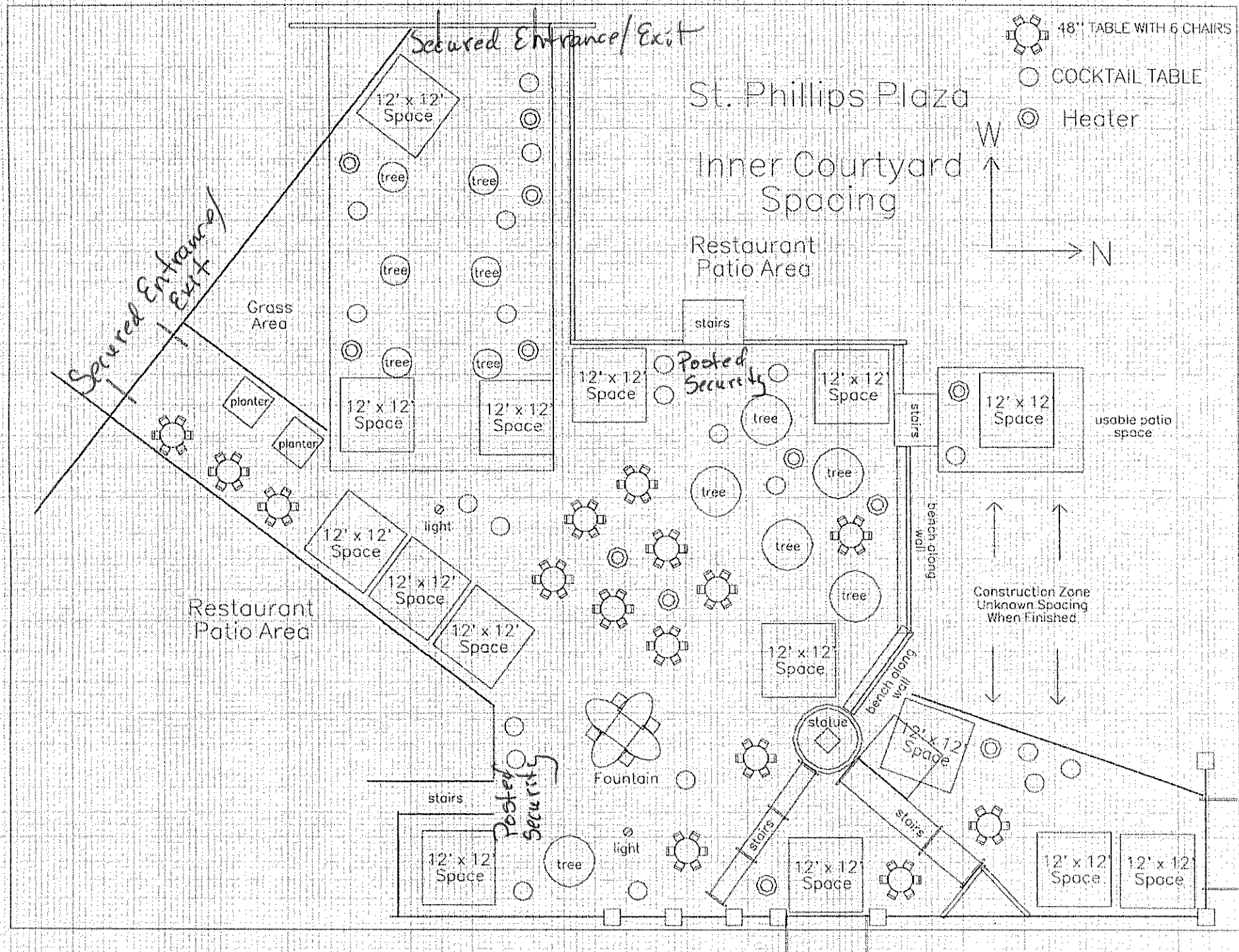

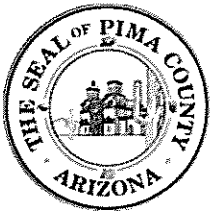

**Mary Jo Furphy**  
Deputy Clerk

# Pima County Clerk of the Board

Robin Brigode

Administration Division  
130 W. Congress, 5<sup>th</sup> Floor  
Tucson, AZ 85701  
Phone: (520)724-8449 • Fax: (520) 222-0448

Document and Micrographics Mgt. Division  
1640 East Benson Highway  
Tucson, Arizona 85714  
Phone: (520) 351-8454 • Fax: (520) 351-8456

November 20, 2013

Mr. Mark Anders Jorve  
Zarpara Vineyard  
17235 N. 75th Ave., Suite D-145  
Glendale, AZ 85308

RE: Application for Wine Festival License  
License No.: 13023026  
Zarpara Vineyard  
Temporary Change for December 14, 2013 from 3:00 p.m. to 8:30 p.m.

Dear Mr. Jorve:

Notice is hereby given that the Pima County Board of Supervisors will hold a hearing in reference to the above Wine Festival License application. Please be advised that the hearing has been scheduled for Tuesday, December 3, 2013, at 9:00 a.m. or thereafter, to be held at the following location:

Pima County Administration Building  
Board of Supervisors Hearing Room  
130 West Congress, 1st Floor  
Tucson, Arizona 85701

If you have any questions pertaining to this hearing, please contact this office at (520)724-8449.

Sincerely,

  
Robin Brigode  
Clerk of the Board

c: Sheriff's Dept., Investigative Support Unit Division

FEE = \$15.00 per event

A service fee of \$25.00 will be charged for all dishonored checks (A.R.S. 44-6852)

A separate license is needed when days are not consecutive. Only twenty-five (25) licenses per calendar year for up to seventy-five calendar days may be issued, excluding sanctioned county or state fair licenses.

1. Applicant's Name:	Jorve Mark Anders			
	Last	First	Middle	
2. Business Name:	Zarpara Vineyard	D.F.W. Lic#:	13023026	
			(Domestic Farm Winery License #)	
3. Location of Festival:	4280 N. Campbell Ave., Ste 212	Tucson	Pima	85718
	(Physical location - Do not use PO Box)	City	County	Zip
4. Mailing Address:	17235 N. 75th Ave., Ste D-145	Glendale	AZ	85308
		City	State	Zip

5. Date and hours of festival:

[illegible]

6. Name and address of site owner:	Selby		Robert	
	Last	First	Middle	
	4280 N. Campbell Ave., Ste 212	Tucson	AZ	85718
	Address	City	State	Zip
7. Phone Numbers:	(520) 529-2775	(602) 885-8903	(602) 885-8903	
	Site Owner	Applicant's Business	Applicant's Residence	

\* Disabled individuals requiring special accommodation, please call (602) 542-9027.

8. Has the festival site owner given permission for use of the site and for the sale of spirituous liquors? YES ☒ NO ☐
9. Are the spirituous liquors to be sold or served Arizona Domestic Farm Winery Products **ONLY**? YES ☒ NO ☐
10. How many wine festival licenses have you applied for this calendar year, including this one? 10

Give the total number of days you have held licensed wine festivals this year 11

11. What security and control measures will you take to prevent violations of state liquor laws at this event?  
(List type and number of security/police personnel and type of fencing or control barriers if applicable)

0 # Police ☒ Fencing  
4 # Security personnel ☒ Barriers

There will be Security personnel at the entrants/exits checking IDs and ensuring wine does not leave the fenced area.

Additionally, we will have roaming Security personnel to ensure individuals are only entering the area at the designated entrants/exits points.

12. Your licensed premises is that area in which you are authorized to sell, dispense, or serve spirituous liquors under the provisions of your license. The following page is to be used to prepare a diagram of your wine festival/fair licensed premises. Please show dimensions, serving areas, fencing, barricades or other control measures and security positions.

I, Mark Anders Jorve, hereby declare that I am the APPLICANT filing this application. I  
(Print full name)  
have read the application and the contents and all statements are true, correct and complete.

X [Signature] State of Arizona County of Cochise  
The foregoing instrument was acknowledged before me this  
24 day of October, 2013  
Day Month Year  
My commission expires Oct 6, 2015  
[Notary Seal: JOSE LUNA, Notary Public - Arizona, Cochise County]  
(Signature of NOTARY PUBLIC)

\*\*\* FOR USE BY LOCAL GOVERNING AUTHORITY ONLY \*\*\*

I, \_\_\_\_\_, hereby ☐ APPROVE ☐ DISAPPROVE this application on behalf of  
(Government Official)

\_\_\_\_\_  
(City, Town, or County) (Title) X \_\_\_\_\_  
(Signature of OFFICIAL)

\*\*\* FOR USE BY DLLC ONLY \*\*\*

☐ APPROVED ☐ DISAPPROVED

By: \_\_\_\_\_ Date: \_\_\_\_\_

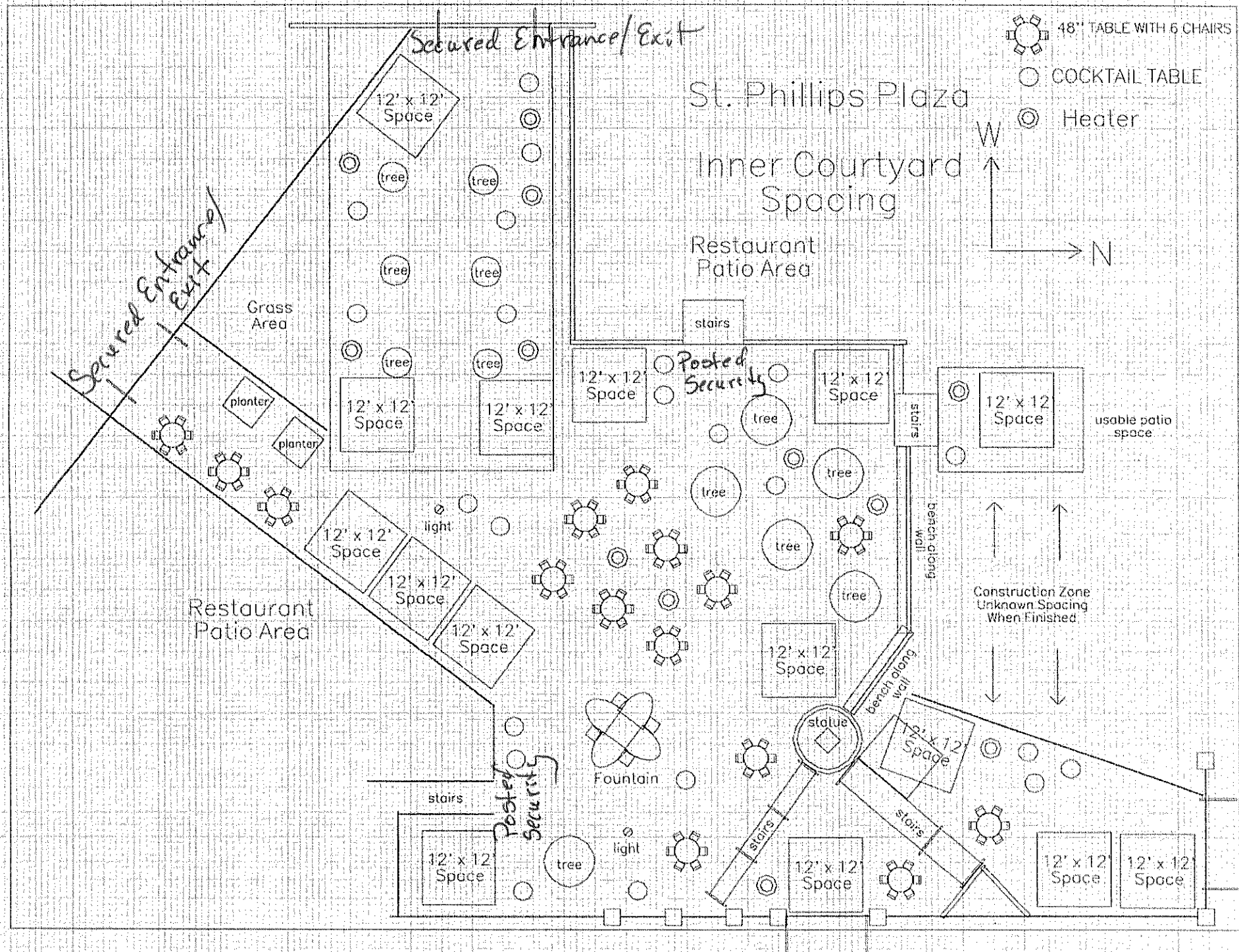

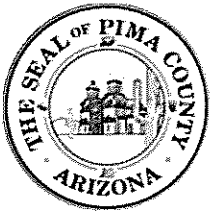

**Mary Jo Furphy**  
Deputy Clerk

# Pima County Clerk of the Board

Robin Brigode

Administration Division  
130 W. Congress, 5<sup>th</sup> Floor  
Tucson, AZ 85701  
Phone: (520)724-8449 • Fax: (520) 222-0448

Document and Micrographics Mgt. Division  
1640 East Benson Highway  
Tucson, Arizona 85714  
Phone: (520) 351-8454 • Fax: (520) 351-8456

November 20, 2013

Ms. Megan Austin Haller  
AZ Hops & Vines  
17235 N. 75th Ave., Suite D-145  
Glendale, AZ 85308

RE: Application for Wine Festival License  
License No.: 13123013  
AZ Hops & Vines  
Temporary Change for December 14, 2013 from 3:00 p.m. to 8:30 p.m.

Dear Ms. Haller:

Notice is hereby given that the Pima County Board of Supervisors will hold a hearing in reference to the above Wine Festival License application. Please be advised that the hearing has been scheduled for Tuesday, December 3, 2013, at 9:00 a.m. or thereafter, to be held at the following location:

Pima County Administration Building  
Board of Supervisors Hearing Room  
130 West Congress, 1st Floor  
Tucson, Arizona 85701

If you have any questions pertaining to this hearing, please contact this office at (520)724-8449.

Sincerely,

Robin Brigode  
Clerk of the Board

A handwritten signature in cursive script, appearing to read "Mary Jo Furphy, Deputy".

c: Sheriff's Dept., Investigative Support Unit Division

State of Arizona Department of Liquor Licenses and Control  
800 W. Washington, 5th Floor  
Phoenix, AZ 85007  
www.azliquor.gov  
(602)542-5141

**APPLICATION FOR WINE FESTIVAL LICENSE/WINE FAIR LICENSE**

FEE = \$15.00 per event

A service fee of \$25.00 will be charged for all dishonored checks (A.R.S. 44-6852)

A separate license is needed when days are not consecutive. Only twenty-five (25) licenses per calendar year for up to seventy-five calendar days may be issued, excluding sanctioned county or state fair licenses.

1. Applicant's Name: Haller Megan Austin  
Last First Middle
2. Business Name: Az Hops & Vines D.F.W. Lic#: 13123013  
(Domestic Farm Winery License #)
3. Location of Festival: 4280 N. Campbell Ave STE 212 TUCSON Pima 85718  
(Physical location - Do not use PO Box) City County Zip
4. Mailing Address: 7235 N. 76th Ave STE D145 Glendale, AZ 85308  
City State Zip
5. Date and hours of festival:

DATE	DAY OF WEEK	HOURS FROM	HOURS TO
<u>12/14/13</u>	<u>Saturday</u>	<u>3</u> a.m./p.m.	<u>8:30</u> a.m./p.m.
_____	_____	_____ a.m./p.m.	_____ a.m./p.m.
_____	_____	_____ a.m./p.m.	_____ a.m./p.m.
_____	_____	_____ a.m./p.m.	_____ a.m./p.m.
_____	_____	_____ a.m./p.m.	_____ a.m./p.m.
_____	_____	_____ a.m./p.m.	_____ a.m./p.m.
_____	_____	_____ a.m./p.m.	_____ a.m./p.m.
_____	_____	_____ a.m./p.m.	_____ a.m./p.m.
_____	_____	_____ a.m./p.m.	_____ a.m./p.m.
_____	_____	_____ a.m./p.m.	_____ a.m./p.m.

6. Name and address of site owner: Sellay Robert  
Last First Middle  
4280 N. Campbell Ave STE 212 TUCSON AZ 85718  
Address City State Zip
7. Phone Numbers: (602) 529-2775 (888) 569-1104 (520) 955-4249  
Site Owner Applicant's Business Applicant's Residence

\* Disabled individuals requiring special accommodation, please call (602) 542-9027.

8. Has the festival site owner given permission for use of the site and for the sale of spirituous liquors? YES ☒ NO ☐

9. Are the spirituous liquors to be sold or served Arizona Domestic Farm Winery Products **ONLY**? YES ☒ NO ☐

10. How many wine festival licenses have you applied for this calendar year, including this one? 2

Give the total number of days you have held licensed wine festivals this year 2

11. What security and control measures will you take to prevent violations of state liquor laws at this event?  
(List type and number of security/police personnel and type of fencing or control barriers if applicable)

         # Police ☐ Fencing  
         # Security personnel ☐ Barriers

12. Your licensed premises is that area in which you are authorized to sell, dispense, or serve spirituous liquors under the provisions of your license. The following page is to be used to prepare a diagram of your wine festival/fair licensed premises. Please show dimensions, serving areas, fencing, barricades or other control measures and security positions.

I, Megan Austin Haller, hereby declare that I am the APPLICANT filing this application. I  
(Print full name)  
have read the application and the contents and all statements are true, correct and complete.

X Megan Haller State of Arizona County of Santa Cruz  
(Signature of APPLICANT)  
The foregoing instrument was acknowledged before me this  
19<sup>th</sup> day of November, 2013  
Day Month Year

My commission expires on: 1-4-14

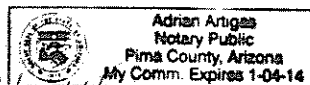

Adrian Arugas  
(Signature of NOTARY PUBLIC)

\*\*\* FOR USE BY LOCAL GOVERNING AUTHORITY ONLY \*\*\*

I, \_\_\_\_\_, hereby ☐ APPROVE ☒ DISAPPROVE this application on behalf of  
(Government Official)

\_\_\_\_\_  
(City, Town, or County)

\_\_\_\_\_  
(Title)

X \_\_\_\_\_  
(Signature of OFFICIAL)

\*\*\* FOR USE BY DLLC ONLY \*\*\*

☐ APPROVED

☐ DISAPPROVED

By: \_\_\_\_\_ Date: \_\_\_\_\_



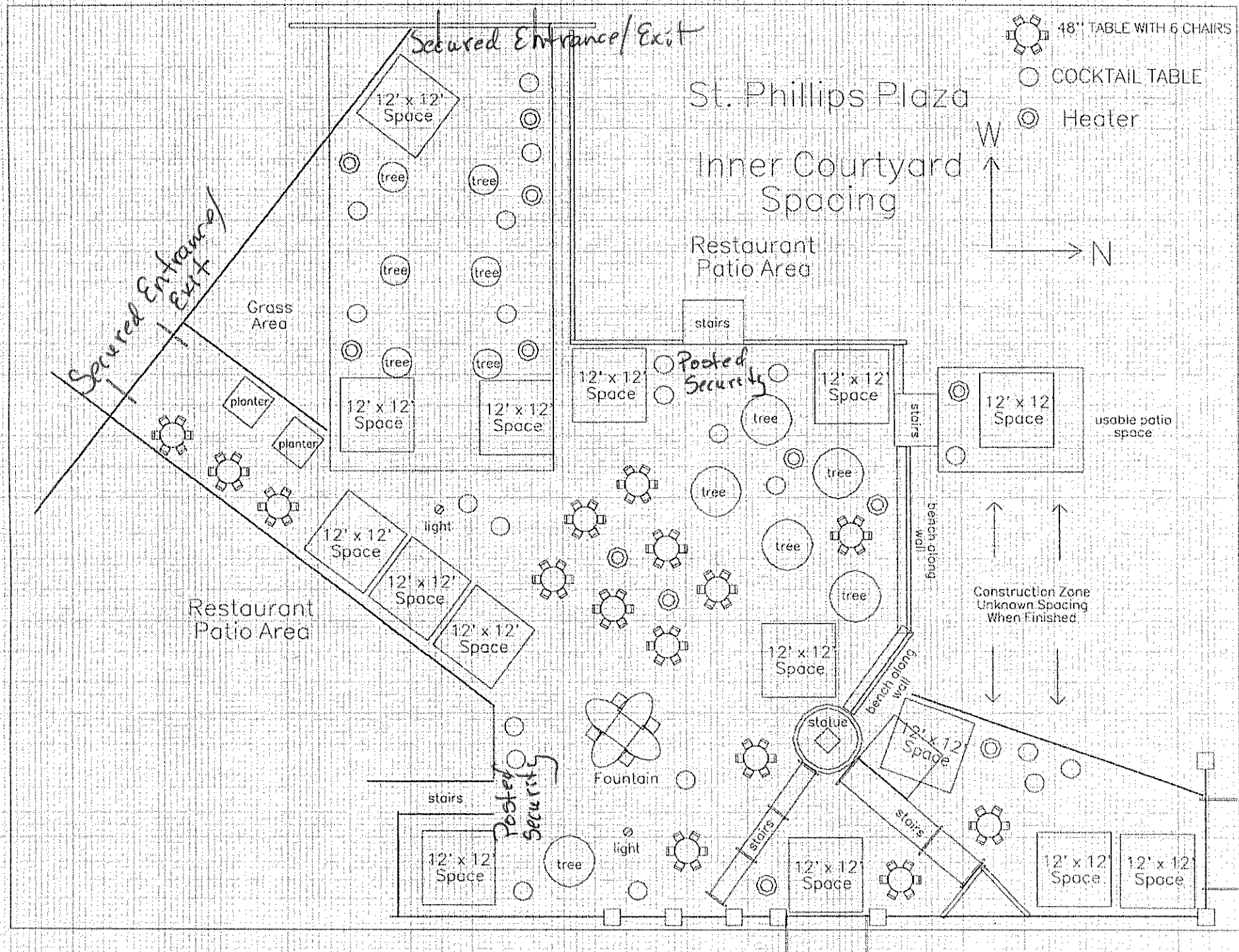

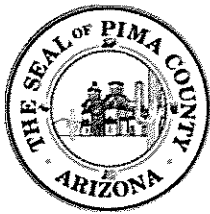

**Mary Jo Furphy**  
Deputy Clerk

# Pima County Clerk of the Board

Robin Brigode

Administration Division  
130 W. Congress, 5<sup>th</sup> Floor  
Tucson, AZ 85701  
Phone: (520)724-8449 • Fax: (520) 222-0448

Document and Micrographics Mgt. Division  
1640 East Benson Highway  
Tucson, Arizona 85714  
Phone: (520) 351-8454 • Fax: (520) 351-8456

November 20, 2013

Mr. Samuel Wallace Pillsbury  
Pillsbury Wine Company, L.L.C.  
17235 N. 75th Ave., Suite D-145  
Glendale, AZ 85308

RE: Application for Wine Festival License  
License No.: 13023010  
Pillsbury Wine Company, L.L.C.  
Temporary Change for December 14, 2013 from 3:00 p.m. to 8:30 p.m.

Dear Mr. Pillsbury:

Notice is hereby given that the Pima County Board of Supervisors will hold a hearing in reference to the above Wine Festival License application. Please be advised that the hearing has been scheduled for Tuesday, December 3, 2013, at 9:00 a.m. or thereafter, to be held at the following location:

Pima County Administration Building  
Board of Supervisors Hearing Room  
130 West Congress, 1st Floor  
Tucson, Arizona 85701

If you have any questions pertaining to this hearing, please contact this office at (520)724-8449.

Sincerely,

  
Robin Brigode  
Clerk of the Board

c: Sheriff's Dept., Investigative Support Unit Division

State of Arizona Department of Liquor Licenses and Control  
800 W. Washington, 5th Floor  
Phoenix, AZ 85007  
www.azliquor.gov  
(602)542-5141

## APPLICATION FOR WINE FESTIVAL LICENSE/WINE FAIR LICENSE

FEE = \$15.00 per event

A service fee of \$25.00 will be charged for all dishonored checks (A.R.S. 44-6852)

A separate license is needed when days are not consecutive. Only twenty-five (25) licenses per calendar year for up to seventy-five calendar days may be issued, excluding sanctioned county or state fair licenses.

1. Applicant's Name: PILLSBURY SAMUEL WALLACE  
Last First Middle
2. Business Name: Pillsbury Wine Company, L.L.C. D.F.W. Lic#: 13023010  
(Domestic Farm Winery License #)
3. Location of Festival: 4280 N. Campbell Ave., Ste 212 Tucson Pima 85718  
(Physical location - Do not use PO Box) City County Zip
4. Mailing Address: 17235 N. 75th Ave., Ste D-145 Glendale AZ 85308  
City State Zip

5. Date and hours of festival:

DATE	DAY OF WEEK	HOURS FROM	HOURS TO
<u>12/14/2013</u>	<u>Saturday</u>	<u>3:00</u> a.m./p.m.	<u>8:30</u> a.m./p.m.
_____	_____	_____ a.m./p.m.	_____ a.m./p.m.
_____	_____	_____ a.m./p.m.	_____ a.m./p.m.
_____	_____	_____ a.m./p.m.	_____ a.m./p.m.
_____	_____	_____ a.m./p.m.	_____ a.m./p.m.
_____	_____	_____ a.m./p.m.	_____ a.m./p.m.
_____	_____	_____ a.m./p.m.	_____ a.m./p.m.
_____	_____	_____ a.m./p.m.	_____ a.m./p.m.
_____	_____	_____ a.m./p.m.	_____ a.m./p.m.
_____	_____	_____ a.m./p.m.	_____ a.m./p.m.

6. Name and address of site owner: Selby Robert  
Last First Middle
- 4280 N. Campbell Ave., Ste 212 Tucson AZ 85718  
Address City State Zip
7. Phone Numbers: (520) 529-2775 (310) 508 3348 (602) 996 3239  
Site Owner Applicant's Business Applicant's Residence

\* Disabled individuals requiring special accommodation, please call (602) 542-9027.

8. Has the festival site owner given permission for use of the site and for the sale of spirituous liquors? YES ☒ NO ☐

9. Are the spirituous liquors to be sold or served Arizona Domestic Farm Winery Products **ONLY**? YES ☒ NO ☐

10. How many wine festival licenses have you applied for this calendar year, including this one? 11

Give the total number of days you have held licensed wine festivals this year 15

11. What security and control measures will you take to prevent violations of state liquor laws at this event?  
(List type and number of security/police personnel and type of fencing or control barriers if applicable)

0 # Police ☒ Fencing  
4 # Security personnel ☒ Barriers

THERE WILL BE SECURITY PERSONNEL AT THE ENTRANCES/EXITS CHECKING ID'S & ENSURING WINE DOES NOT LEAVE THE FENCED AREA. ADDITIONALLY, WE WILL HAVE TRAINING SECURITY PERSONNEL TO ENSURE INDIVIDUALS ARE ONLY ENTERING AT THE DESIGNATED ENTRANCE/EXIT POINTS.

12. Your licensed premises is that area in which you are authorized to sell, dispense, or serve spirituous liquors under the provisions of your license. The following page is to be used to prepare a diagram of your wine festival/fair licensed premises. Please show dimensions, serving areas, fencing, barricades or other control measures and security positions.

I, SAM PILLSBURY, hereby declare that I am the APPLICANT filing this application. I  
(Print full name)

have read the application and the contents and all statements are true, correct and complete.

X [Signature] State of Arizona County of Maricopa  
(Signature of APPLICANT) The foregoing instrument was acknowledged before me this

1 day of November, 2013  
Day Month Year

My commission expires on: 9/4/17

[Signature]  
(Signature of NOTARY PUBLIC)

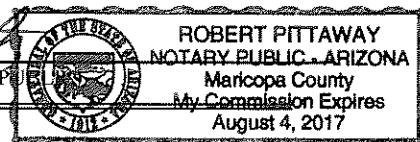

\*\*\* FOR USE BY LOCAL GOVERNING AUTHORITY ONLY \*\*\*

I, \_\_\_\_\_, hereby ☐ APPROVE ☐ DISAPPROVE this application on behalf of  
(Government Official)

\_\_\_\_\_  
(City, Town, or County) (Title) X (Signature of OFFICIAL)

\*\*\* FOR USE BY DLLC ONLY \*\*\*

☐ APPROVED ☐ DISAPPROVED

By: \_\_\_\_\_ Date: \_\_\_\_\_

